

CHRYSLER Renegade (BV) Vehicle Isolation Test

Supported equipment: Launch's full range of comprehensive diagnostic equipment

Current equipment: PAD 5

Function description: Vehicle isolation test for CHRYSLER Renegade (BV)

Tested model: CHRYSLER/2020/Renegade (BV), VIN: 1C4BU0001LP0*****

1. On a PAD 5, choose [Local Diagnose] and then [CHRYSLER] to test.

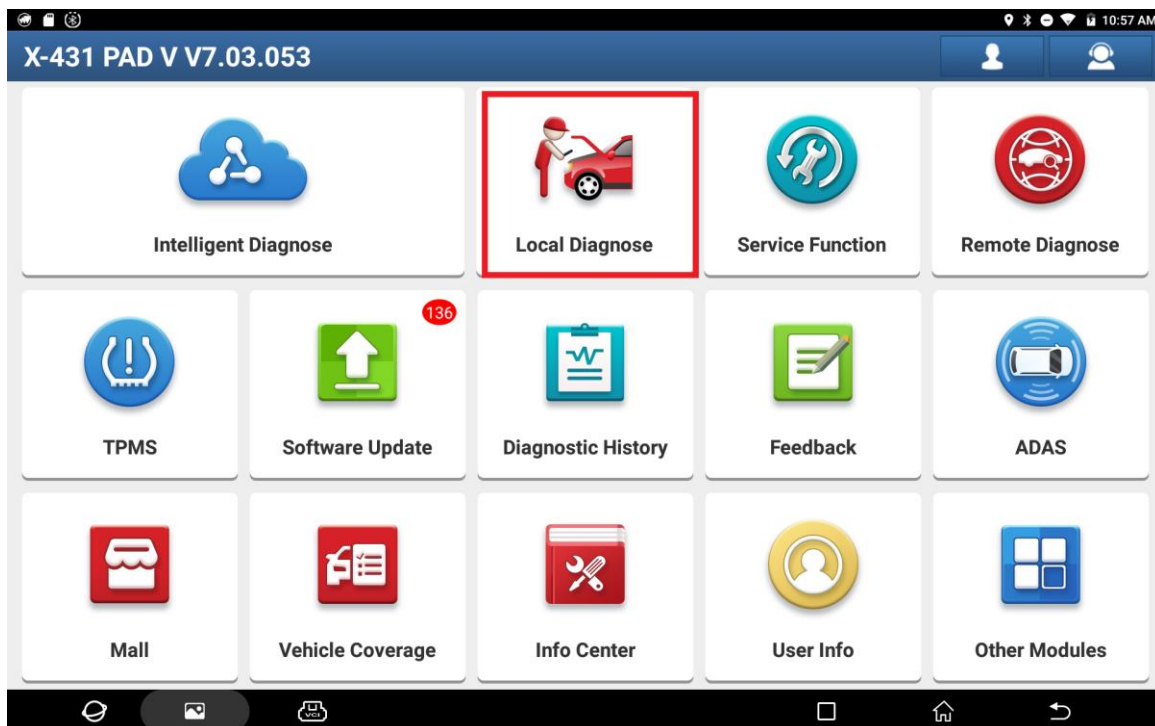

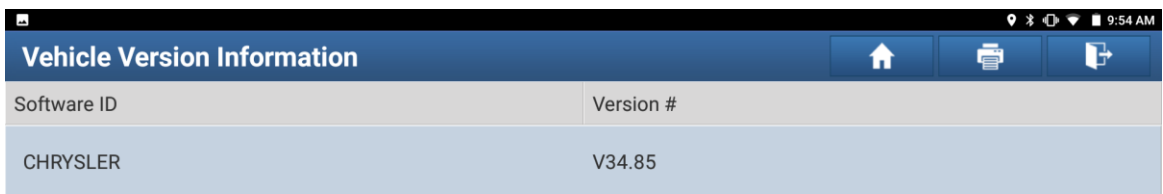
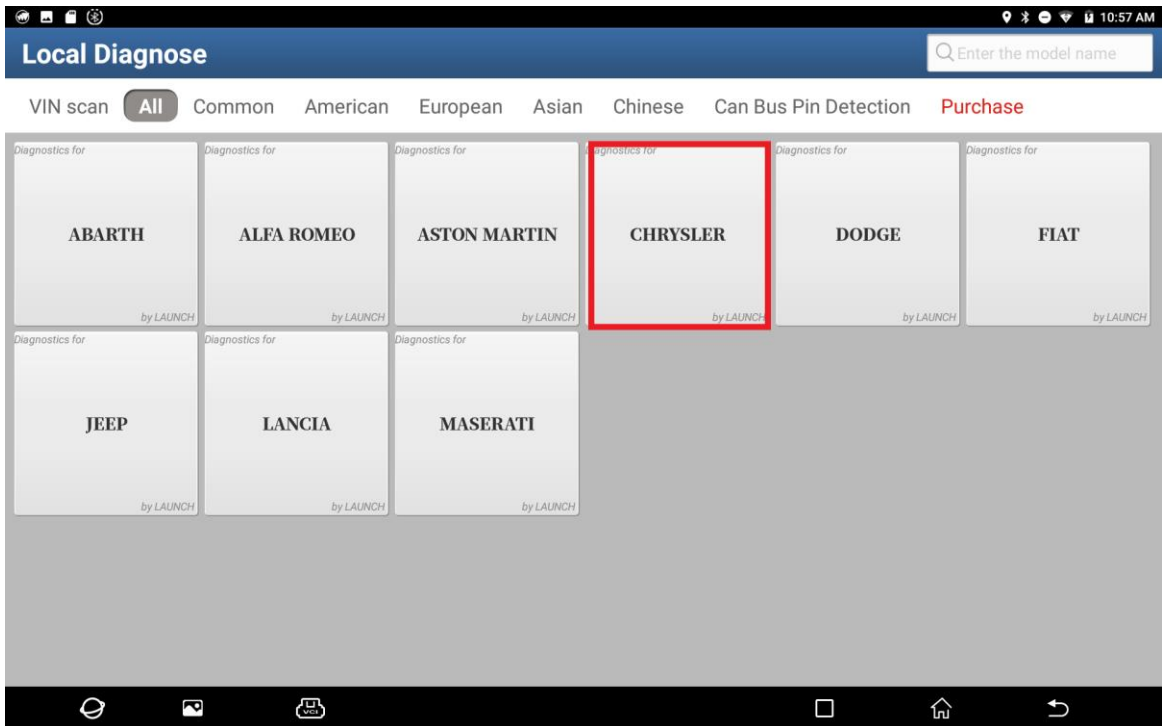

CHRYSLER/JEEP/DODGE V34.85

Introduction

ECU Coverage:

Engine, Automatic Transmission, Anti-lock Brake, Airbag, Body, A/C, Dashboard, Memory Seat, Trap-door, Steering Angle, Wireless Control Module, Tire Pressure, etc.

Basic Functions:

- Read Car Computer Information
- Read Car Fault Information
- Clear Car Fault Information
- Read Car Running Data
- Actuation Test For Car Component

Special Functions:

- **ENGINE [Engine System]:**
 Check PCM Odometer, Check PCM VIN, Learn ETC, Reset ECU, Reset Memory, Clear Variable Line Pressure(VLP) Counters, Relearn Cam/Crank, Injector Quantity Adjustment, View/Reset duty cycle accumulators, View/reset trip information accumulators, Enable / Disable vehicle features, Reset Nox adsorber counts, Reset after treatment trip information, Turbo actuator pre-align / self calibrate, Reset regenerative filter timers, Reset Fuel Pressure Limiting Valve Accumulators, Stationary Desoot, View/Reset Duty Cycle Maps, Idle Shutdown Timer Adjustment, Oil Change Monitor Type, View/Reset NAC After Treatment Over Temp Events, Manual DPF Regeneration, DPF Replacement,



2. Click [16 PIN Connector] and choose [Automatically Search] to identify car models automatically.

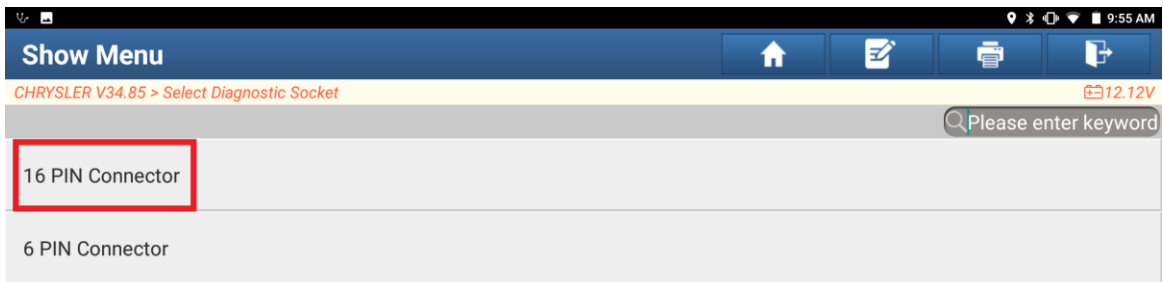
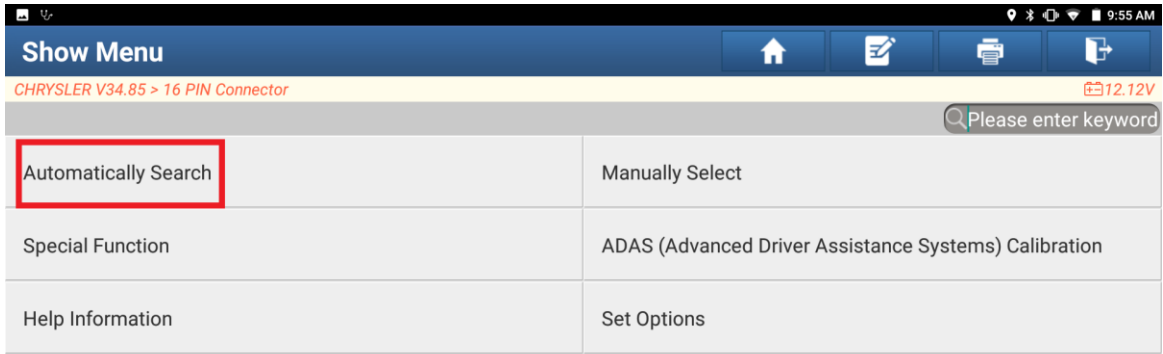

3. Click OK. It displays a prompt message indicating that the SGW needs to be unlocked.

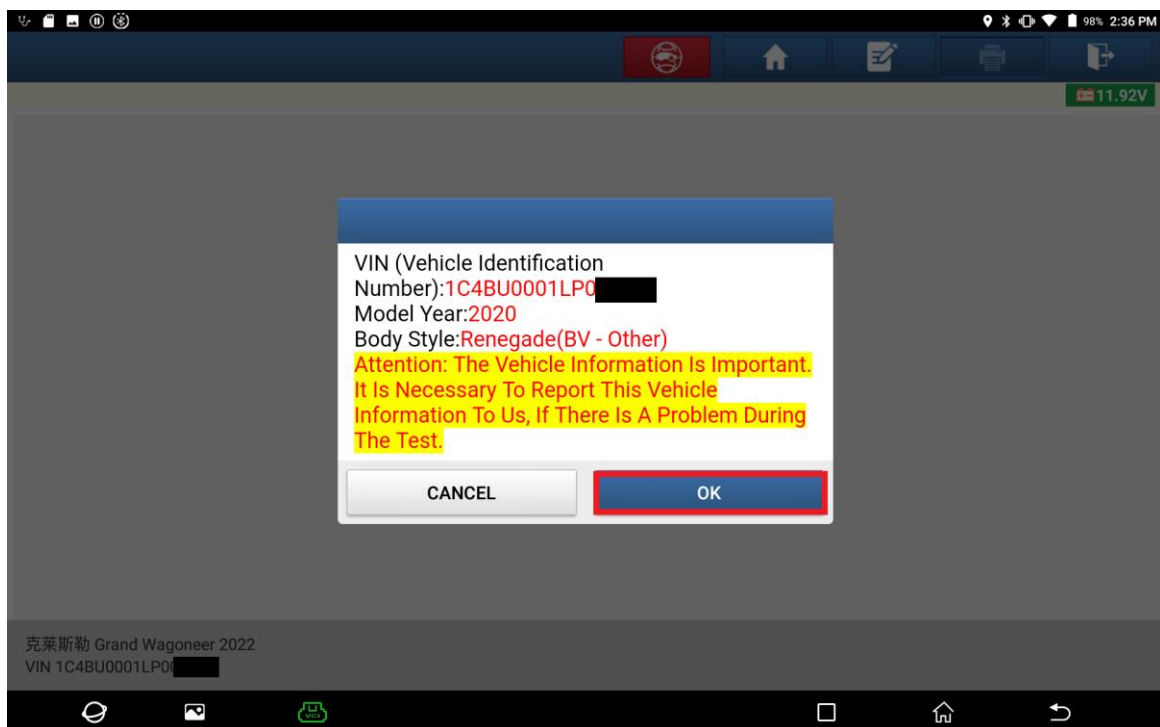
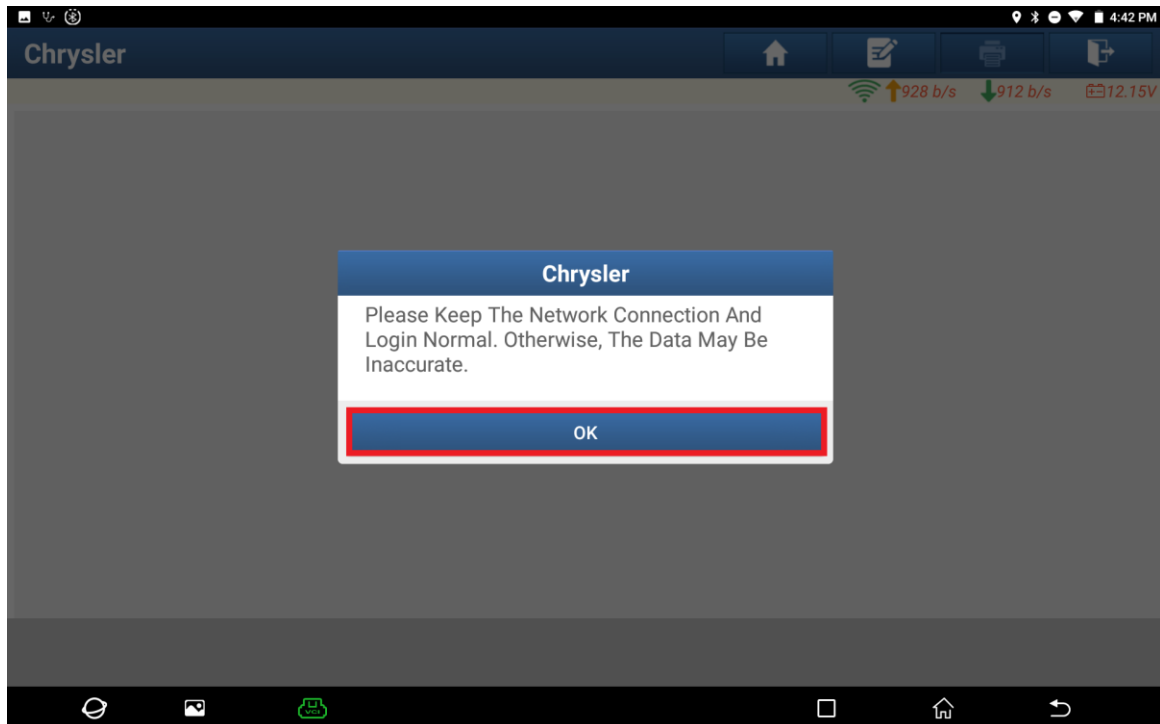

- 4. Click [Yes], choose [North America], and input the FCA account you purchased.

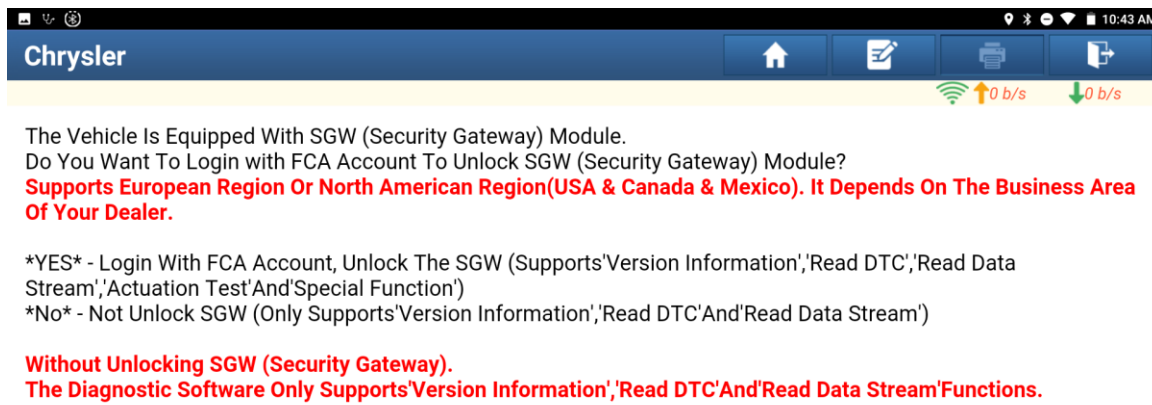

The Vehicle Is Equipped With SGW (Security Gateway) Module.
Do You Want To Login with FCA Account To Unlock SGW (Security Gateway) Module?
Supports European Region Or North American Region(USA & Canada & Mexico). It Depends On The Business Area Of Your Dealer.

YES - Login With FCA Account, Unlock The SGW (Supports'Version Information','Read DTC','Read Data Stream','Actuation Test'And'Special Function')
No - Not Unlock SGW (Only Supports'Version Information','Read DTC'And'Read Data Stream')

**Without Unlocking SGW (Security Gateway).
The Diagnostic Software Only Supports'Version Information','Read DTC'And'Read Data Stream'Functions.**

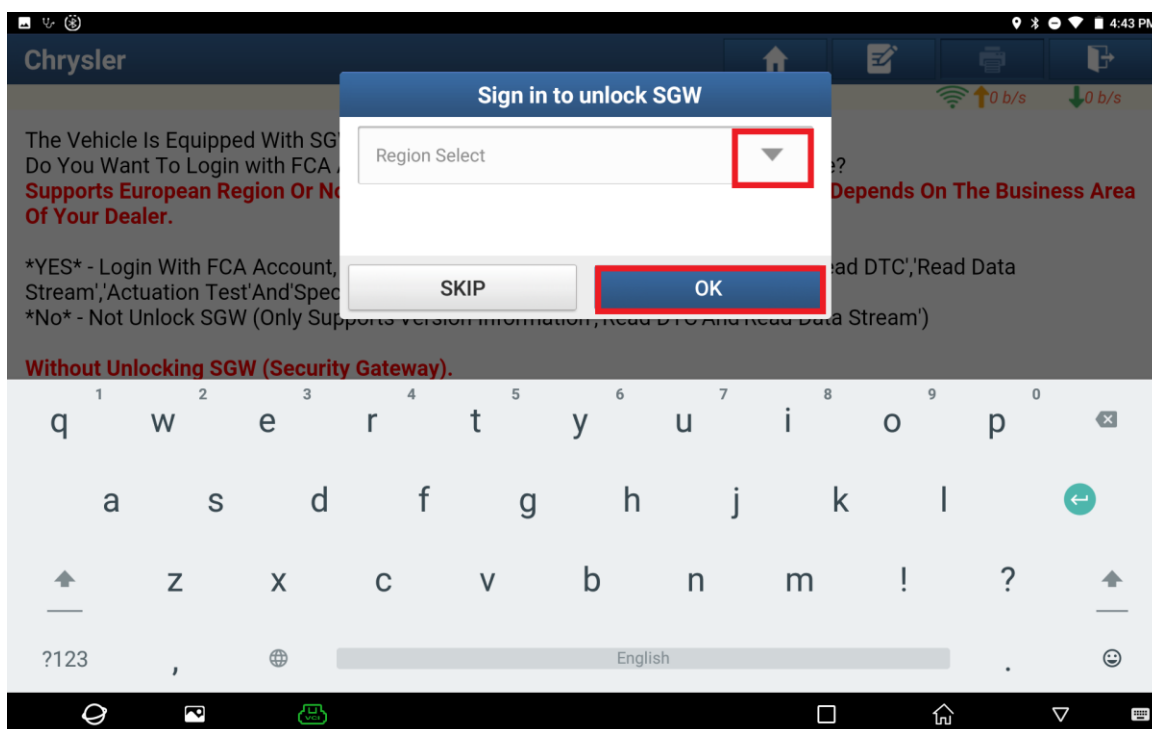
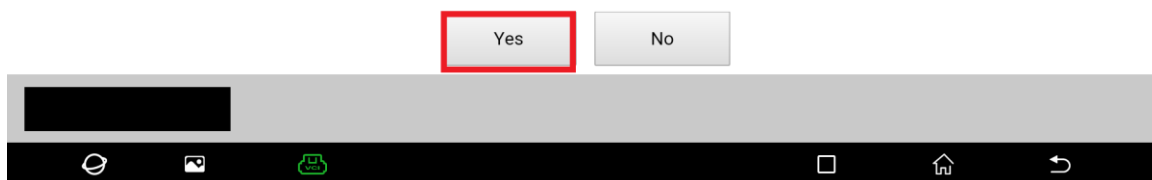

5. Click OK.

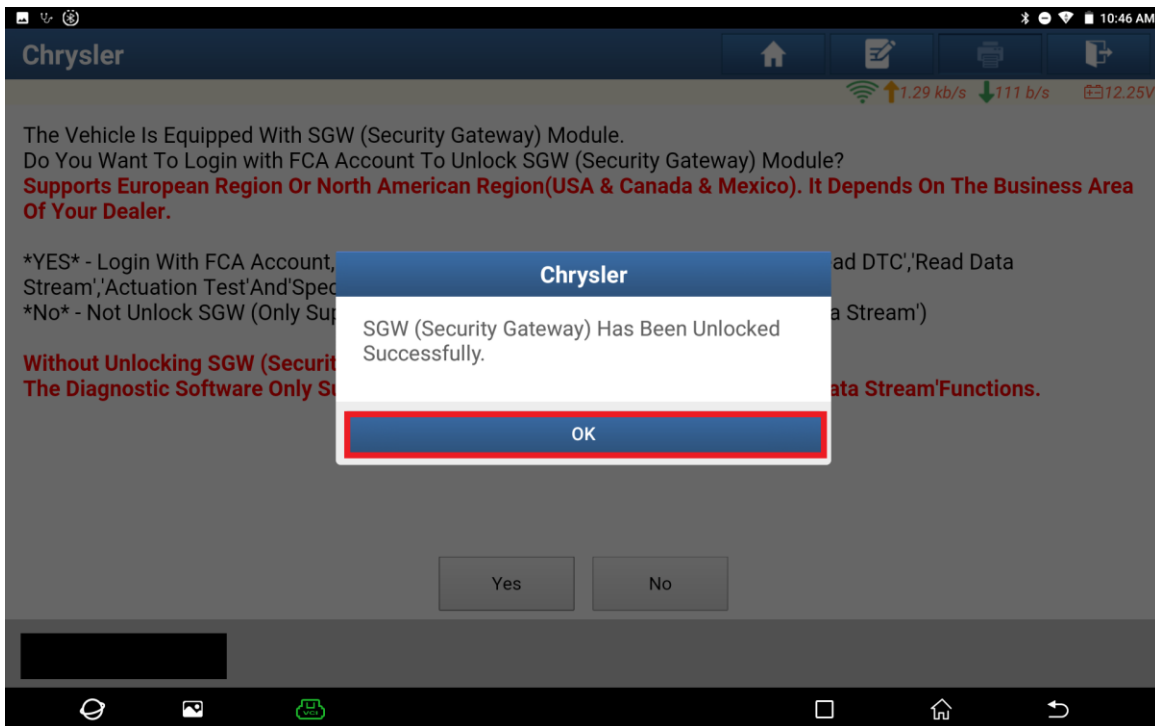
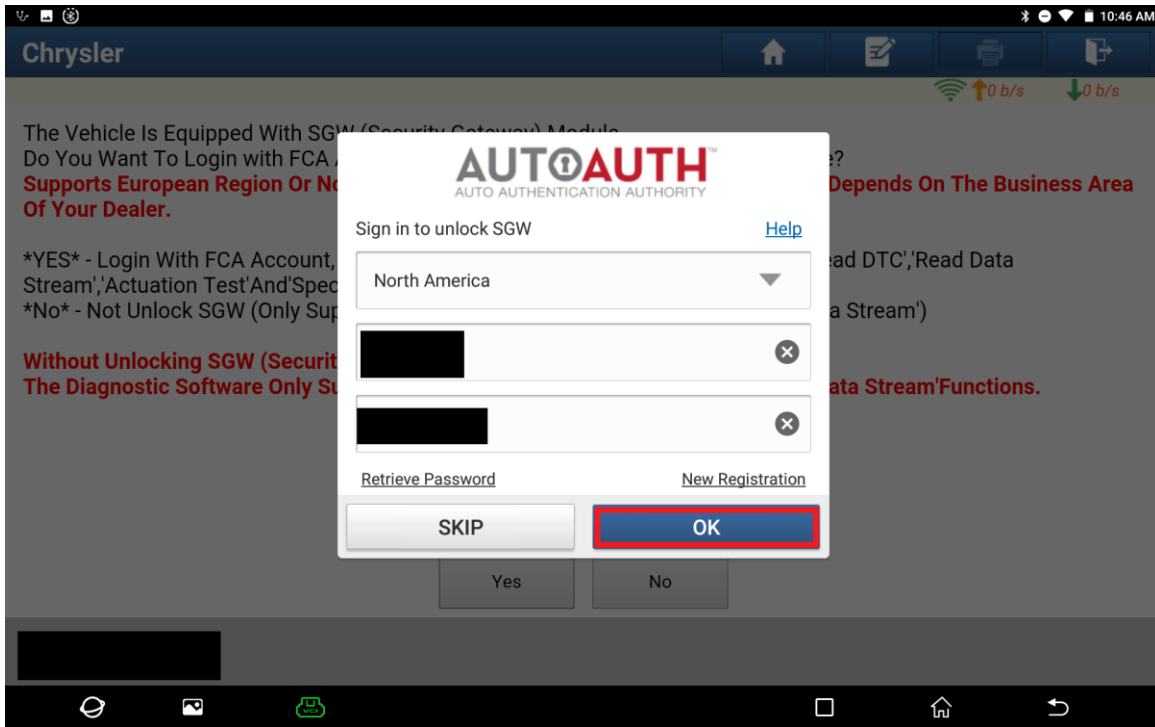

6. On the PAD 5, click [Smart Detection] to scan the entire vehicle systems.

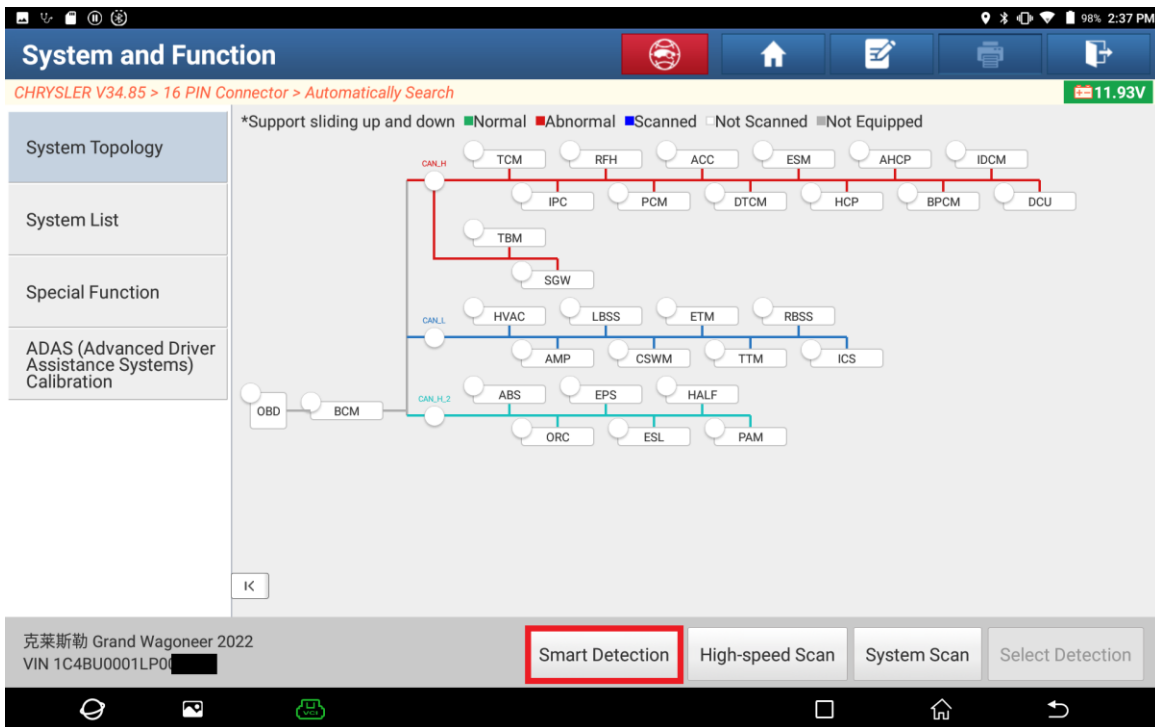

7. Click [BPCM (Battery Pack Control Module)] to access the system.

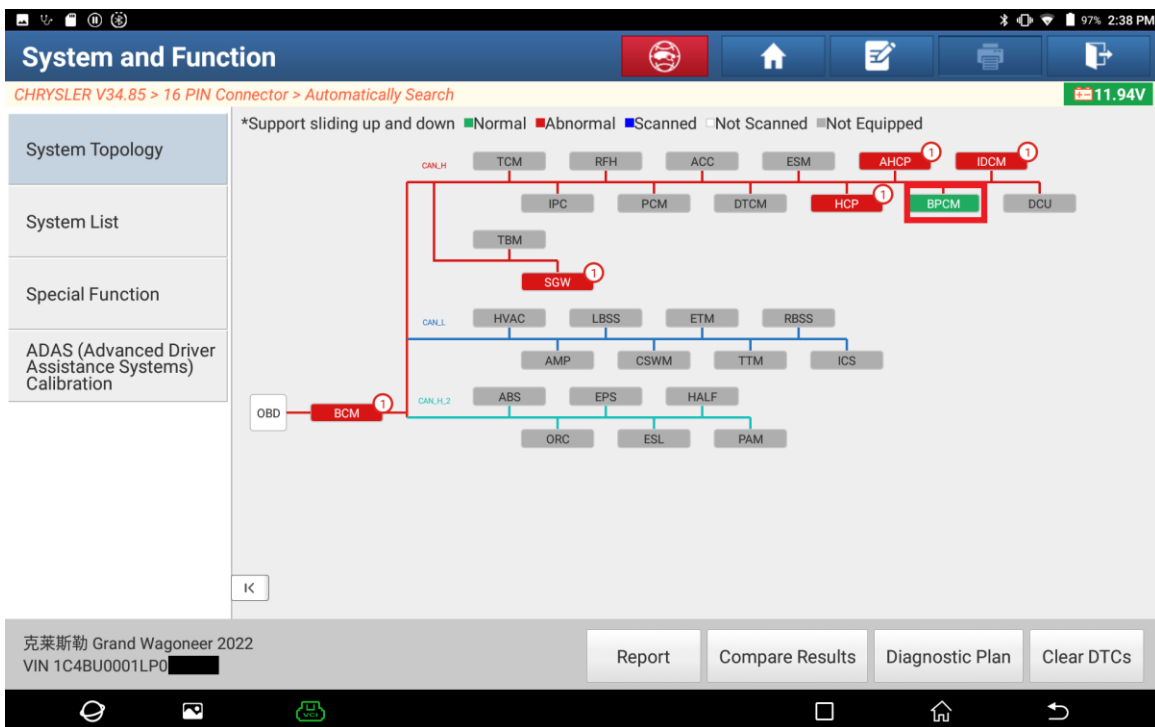

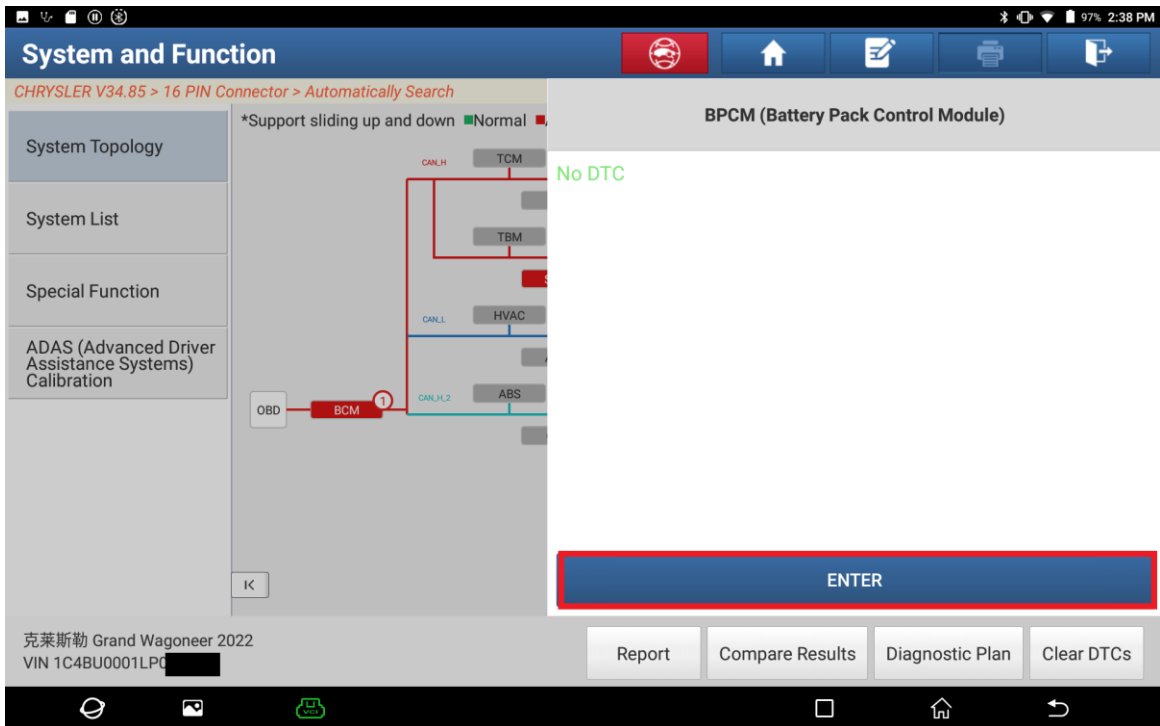

8. Click [Special Function].

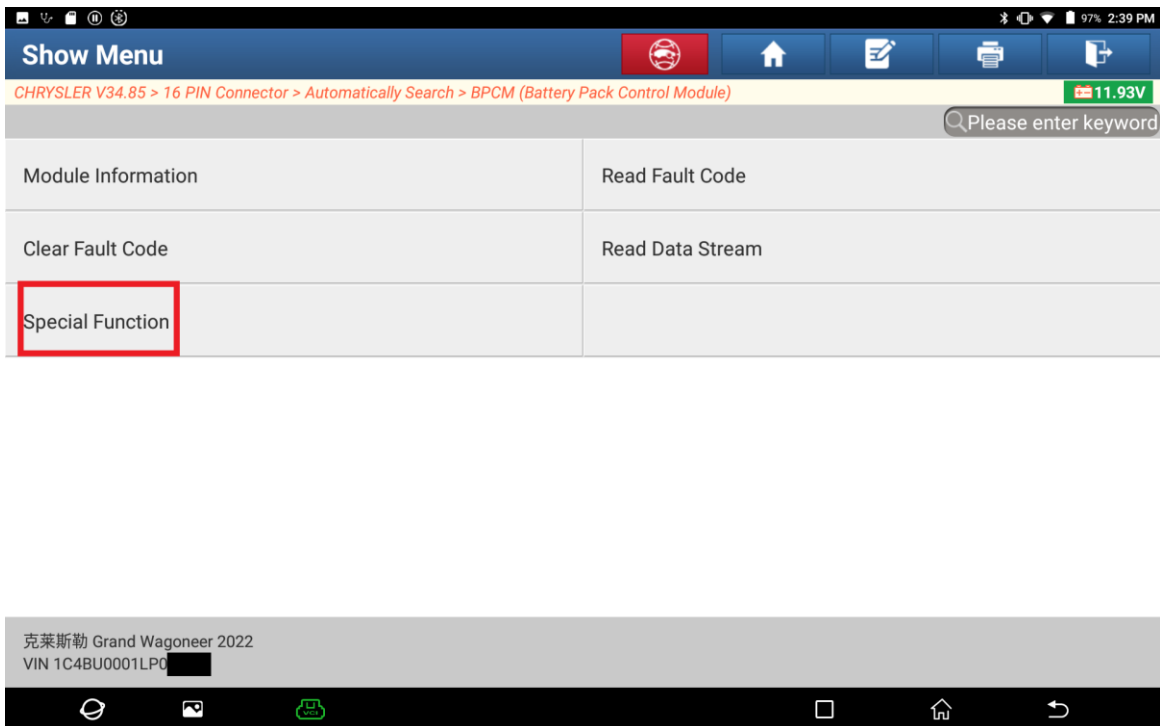

9. Click [Vehicle Isolation Test].

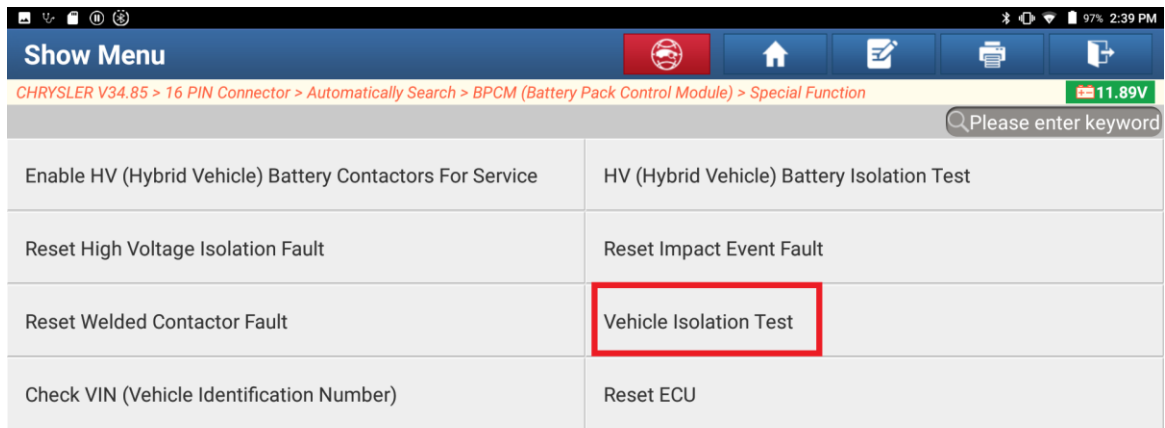

10. Click OK.

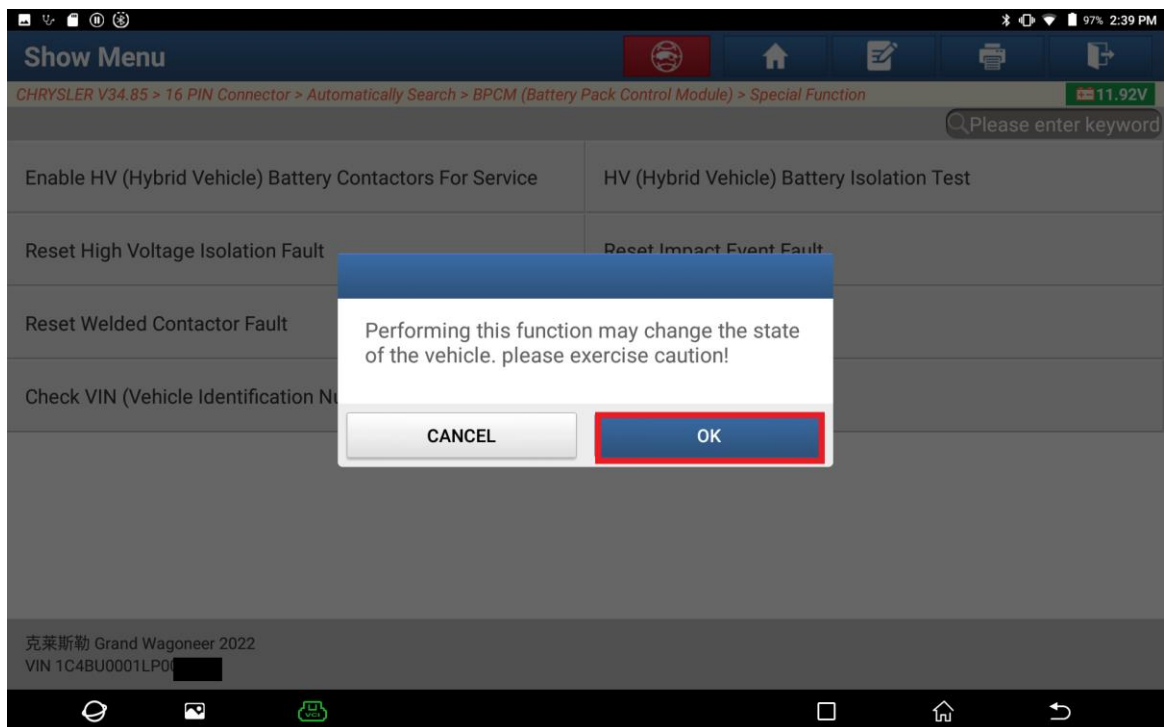

11. Click OK.

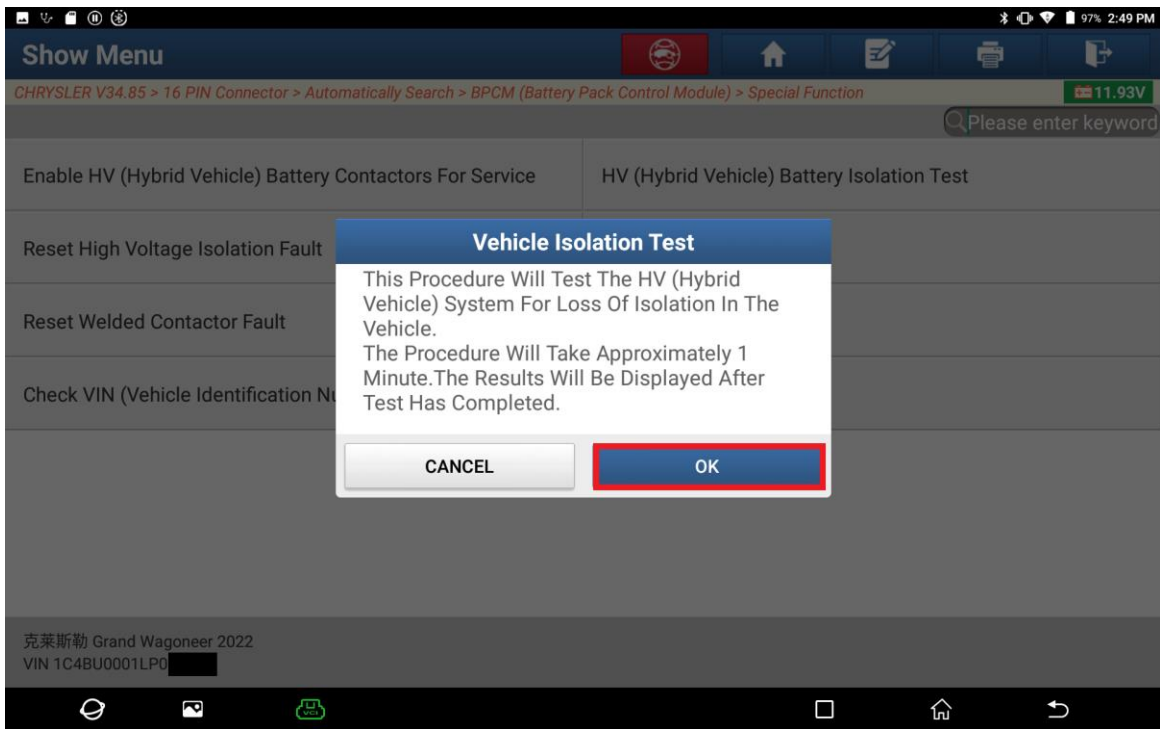

12. Click OK.

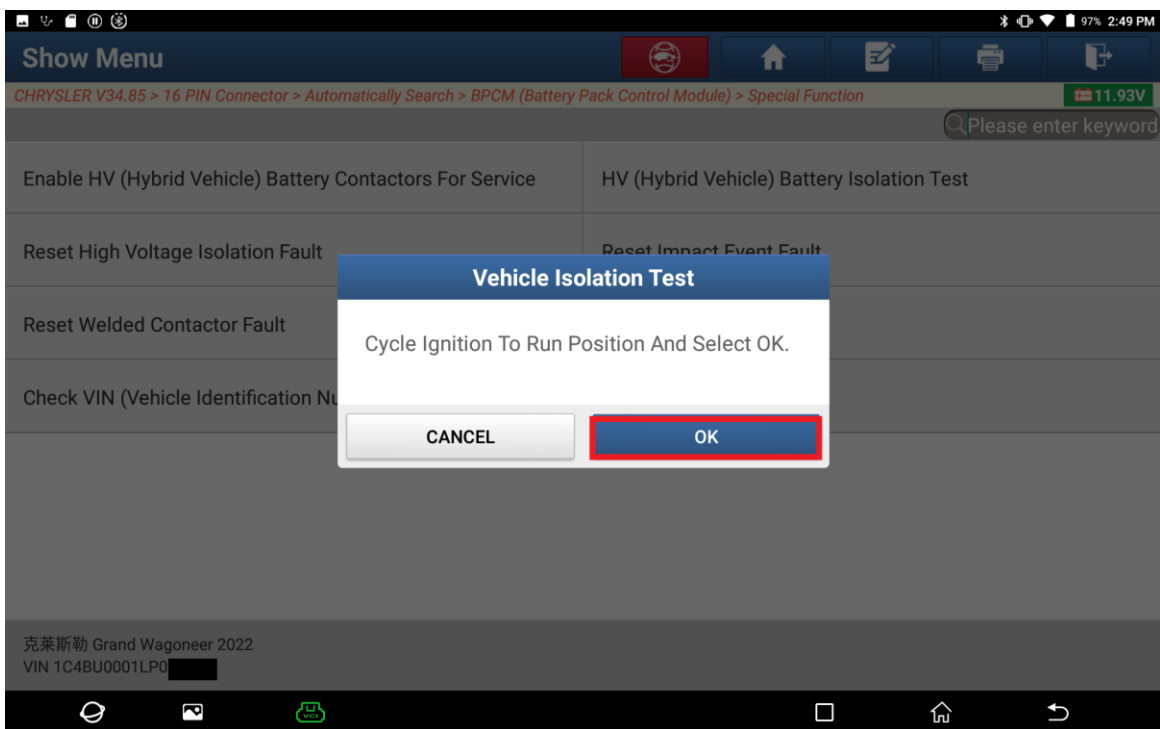

13. Wait for a moment.

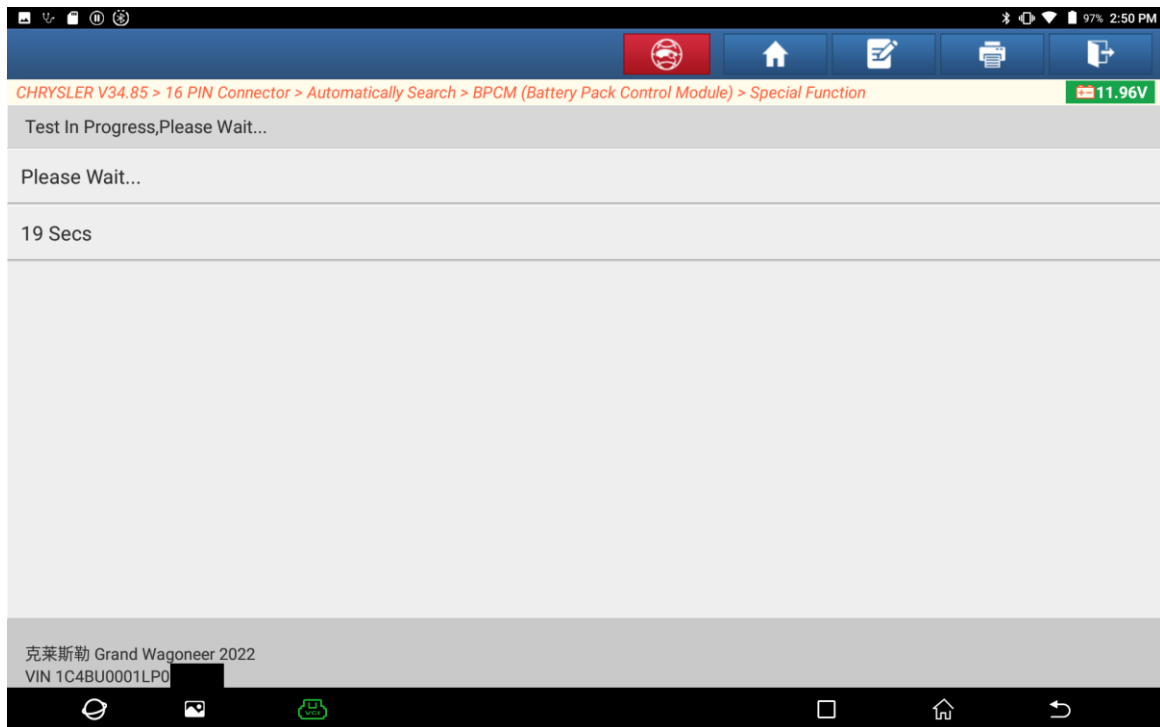

14. Click OK. The operations are completed.

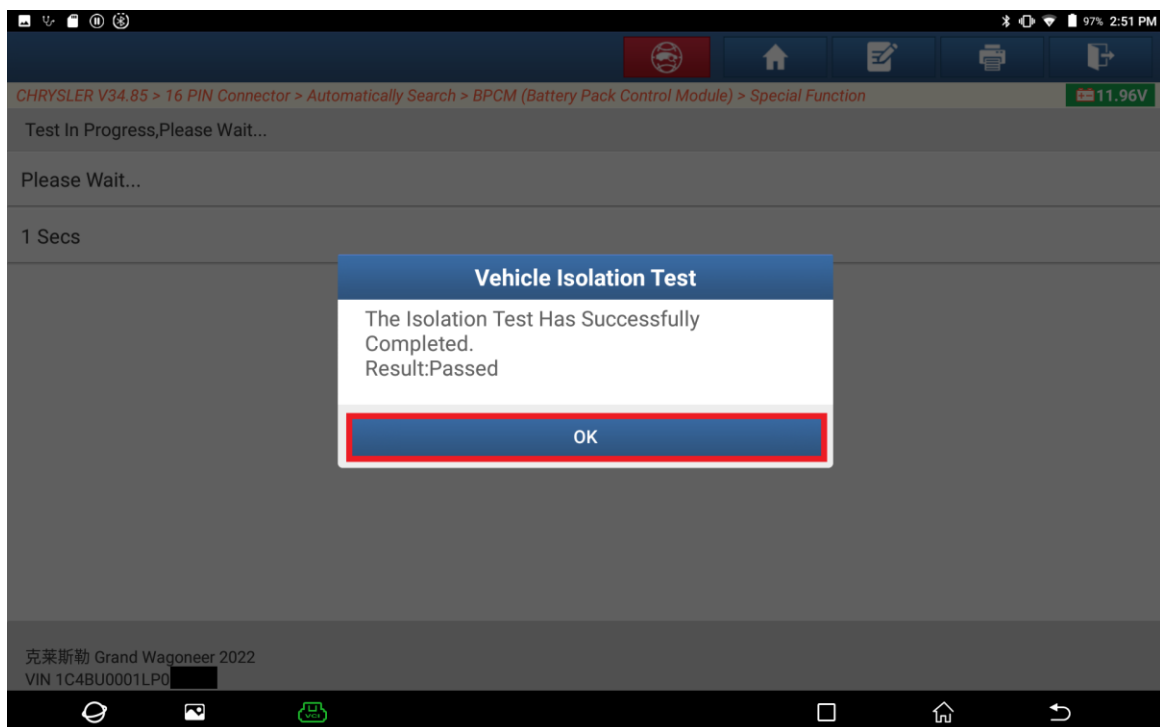

Statement:

The content of this document is copyrighted by LAUNCH TECH CO., LTD., and no individual or organization may quote or reprint it without consent.