

CHRYSLER RAM1500 Clear Steering Pull Compensation

Supported equipment: Launch's full range of comprehensive diagnostic equipment

Current equipment: PAD V

Function description: After repair is completed for CHRYSLER RAM1500, it is necessary to clear steering pull compensation.

Tested model: CHRYSLER/2019/RAM1500, VIN: 1C6SRFLT7KN8****

1. On a PAD V, choose [Local Diagnose] and then [CHRYSLER] to test.

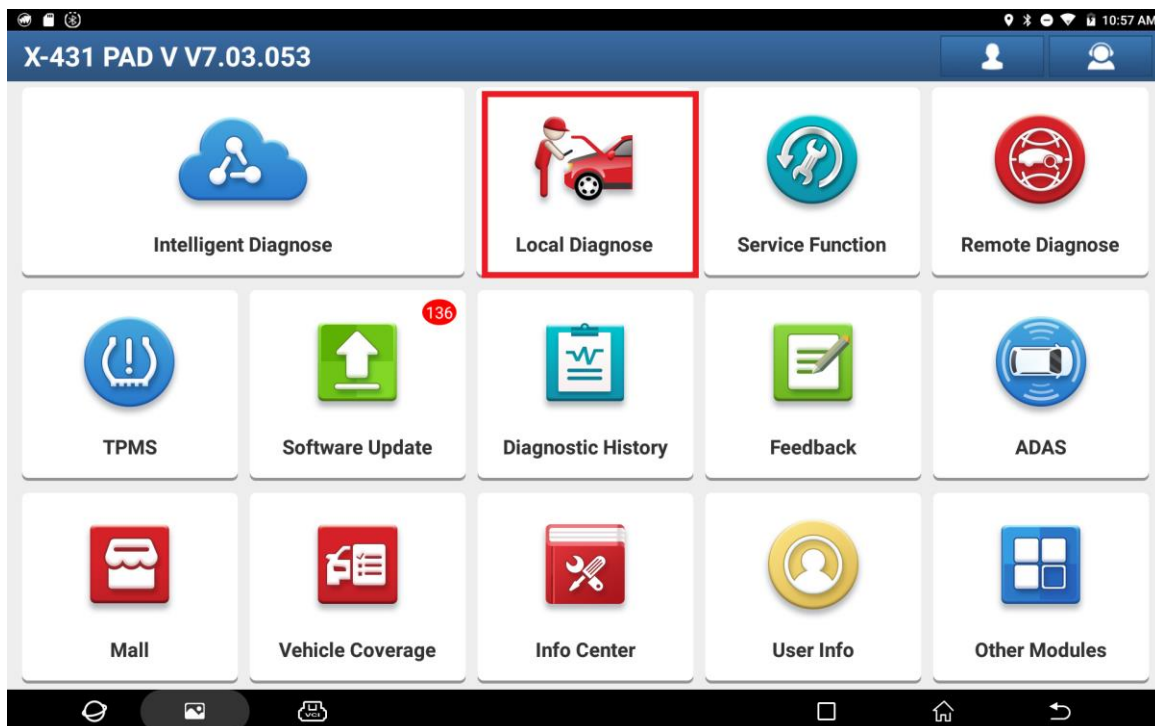

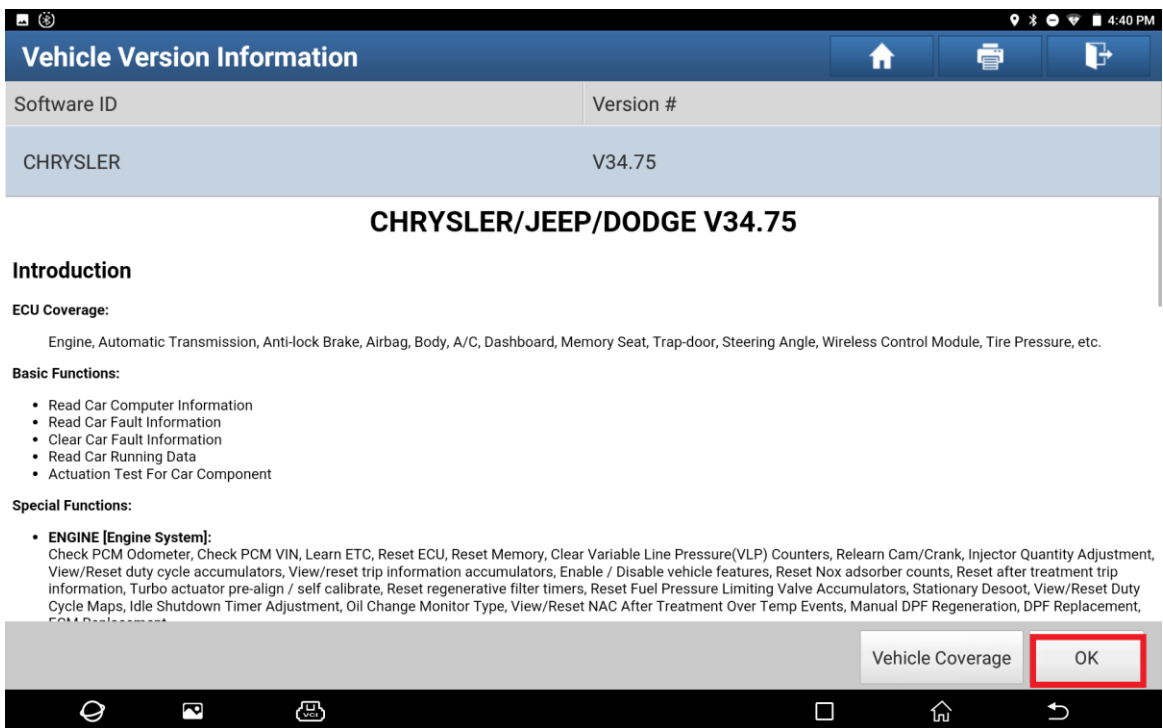
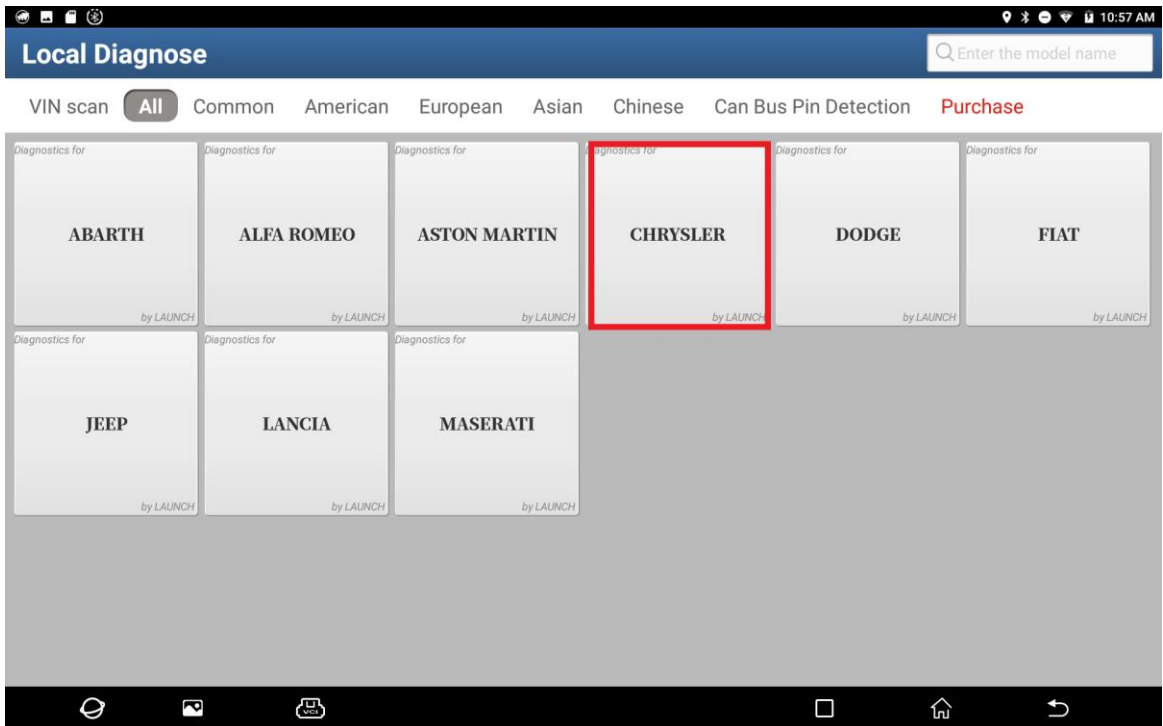

2. Click [16 PIN Connector] and choose [Automatically Search] to identify car models automatically.

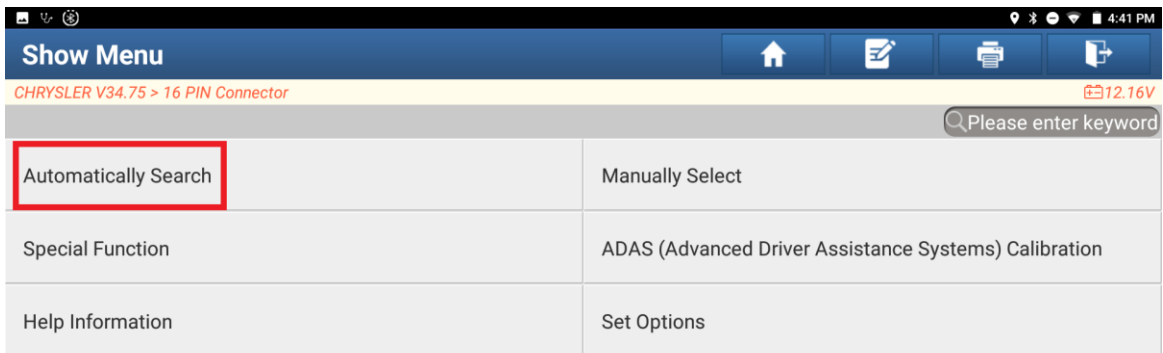
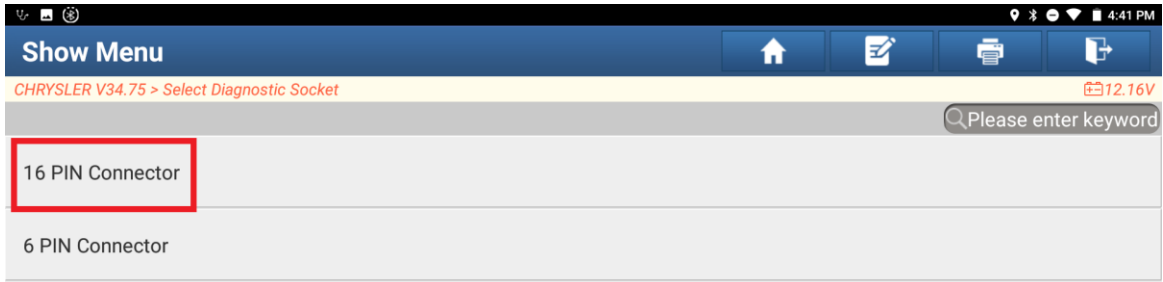

- Click OK. It displays a prompt message indicating that the SGW needs to be unlocked.

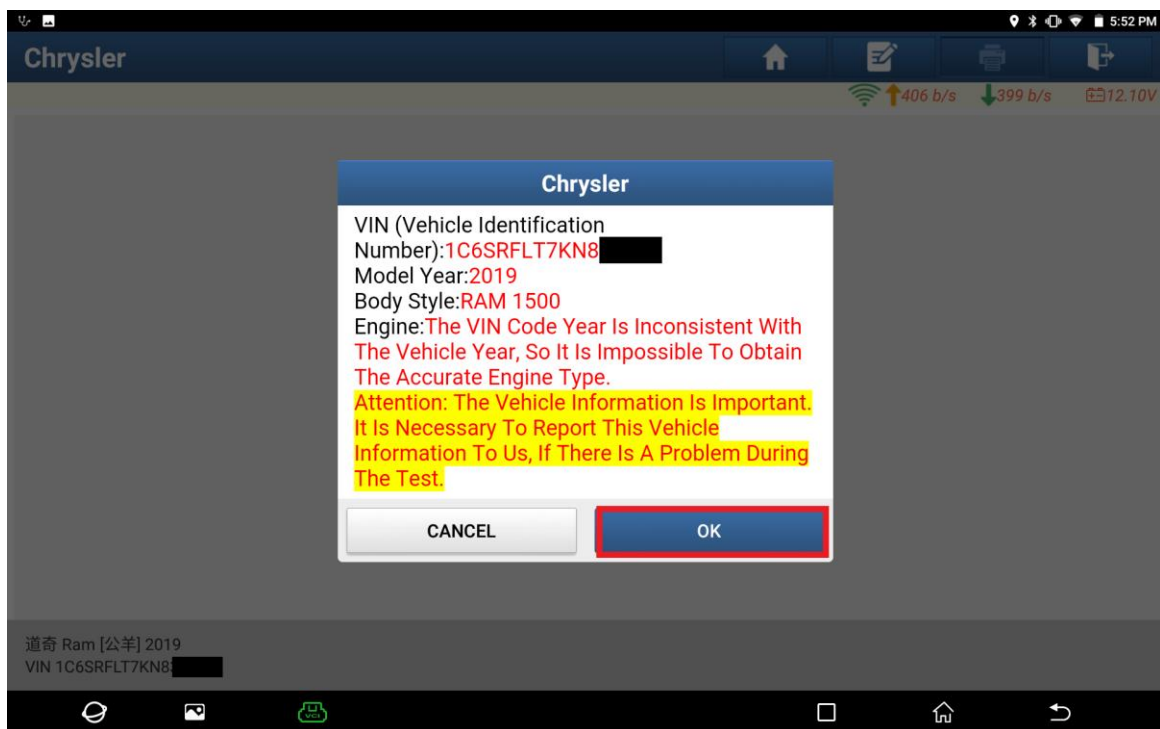
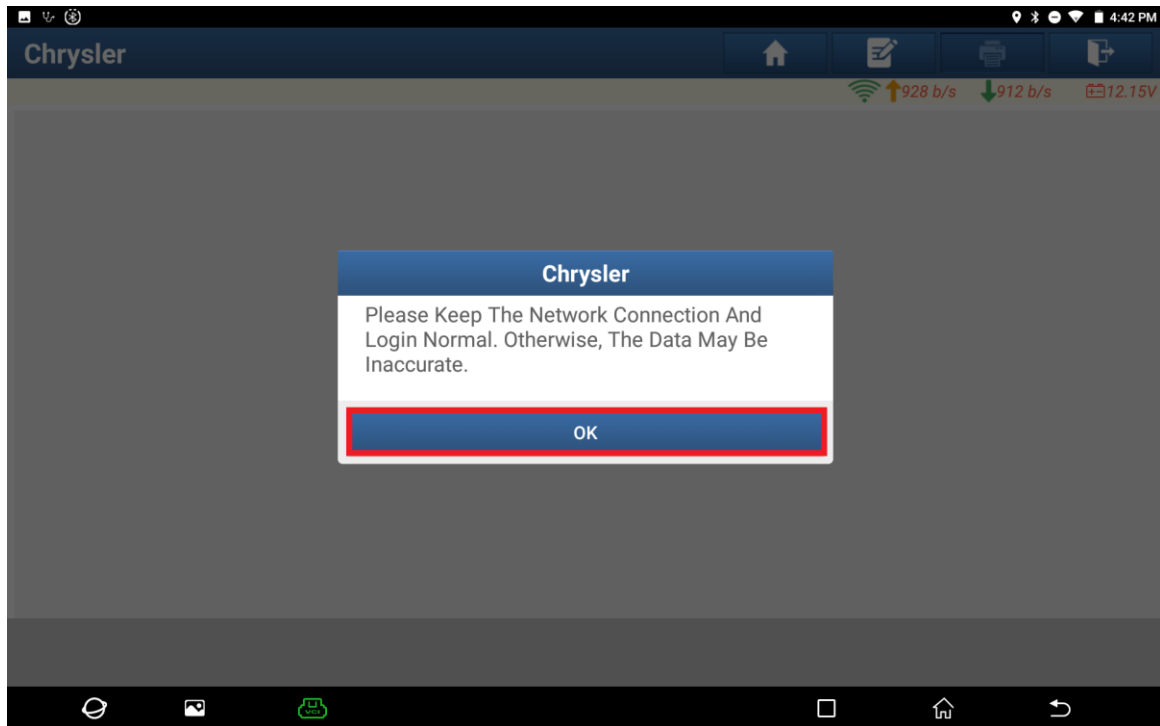

- 4. Click [Yes], choose [North America], and input the FCA account you purchased.

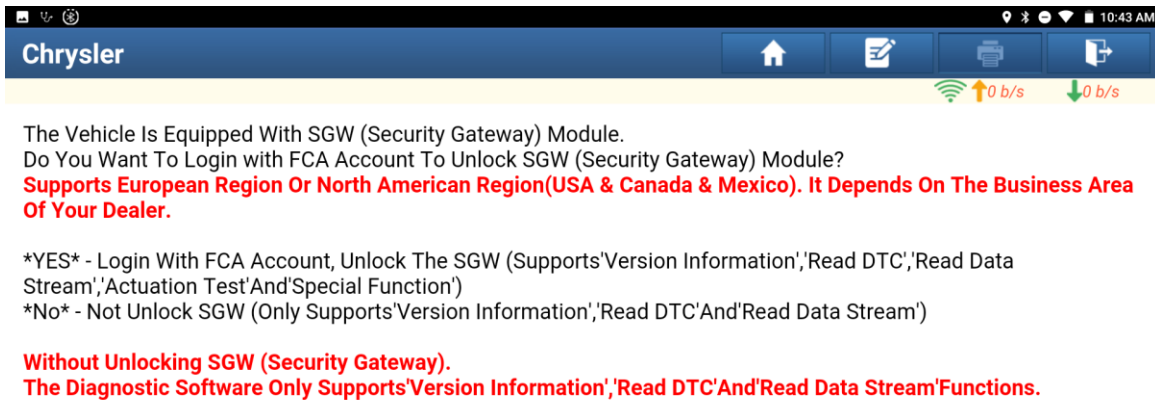

The Vehicle Is Equipped With SGW (Security Gateway) Module.
Do You Want To Login with FCA Account To Unlock SGW (Security Gateway) Module?
Supports European Region Or North American Region(USA & Canada & Mexico). It Depends On The Business Area Of Your Dealer.

YES - Login With FCA Account, Unlock The SGW (Supports'Version Information','Read DTC','Read Data Stream','Actuation Test'And'Special Function')
No - Not Unlock SGW (Only Supports'Version Information','Read DTC'And'Read Data Stream')

**Without Unlocking SGW (Security Gateway).
The Diagnostic Software Only Supports'Version Information','Read DTC'And'Read Data Stream'Functions.**

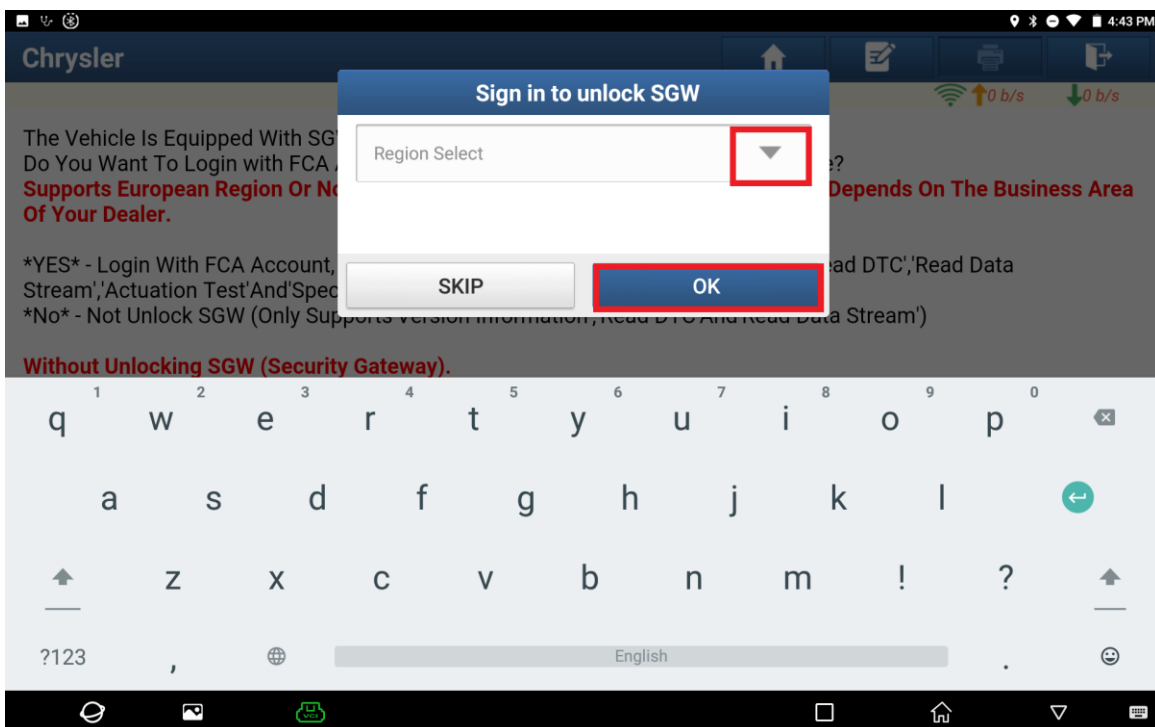
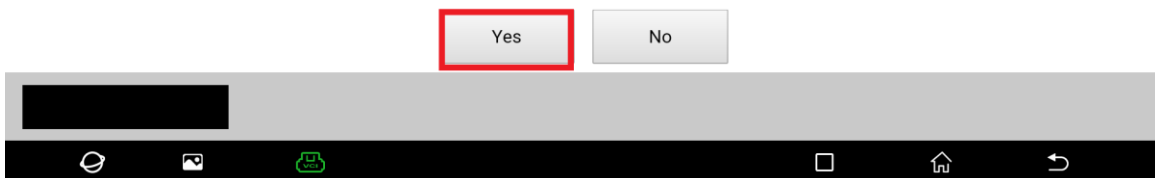

5. Click OK.

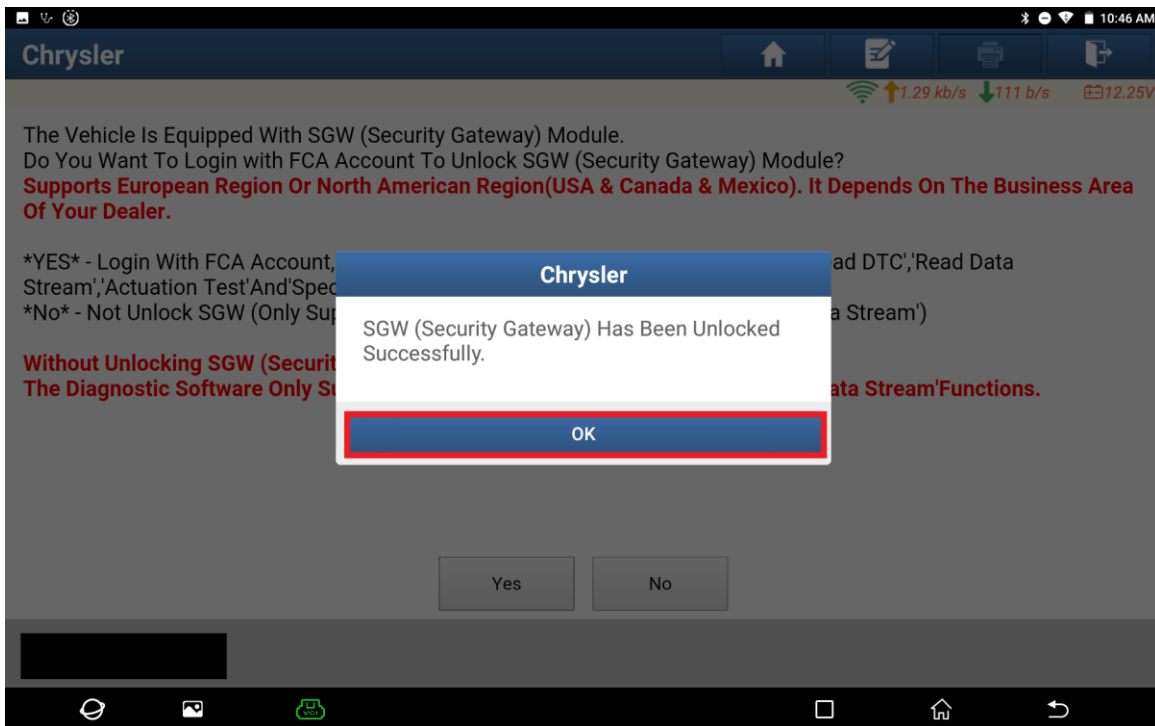
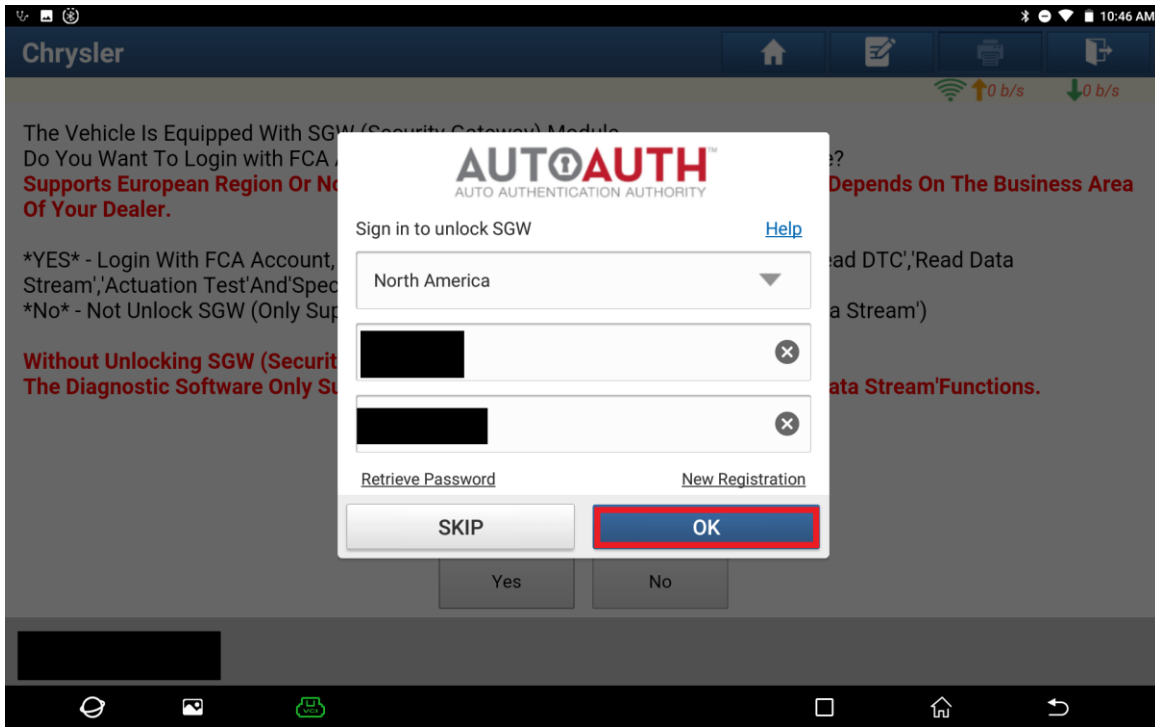

6. On the PAD V, click [Smart Detection] to scan the entire vehicle systems.

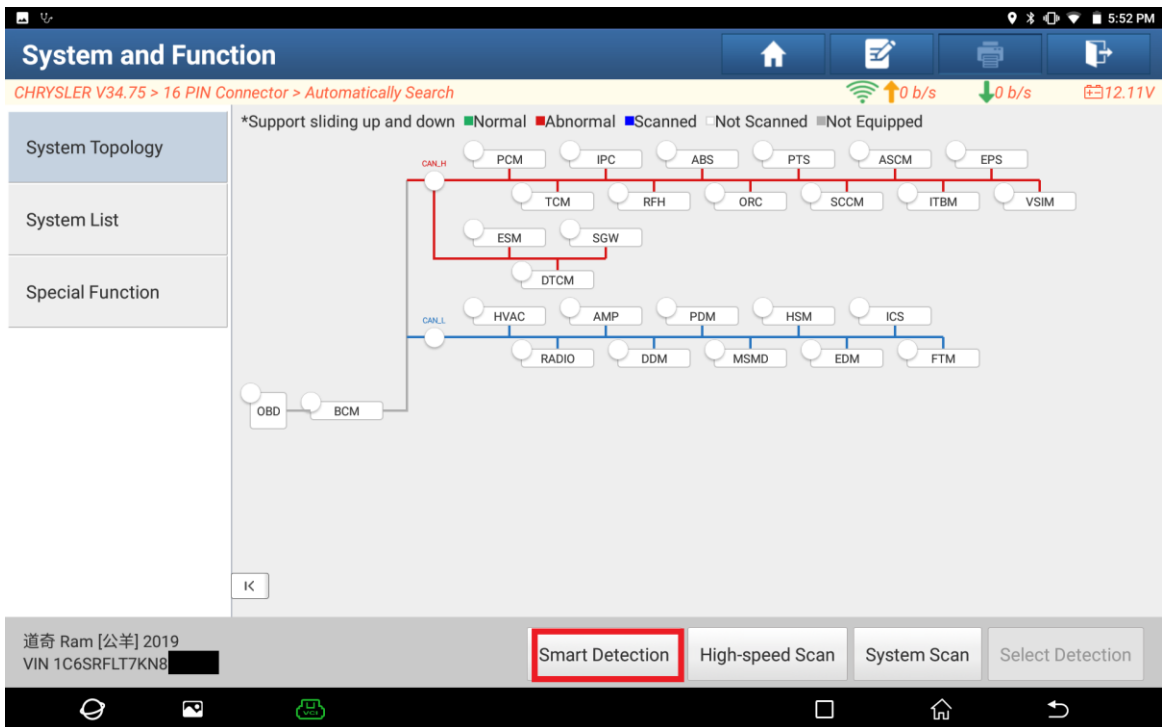

7. Click [EPS (Electronic Power Steering)] to access the system.

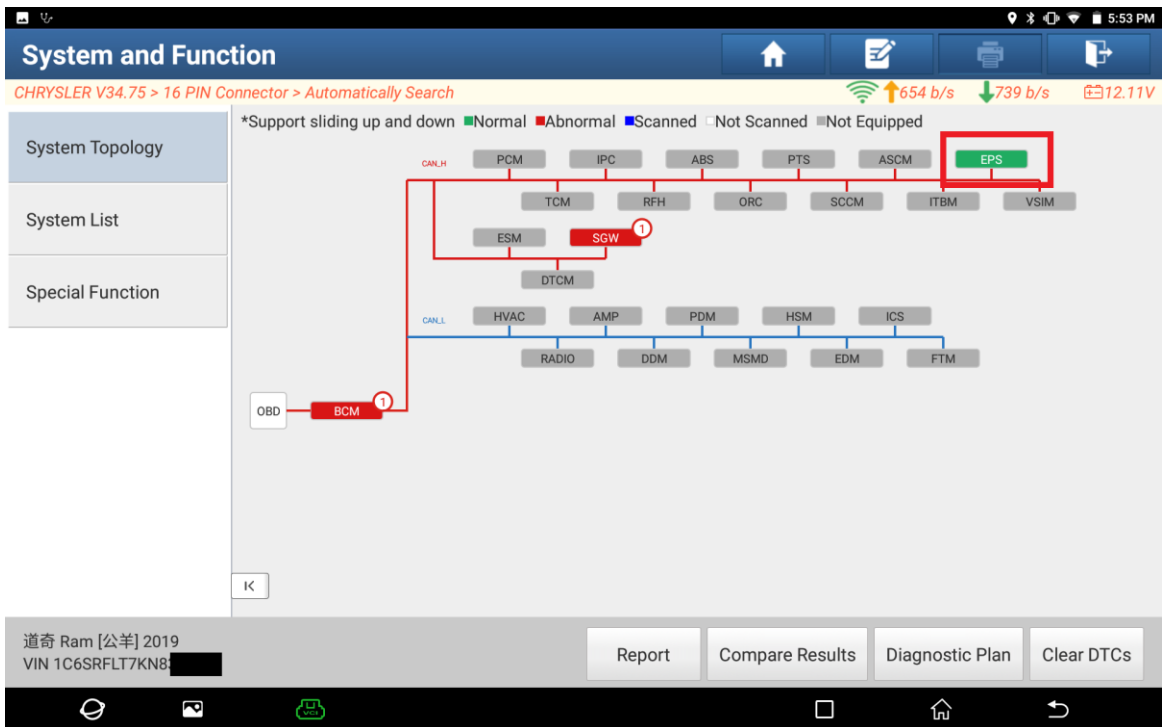

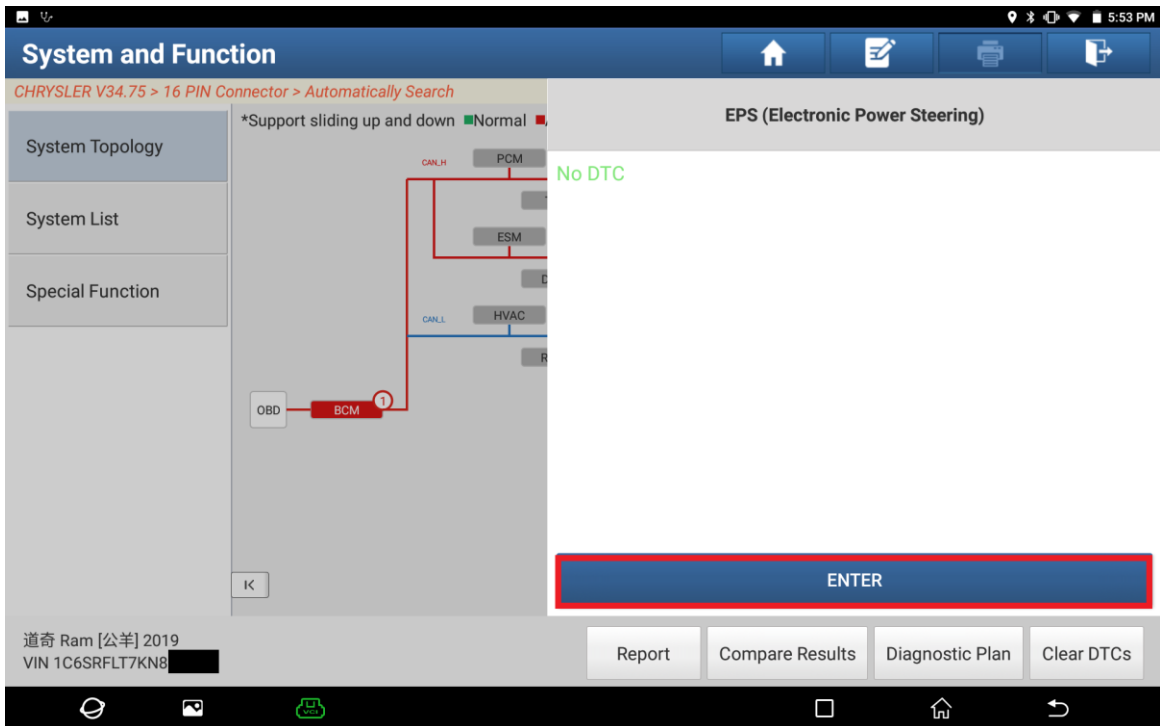

8. Click [Special Function].

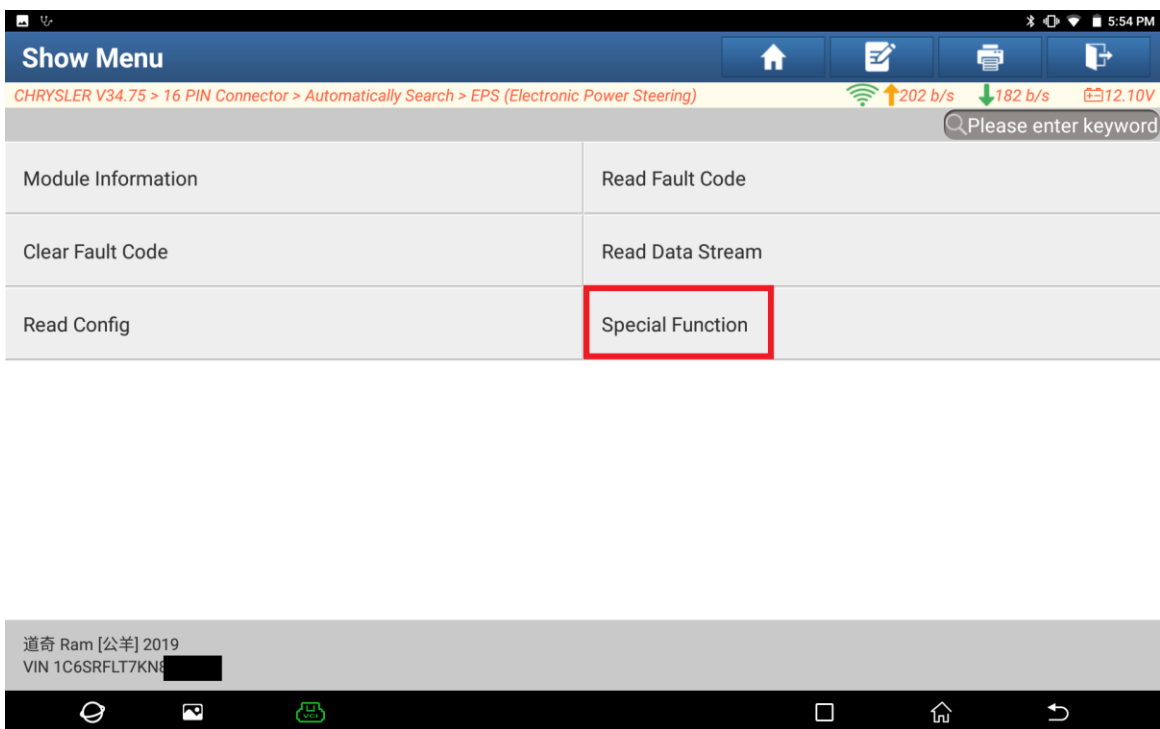

9. Click [Clear Steering Pull Compensation].

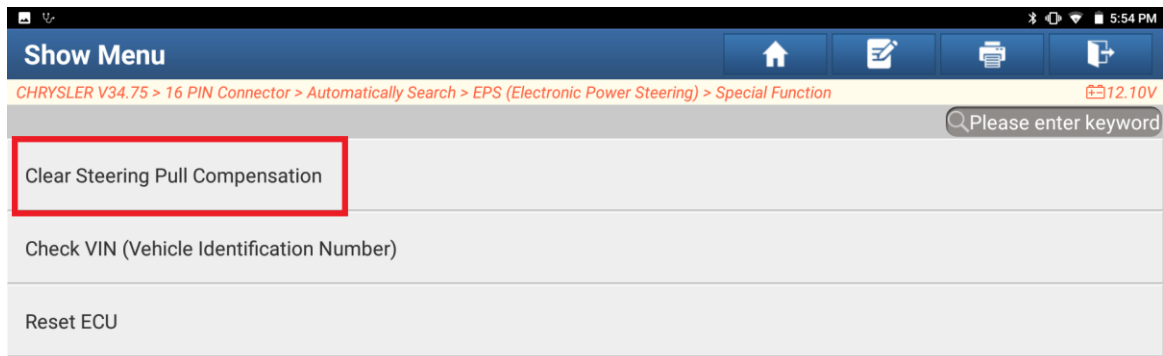

10. Click OK.

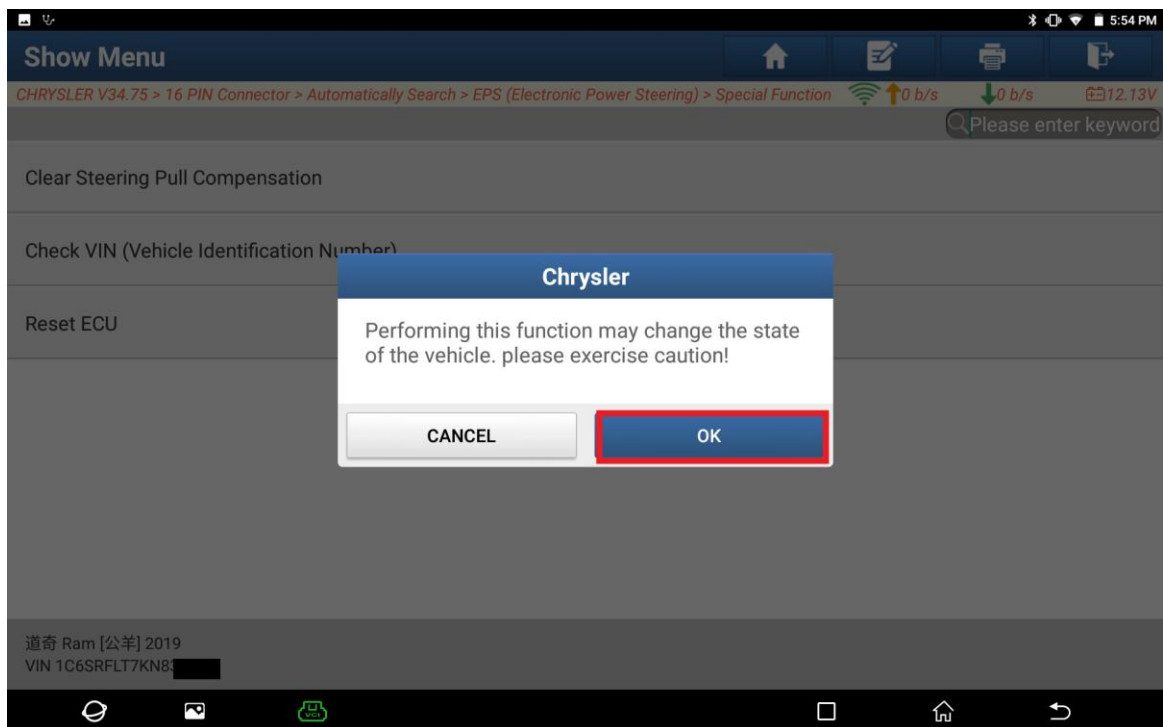

11. Click OK.

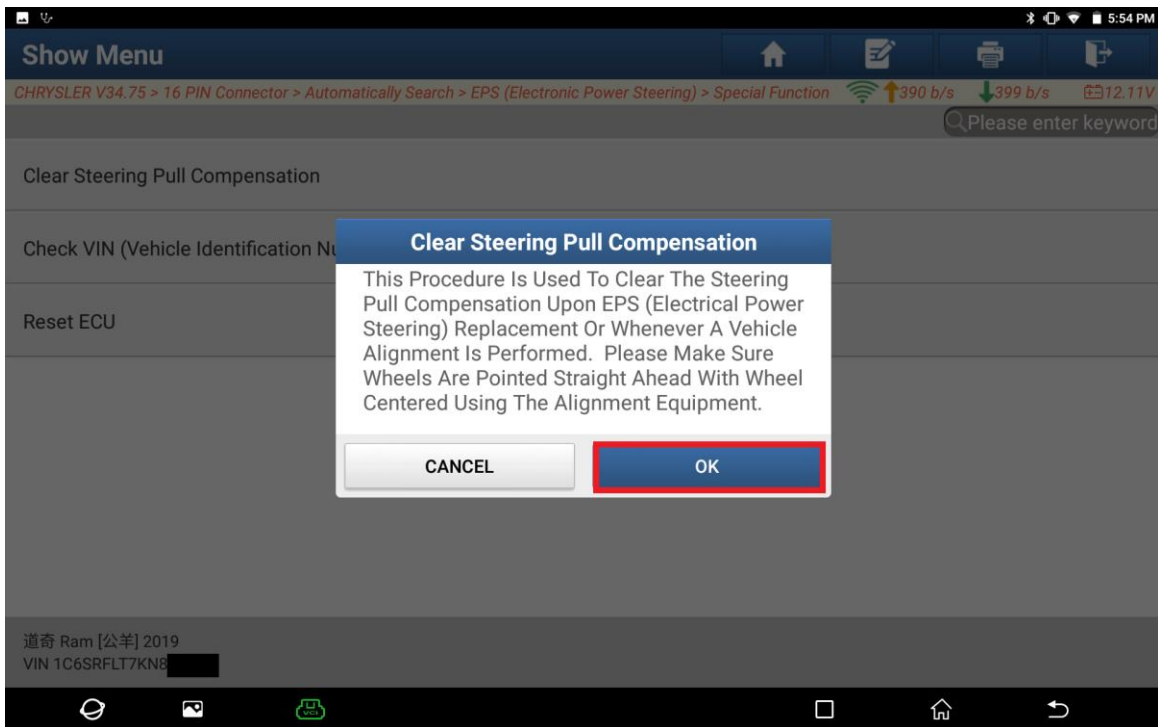

12. Click OK. The operations are completed.

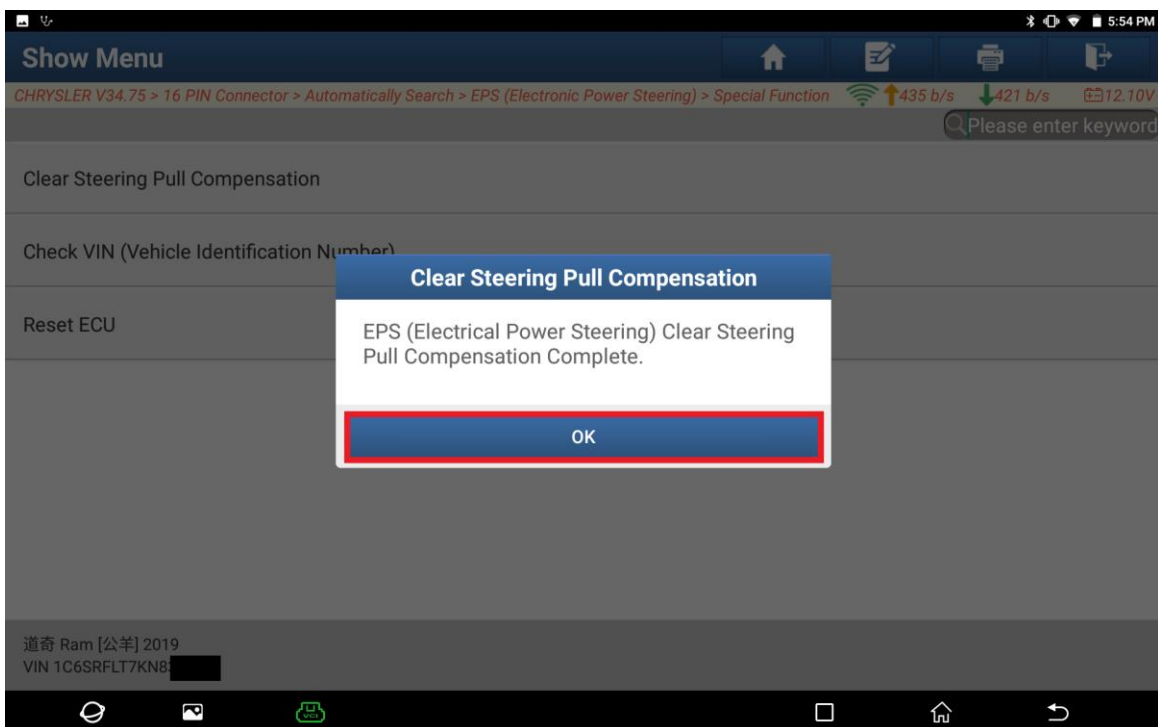

Statement:

The content of this document is copyrighted by Shenzhen Launch Tech Co., Ltd., and no individual or organization may quote or reprint it without consent.