

# FIAT TALENTO/TANGO Particulate Filter Regeneration Method

**Supported equipment:** Launch's full range of comprehensive diagnostic equipment

**Current equipment:** PAD V

**Function description:** When the particulate filter regeneration is required for FIAT or the GPF DTC (P2463, P243F or P24A4) exists in the fault memory, this procedure must be performed.

**Tested models:** 2016/Fiat/TALENTO(TANGO), VIN:  
ZFAFFL007J50\*\*\*\*\*

1. On a PAD V, choose [Local Diagnose] and then [FIAT] to test.

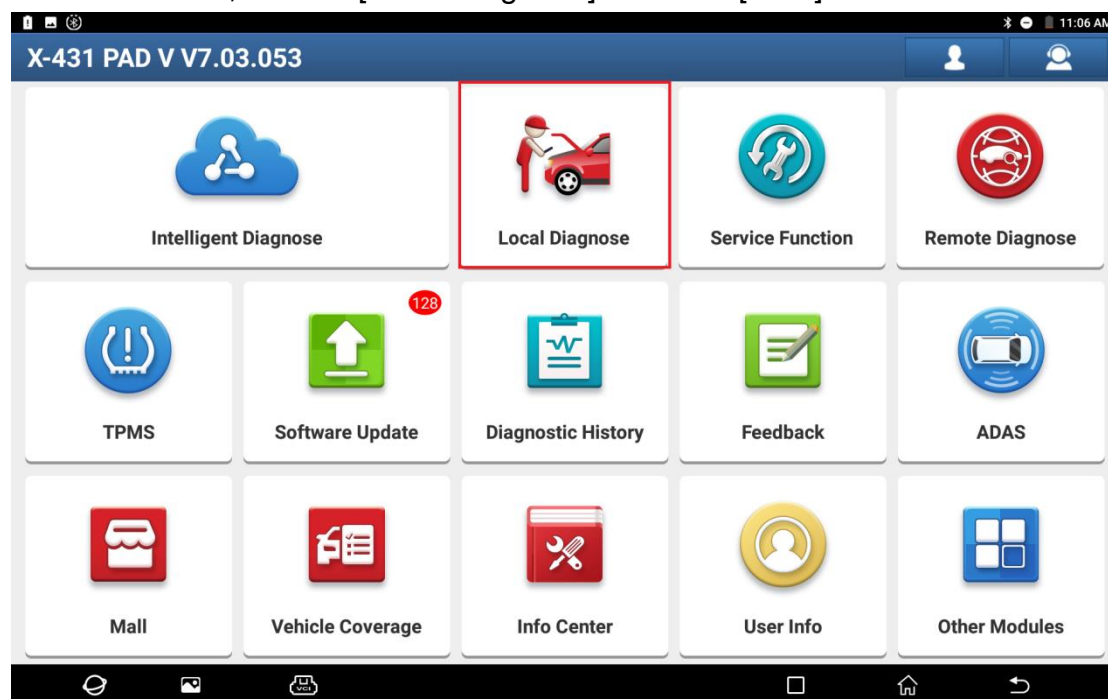

Local Diagnose

VIN scan **All** Common American European Asian Chinese Can Bus Pin Detection Purchase

Diagnosics for <b>ABARTH</b> <small>by LAUNCH</small>	Diagnosics for <b>ALFA ROMEO</b> <small>by LAUNCH</small>	Diagnosics for <b>DODGE</b> <small>by LAUNCH</small>	Diagnosics for <b>JEEP</b> <small>by LAUNCH</small>	Diagnosics for <b>LANCIA</b> <small>by LAUNCH</small>	Diagnosics for <b>MASERATI</b> <small>by LAUNCH</small>
Diagnosics for <b>CADILLAC (CHINA)</b> <small>by LAUNCH</small>	Diagnosics for <b>BUICK (CHINA)</b> <small>by LAUNCH</small>	Diagnosics for <b>SGM</b> <small>by LAUNCH</small>	Diagnosics for <b>CHEVROLET (CHINA)</b> <small>by LAUNCH</small>	Diagnosics for <b>CHRYSLER</b> <small>by LAUNCH</small>	Diagnosics for <b>CADILLAC</b> <small>by LAUNCH</small>
Diagnosics for <b>BUICK</b> <small>by LAUNCH</small>	Diagnosics for <b>OPEL</b> <small>by LAUNCH</small>	Diagnosics for <b>ECUAID</b> <small>by LAUNCH</small>	Diagnosics for <b>FIAT</b> <small>by LAUNCH</small>	Diagnosics for <b>GM</b> <small>by LAUNCH</small>	Diagnosics for <b>ASTON MARTIN</b> <small>by LAUNCH</small>

Vehicle Version Information

Software ID	Version #
FIAT	V38.30

### FIAT V38.30

#### Introduction

**ECU Coverage:**

This Software Diagnoses All FIAT Series ECUs, Including Engine, AT, ABS, SRS, A/C, Instrument, Power Steering, Body PC, Door Control, Tire Pressure Control, Parking Control And Headlamp, Etc.

(The Following Models Covered Are Only For Reference And Will Vary Constantly With The Upgrades Of Software.)

**Basic Functions Include:**

- Reading ECU Information
- Reading DTCs
- Clearing DTCs
- Reading Vehicle Running Data
- Vehicle component Operation Test

**Special functions include:**

- Key Programming([Body Module])
- Tire Pressure detection([Body Module]/[Tire Pressure Control])
- Reset Adaption

Vehicle Coverage

- 2. Choose [Automatically Search] to identify car models automatically. After the car model is successfully identified, choose OK.

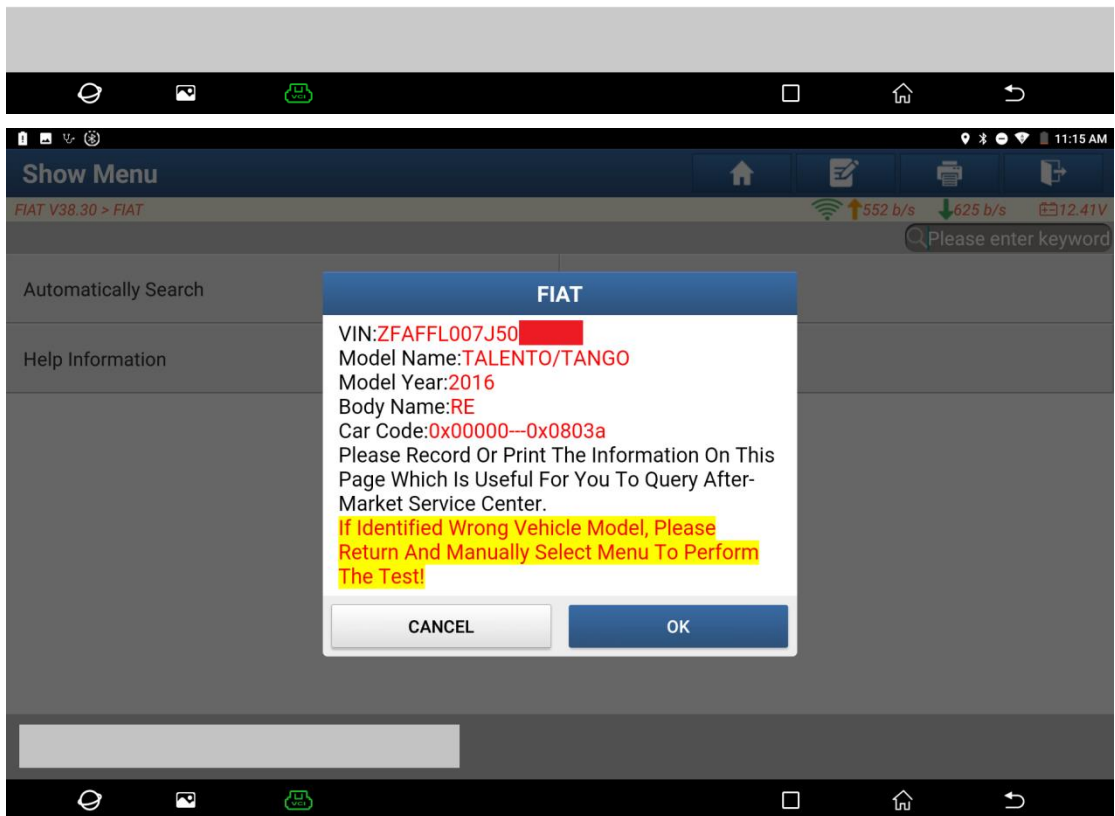
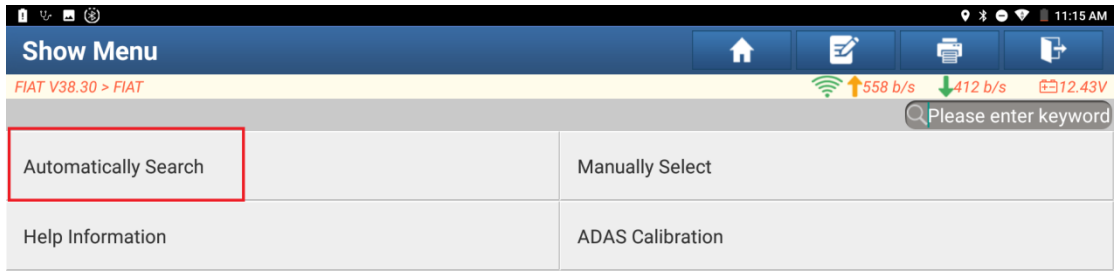

3. Choose [Yes] to unlock the SGW.

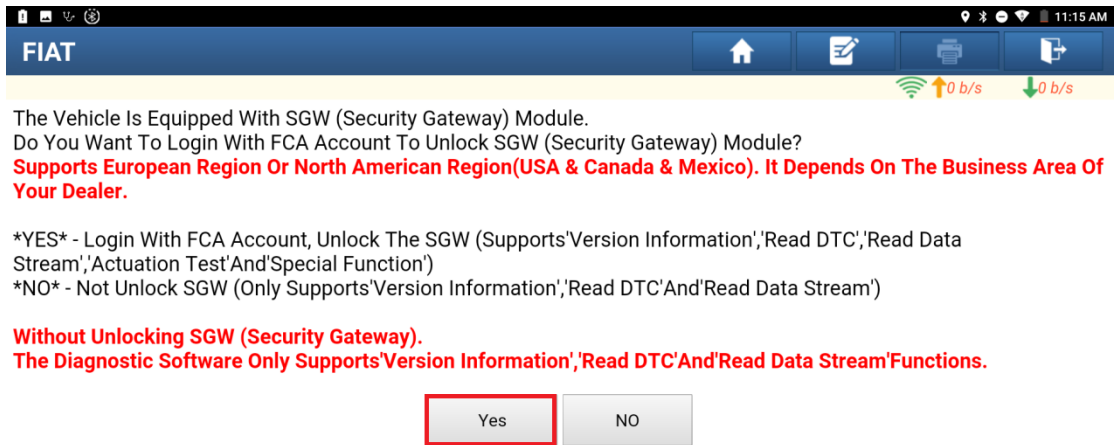

4. Choose [North America] for the region.

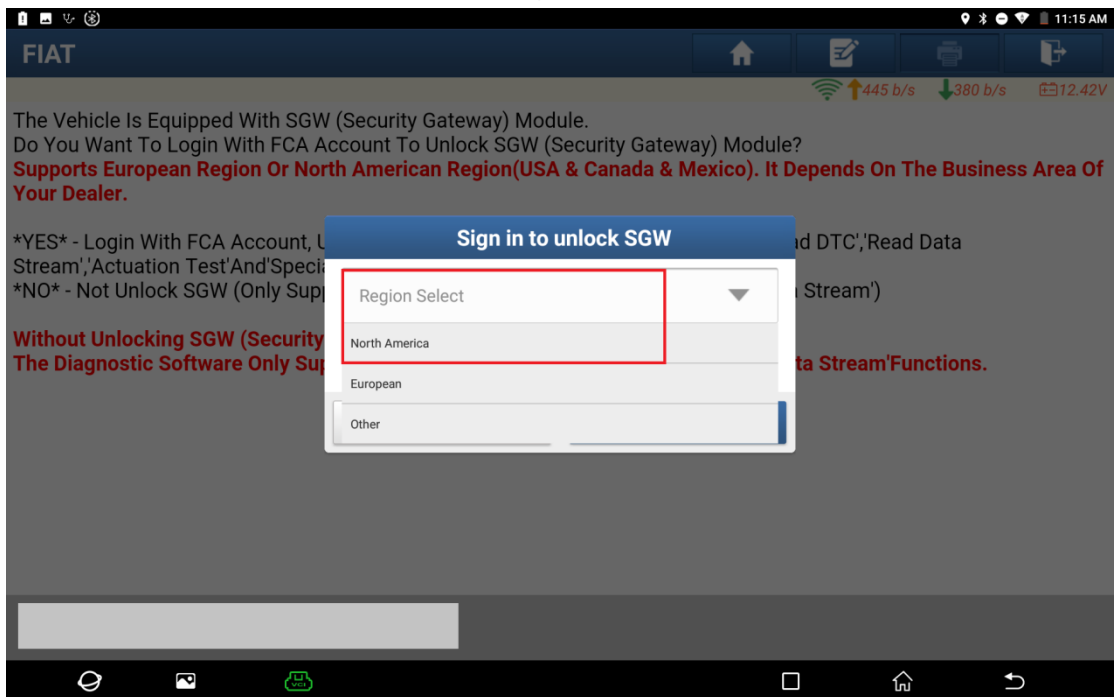

5. Input the login user name and password, and click OK.

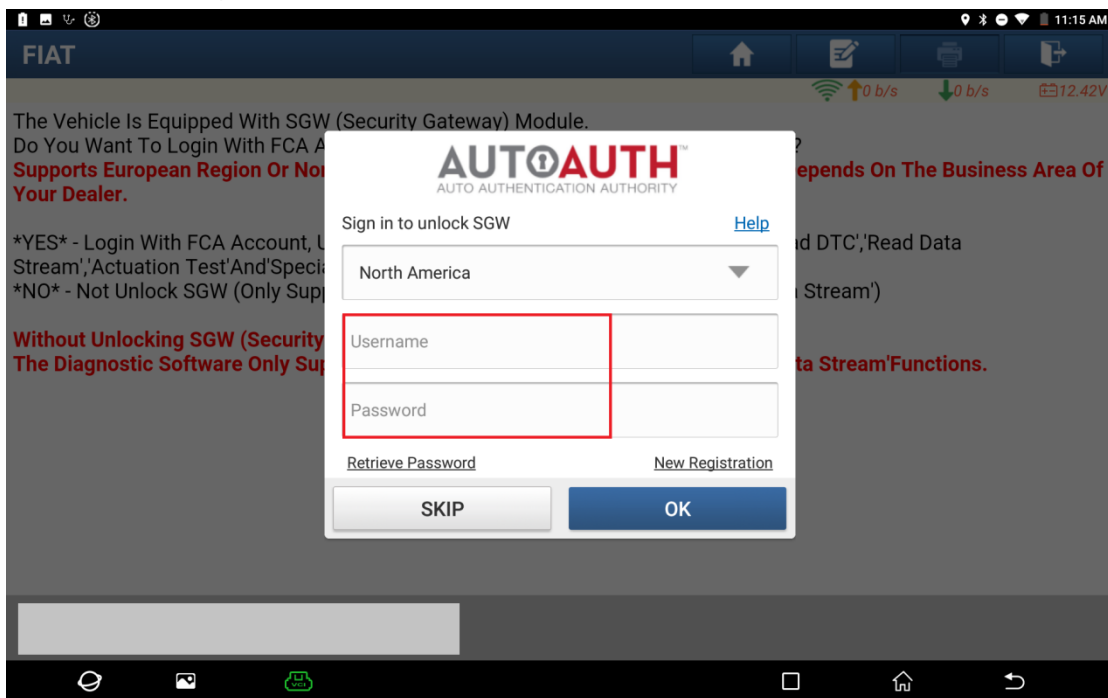

6. Unlocking is successful. Click OK.

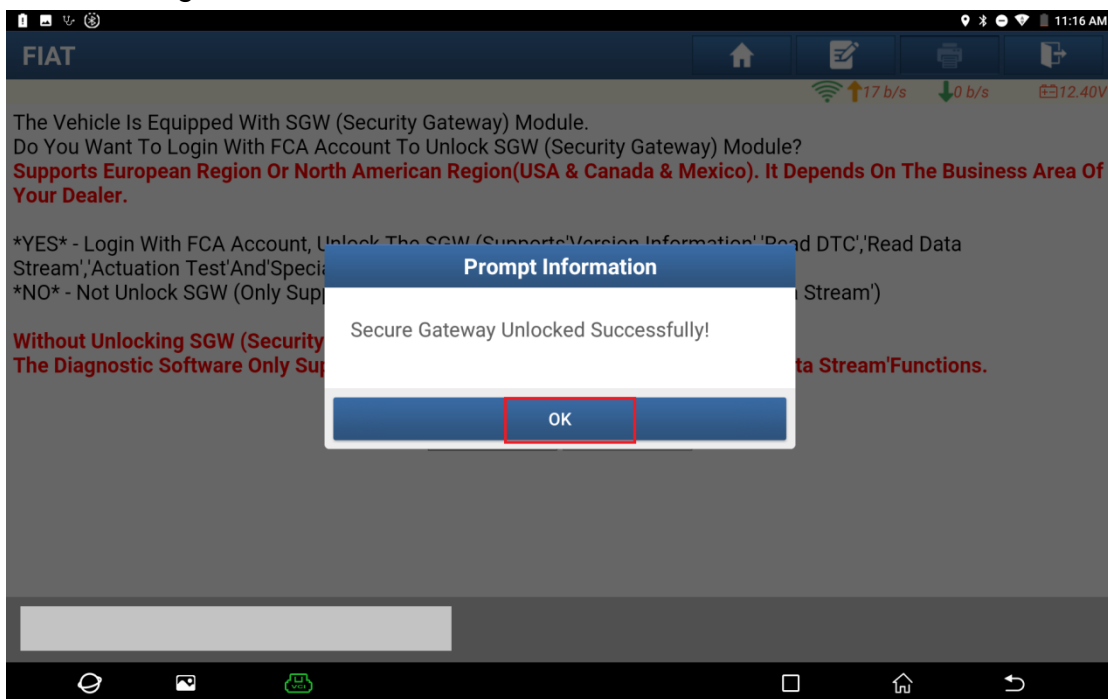

7. Click [Smart Detection] to scan the entire vehicle systems.

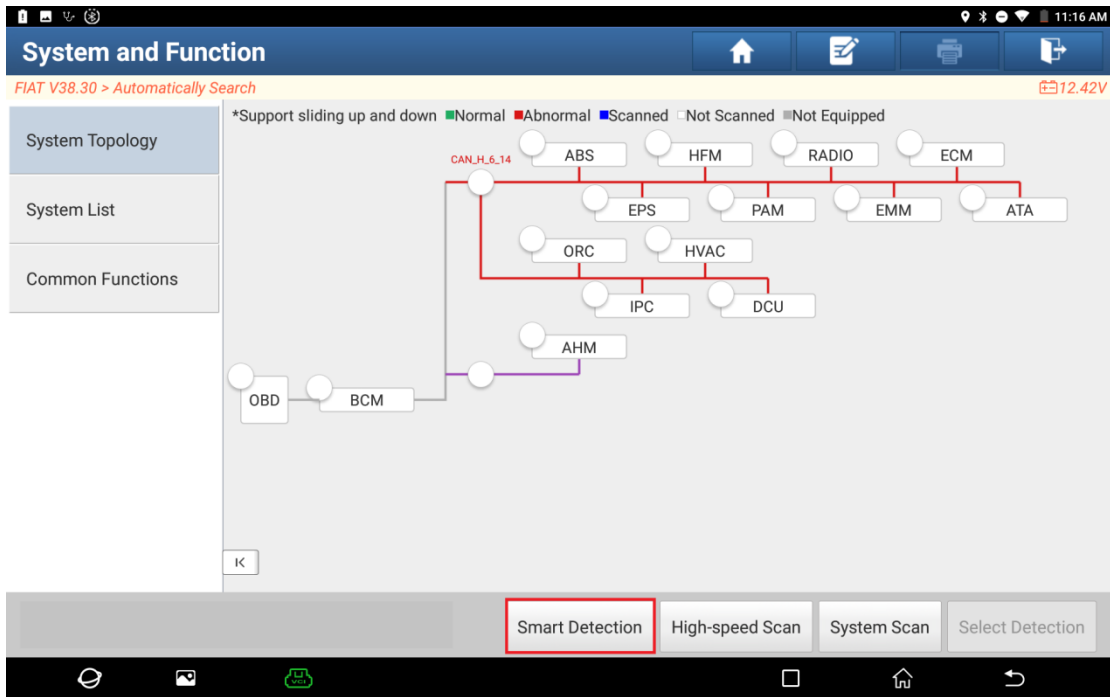

8. Click [ECM (Engine Control Module)] to access the system.

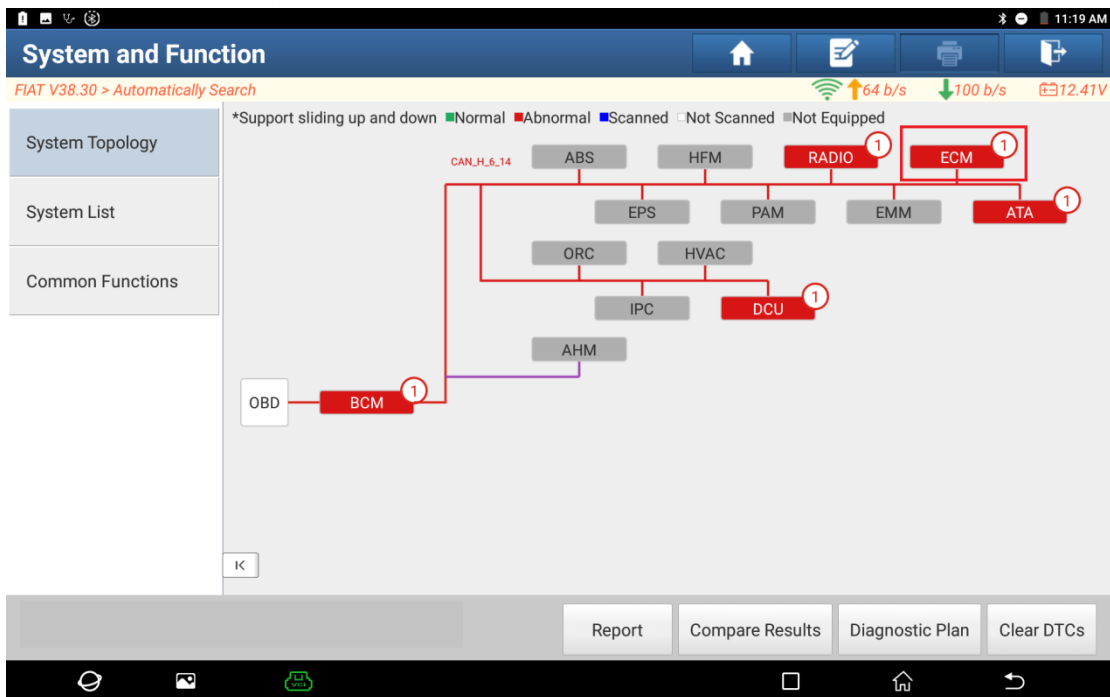

9. Click [Special Function] and click OK.

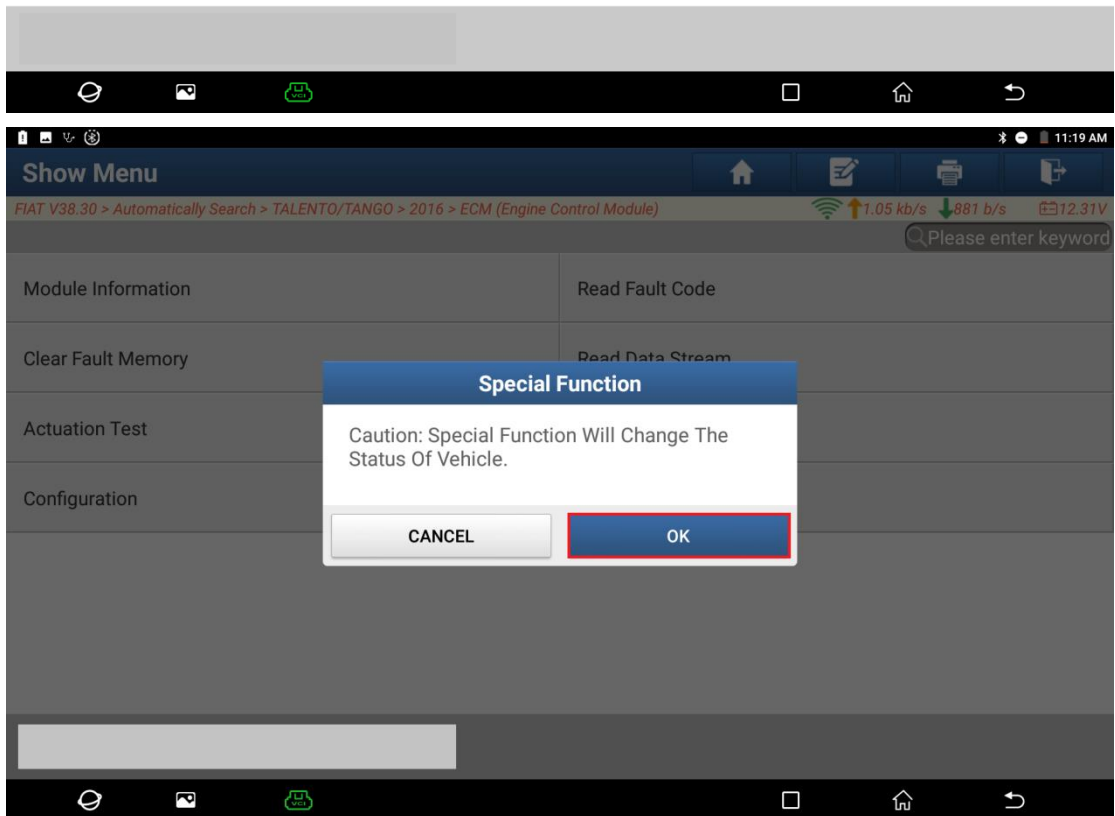
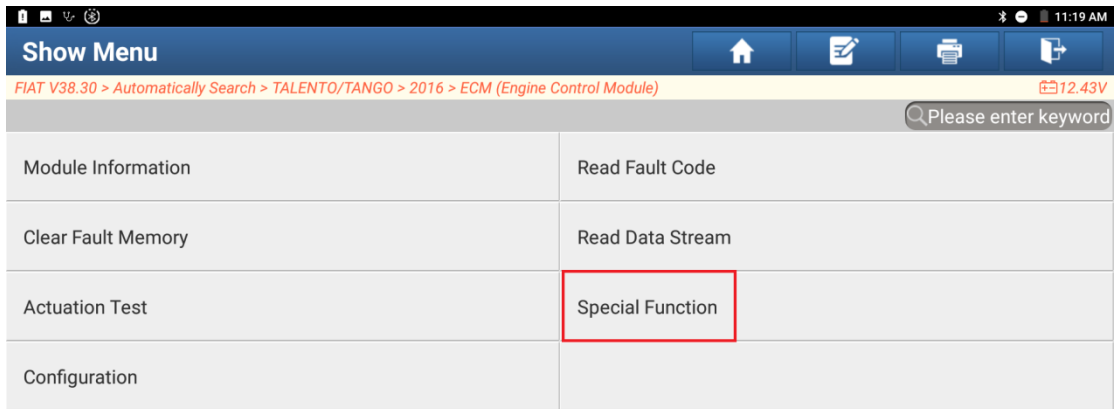

10. Choose [Misc Function].

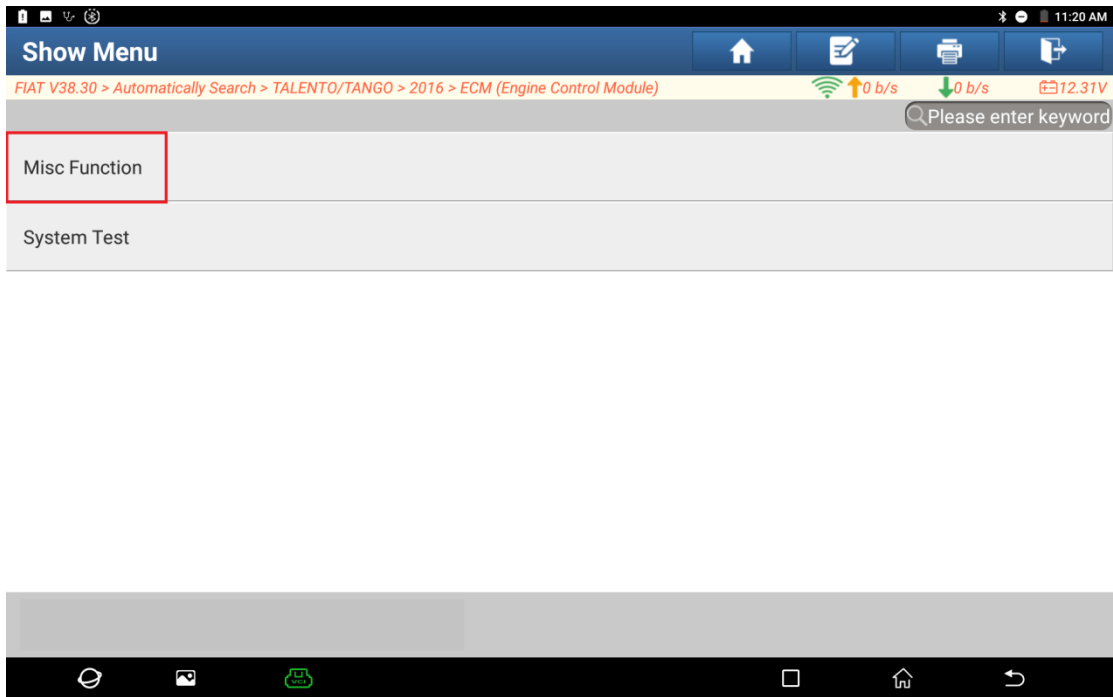

11. Choose [Particulate Filter Regeneration].

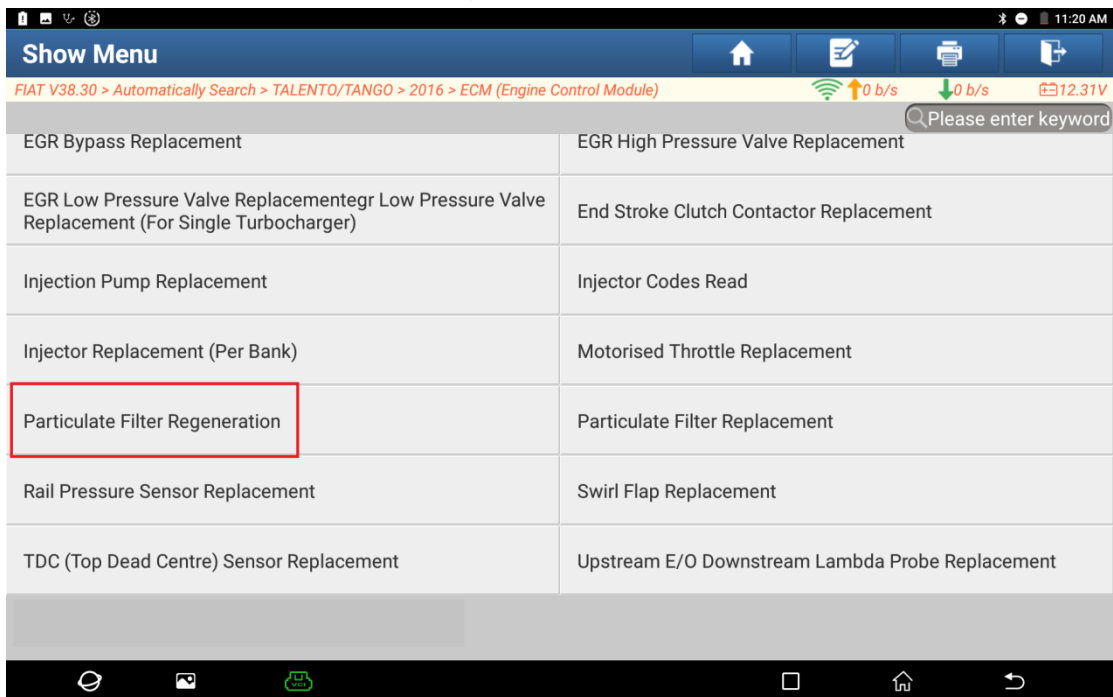



12. Click OK.

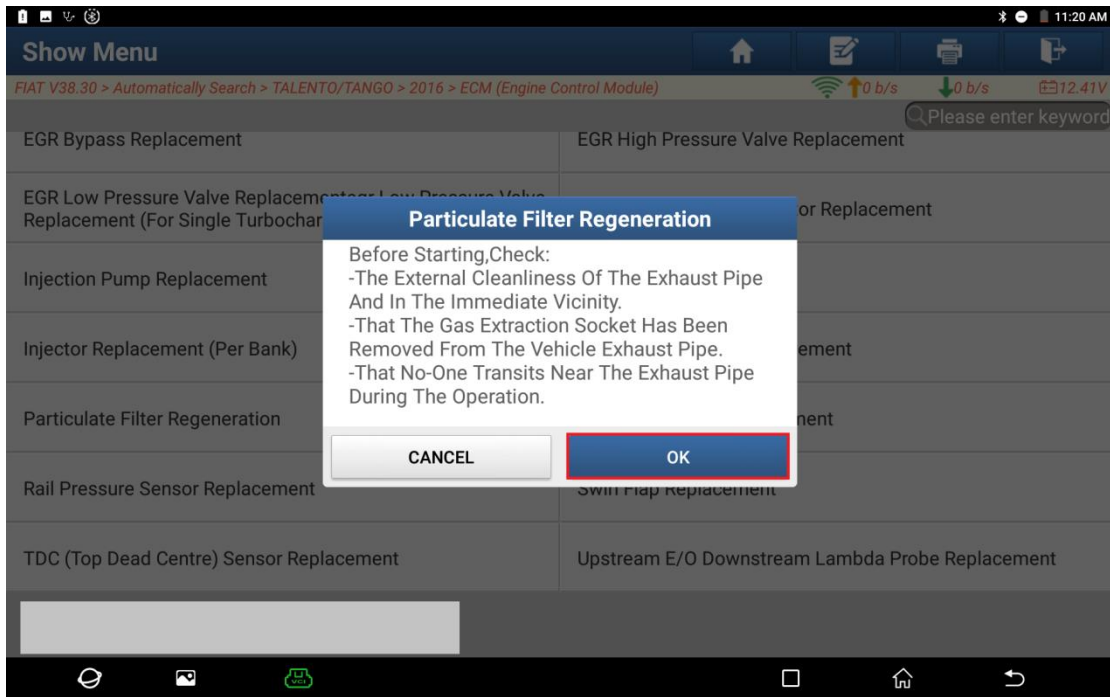

13. Click OK.

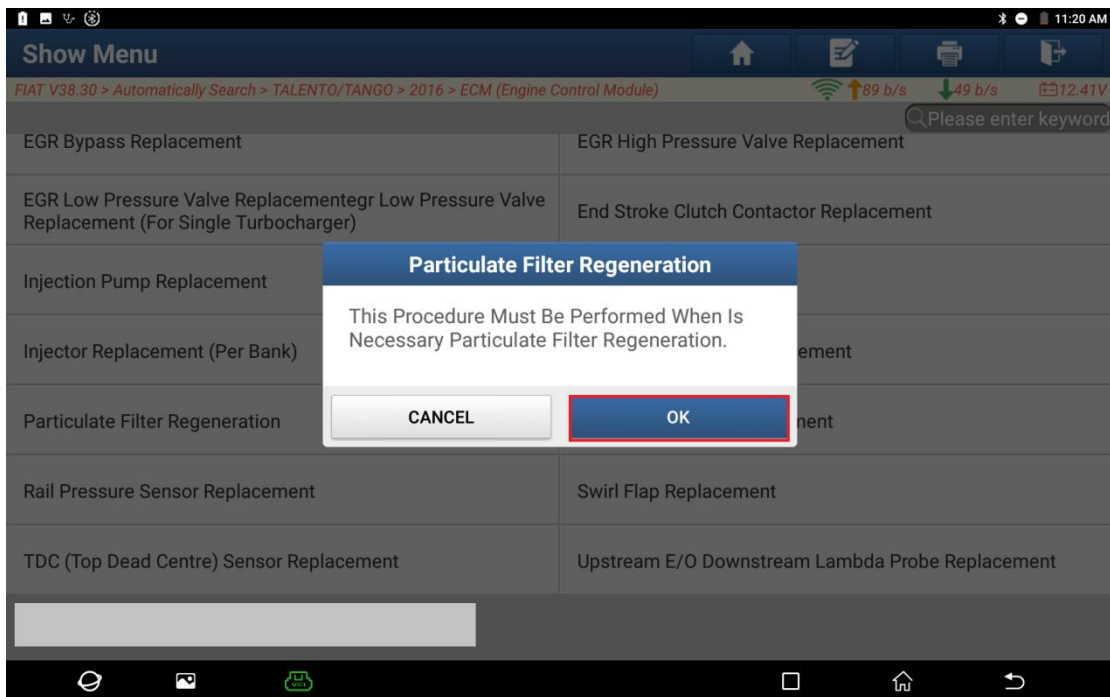

14. Click OK.

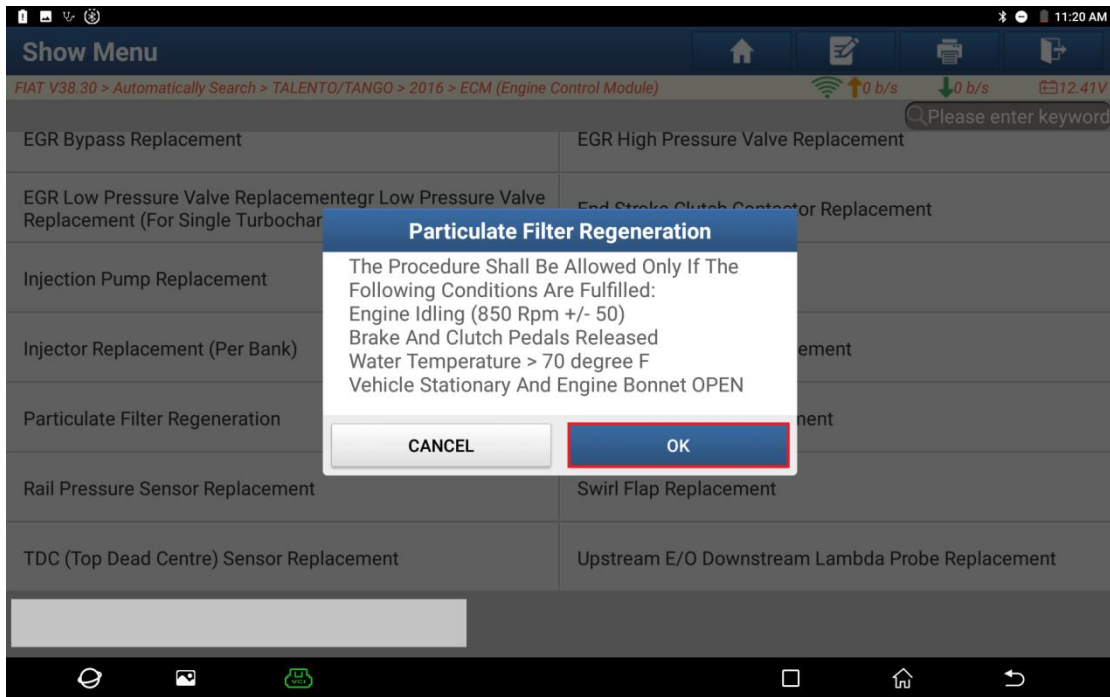

15. Click OK.

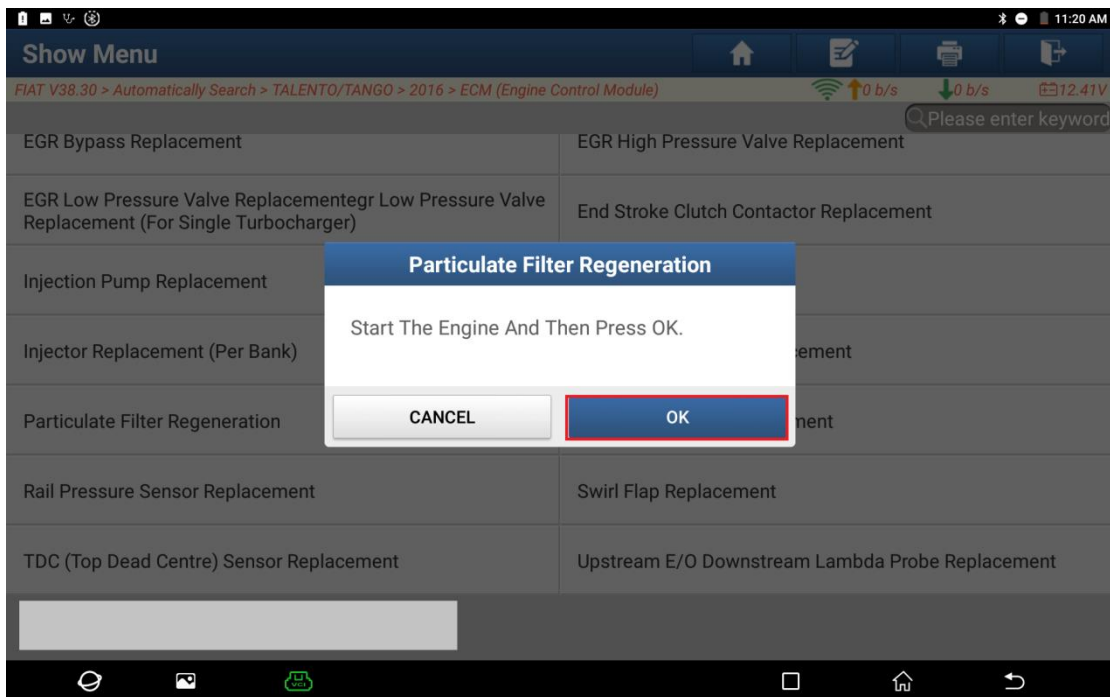

16. Click OK.

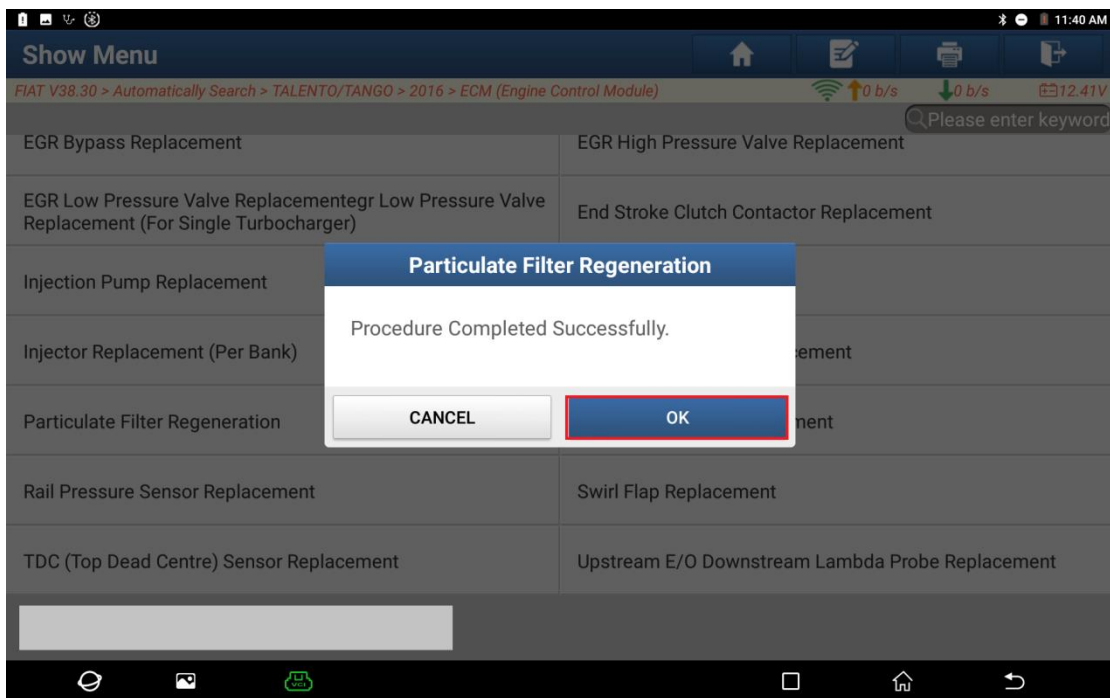

17. Click OK.

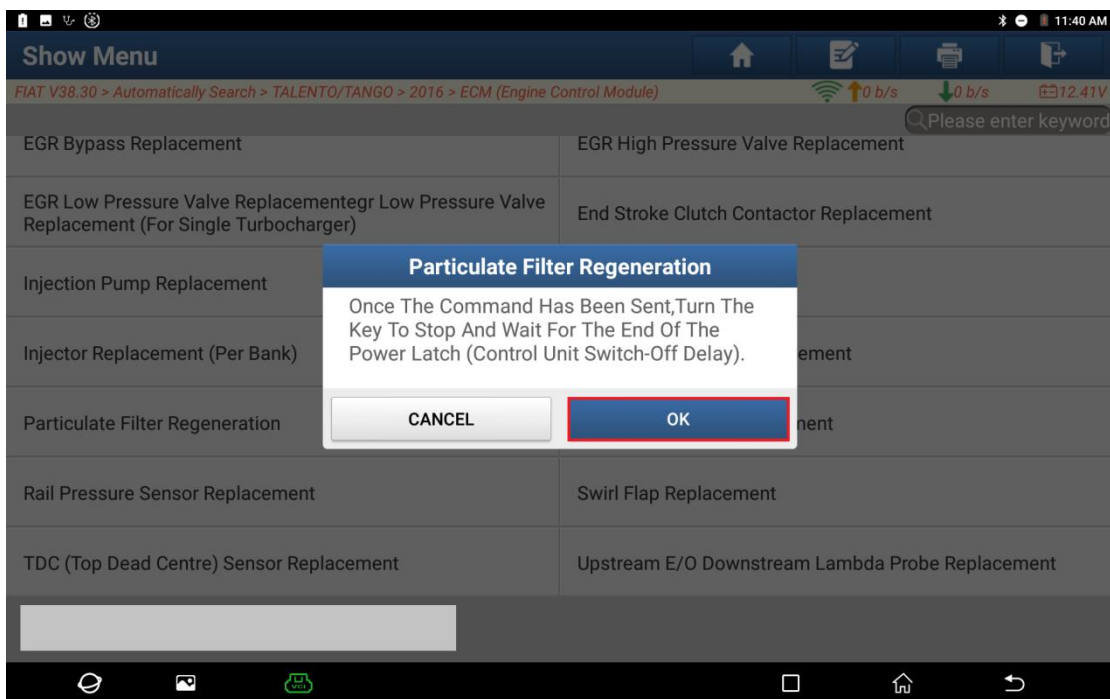

18. Click OK.

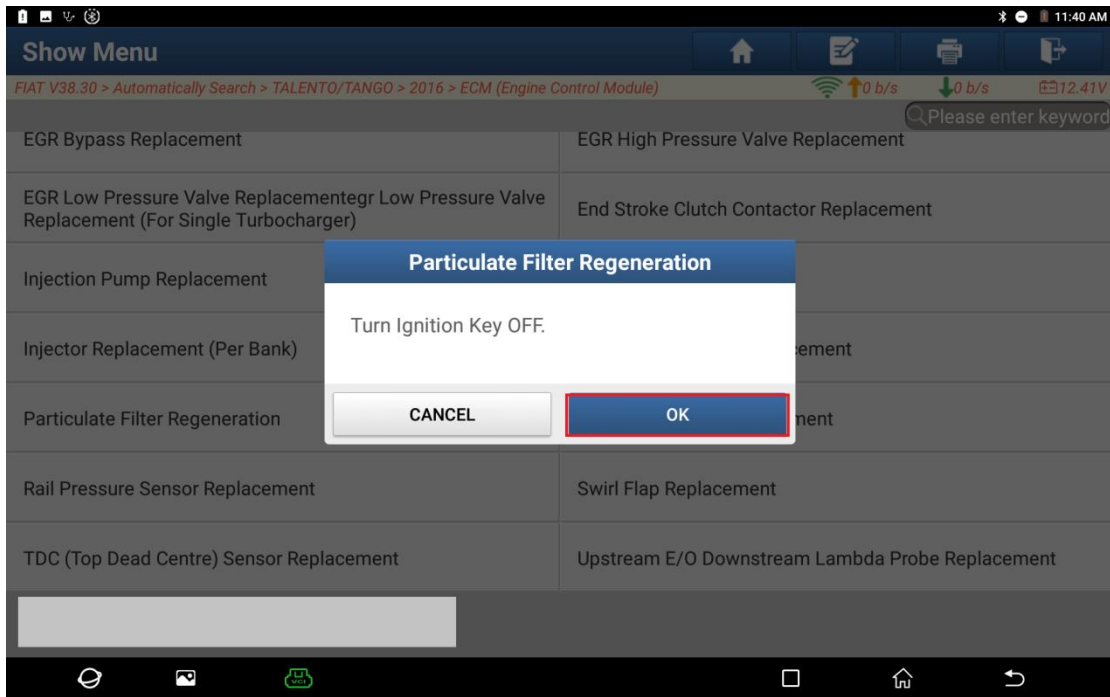

19. Wait for the countdown to end.

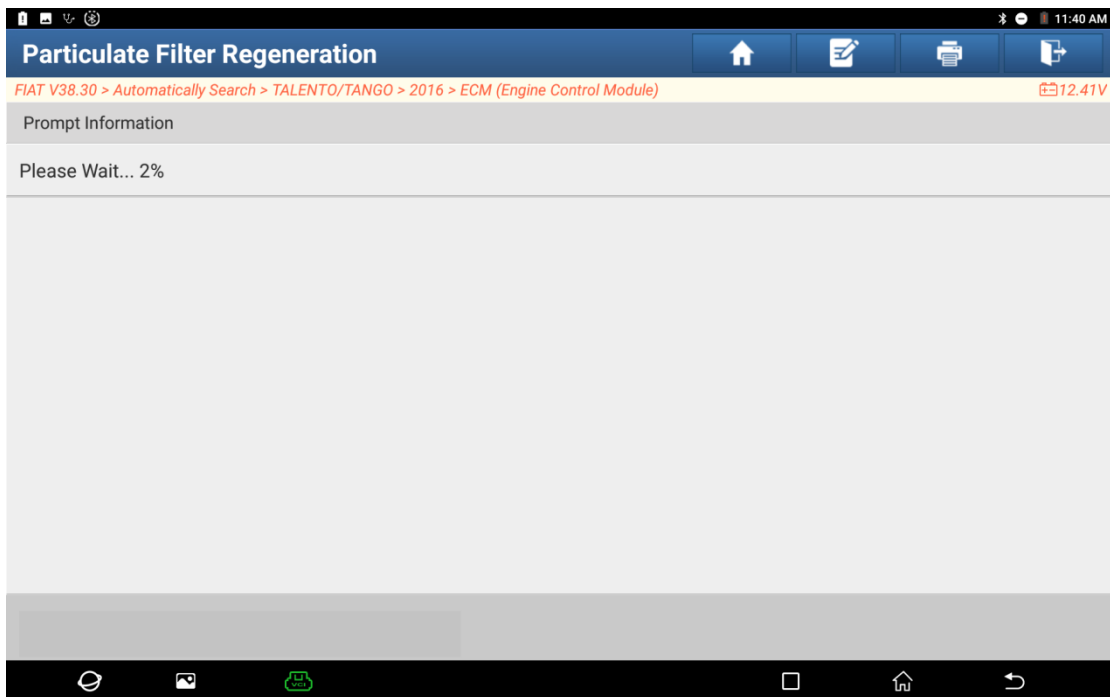

20. Click OK.

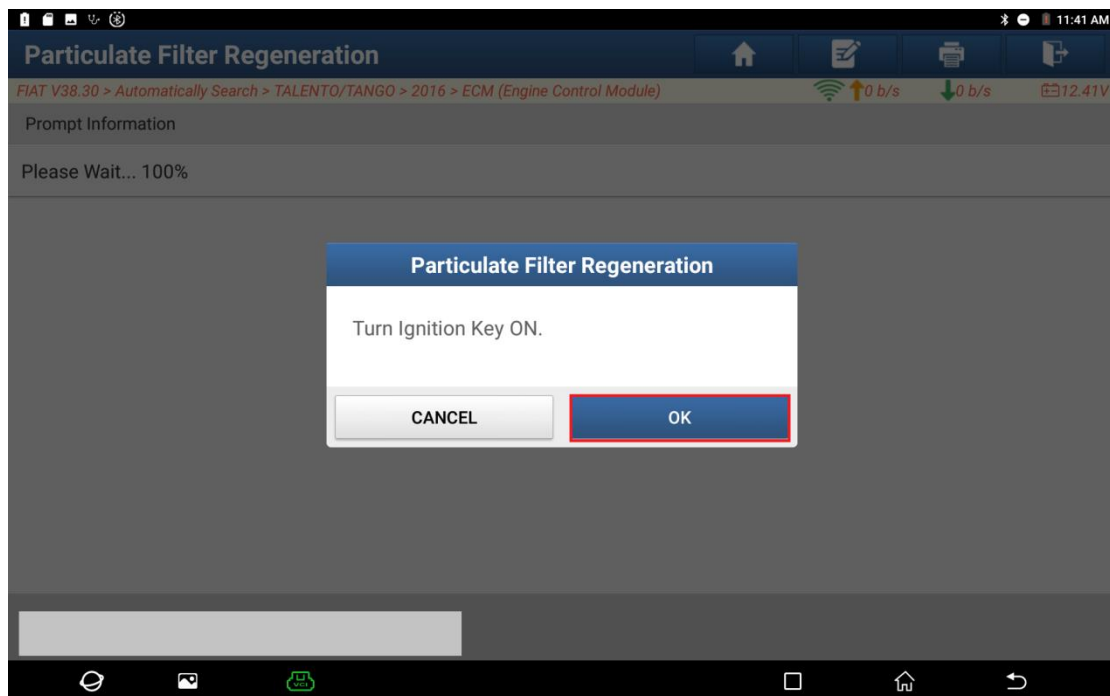

21. Click OK. Program execution is completed.

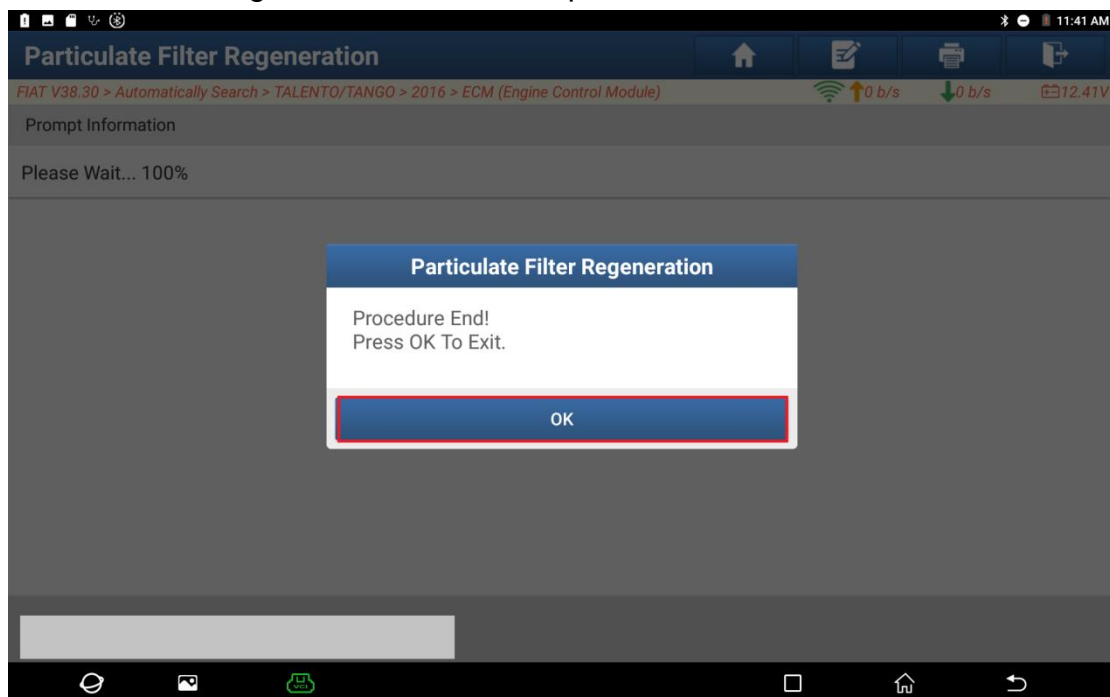

## Statement:

The content of this document is copyrighted by Shenzhen Launch Tech Co., Ltd., and no individual or organization may quote or reprint it without consent.