

## Operation instructions for Toyota Anti-Theft function

**Features:** Anti-Theft Box Reset (All Keys Lost)

### Requirements:

**Required devices:** PRO and other Android devices of 431 products

**Required software:** Toyota V10.01

### Steps:

For Toyota Immobilizer, the following is a detailed introduction to the method of All Keys Lost for mechanical 72 chip keys.

1. Enter the software, and select , **【System mode】** , as shown in Figure 1.

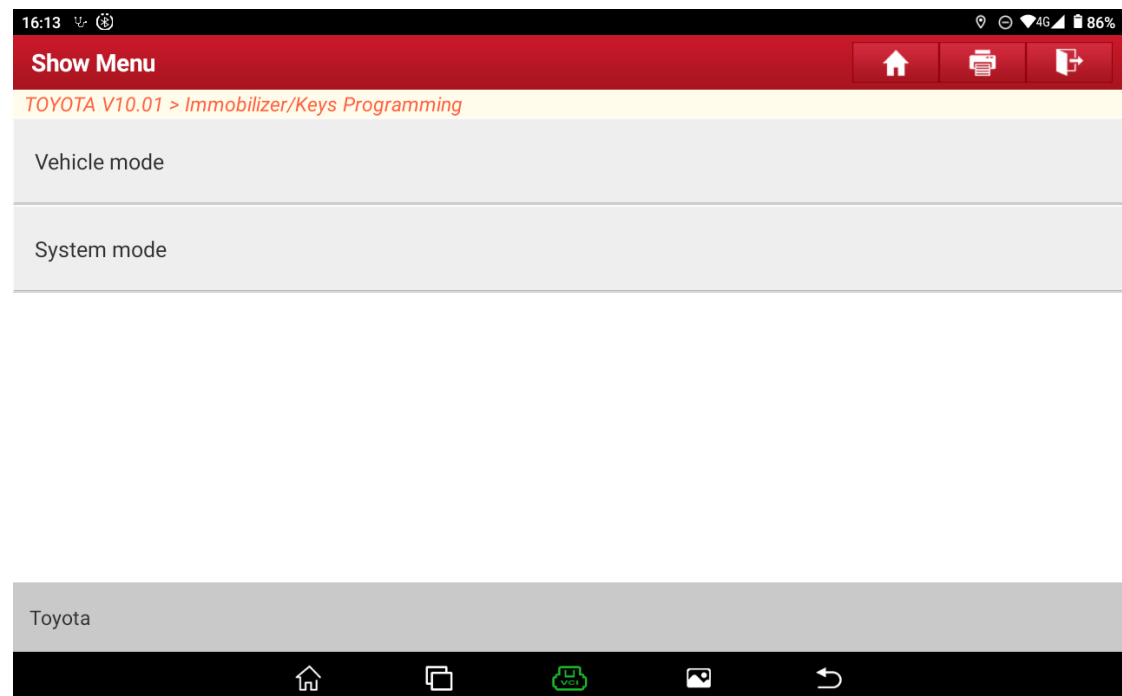

Figure 1

2. Select **【Immobiliser (Immobilizer Programming)】** , as shown in Figure 2.

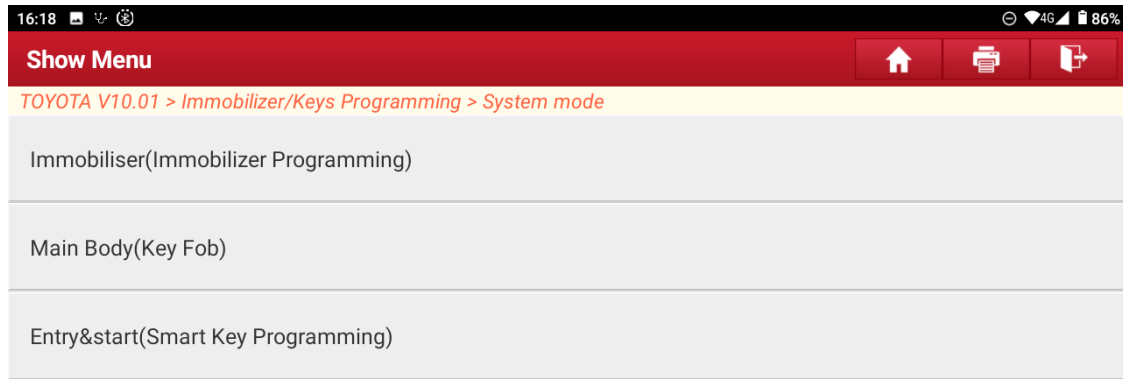

Figure 2

3. Select **【Type 5 (with G 72)】** , as shown in Figure 3.

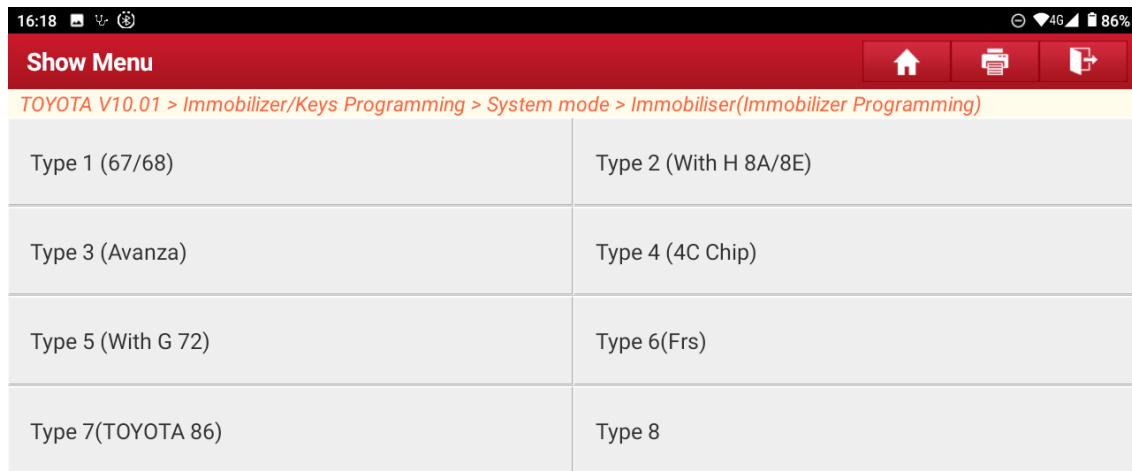

Figure 3

4. Select **【Anti-theft Box Reset (All Keys Lost)】** , as shown in Figure 4.

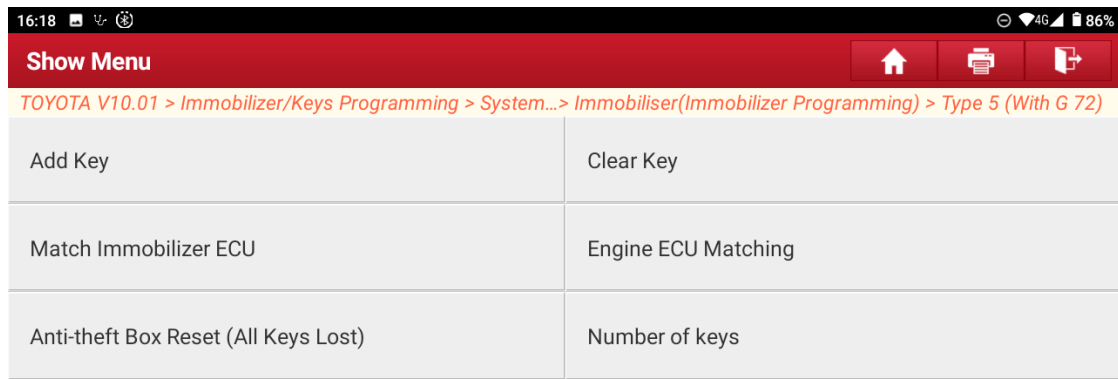

Figure 4

5. If the Anti-theft Box has been reset or replaced with a new one, there will be the following prompts, as shown in Figure 5 and Figure 6.

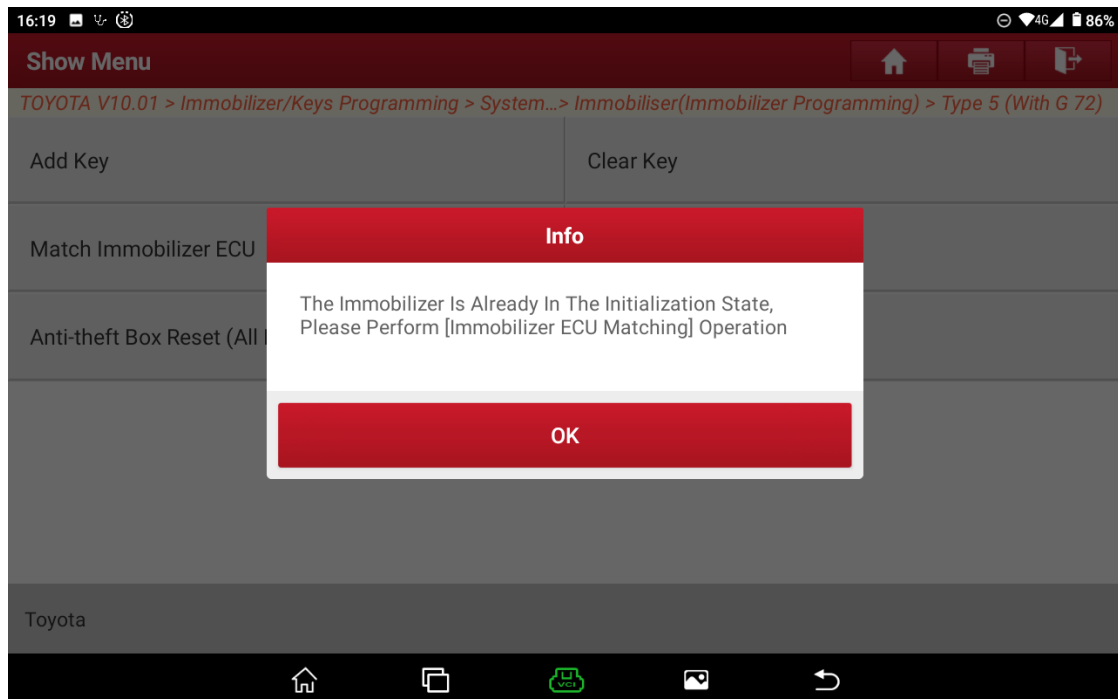

Figure 5

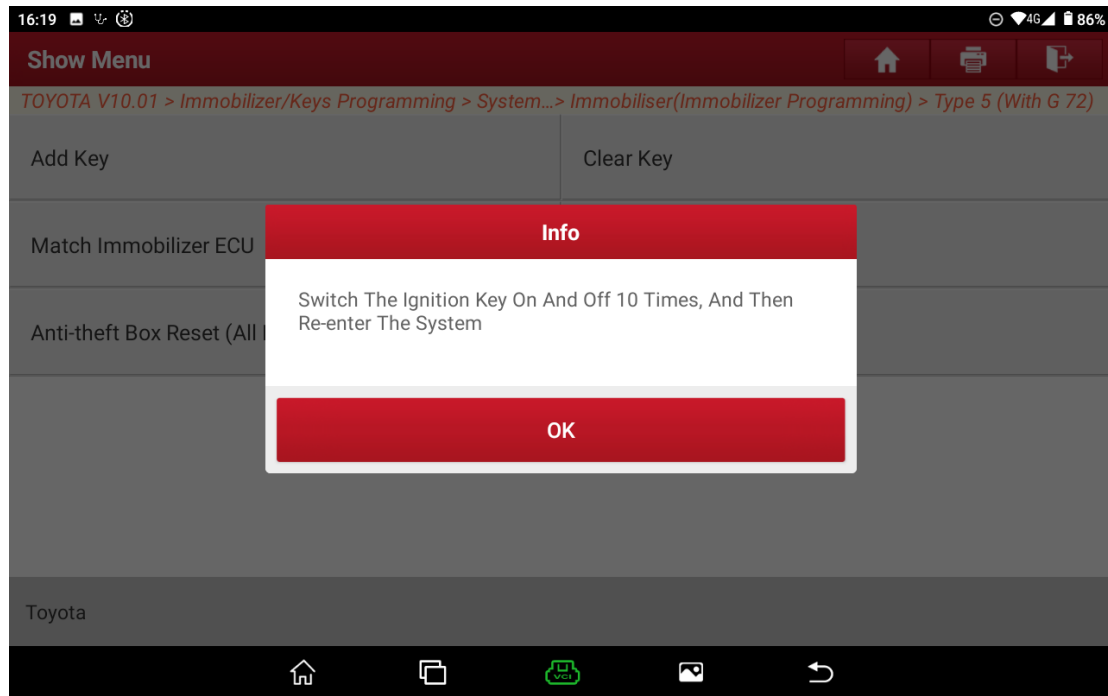

Figure 6

6. The following is the process of All Keys Lost, follow the prompts.

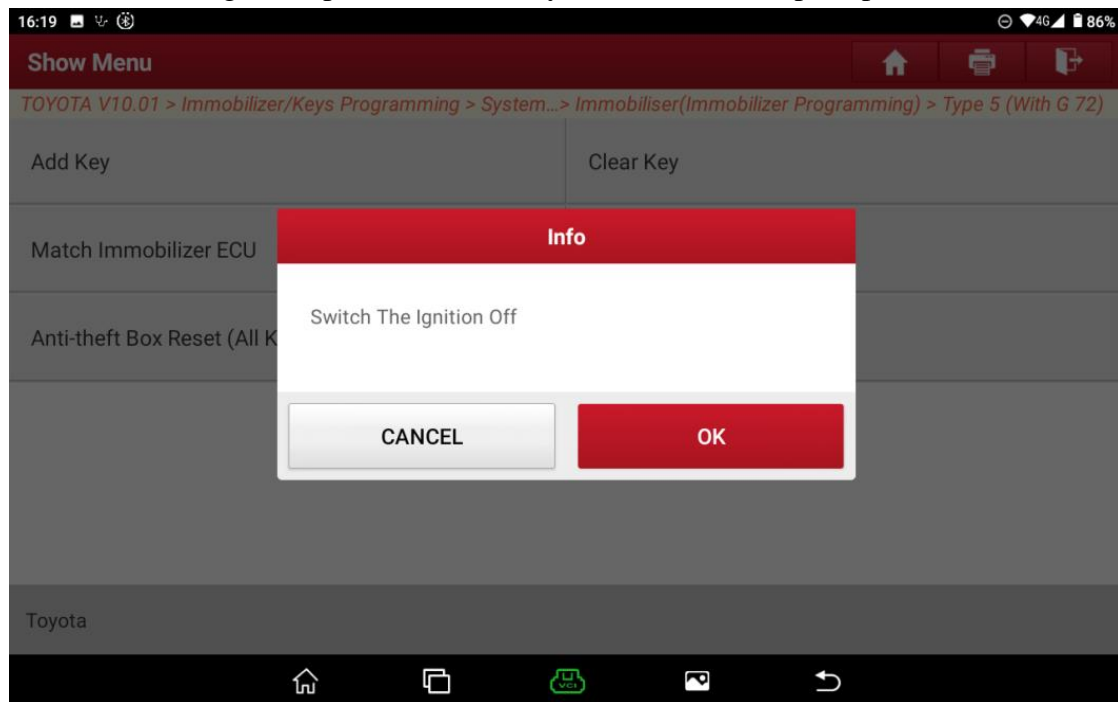

Figure 7

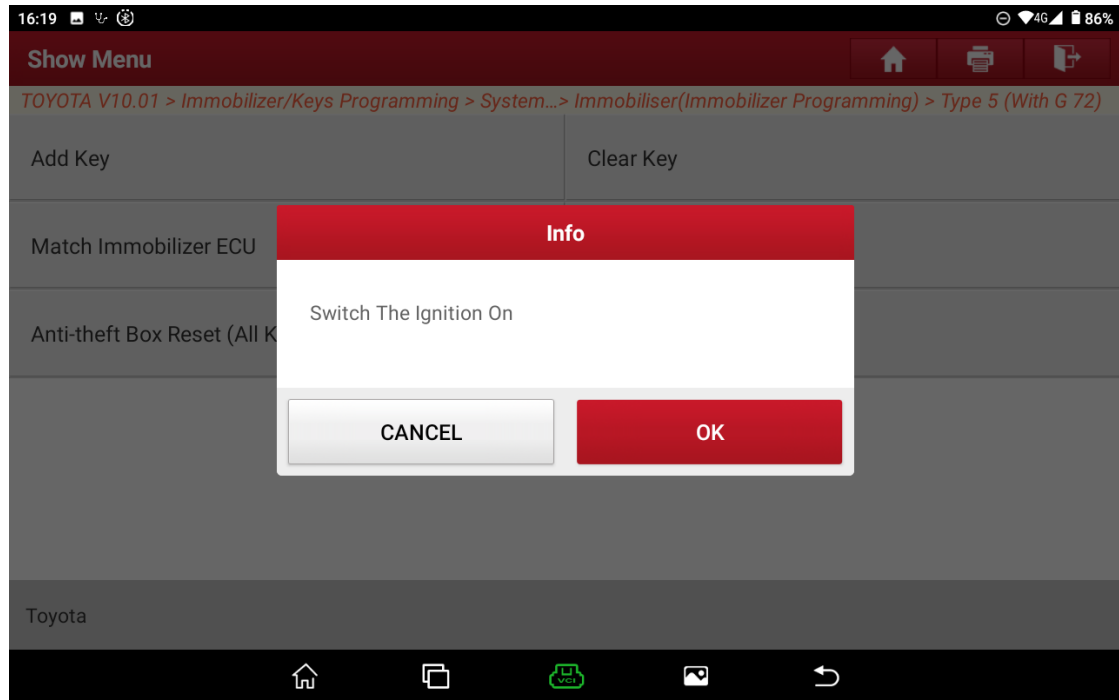

Figure 8

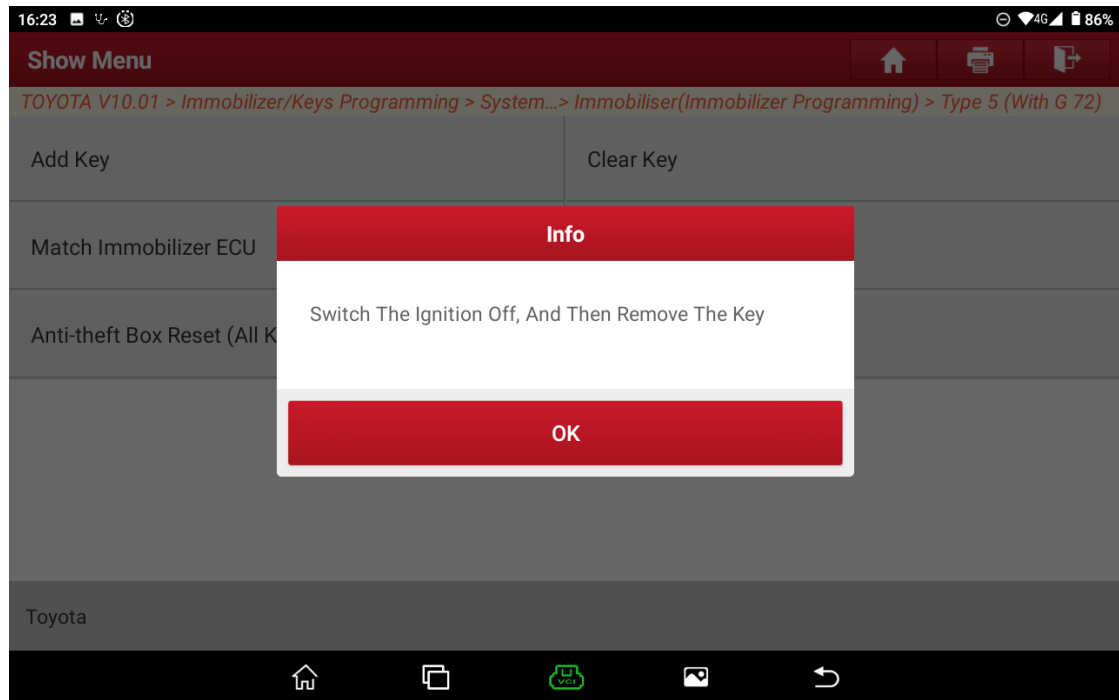

Figure 9

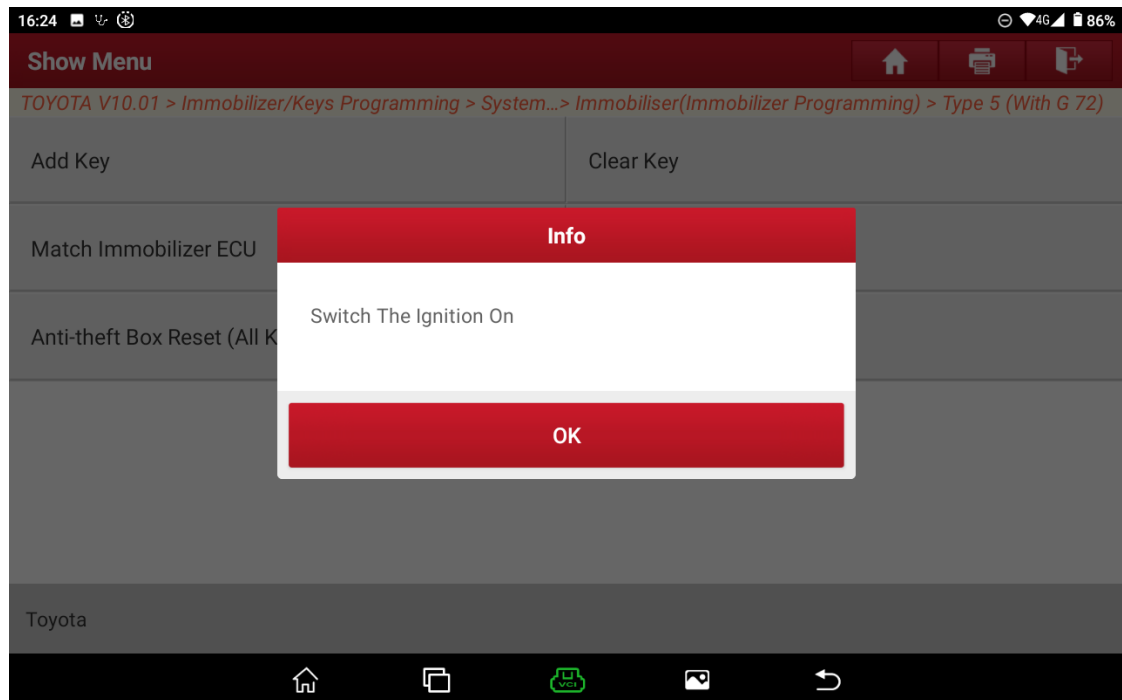

Figure 10

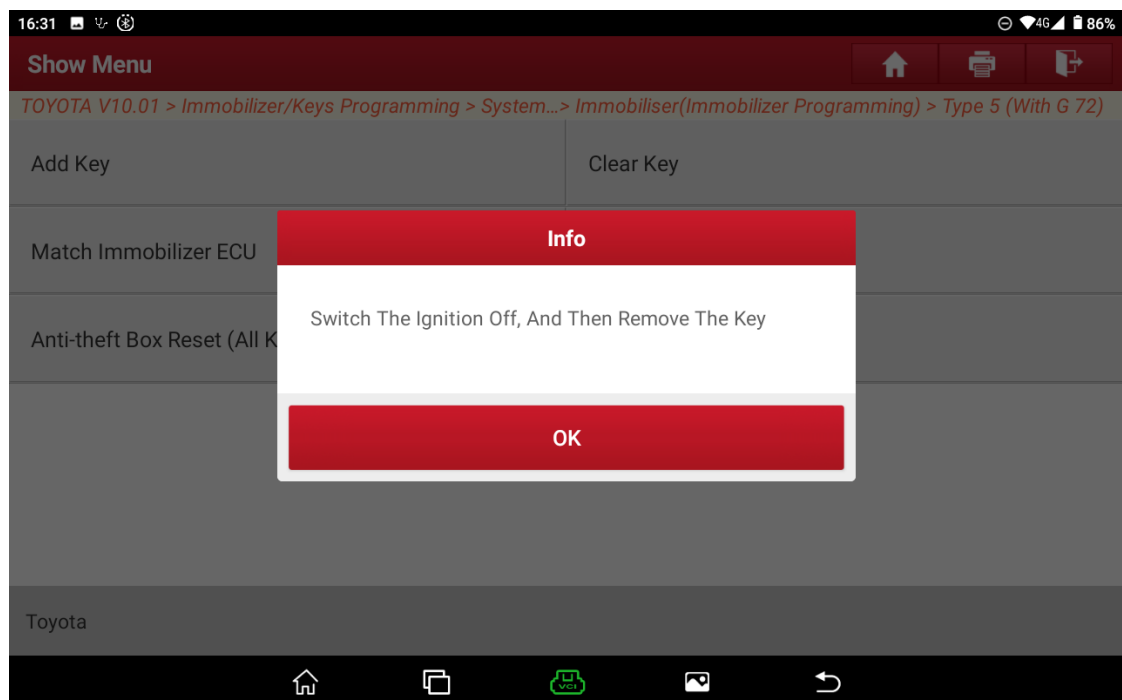

Figure 11

7. Perform the following operations according to the type and quantity of keys you want to match. You can operate on this interface. Click “OK” after the operation completed, which is to prevent the key matching failed caused by you don’t remember the operation procedure after exiting by clicking “OK”, as shown in Figure 12.

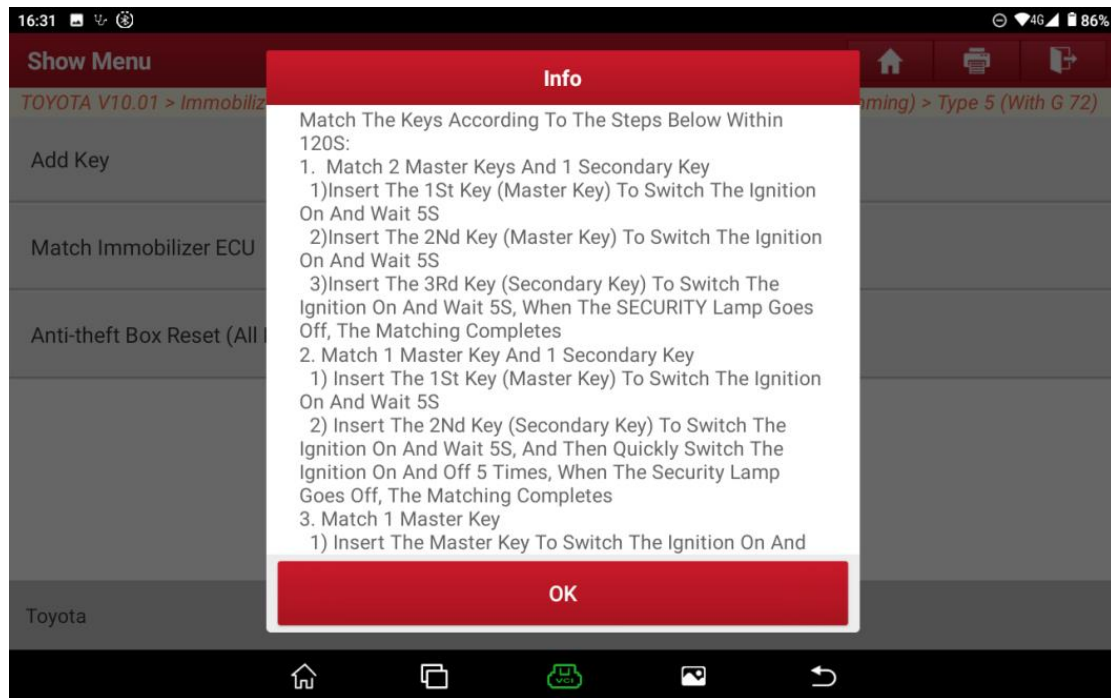

Figure 12

8. Finally, you can test whether the key is normal by starting the vehicle.

### Statement:

The content of this document belongs to Shenzhen Launch Tech Co., Ltd. All rights reserved. Any individual or unit shall not quote or reprint without consent.