

# LAUNCH

## AC System Initialization Introduction

### Function Introduction

The automatic air conditioning system uses a temperature selector to set the required temperature, and the system uses the automatic control of the ECU to adjust and maintain the predetermined temperature.

When the automatic air conditioner replaces the air conditioner electronic control unit, replaces the servo motor, and disconnects and connects the battery cable, it must be initialized; otherwise the system will not work normally.

The prerequisites for initialization are as follows: before starting the engine, turn off the automatic air-conditioning control system; during engine operation, the automatic air conditioning initialization operation must be completed before the air conditioning cooling mode can be activated. At this time, you need to use the diagnostic tool to initialize the air conditioning.

### Device Requirement

PAD VII, European Euro Tab III, MM4.0

Other devices can buy "Motor Angle Calibration" function in Mall module.

### Support Vehicles

Subaru, Hyundai, Kia, BMW, MINI, Toyota, Lexus, Mitsubishi, Jaguar, Land Rover, Audi, Volkswagen, Seat, Skoda etc.

### Operation Guide:

Here we take Toyota Alphard as an example.

1. Select "Toyota".

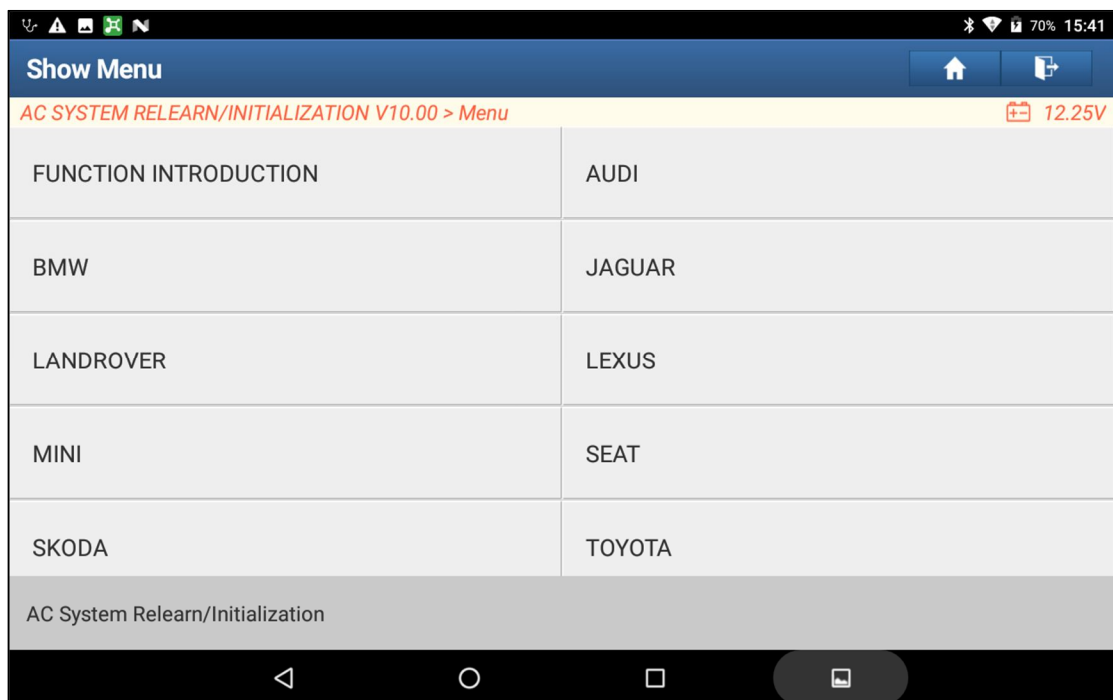

# LAUNCH

2. Switch on ignition.

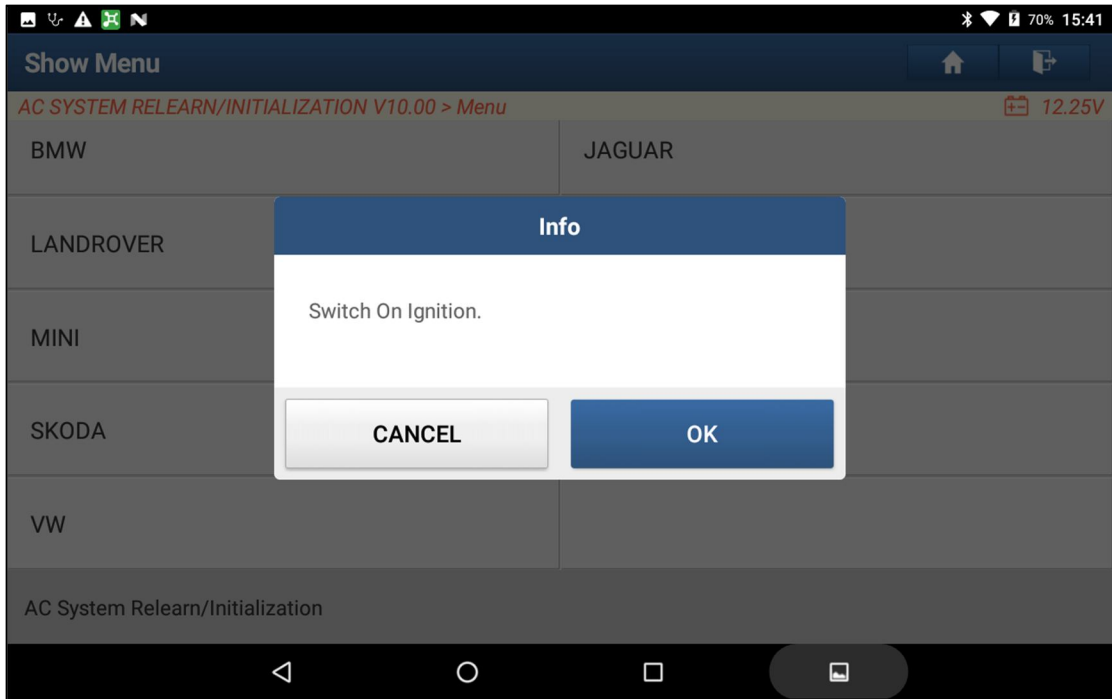

3. Select "Alphard".

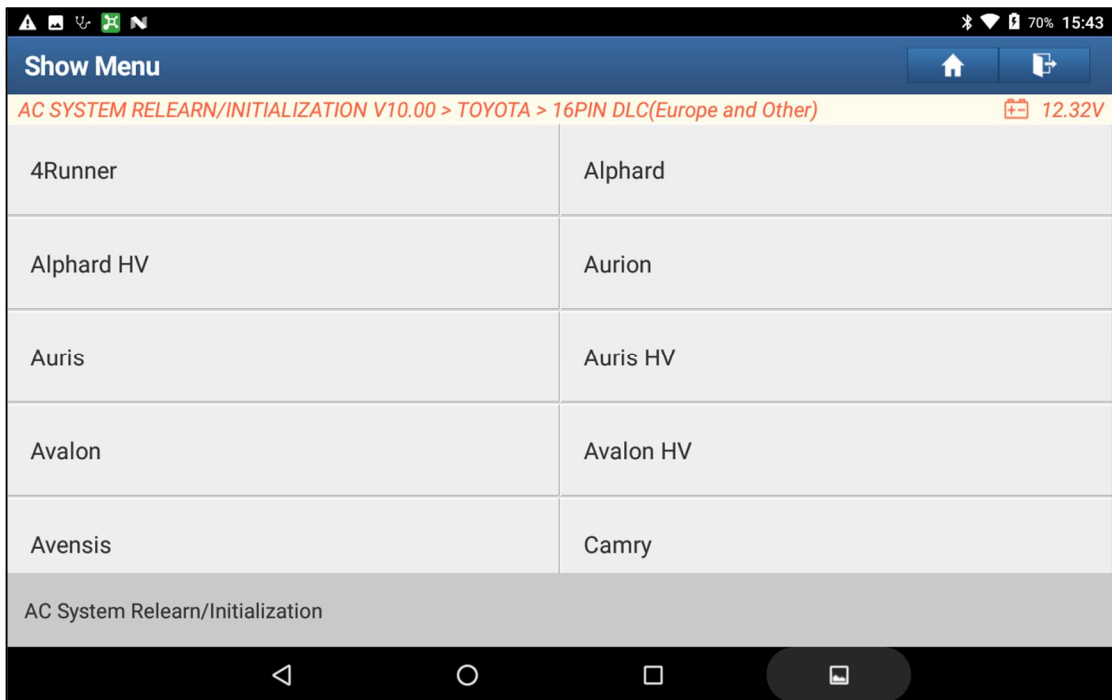

# LAUNCH

4. From the photo, we need where to find the model and engine type, click "OK".

Notice

AC SYSTEM RELEARN/INITIALIZATION V10.00 > TOYOTA > 16PIN DLC(Europe and Other) > Alphard 12.32V

Vehicle Mode



MODEL 7E1213-GEPNKT  
ENGINE 3775BB

TOYOTA MOTOR THAILAND CO., LTD.  
1598 CC

FRAME No. COLOR TRIM GVM(KG)  
03 Y605  
248E-07A  
33 MAY 06

TRANS/AXLE  
PLANT/BUILT

Please select the vehicle mode menu according to the vehicle model on the nameplate.

AC System Relearn/Initialization

OK

5. Select "GHH".

Show Menu

AC SYSTEM RELEARN/INITIALIZATION V10.00 > TOYOTA > 16PIN DLC(Europe and Other) > Alphard 12.32V

|       |       |
|-------|-------|
| AGH30 | ANH   |
| GGH   | GGH30 |
| GHH   |       |

AC System Relearn/Initialization

# LAUNCH

6. Confirm vehicle info and click "OK".

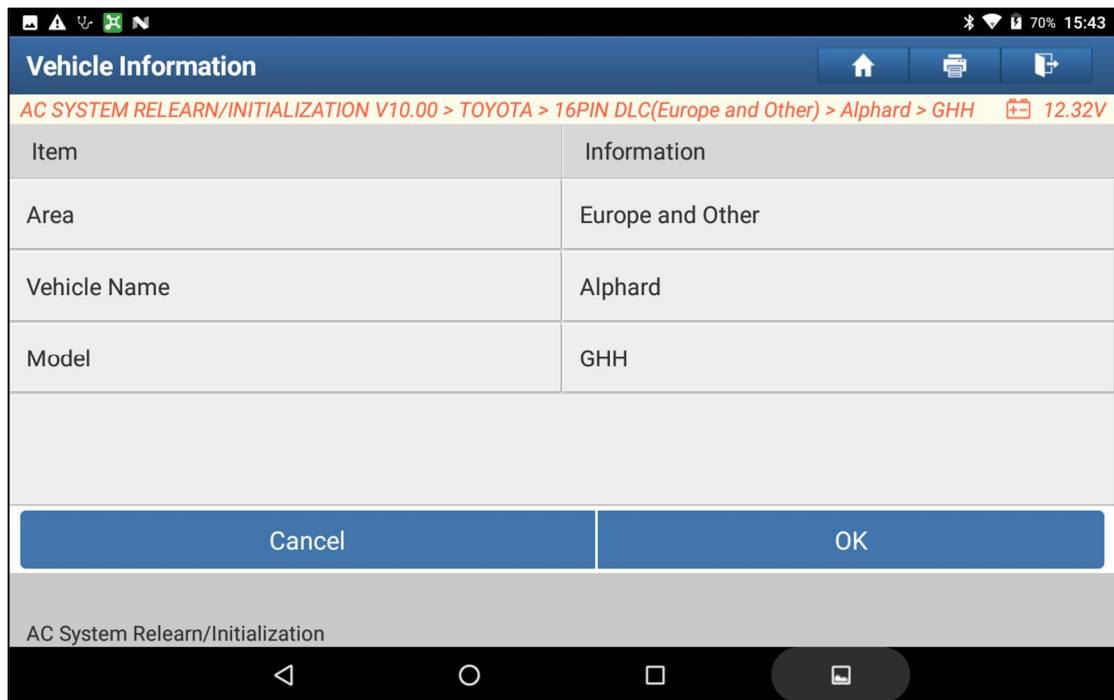

7. Read the notice carefully and select "OK".

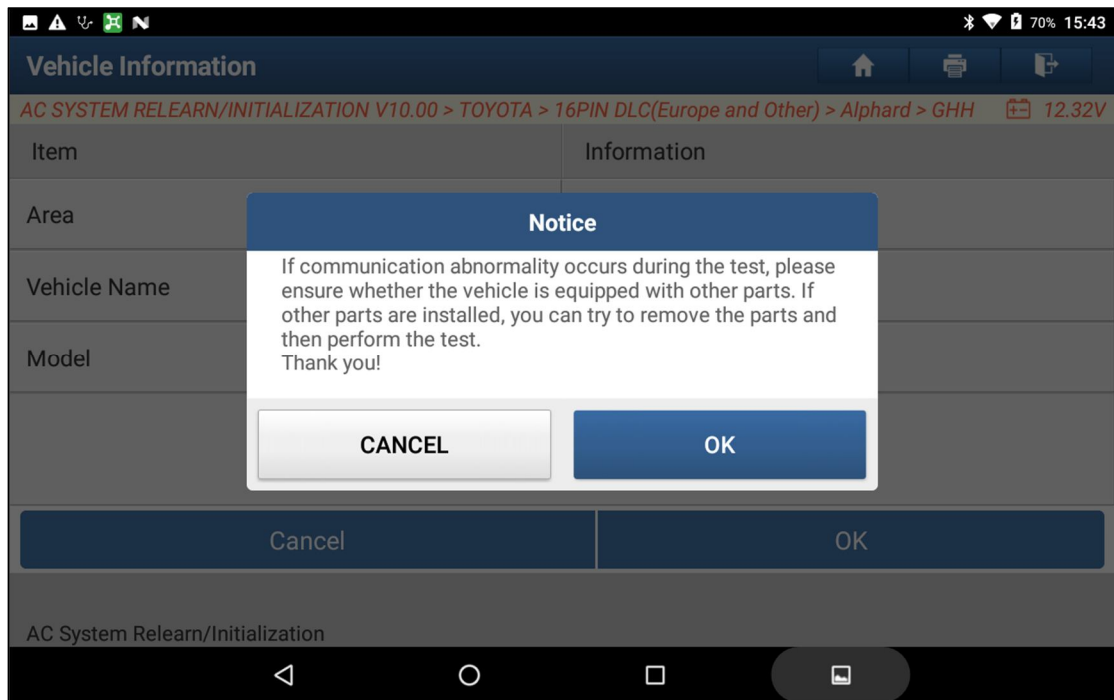

# LAUNCH

8. Click "Air Conditioner".

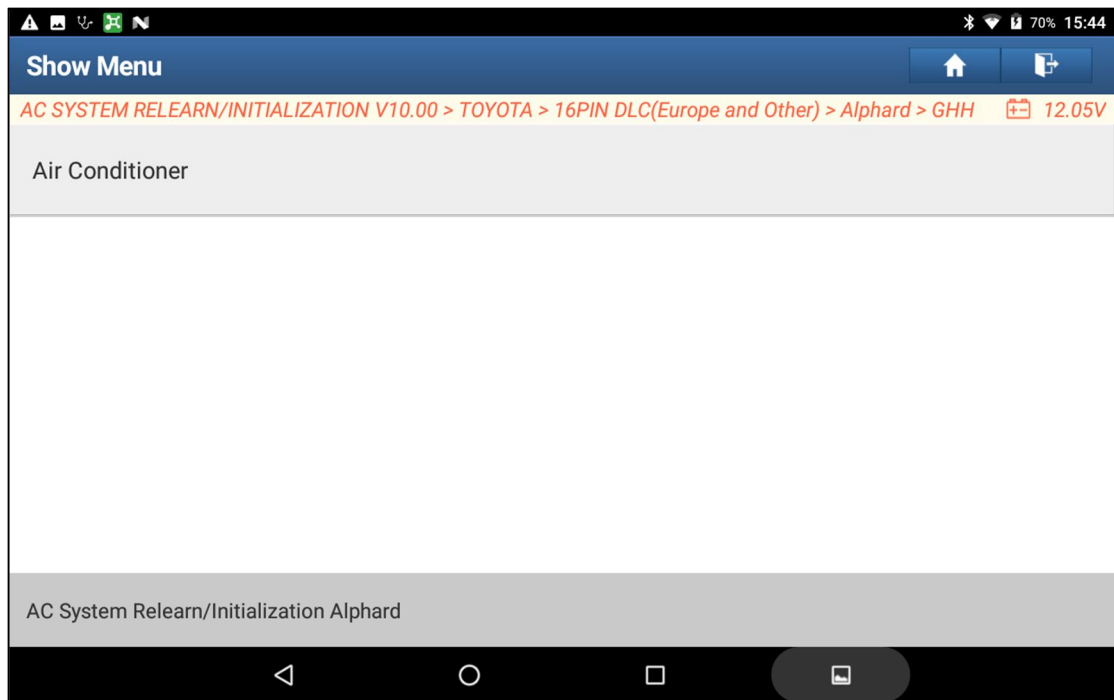

9. Read the notice and click "OK" to continue.

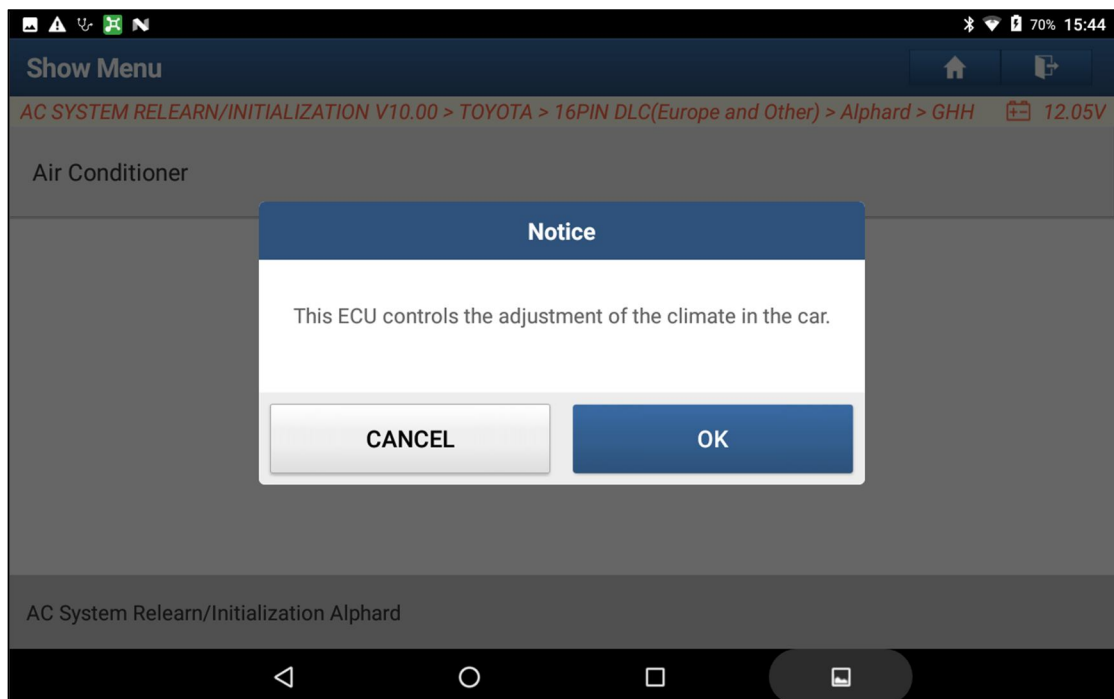

# LAUNCH

10. Click "Special Function".



11. Click "Servo Motor Initialization".

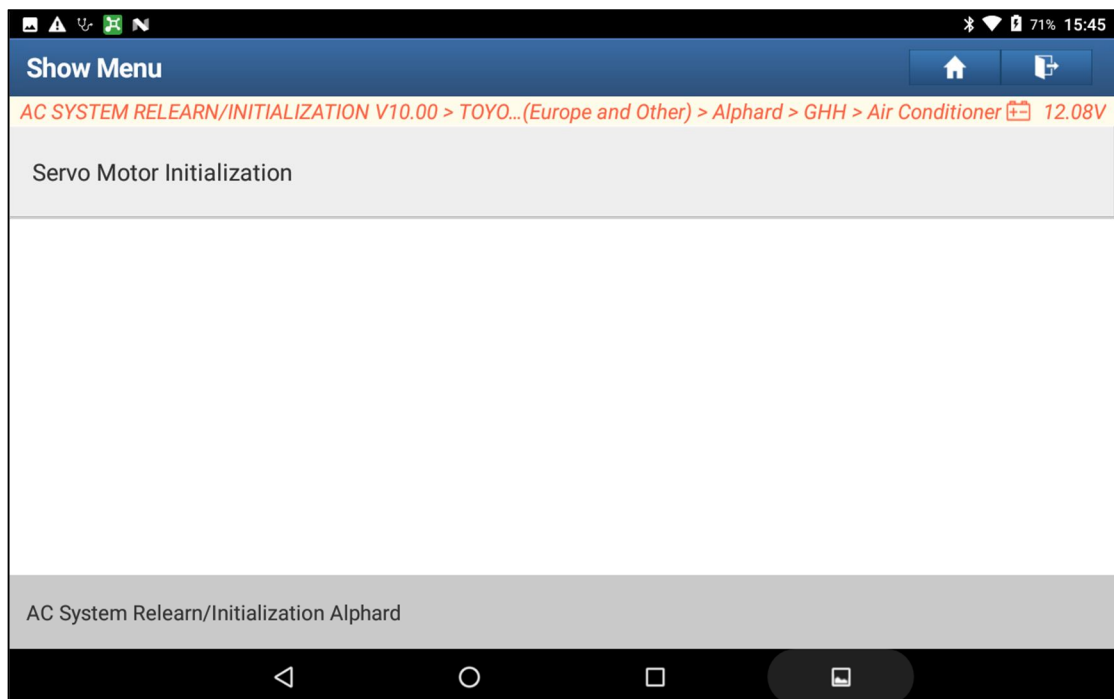

# LAUNCH

12. Noted that perform the servo motor initialization after replacing the actuator and battery. Click "OK" to continue.

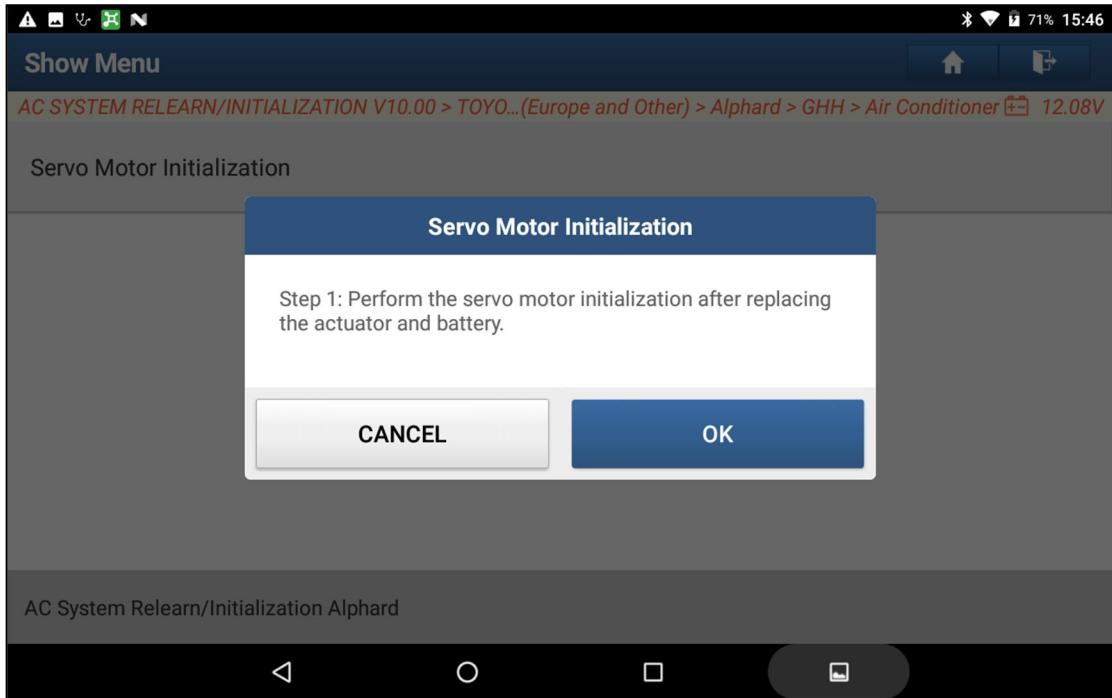

13. Starting execute initialization, click "OK".

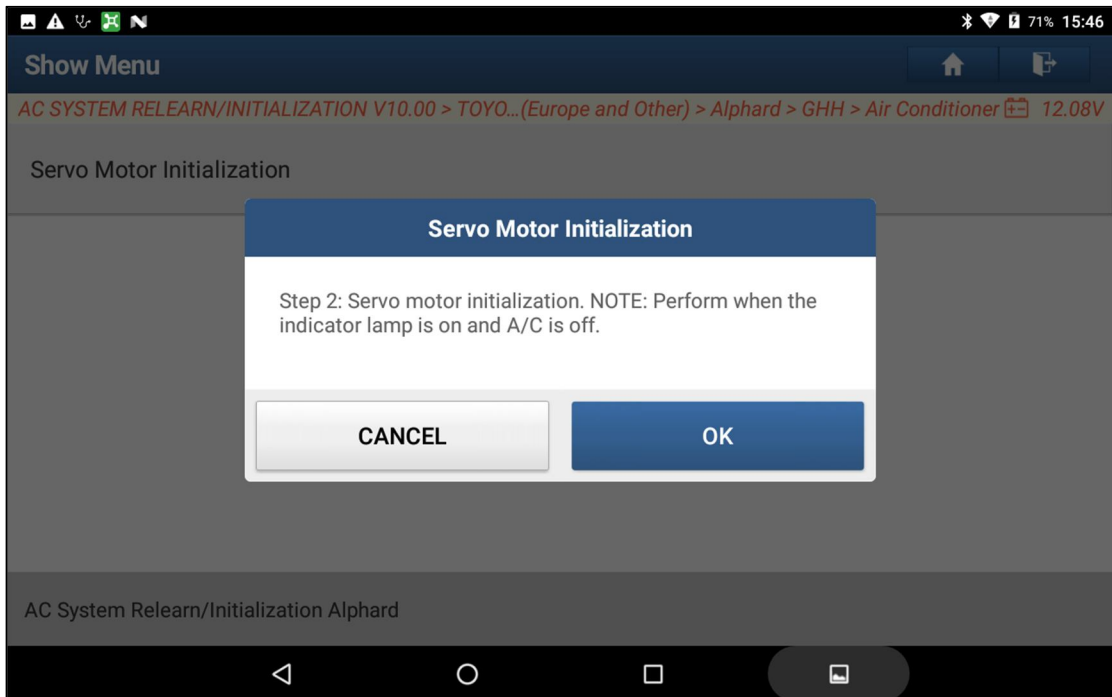

# LAUNCH

14. The initialization starts, the DEF indicator lamp is off and the automatic indicator lamp is on, if the lamp goes out, the initialization will end.

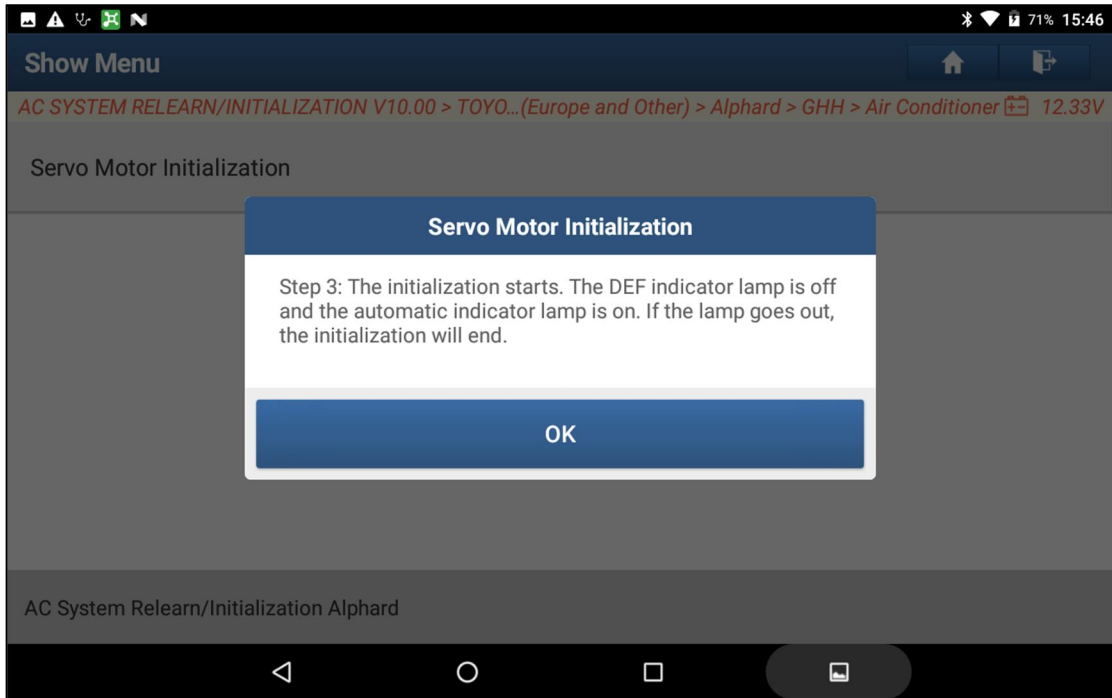

## 32 Service Functions

