

2012 Audi Q7 Brake Pad Replacement Method

Product Model	Date	No.
X431Pro series	20151217	—

Vehicle Coverage:

- Audi, 2012, VIN=LFV3B28R1C30*****. See Figure 1.



Figure 1

Prerequisites:

- The battery voltage is no less than 12V.
- Ignition ON and engine stopped.
- Parking brake switch pressed and instrument panel brake lamp off before basic setting

Procedure:

- 1) Turn on the ignition switch.
- 2) Choose brake pad reset V10.40 or a later version.
- 3) Choose AUDI. See Figure 2.

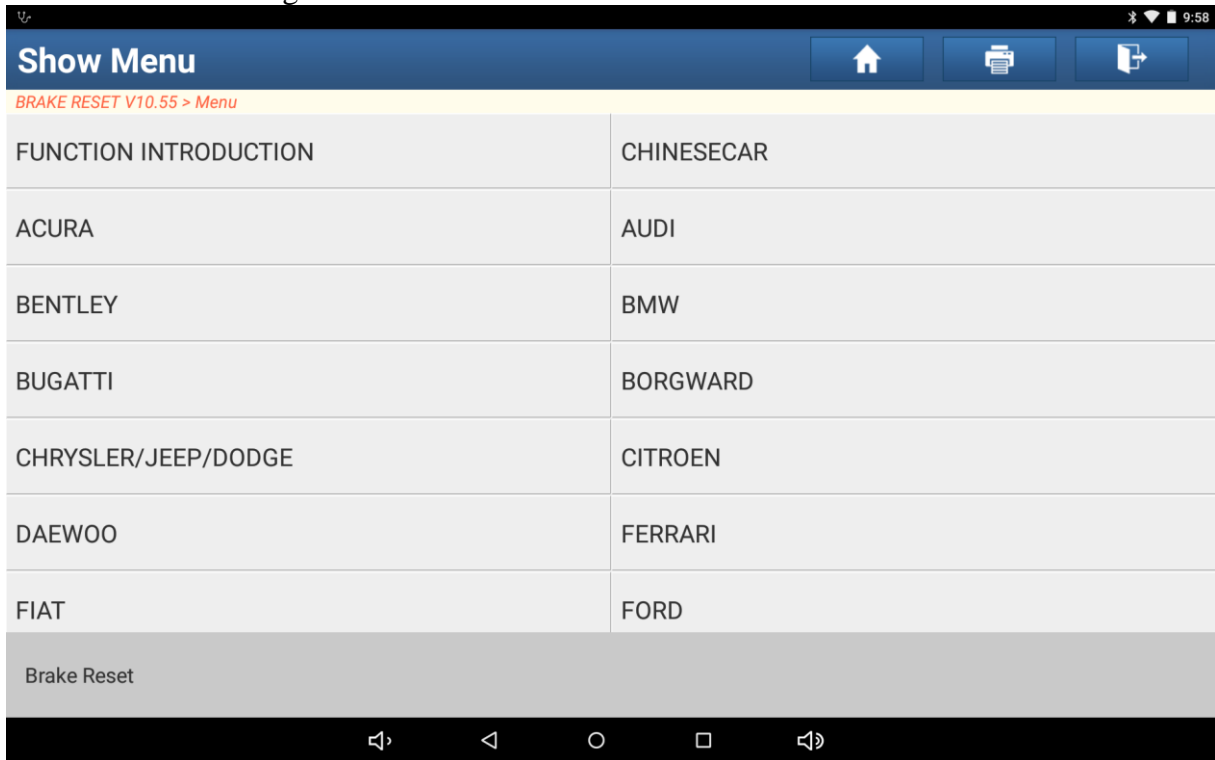

Figure 2

- 4) Choose Other Vehicle Models. See Figure 3.

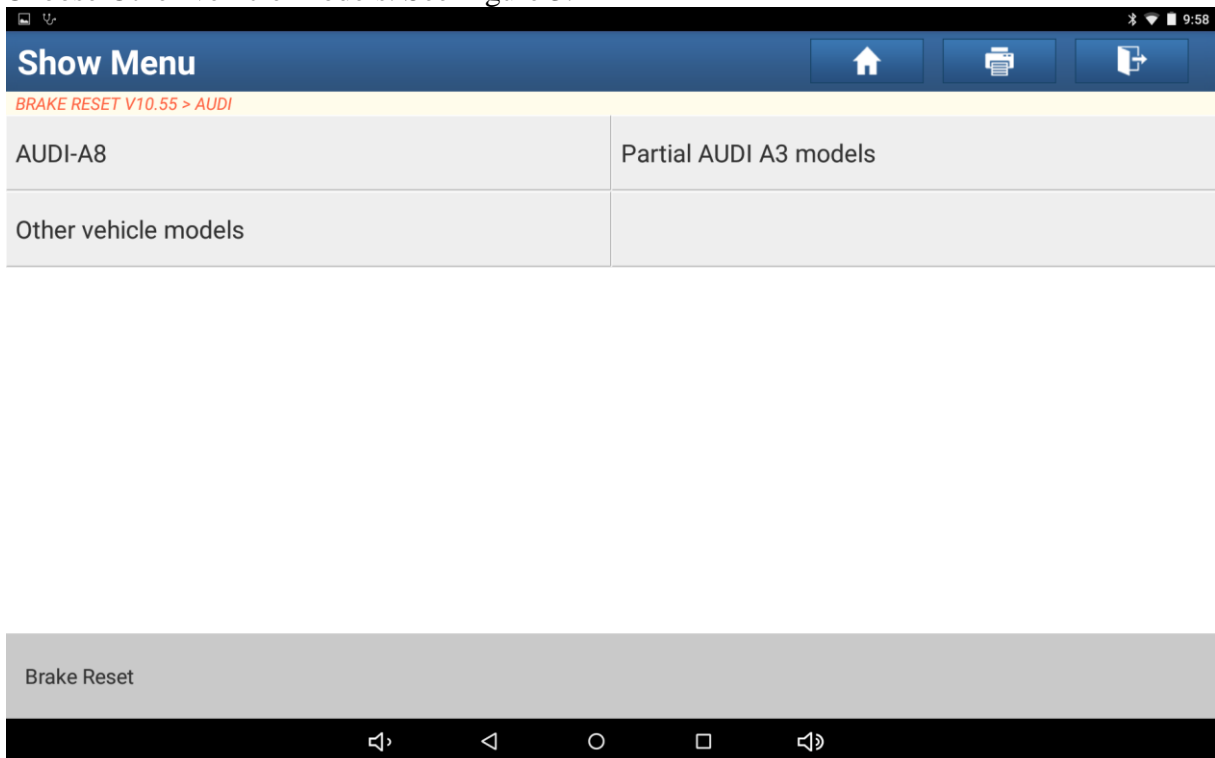

Figure 3

5) Choose 53 Parking Brake. See Figure 4.

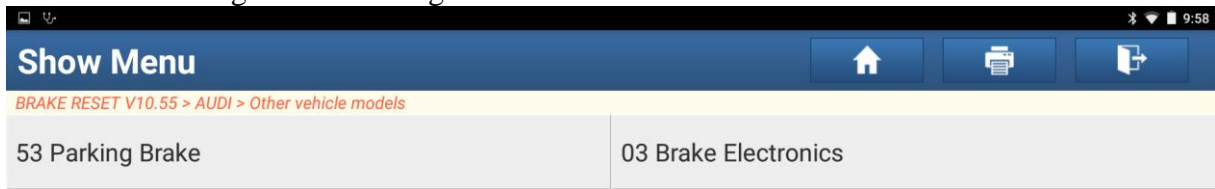

Figure 4

6) Note the brake pad replacement conditions. See Figure 5.

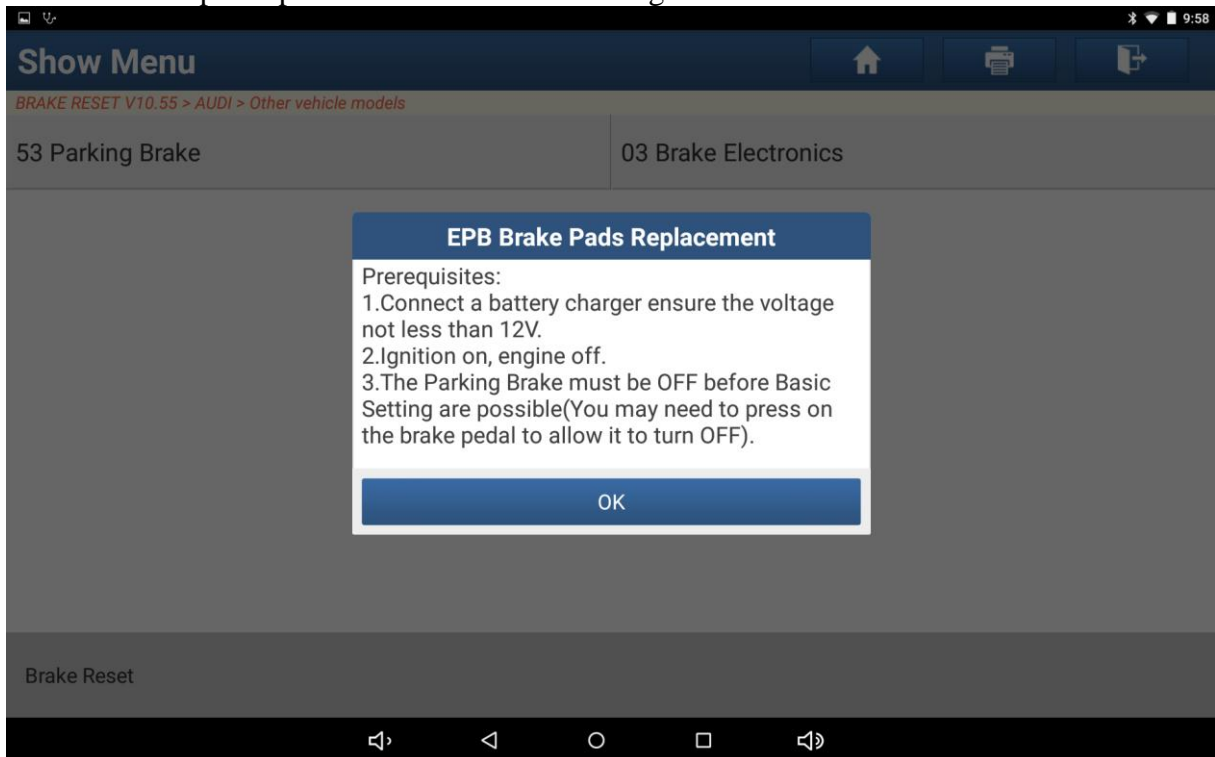

Figure 5

7) Click OK. The brake pad replacement function menu is displayed. You can choose the brake pad replacement function as required. Choose Auto Rear Brake Pads Replacement. See Figure 6.

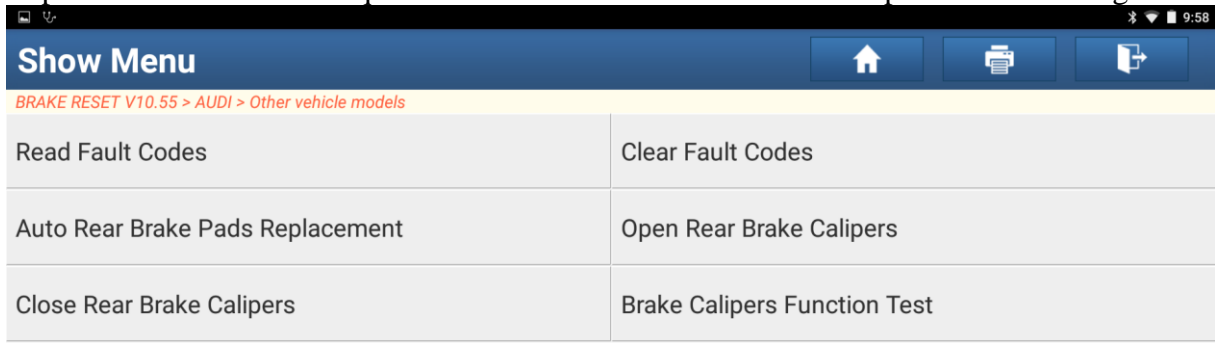

Figure 6

8) The "Read Fault Codes" menu is displayed. See Figure 7.

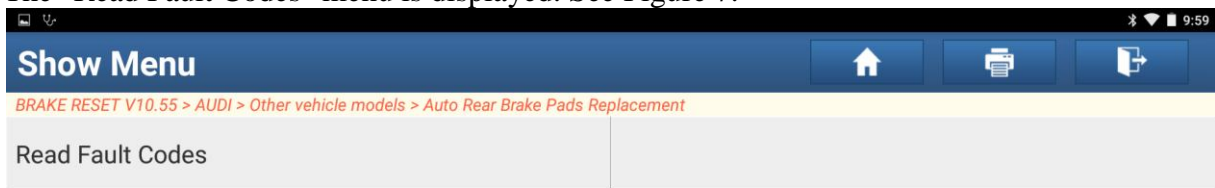

Figure 7

9) Choose Read Fault Codes. See Figure 8.

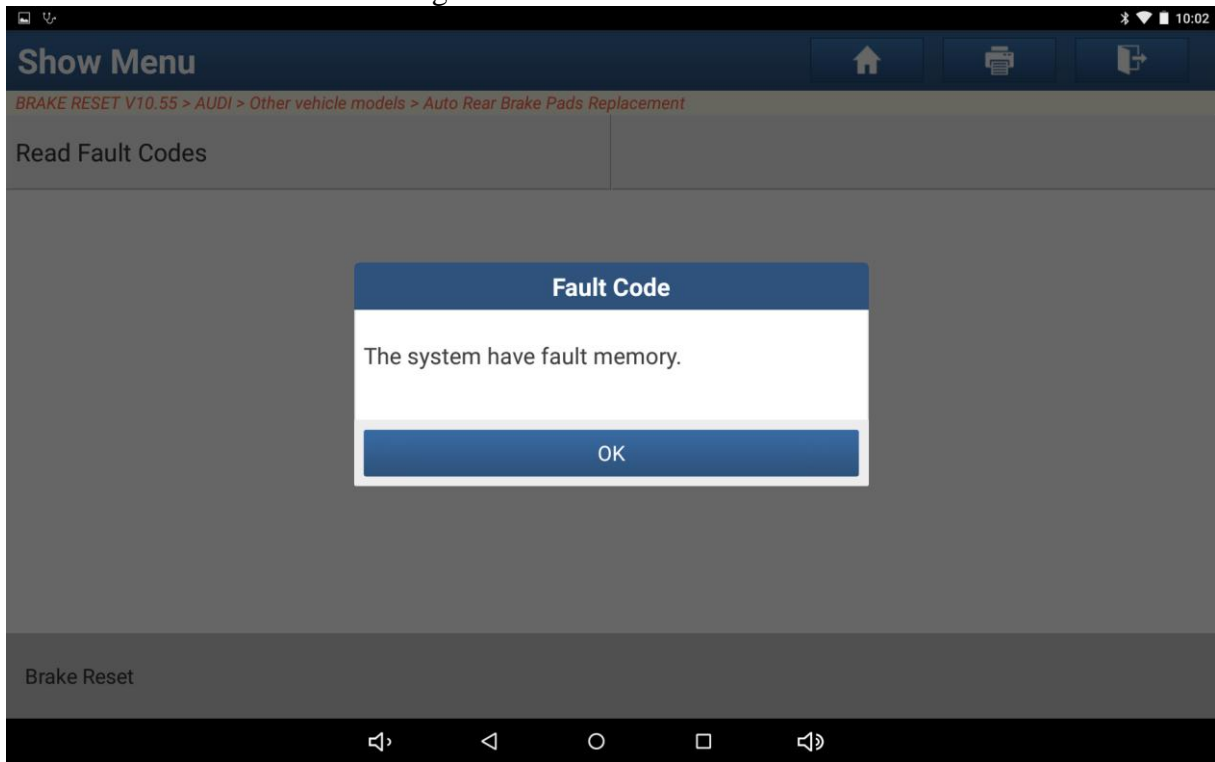

Figure 8

10) Click OK. The "Clear Fault Codes" menu is displayed. See Figure 9.

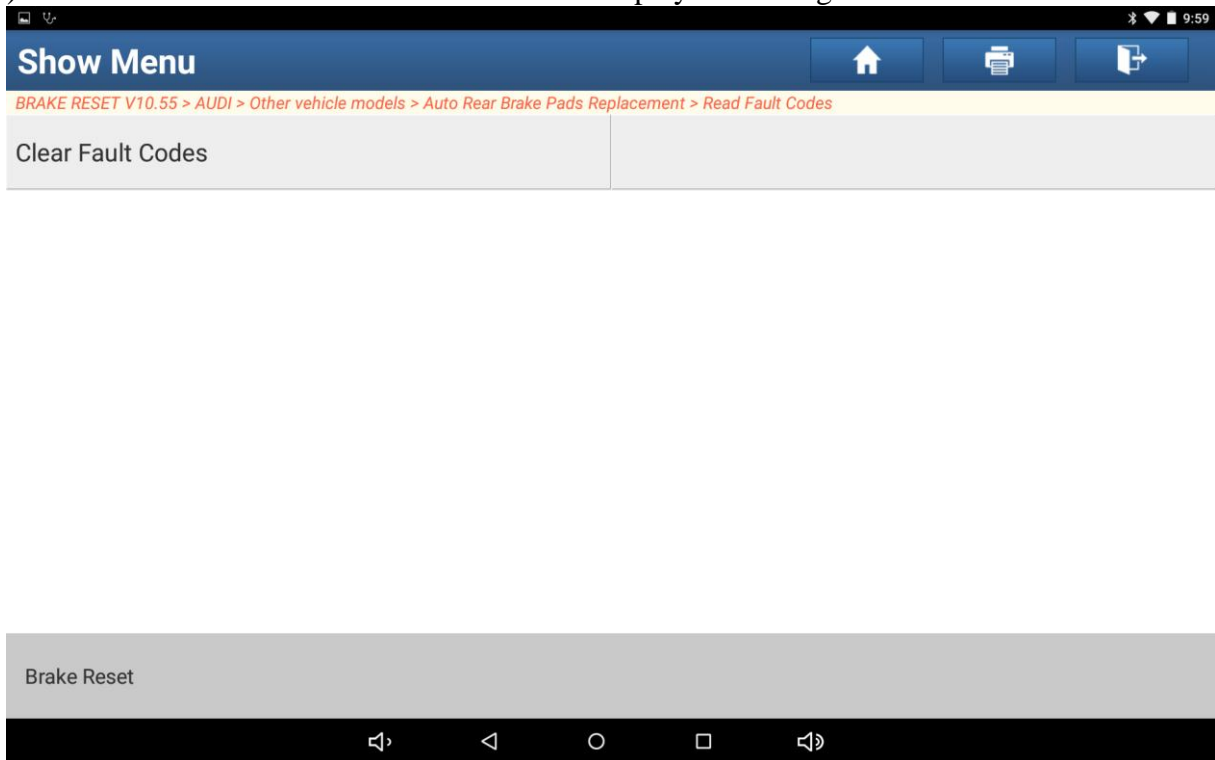

Figure 9

11) Choose Clear Fault Codes. See Figure 10.

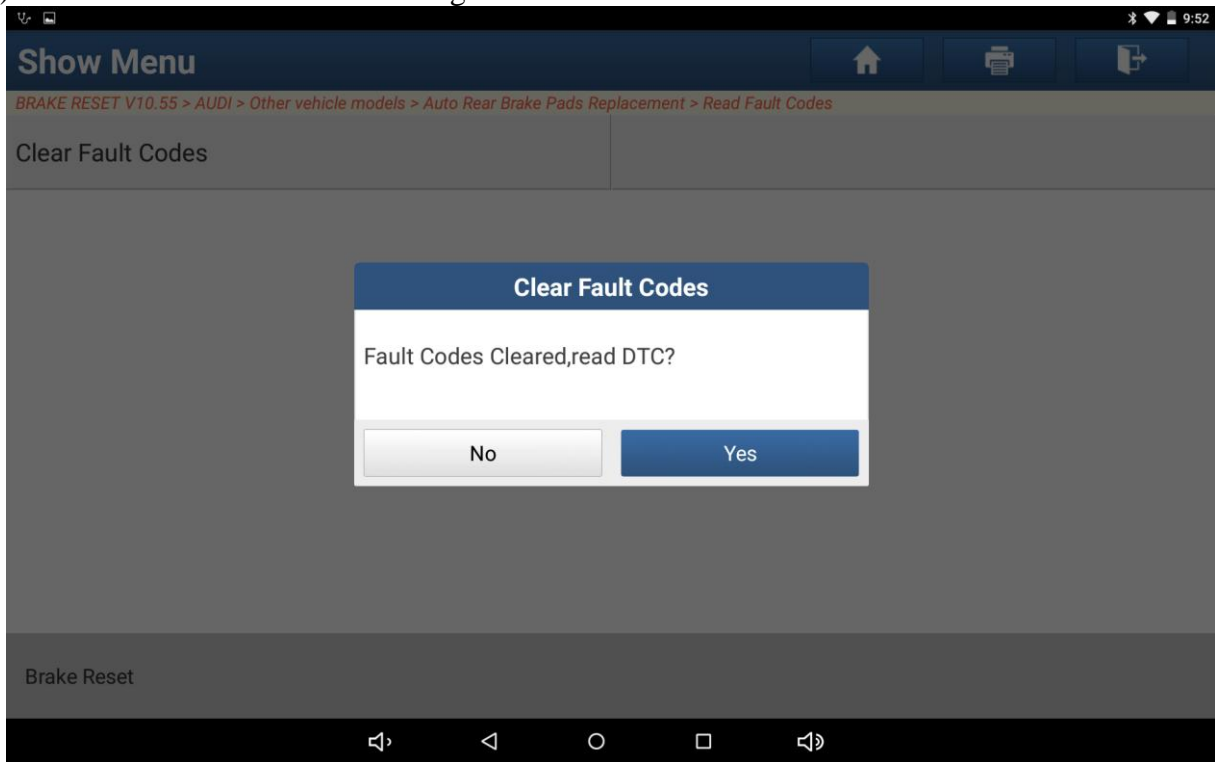

Figure 10

12) If the fault codes have been cleared, click No. See Figure 11.

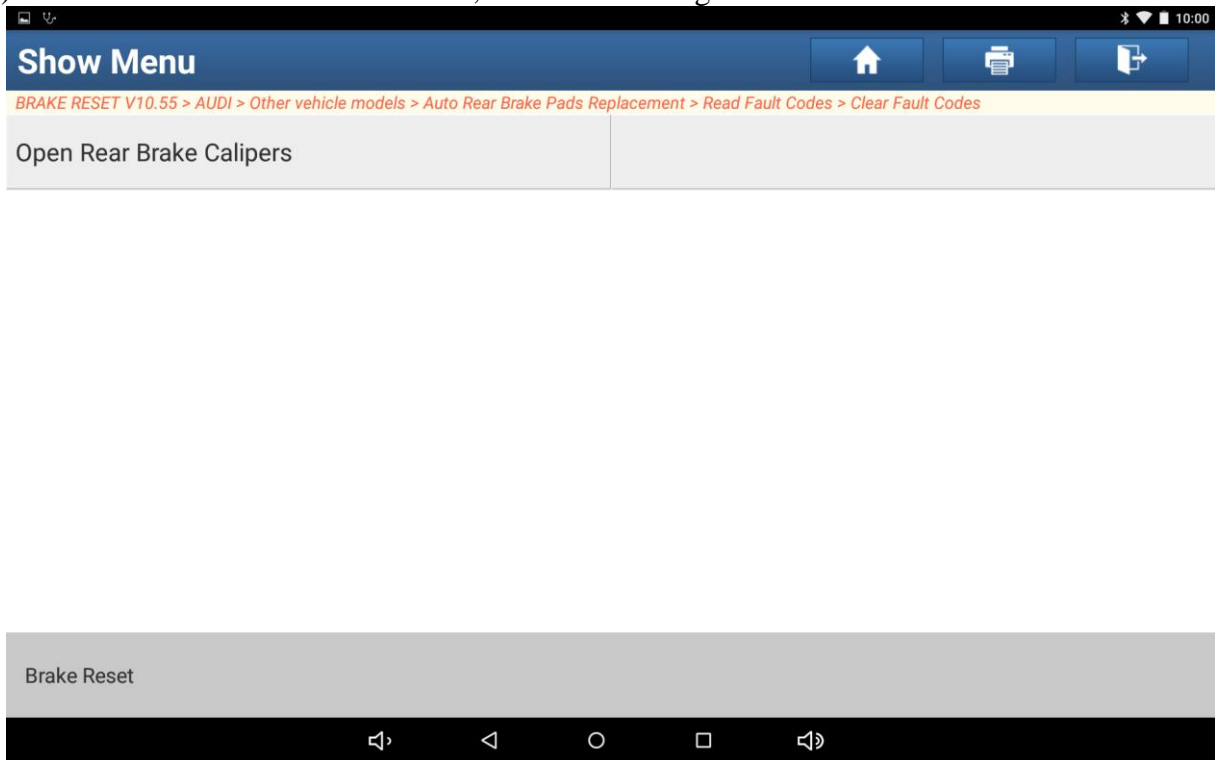

Figure 11

13) Choose Open Rear Brake Calipers. See Figure 12.

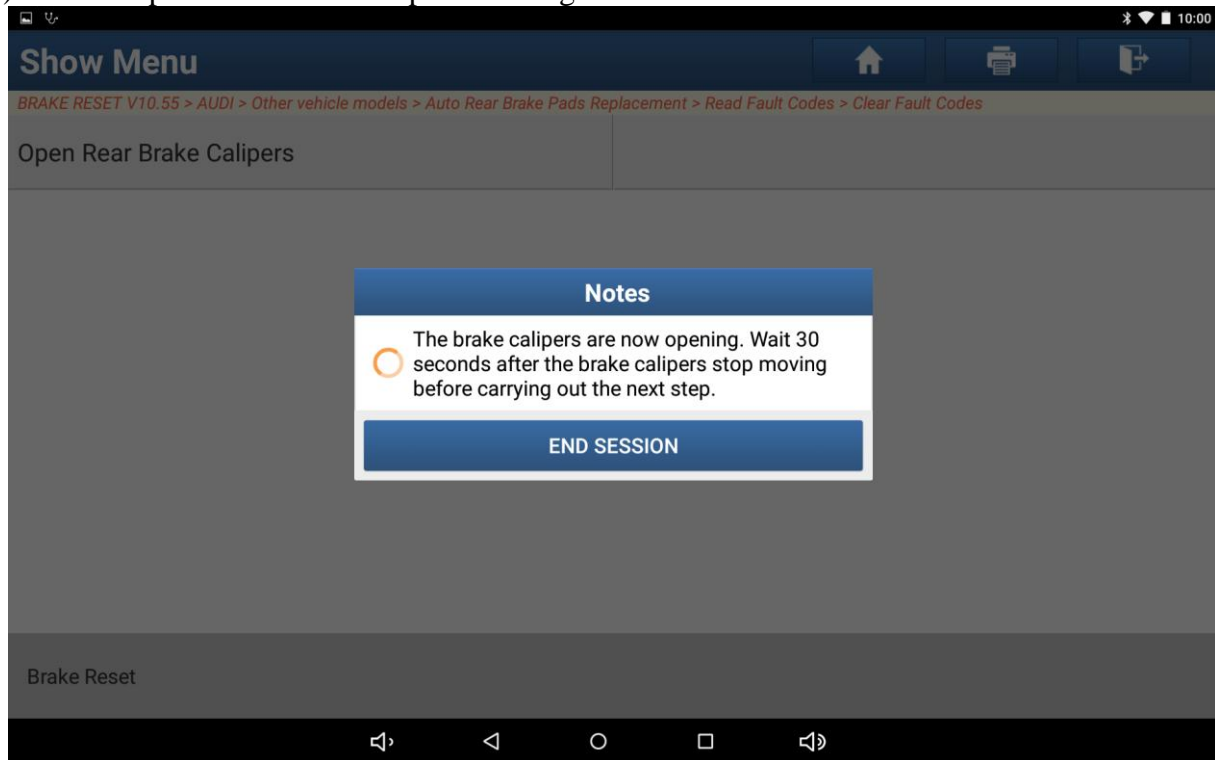

Figure 12

14) Wait for about 30s. The brake calipers have been opened. See Figure 13.

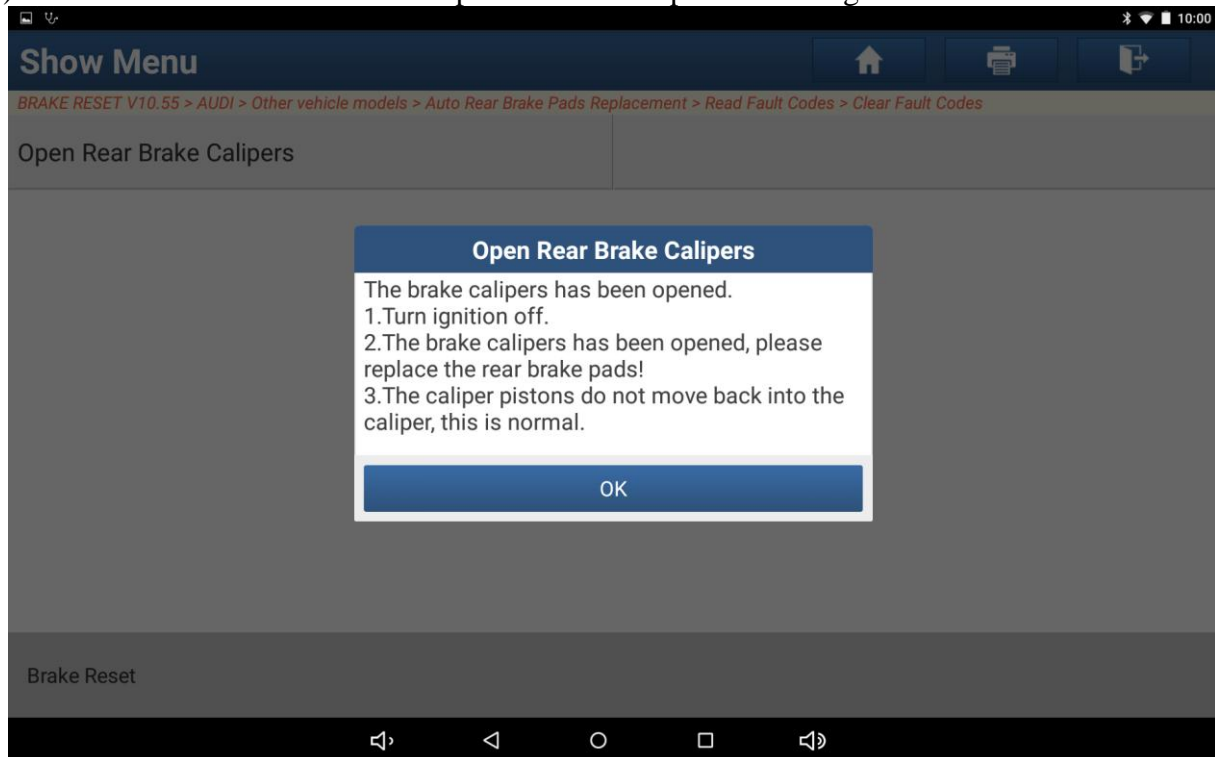

Figure 13

15) Click OK to replace the brake pads. See Figure 14. When replacing the brake pads, if the motor is not completely separated, manual "open-top" is required.

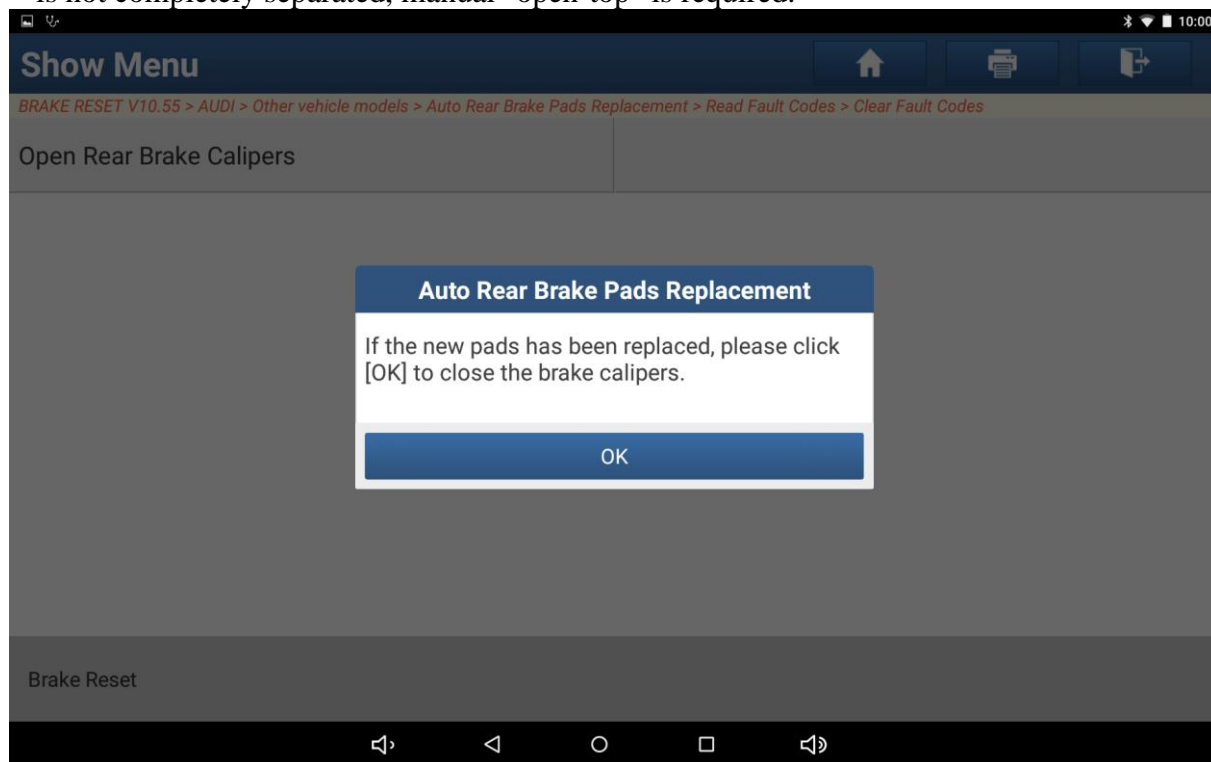

Figure 14

16) After the brake pads are replaced, click OK. The "Close Rear Brake Calipers" menu is displayed. See Figure 15.

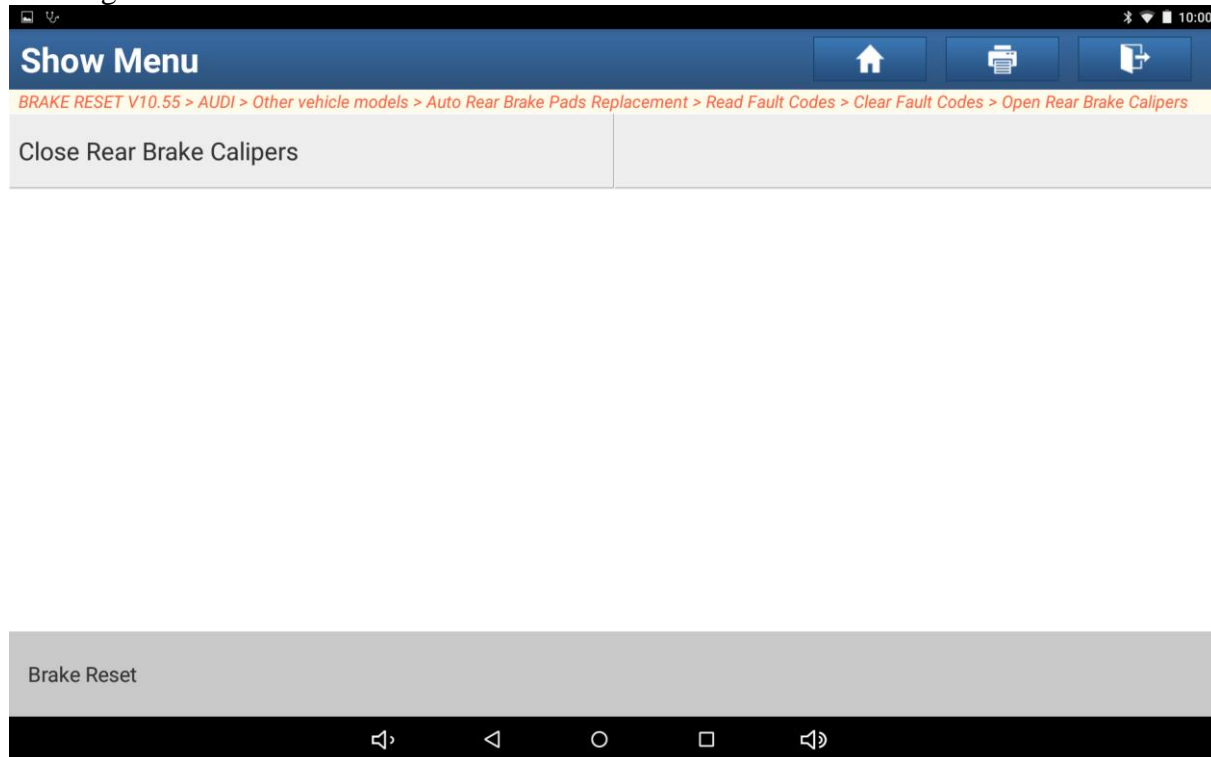

Figure 15

17) Choose "Close Rear Brake Calipers". The conditions for closing rear brake calipers are displayed. See Figure 16.

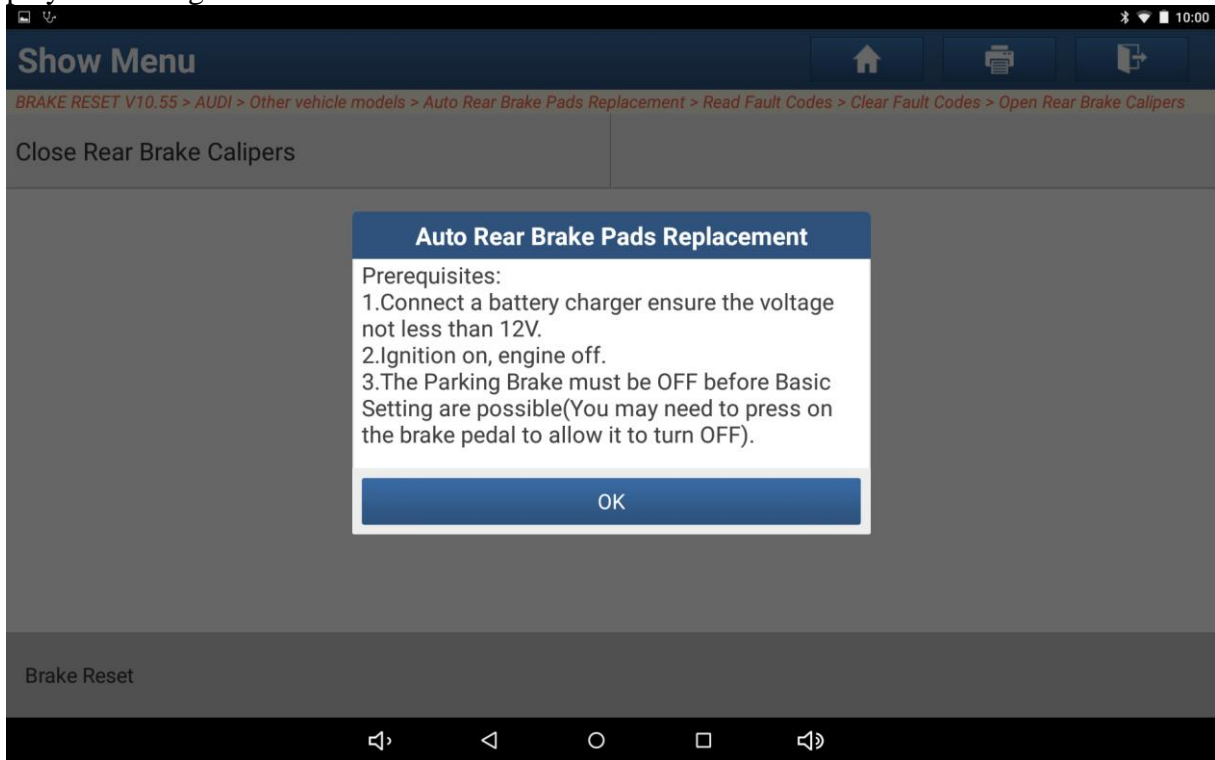

Figure 16

18) If the conditions are met, click OK. See Figure 17.

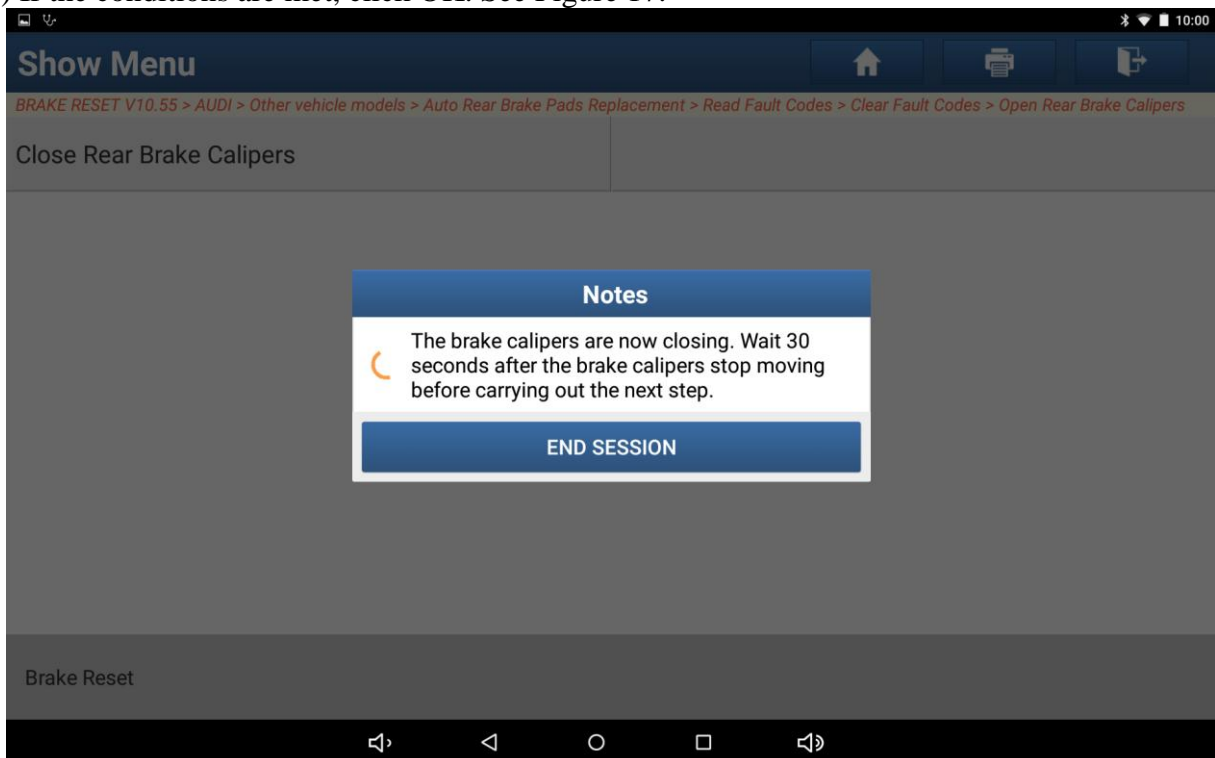

Figure 17

19) Wait for about 30s. The brake calipers have been closed. See Figure 18.

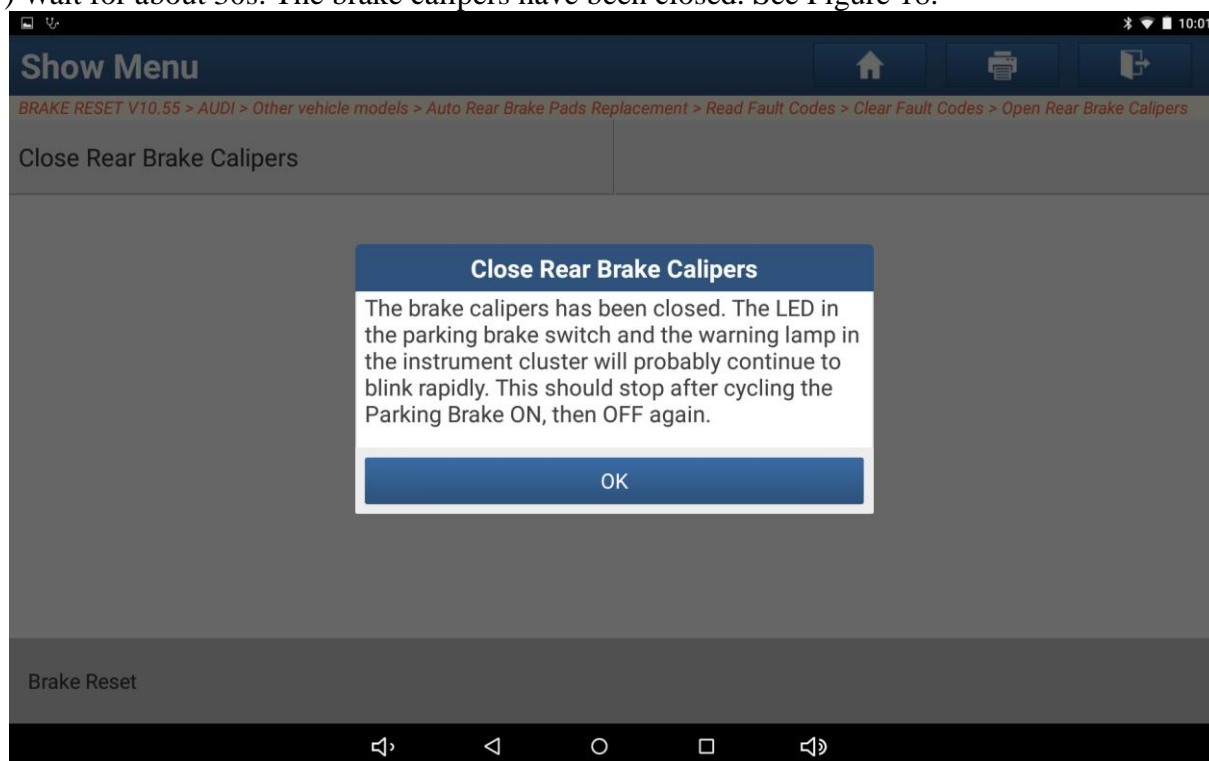

Figure 18

20) Click OK. Brake pad replacement is completed. See Figure 19.

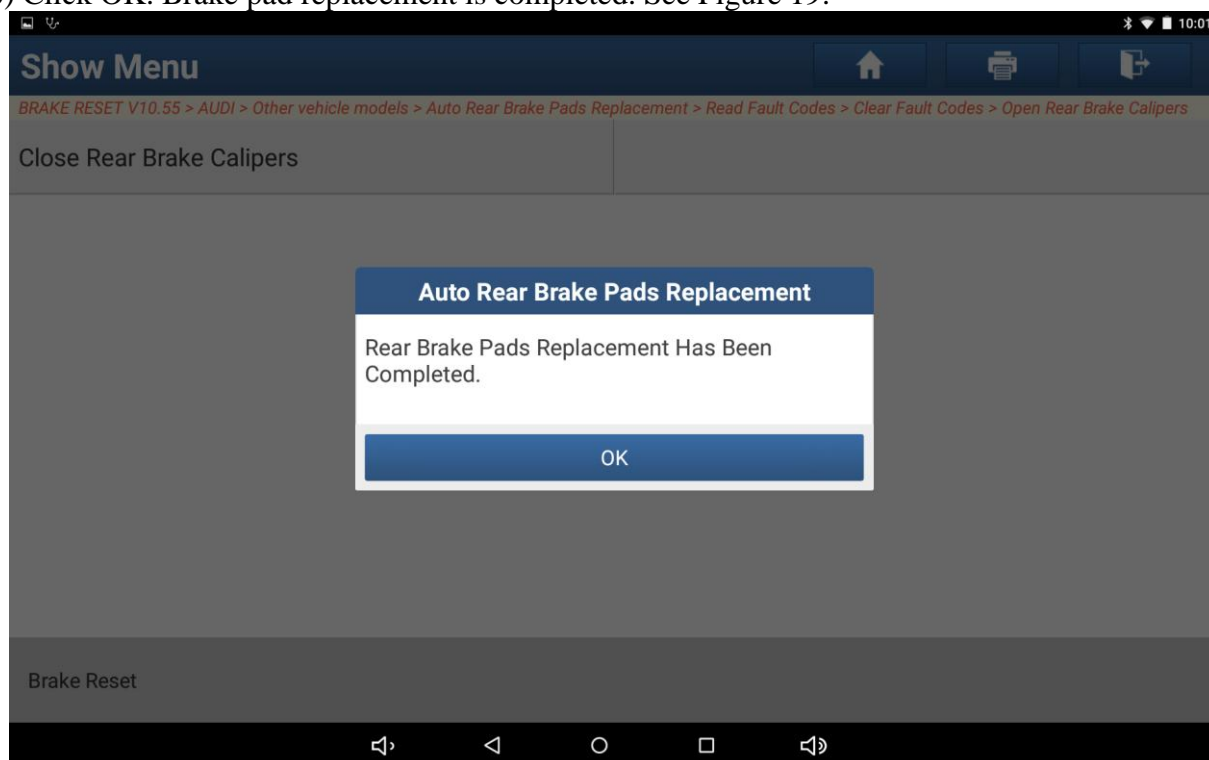

Figure 19

LAUNCH is dedicated to pursuing good functions and addressing customer needs. Follow LAUNCH, you will "make a little progress every day"!

