

## **2016 GM Envision Open Cylinder Operation Steps After Replacing The Brake Pad**

### **Course Introduction:**

This lesson takes 2016 GM Envision as an example, video explanation of problem solving by remote real car operation. The car must be replaced because the rear brake pads are worn. The course mainly explains the use of X431 PRO3 to solve the problem. After the model is replaced, the brake pads retract and the rear cylinder is extended.

### **Model Name:**

SGM ENVISION 2016

### **Malfunction:**

Rear brake pads worn

### **Repair Item:**

Replace the rear brake pads

### **Solution:**

After replace the brake pads, open the brake master cylinder

### **Use Equipment:**

Launch X431-PRO 3

### **Software Version:**

CN GM V51.40

### **Operation Guide:**

#### **Starting Conditions:**

The vehicle stops stability, and then disassembles the rear tires, release the handbrake, and make sure the battery voltage is above 12V.

## X431 Technical Bulletin

1. Turn on the ignition switch and do not start, select the China general model software to enter, select special functions;

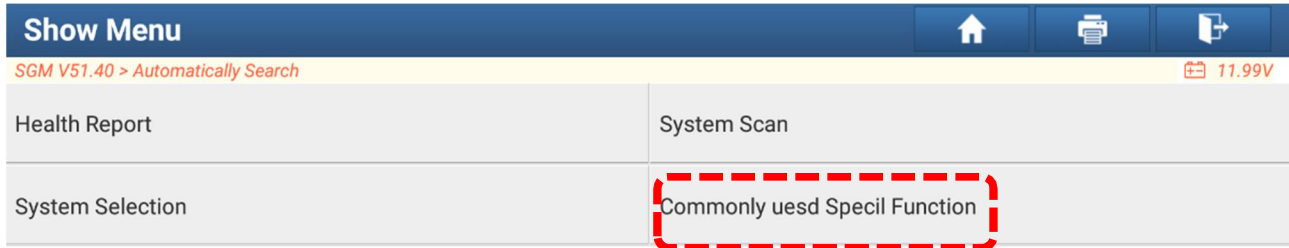

SGM Envision 2016

2. Follow the steps to select the vehicle type and configuration and get in;

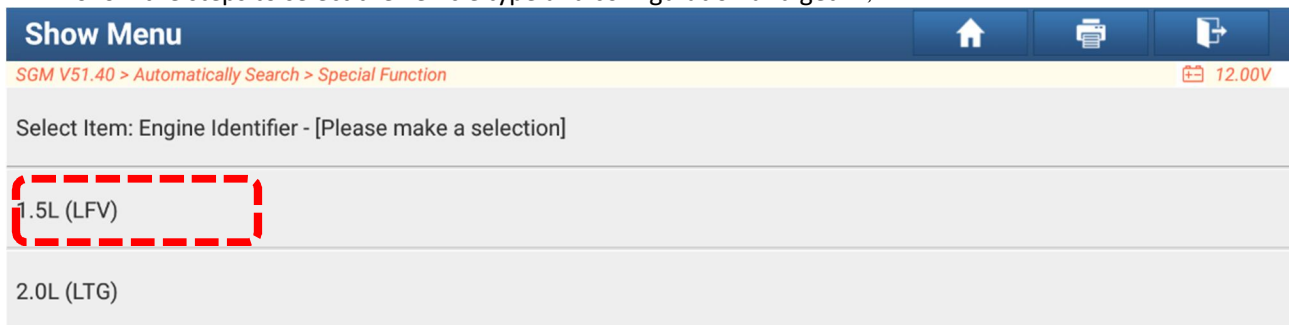

SGM Envision 2016

## X431 Technical Bulletin

3. Select the option 'Rear brake caliper piston retract (preparing to change the brake pads)';

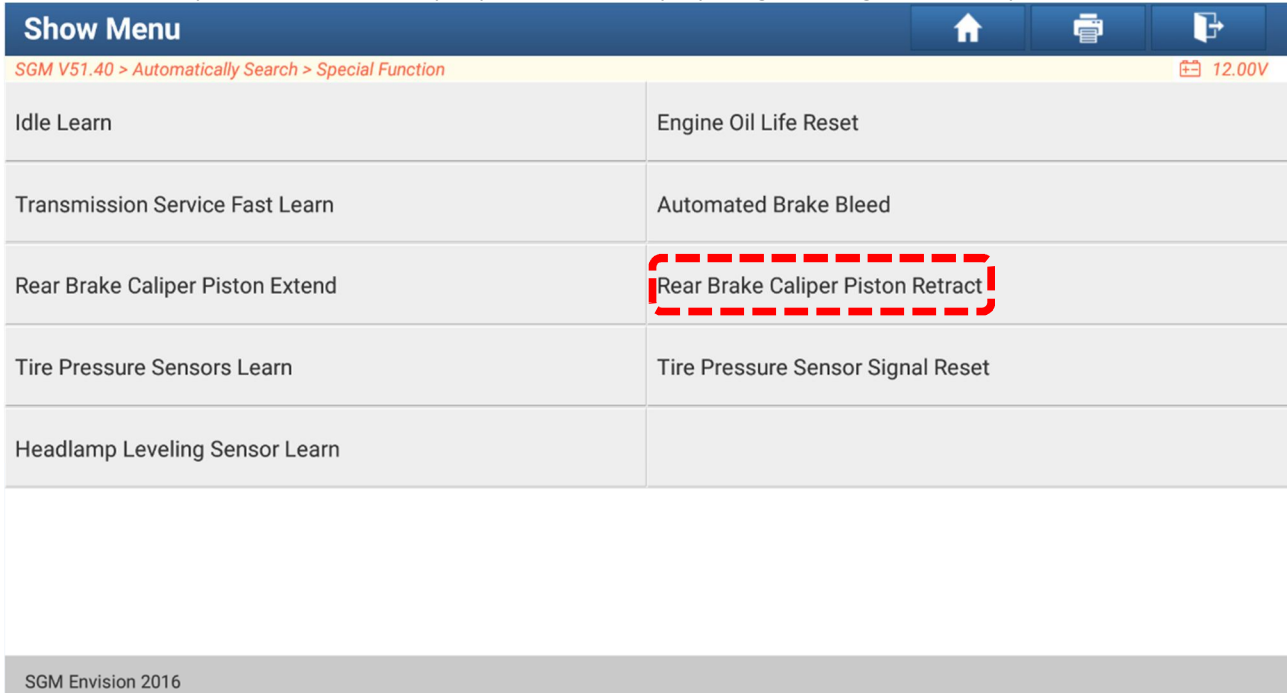

a) Pay attention to the prompt information as the follow screenshot display and meet the conditions to determine;

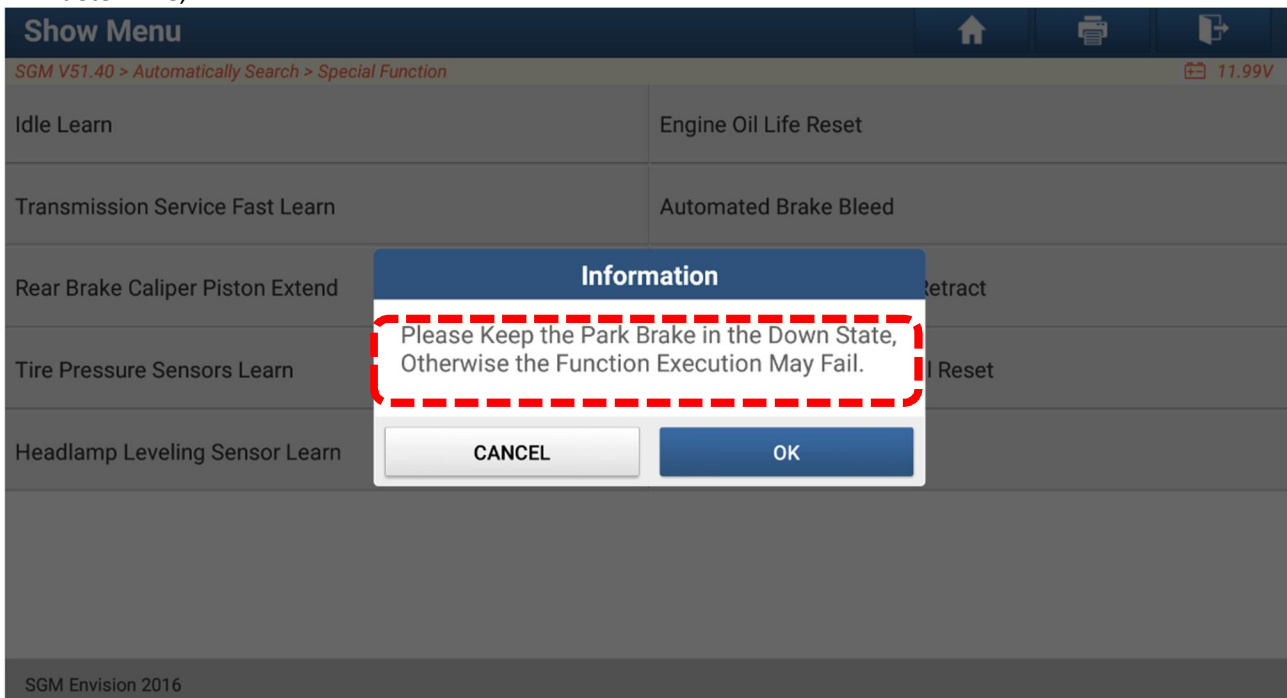

4. Do not start the vehicle, click to retract;

Rear Brake Caliper Piston Retract

SGM V51.40 > Automatically Search > Special Function

11.96V

Name	State	Unit
Command State	None	
Park Brake Switch	Applied	
Left Park Brake Actuator Voltage	0	V
Left Park Brake Actuator Status	Released	
Left Park Brake Actuator	On	
Left Park Brake Actuator Direction	Apply	
Right Park Brake Actuator Voltage	12.00	V

Exit

Retract

SGM Envision 2016

5. After the command status is displaying retracted, and checked the cylinder is fully recovered, you can operate to replace the new brake pads;

Rear Brake Caliper Piston Retract

SGM V51.40 > Automatically Search > Special Function

12.01V

Name	State	Unit
Command State	Retract	
Park Brake Switch	Applied	
Left Park Brake Actuator Voltage	0	V
Left Park Brake Actuator Status	Released	
Left Park Brake Actuator	On	
Left Park Brake Actuator Direction	Apply	
Right Park Brake Actuator Voltage	12.00	V

Exit

Retract

## X431 Technical Bulletin

6. After installed the brake pads ,need extend and operate the hand brake make sure it can normally work, then click exit and yes;

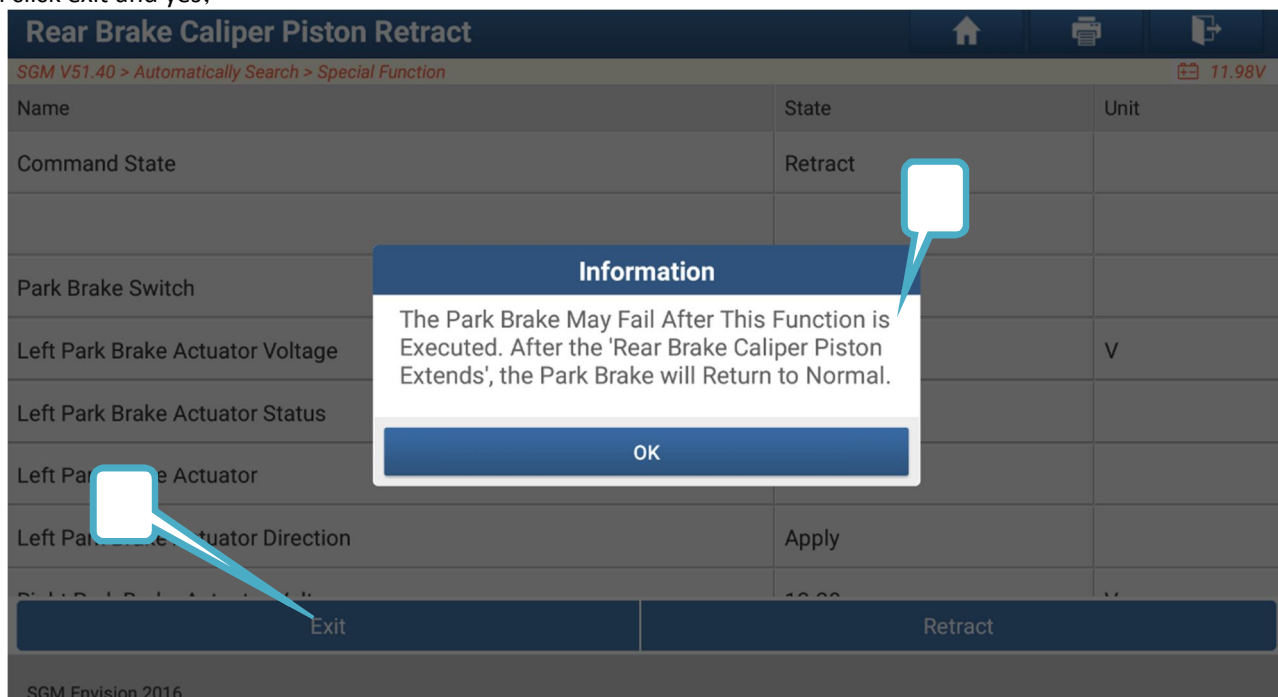

7. Select the option“Rear brake caliper piston extended (function performed after replacing brake pads)”;

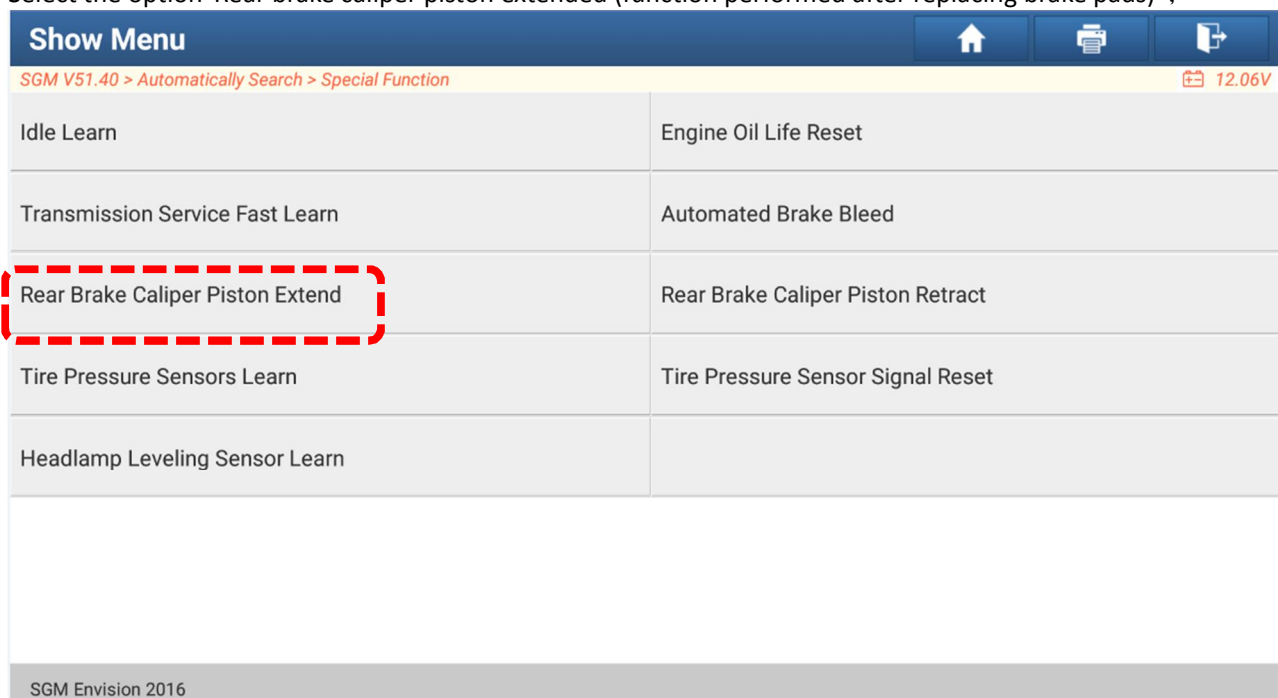

## X431 Technical Bulletin

8. Pay attention to the prompt information as the follow screenshot shown and meet the conditions to determine;

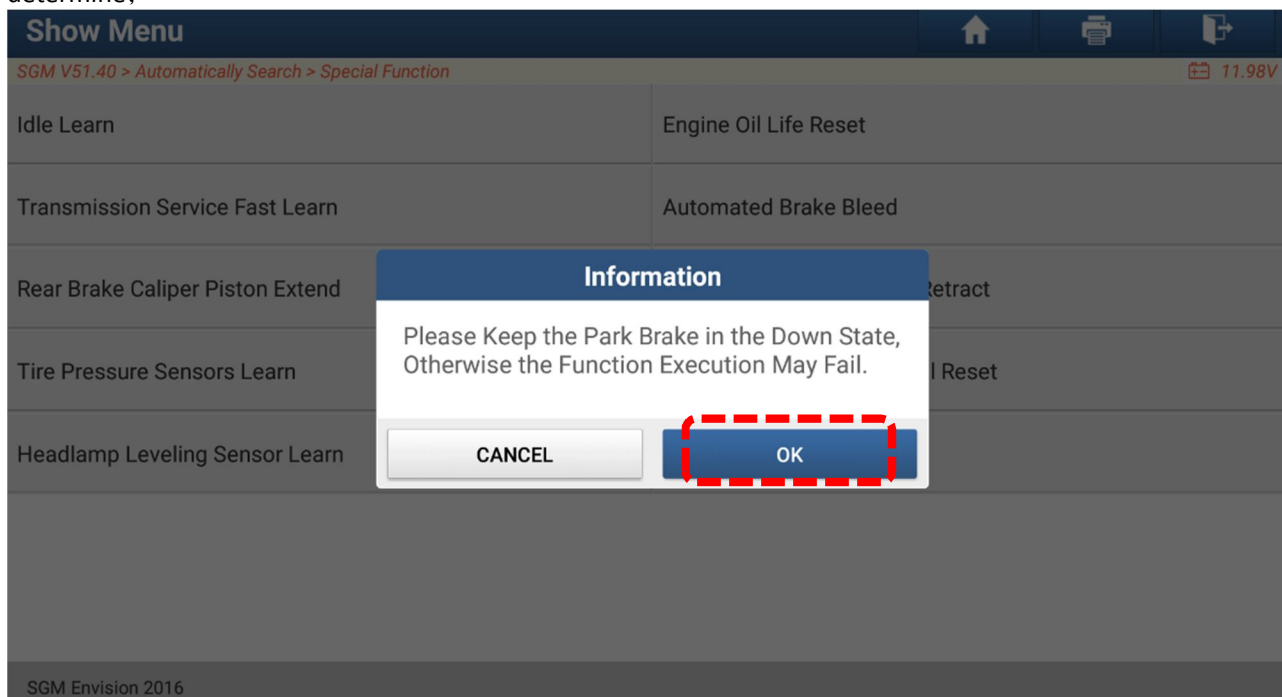

9. Click option Apply. When the command status shows that it has been applied, observe that the cylinder is fully extended, click exit to test whether the handbrake is normal.

