

2009 and 2013 BMW Brake RESET Operation _ EN

Measured models:

BMW 520D, F07 chassis, 2009 model, VIN = WBASN62000C *****

BMW 320D, F31 chassis, 2013 models, VIN = WBA3K320X0F *****

Precautions:

Set the ignition switch to the ON position;

The parking brake is released and the instrument parking warning light goes out;

After updating the rear axle brake caliper or brake, the parking brake needs to be operated multiple times before it can provide the normal parking brake function.

Operate patiently as required.

Steps:

1. Select brake reset software V10.20 or higher;
2. Select "BMW";
3. The prompt message Turn on the ignition will be displayed, click OK to continue;
4. Select "Manual Selection";
5. Select "Wheel Brake Reset";
6. Select the "5 Series" menu;
7. Select the "5'_GT (F07)" menu;
8. The message VIN (Vehicle Identification Number) will be displayed, click OK to continue;

9. The whole process is divided into two steps: retracting the brake cylinder mode; releasing the brake cylinder mode. The first step is to select the "retracting brake cylinder mode";

10. Note that in order to reach the installation location, the following conditions must be met:

- a) Ignition switch is on
- b) Vehicle is stationary
- c) The parking brake has been released

11. Note the two split pump separation operations: the parking brake will be moved to the installation position and the installation mode will be activated. It takes about 5 seconds to reach the installation position. Also note that the EMF (Stop) button is frozen when the assembly mode is activated. At this time, the EMF button of the parking brake function is not available. To freeze the installation mode, the parking brake must be activated. Confirm to continue.

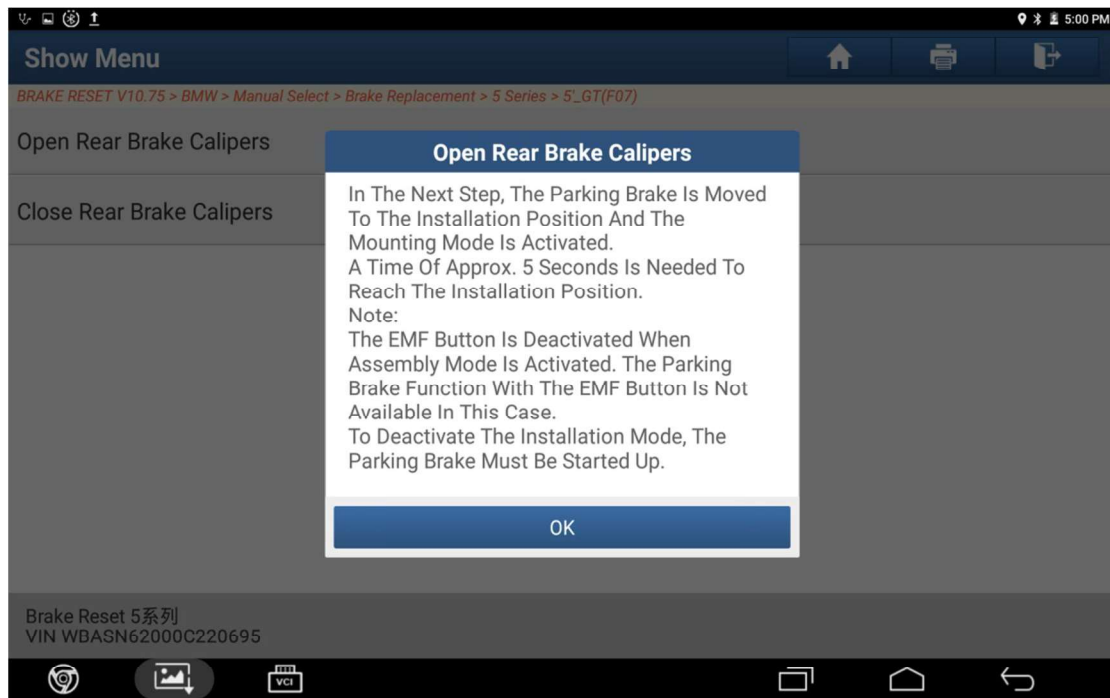

12. Pay attention to the prompt operation. After confirming that the brake cylinder is retracted, turn off the ignition switch. Now follow the instructions to repair the brake. The parking brake must be commissioned when exiting the installation mode.

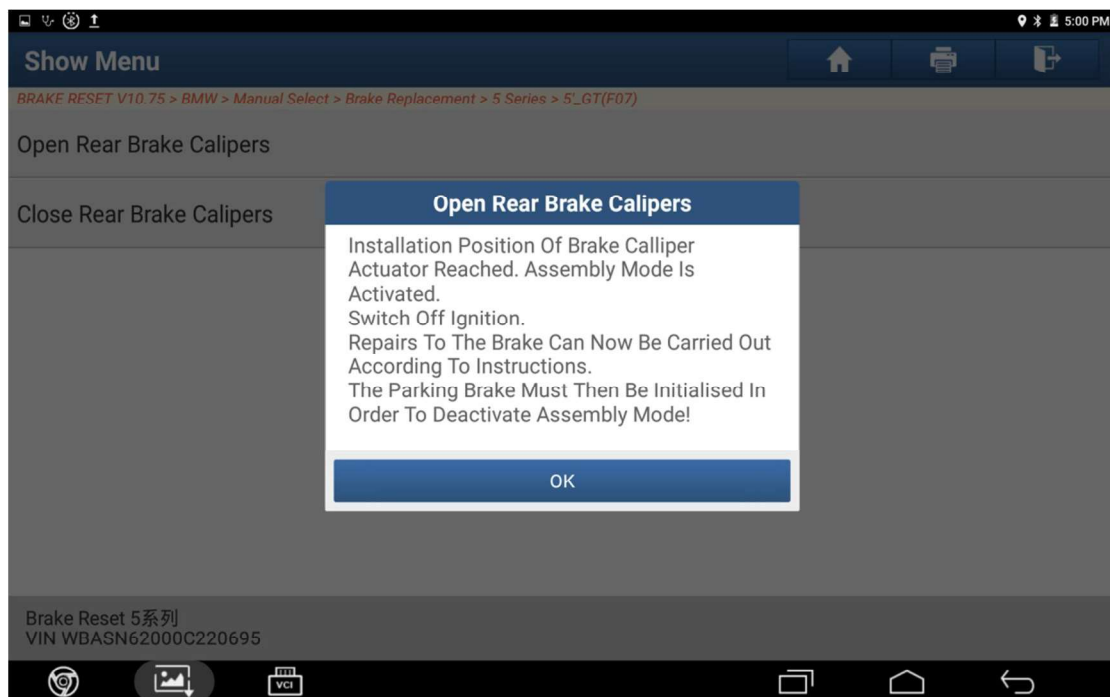

13. After clicking OK, the “Retract Brake Pump Mode” function is completed, and then the brake or calipers are replaced;

14. After the brake or calipers have been replaced, select and perform the second step “Release brake cylinder mode” function



15. Follow the instructions and use the maintenance function to activate the parking brake. You can run the parking brake by repeatedly releasing and adjusting the parking brake button by starting the parking brake button. Note whether there are four situations listed in Figure 4. If there is a need to activate the parking brake, it is also necessary to pay attention to the ignition switch must be turned on when starting, click OK to continue

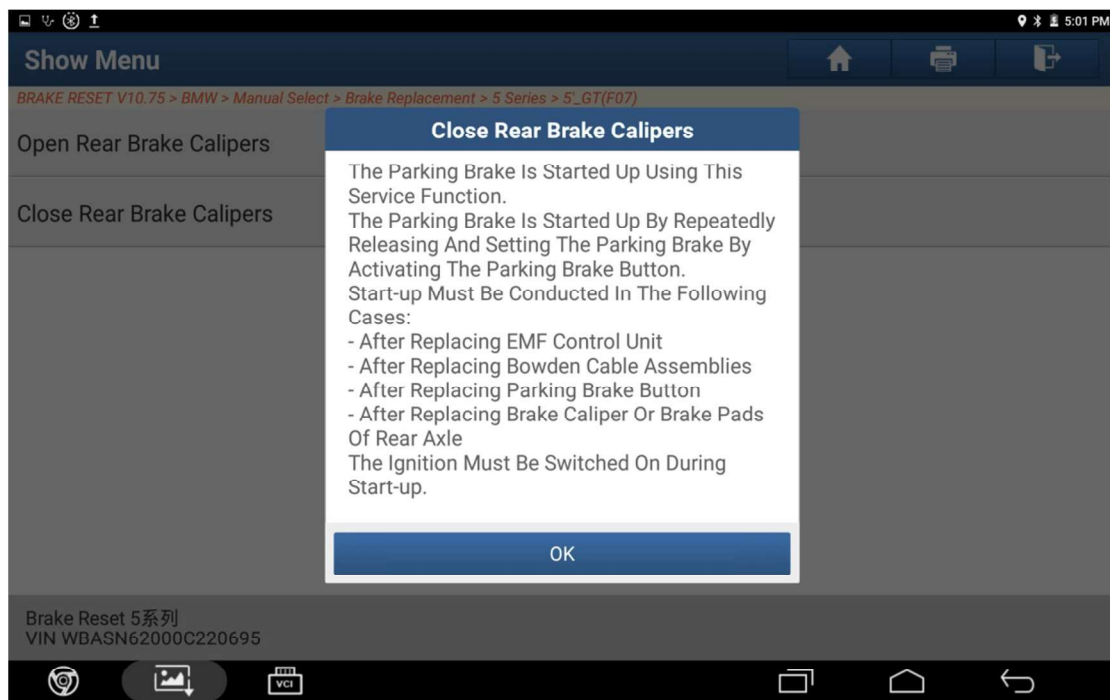

16. Follow the prompts and pay attention to the reminder "The installation mode was frozen at the start of the program", click OK to continue

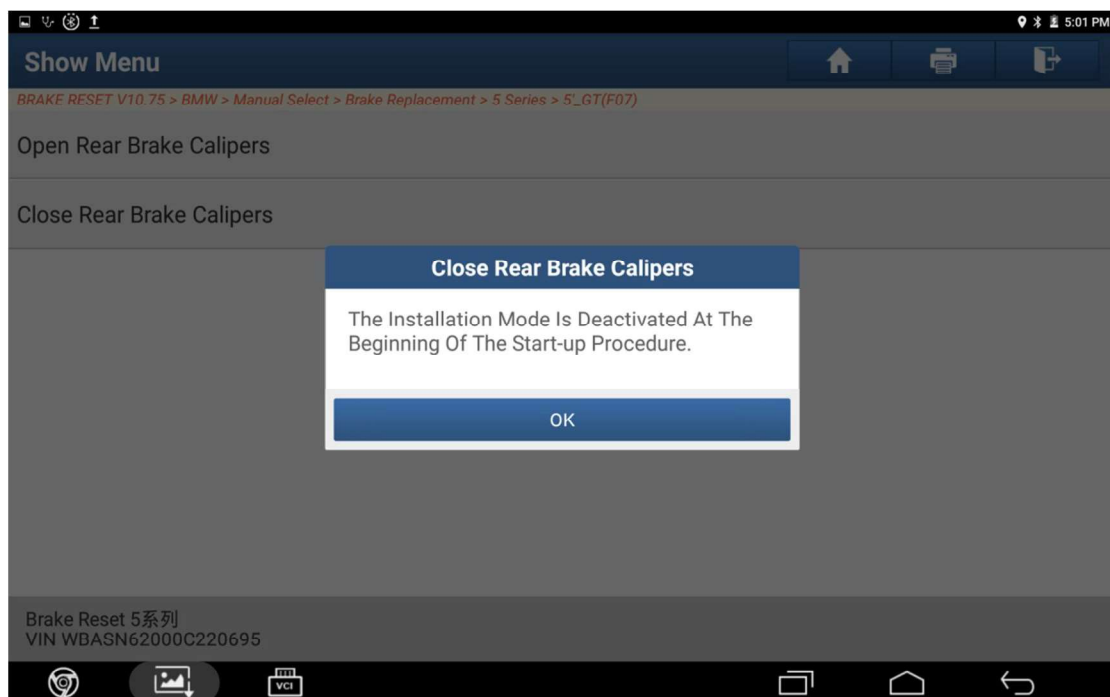

17. Follow the instructions and pay attention to the reminder that "the parking

brake must be released at the beginning of the start-up procedure. This requires activating the foot brake and pressing the parking brake button. It takes about 3 seconds to release the parking brake and can be heard" Click OK to continue.

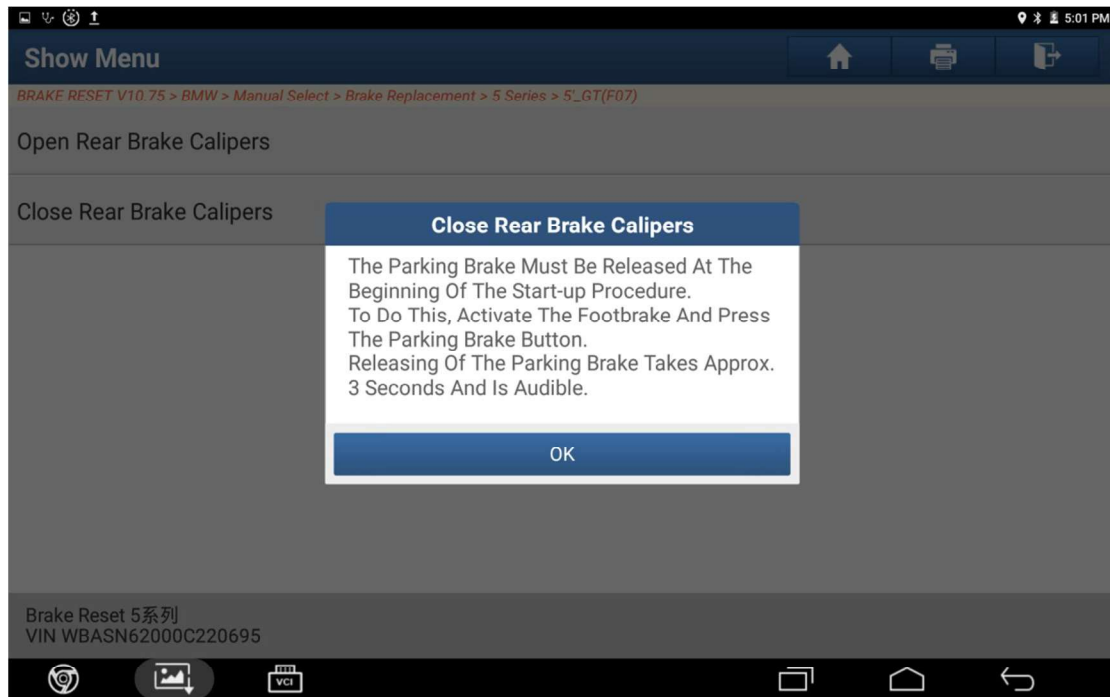

18. Set the parking brake, pay attention to the reminder "pull the parking brake button and wait for about 3 seconds, until the parking brake is set, the setting of the parking brake can be heard", click OK to continue

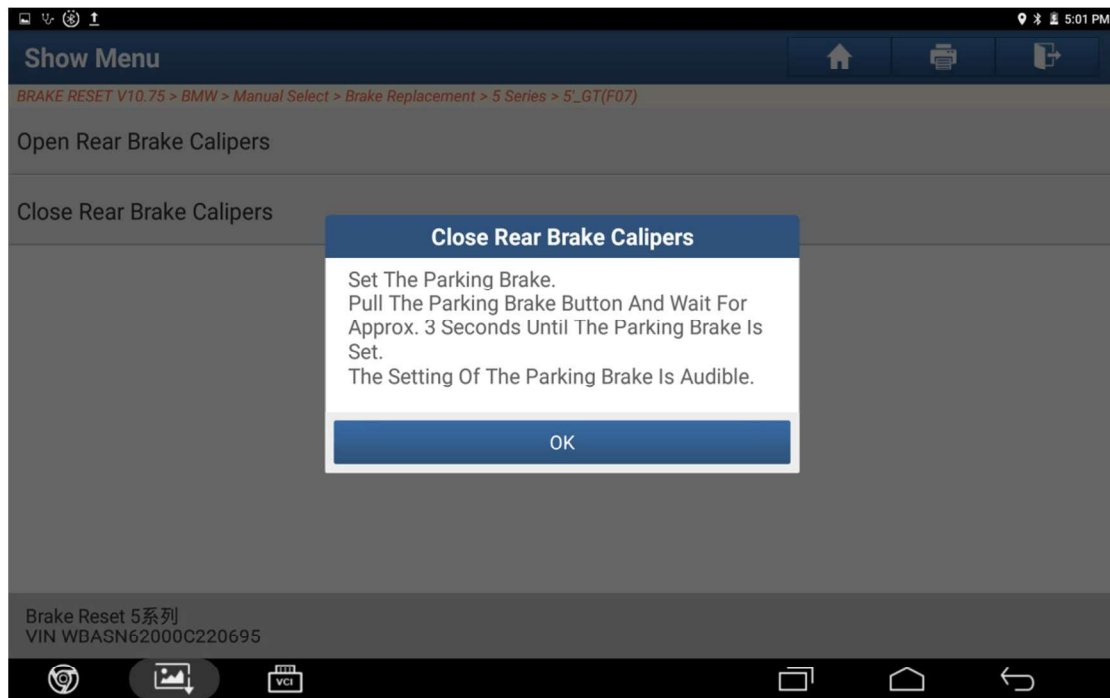

19. Set the parking brake, pay attention to the reminder "pull the parking brake button and wait for about 3 seconds, until the parking brake is set, the setting of the parking brake can be heard", click OK to continue

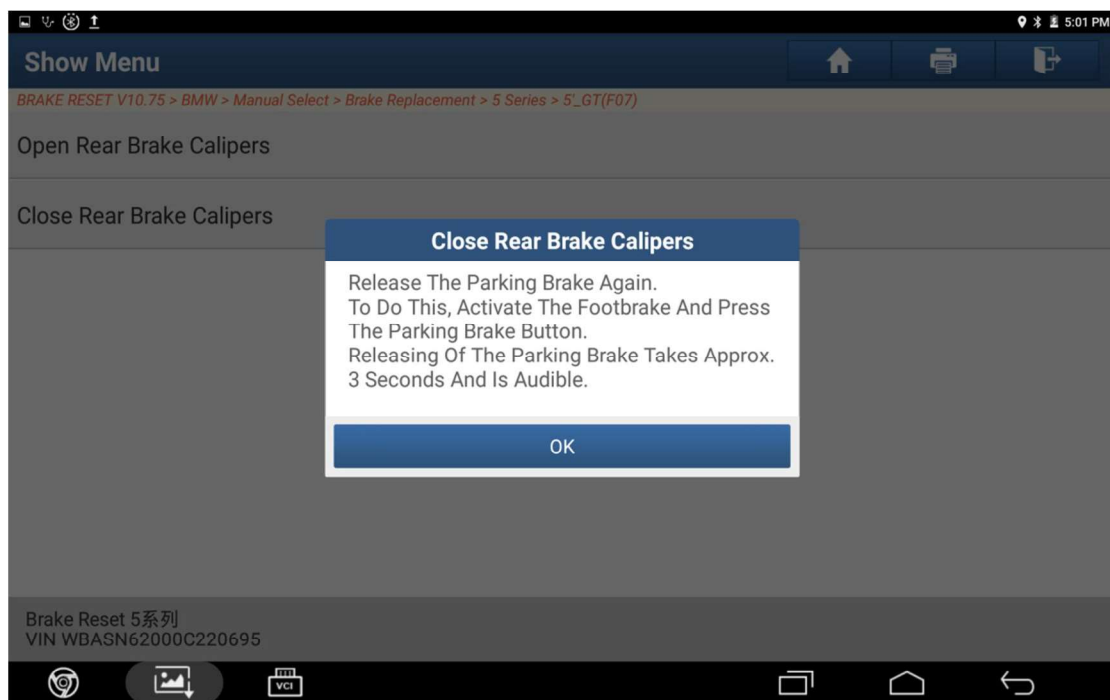

20. Prompt "Parking brake has been completed successfully". Tip: After updating

the rear axle brake caliper or brake, the normal parking brake function can only be provided after the forklift brake is operated multiple times.

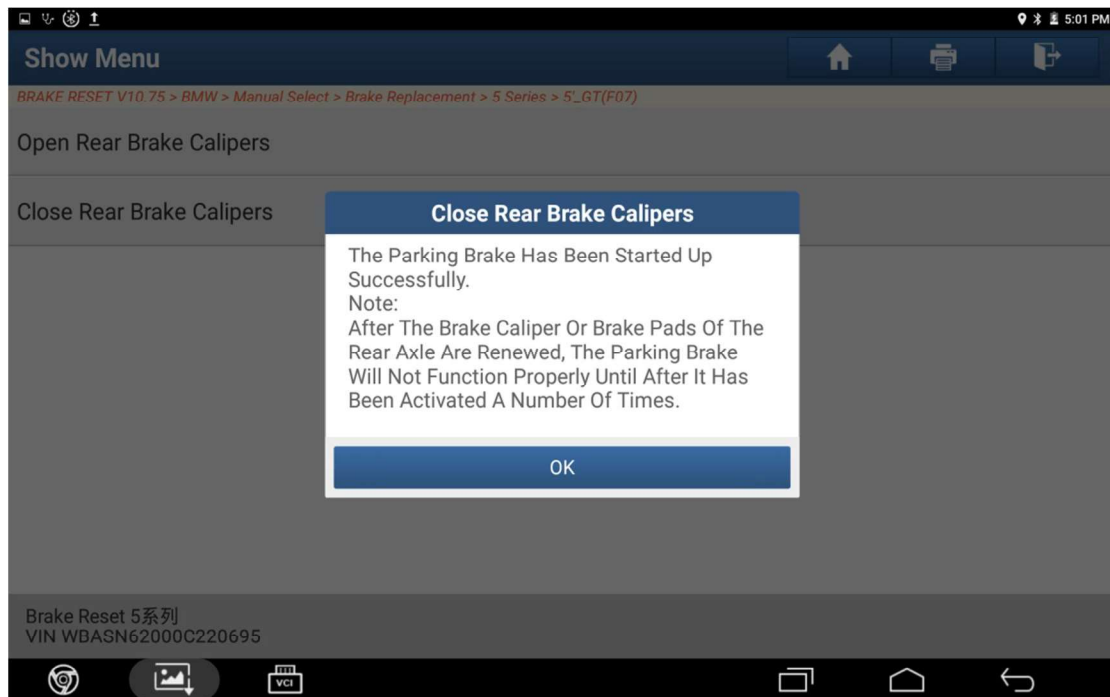

21. Click the OK button, and the function of "release brake cylinder mode" is completed.