

# Mercedes-Benz S600L

## Calibration Learning By Intelligent Servo Module

**Tested Model:** 2007 Mercedes-Benz S600 L, VIN: WDDNG76X9A16\*\*\*\*, as shown below:



## Function Description:

After replacement of this module, it is necessary to use PADIII to perform calibration learning.

## Operation Guideline:

1) Select "Local Diagnosis" -> "Mercedes", see Picture 1.

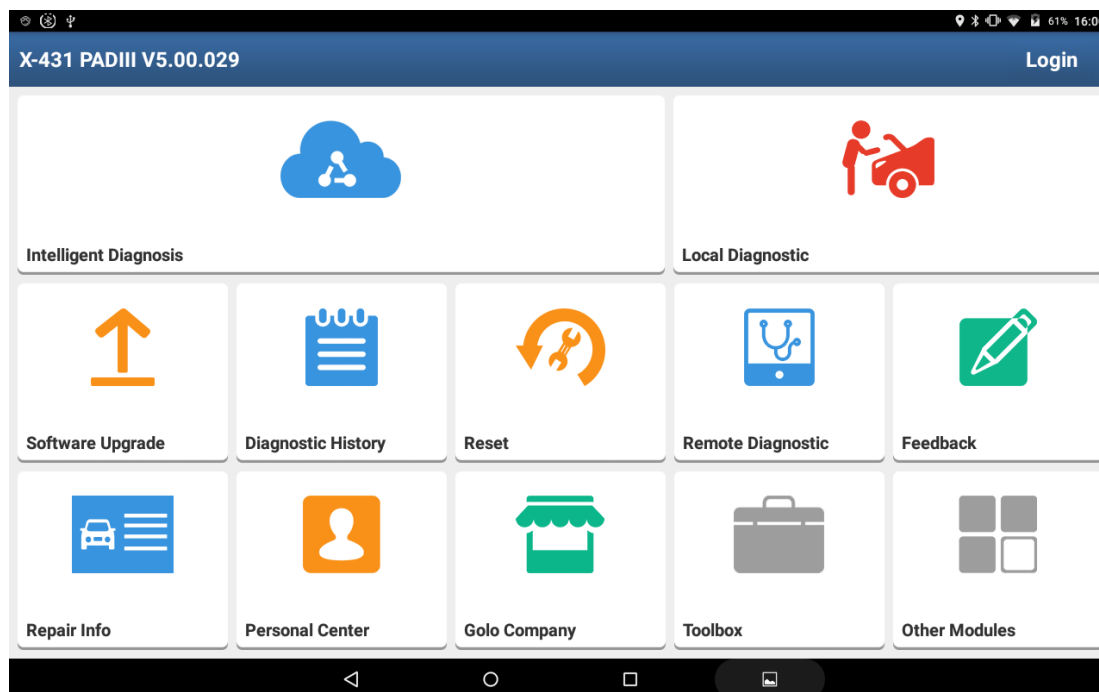

Picture 1

2) Select "Automatic Search", see Picture 2.

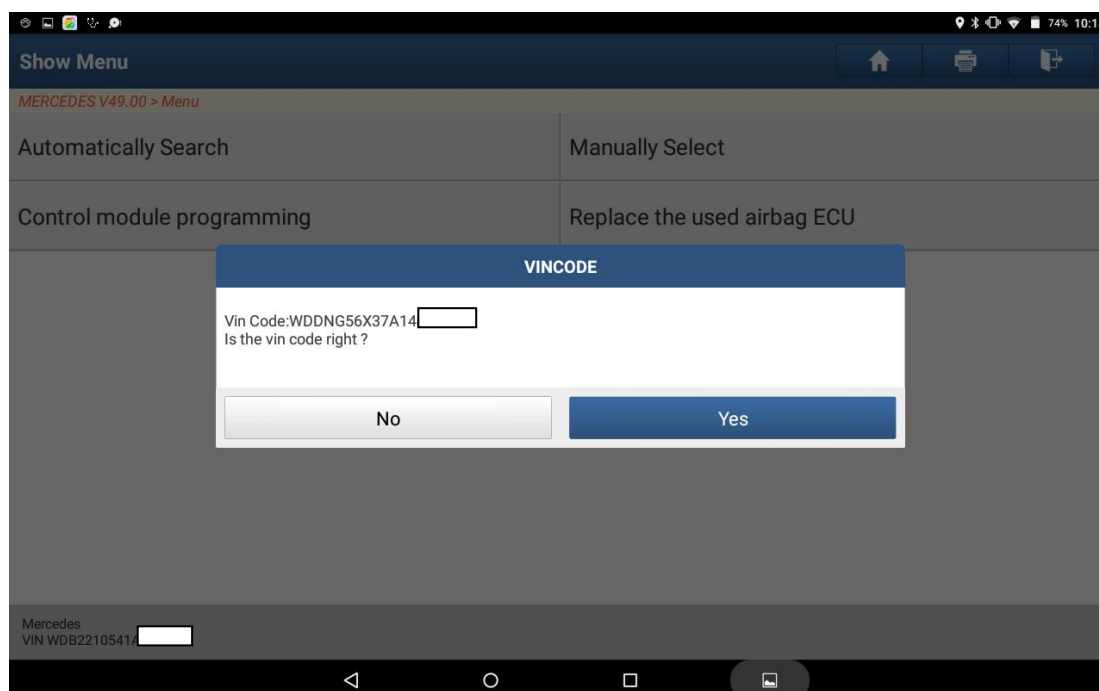

Picture 2

3) It displays the vehicle information, after confirmation, click OK, see Picture 3.

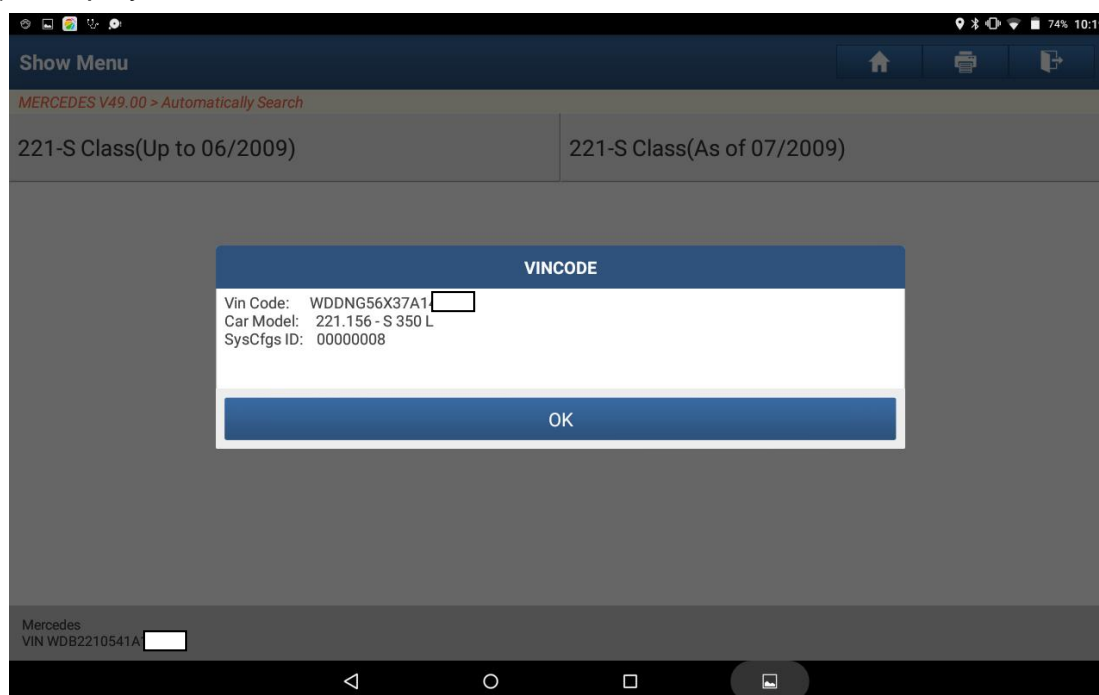

Picture 3

4) Select "System Scan", see Picture 4.

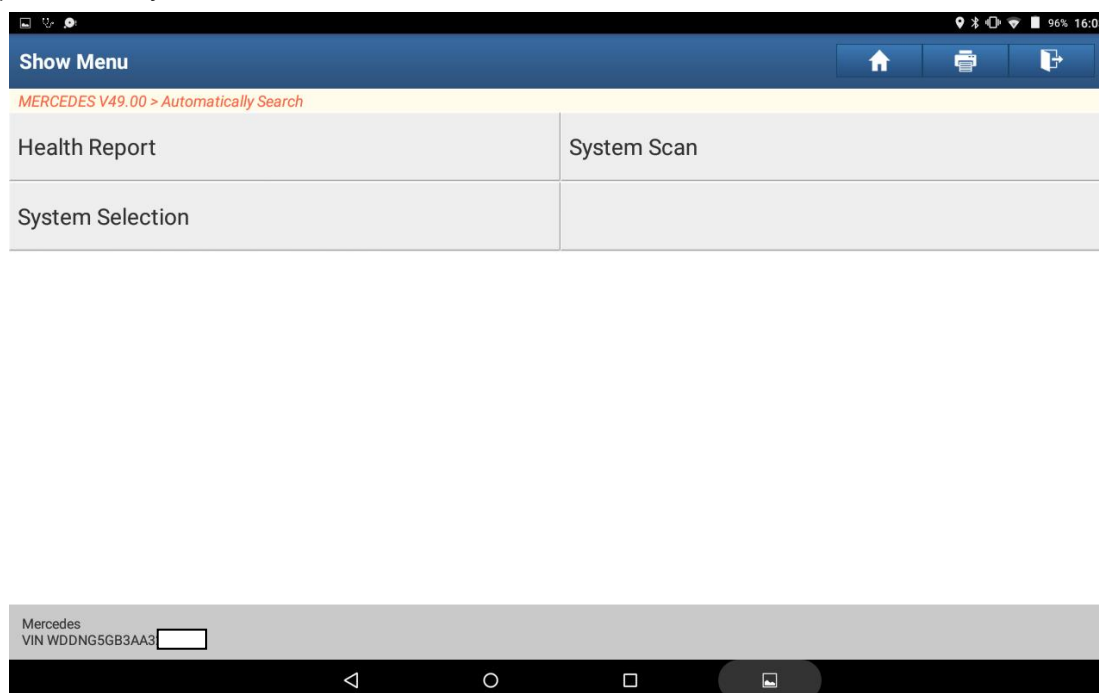

Picture 4

5) Select YES to start the test, see Picture 5.

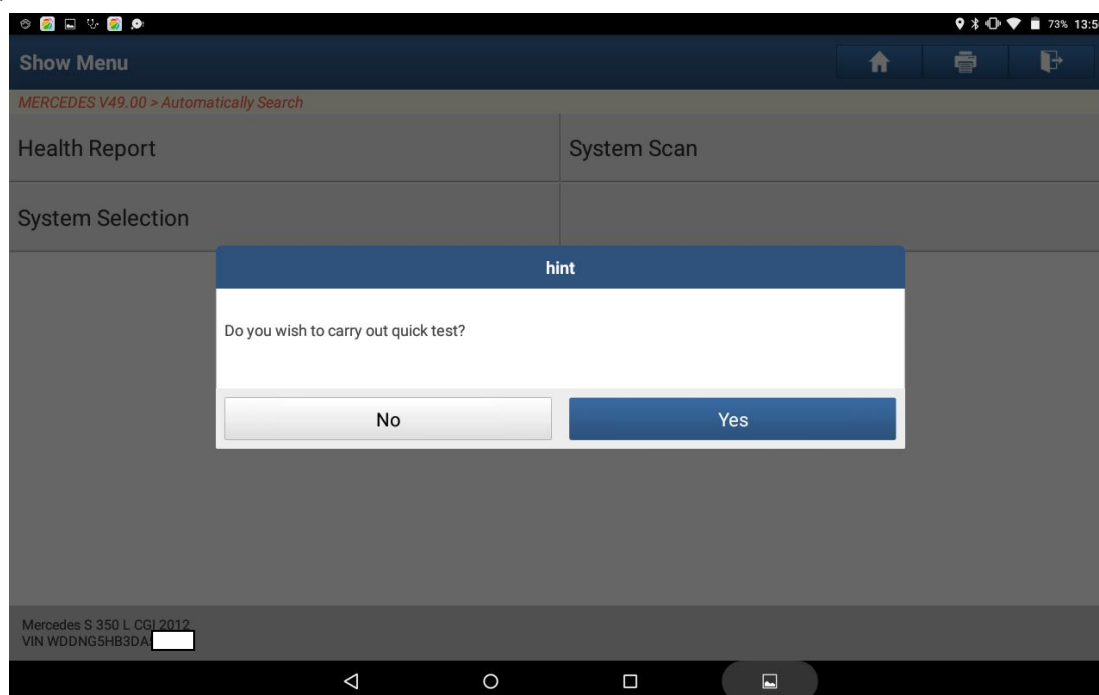

Picture 5

6) Switch on the ignition, then click OK, see Picture 6.

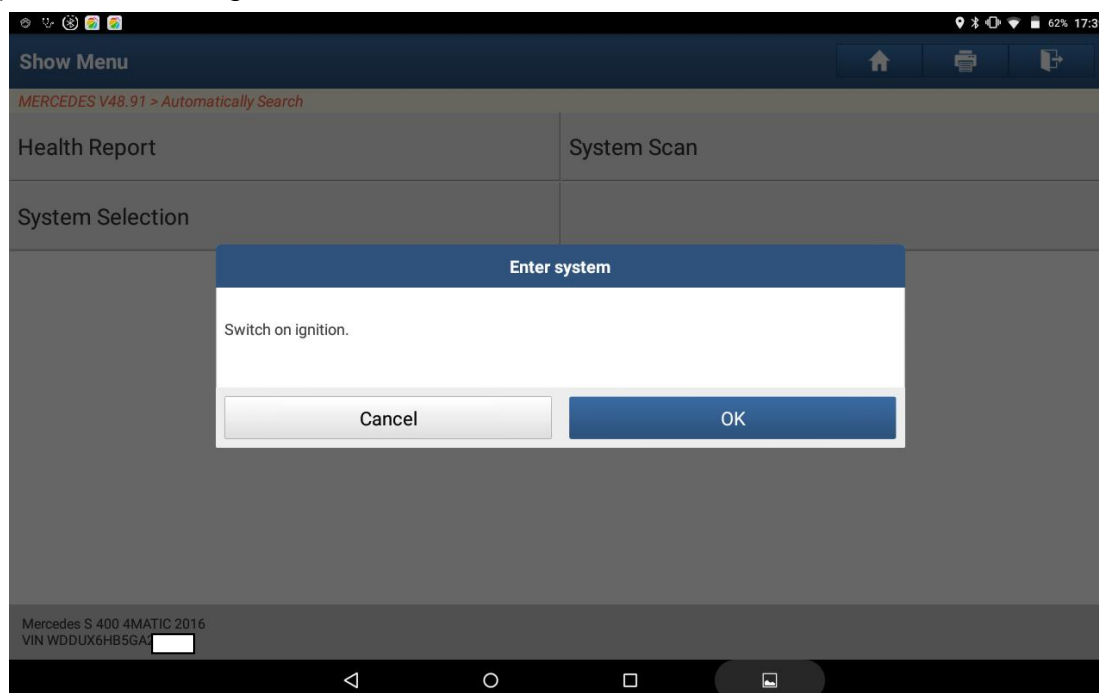

Picture 6

7) Scan the configured system by fast test, see Picture 7.

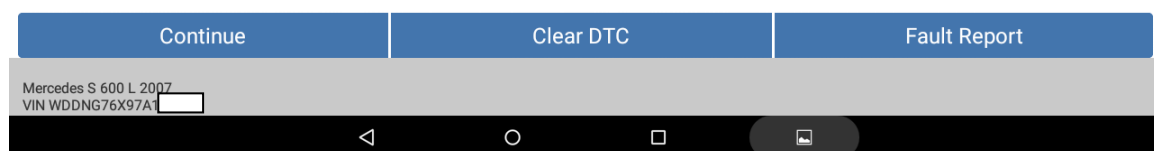
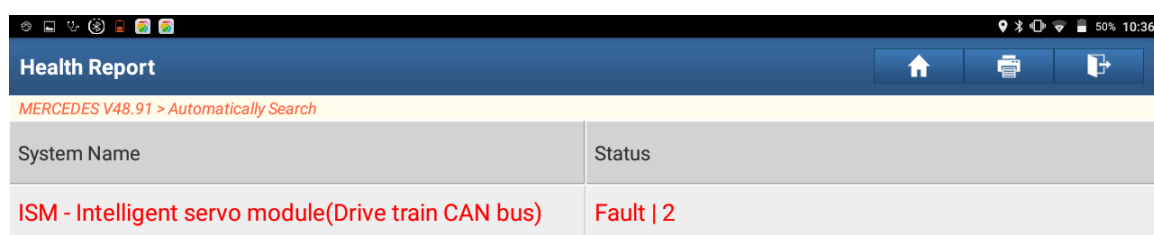

Picture 7

8) Select "Intelligent servo module". Turn on the ignition, click OK to enter the system, see Picture 8.

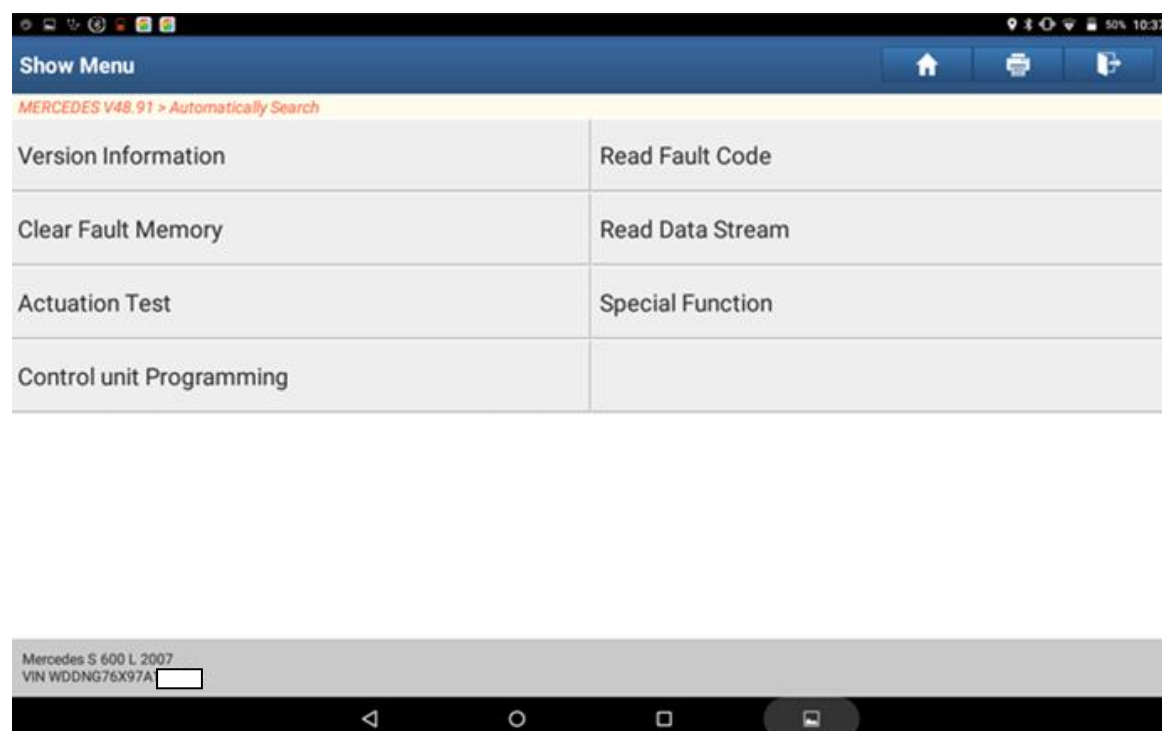

Picture 8

9) Select special function, see Picture 9.

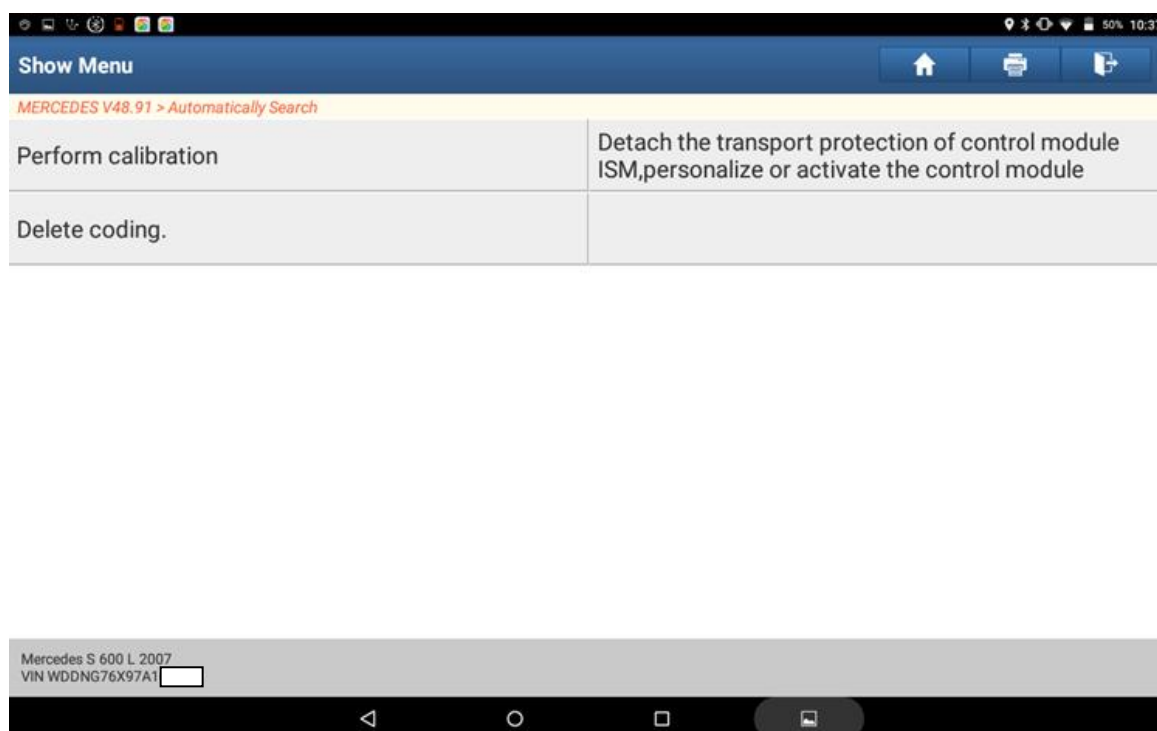

Picture 9

10) Select "Perform calibration". After confirming that the conditions are met, click YES to perform learning ISM, see Picture 10.

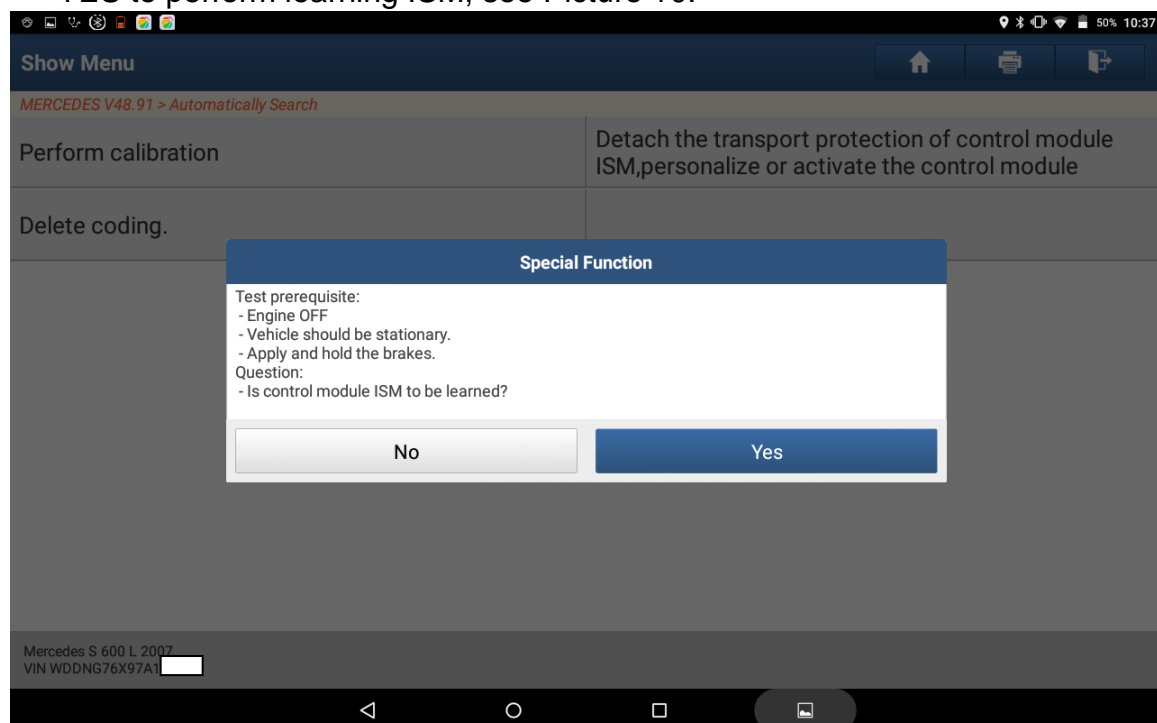

Picture 10

11) It prompts to wait, see Picture 11.

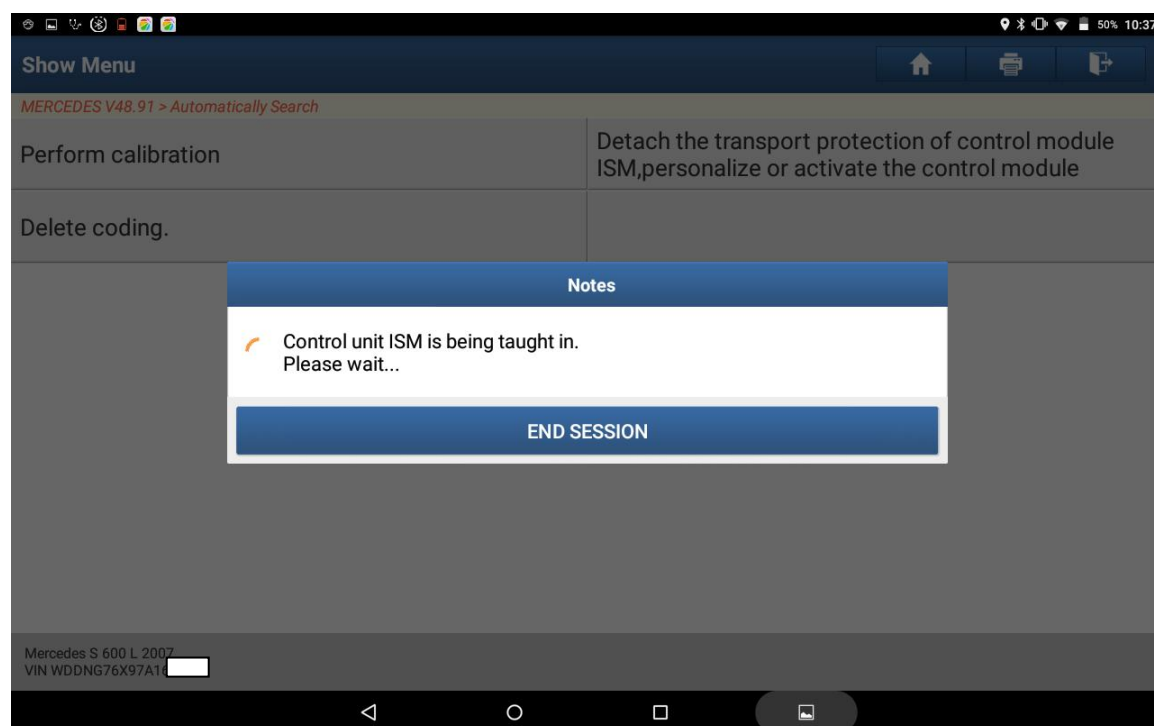

Picture 11

12) After successful calibration, click Back, see Picture 12.

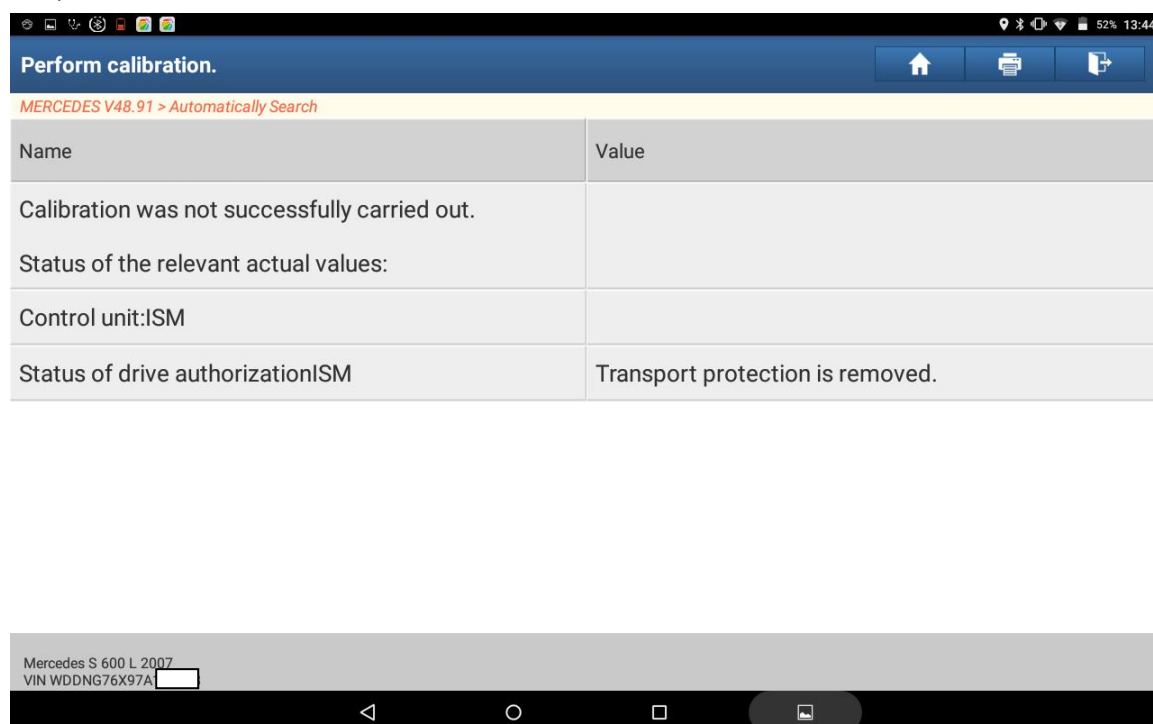

Picture 12

13) Follow the prompts to turn the ignition off and on, then click OK, see Picture 13.

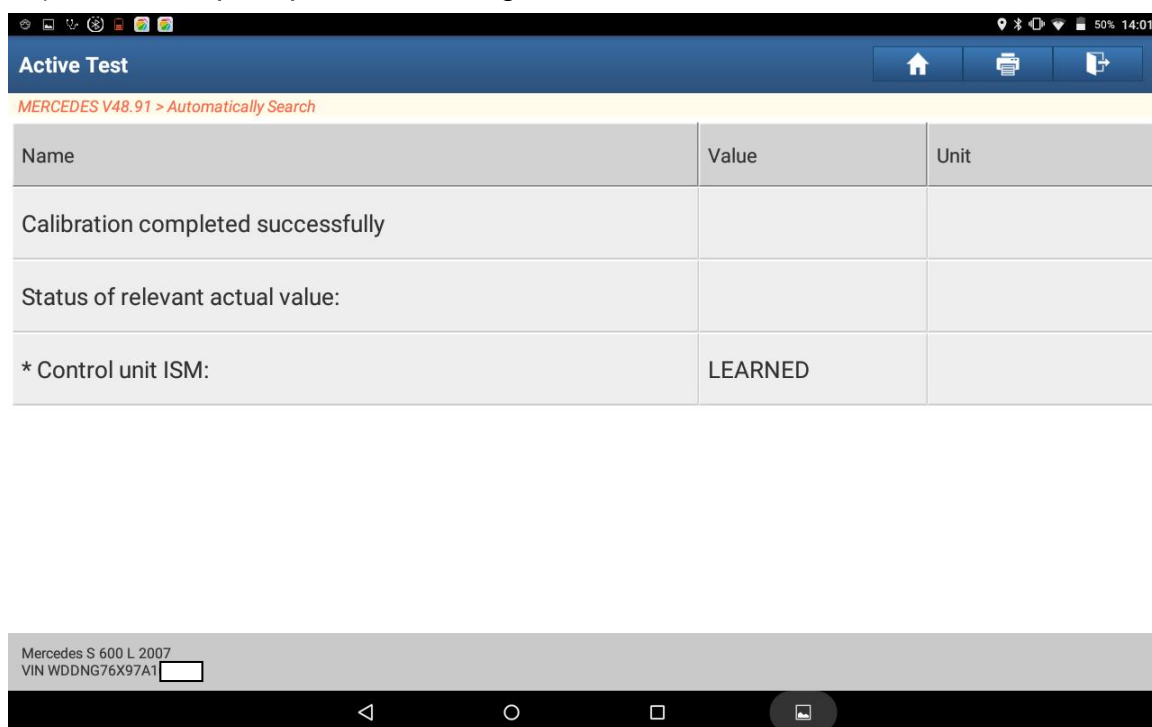

Picture 13

14) Calibration learning by Intelligent Servo Module has ended.

## Declaration:

The copyright of this document belongs to Launch Technology Co., Ltd. Any company or individual shall not quote or reprint without permission.