

2. 4M41-M/T

1

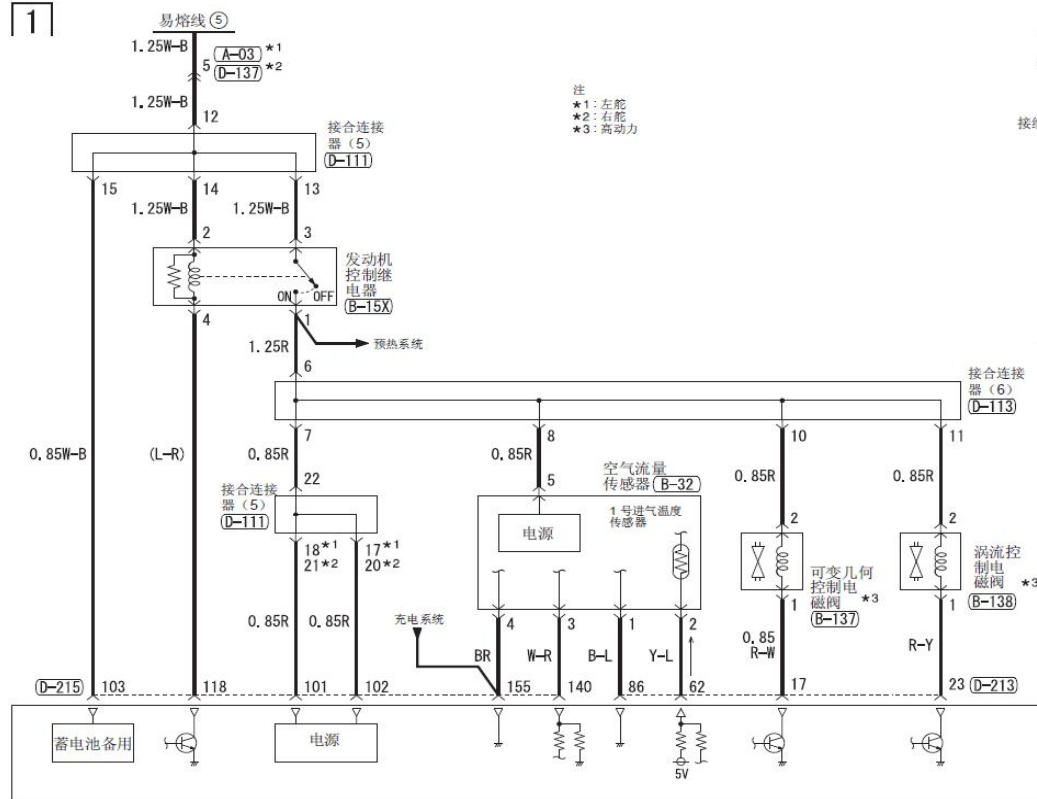

注
*1: 左舵
*2: 右舵
*3: 高动力

2

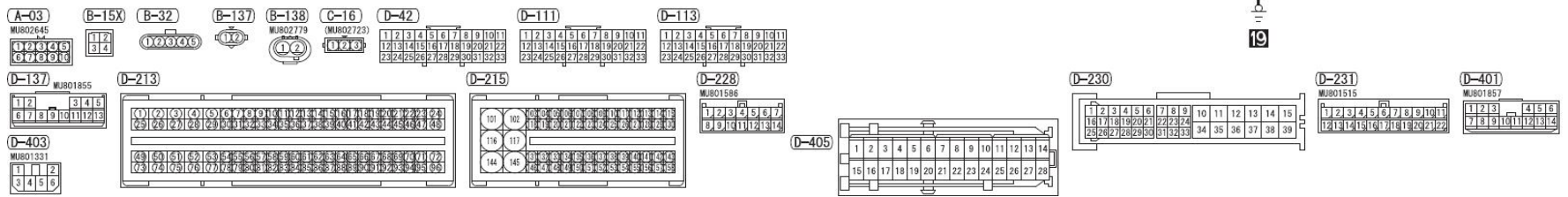
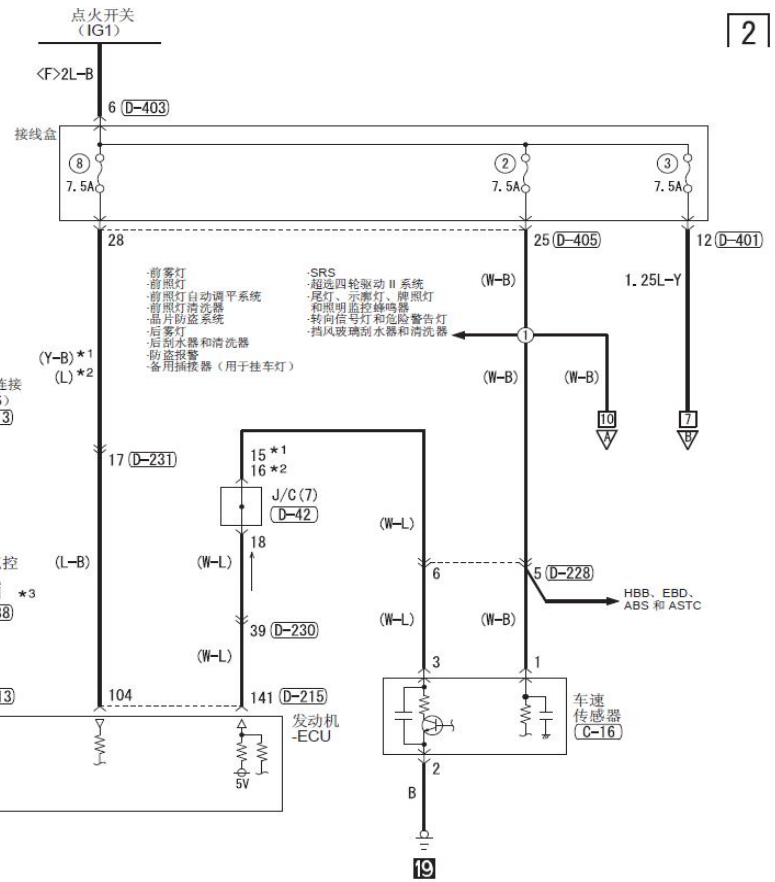

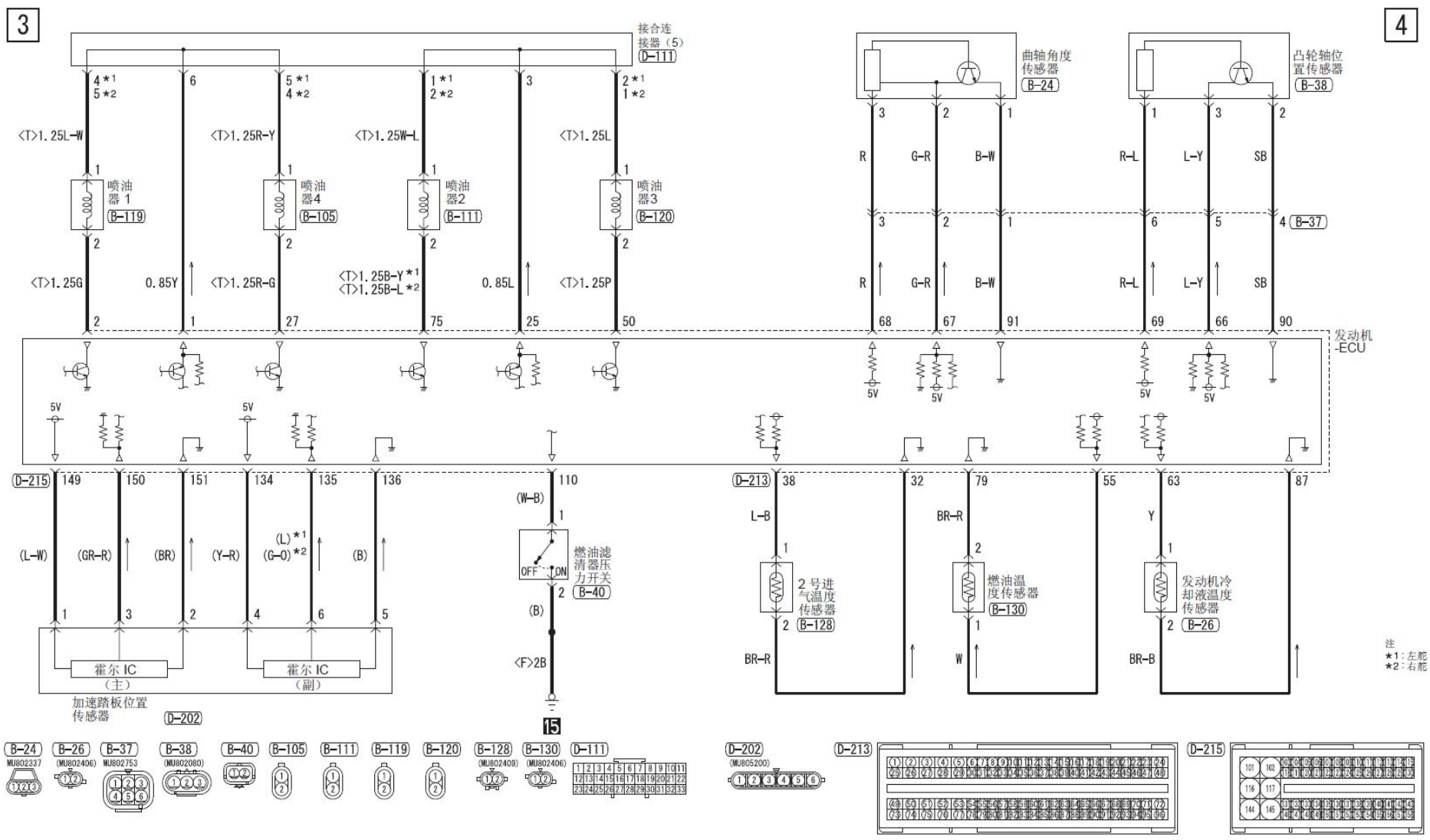

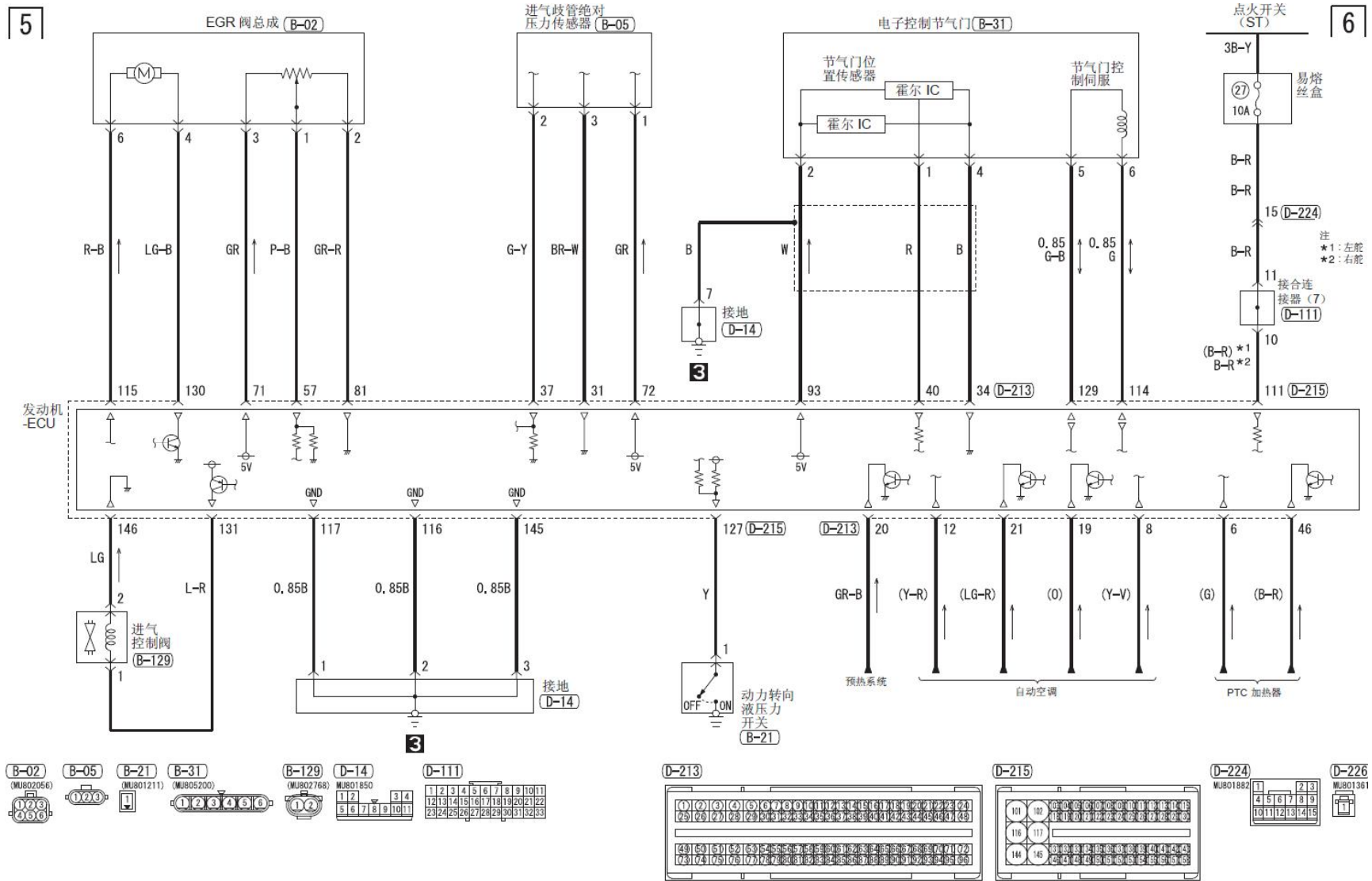

7

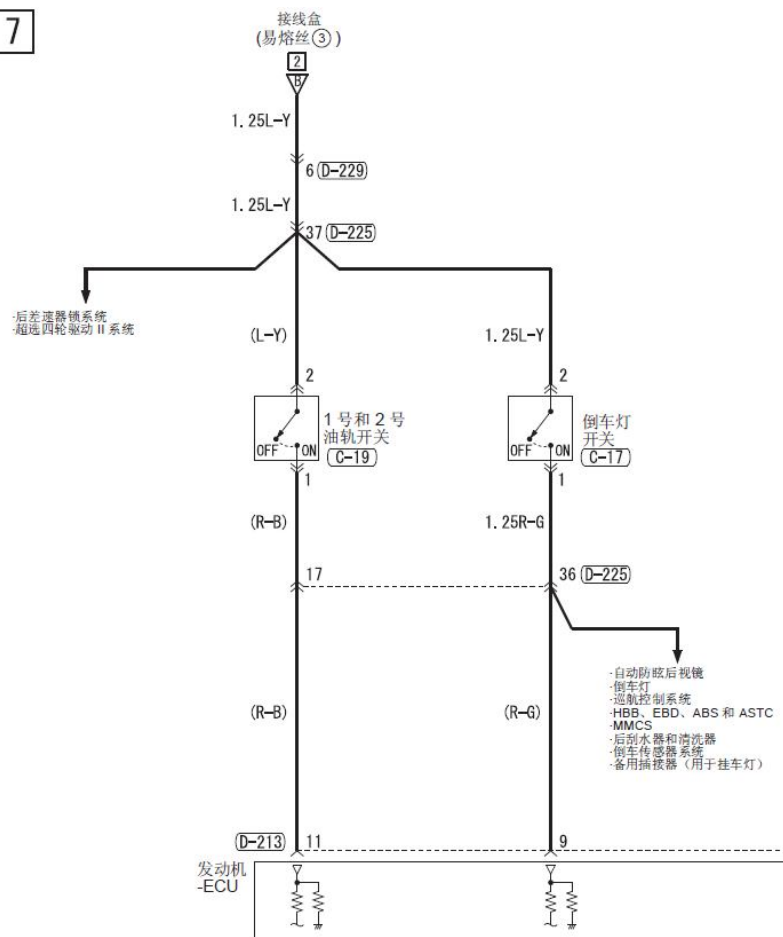

8

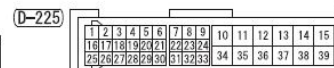
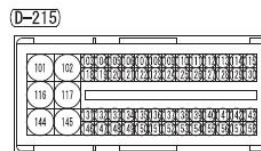
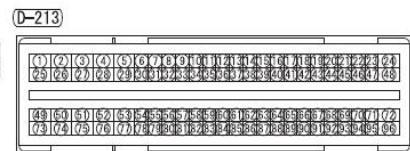
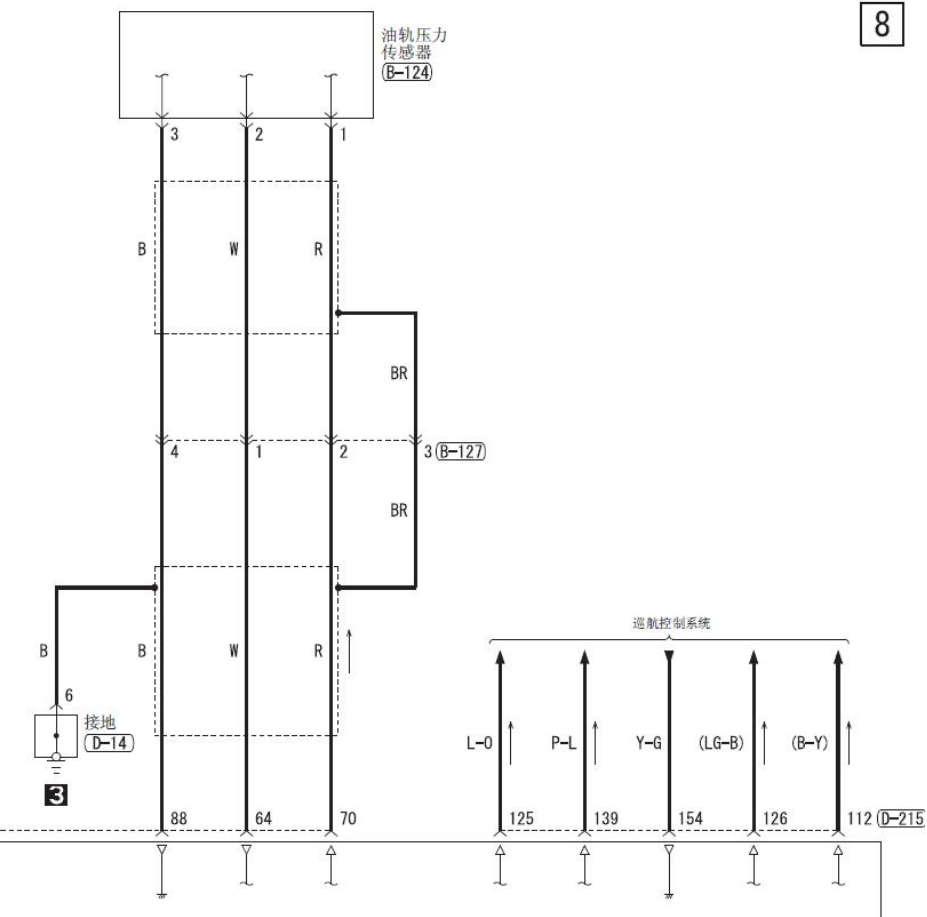

线色代码
 B: 黑色 LG: 浅绿色 G: 绿色 L: 蓝色 W: 白色 Y: 黄色
 SB: 天蓝色 BR: 棕色 O: 橙色 GR: 灰色 R: 红色 P: 粉红色
 V: 紫罗兰色 PU: 紫色 SI: 银色

