

GM Chevrolet Suburban 2021 Power Steering Active Pull/Drift Compensation Learn

Supported equipment: Launch's full range of comprehensive diagnostic equipment

Current equipment: PAD 5

Function description: This function is required to correct steering pull or abnormal power assist after steering system or suspension component disassembly/replacement, four-wheel alignment, or battery replacement.

Tested model: 2021 GM Chevrolet Suburban, VIN: 1GNSKDKD9MR*****

1. It is necessary to stop the vehicle before performing this function. On a PAD 5, choose [Local Diagnose].

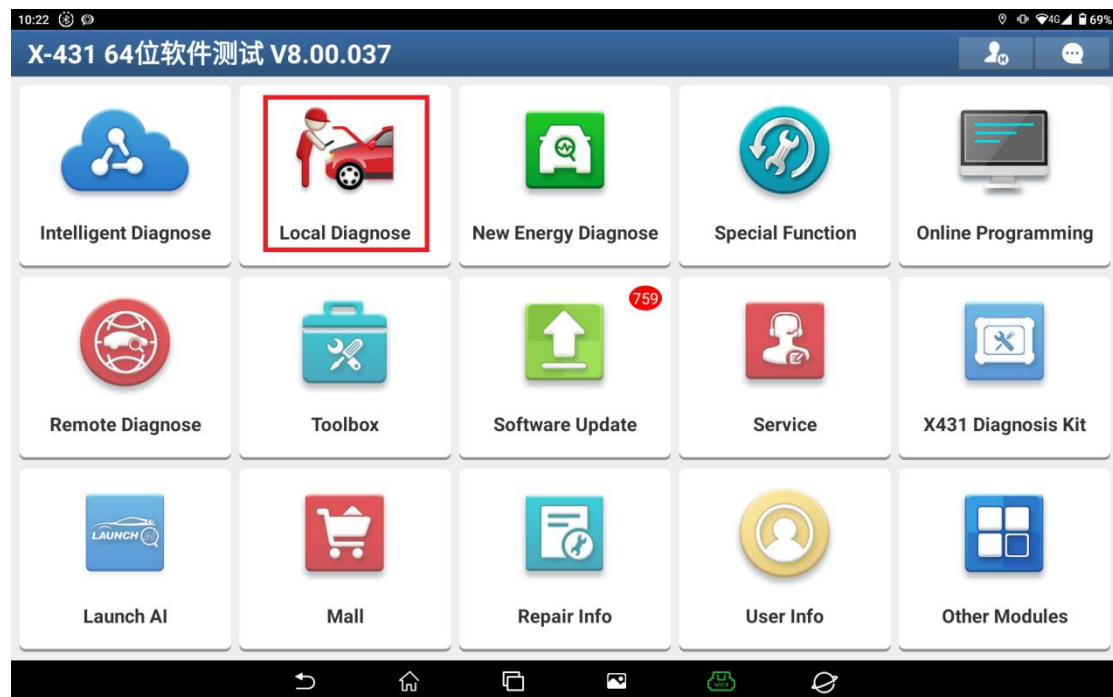

2. Choose [GM] to test.

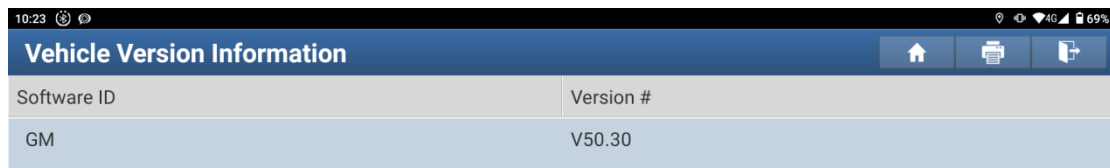
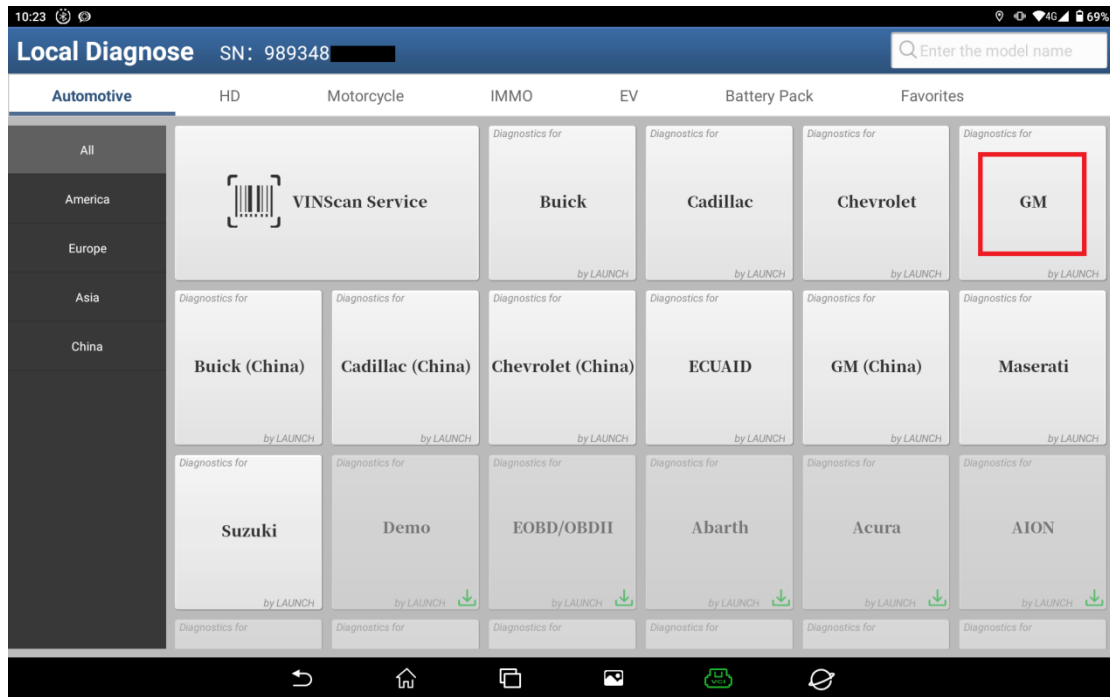

GM Diagnose V50.30

INTRODUCTION

This diagnostic software can test the ECUs of GM Models,including:

Engine Control Module, Transmission Control Module,Antilock Braking System, Supplemental Inflatable Restraint,Body Control Module, Instrument Panel Cluster, Heating and Air Conditioning, Tire Pressure Monitor, Electronic Suspension Control, Radio, Driver Door Module, Driver Position Module, Passenger Door Module, Remote Control Door Lock Receiver, Vehicle Comm. Interface Module, Immobilizer, Amplifier and so on.

Basic Functions:

- Reading ECU information
- Reading DTCs
- Clearing DTCs
- Reading vehicle running data
- Vehicle component operation test

Special Functions:

- **Engine Control Module:**
 - Oil Life Reset
 - Accelerator Pedal Position (APP) Learn
 - Crankshaft Position Variation Learn
 - EVAP Service Req Test



3. Choose [Automatically Search] to identify car models automatically.

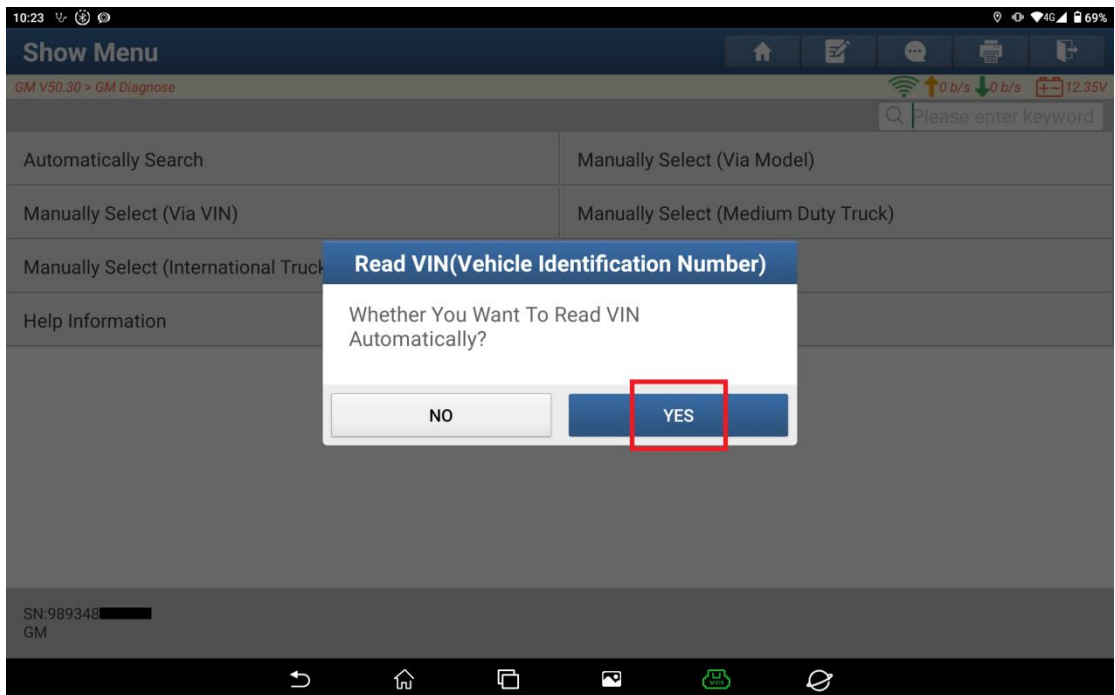
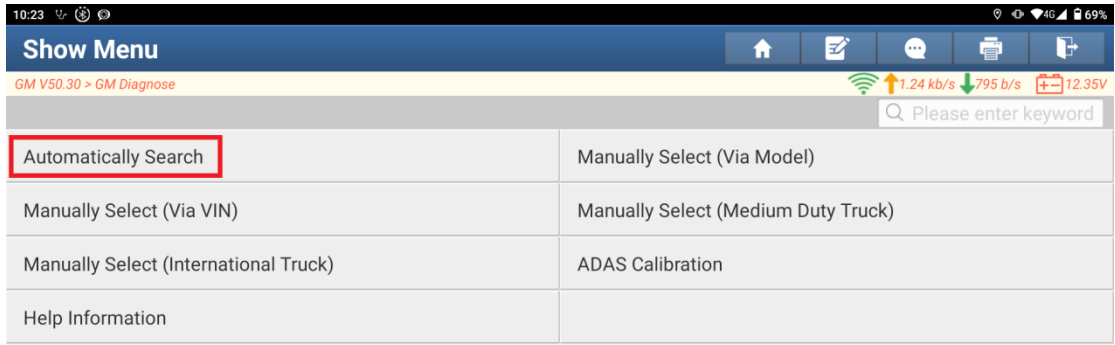

- 4. Operate according to the prompt “Turn Ignition ON (Turn The Key To On Position. For Push-Start Vehicle, Please Long Press The Start Button For 5-10s To Turn Ignition On)”.

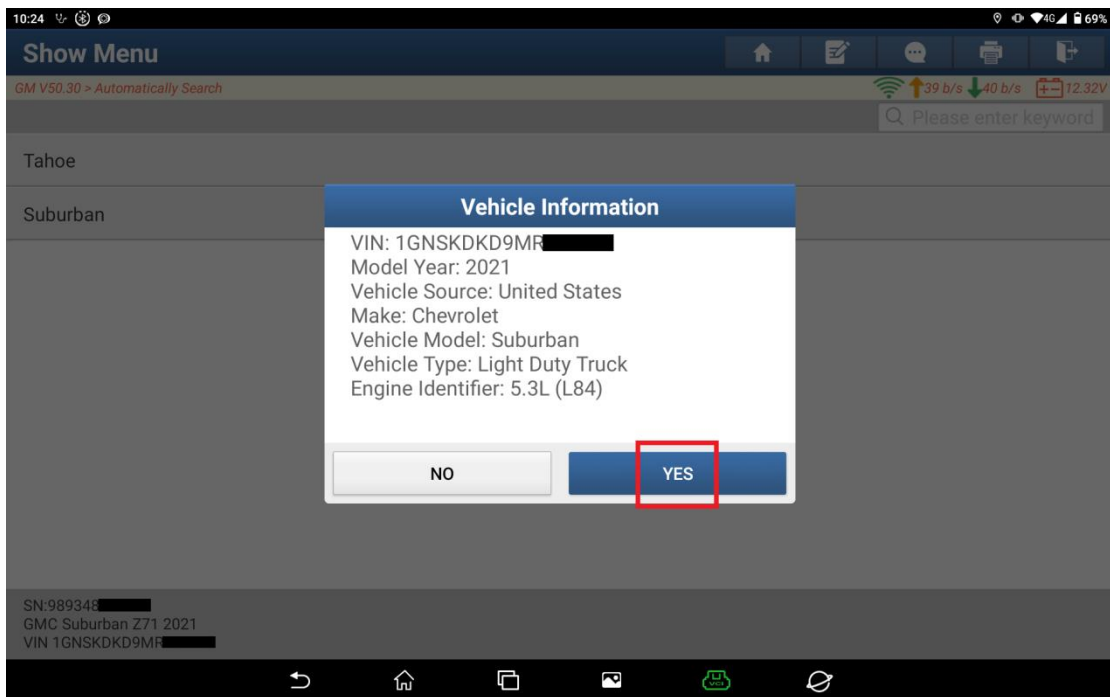
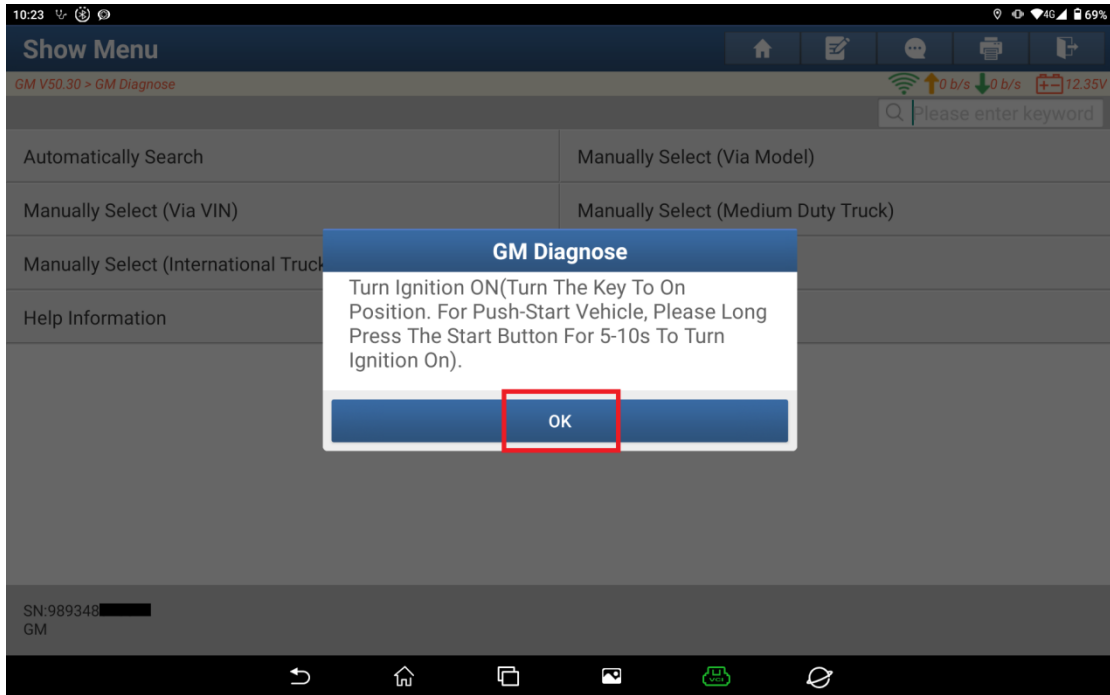

5. Click [PSCM] to access the system.

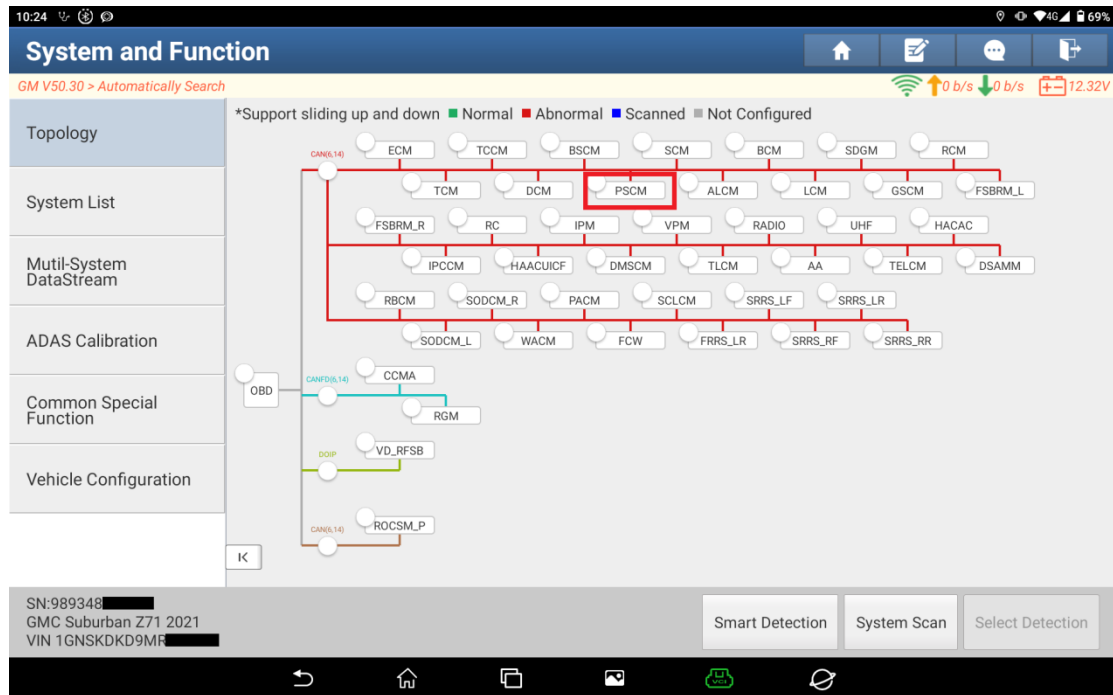

6. Click [Special Functions].

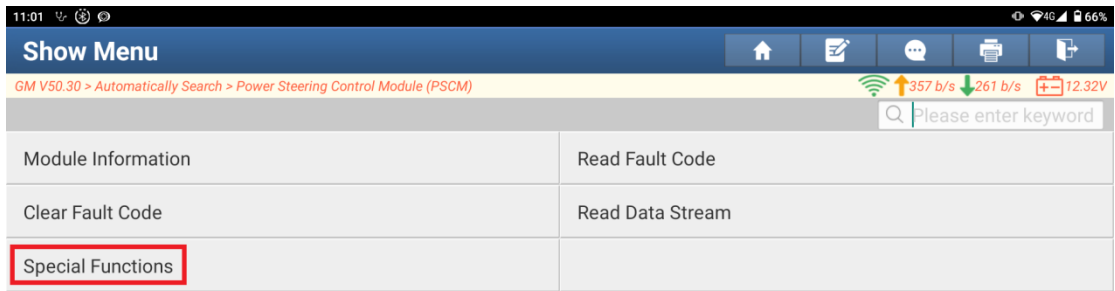

7. Click [Power Steering Active Pull/Drift Compensation Learn].

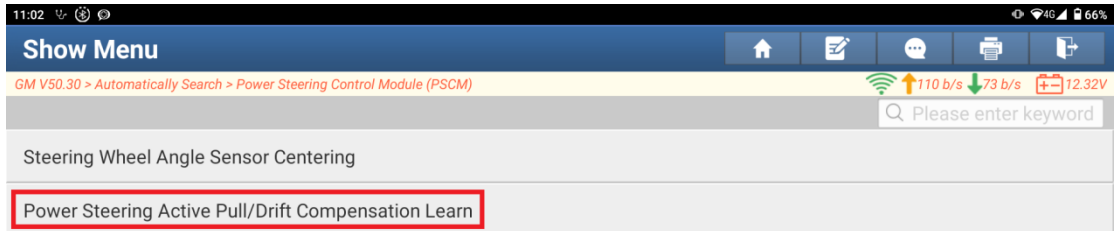

- Confirm the following conditions before execution: "Engine Off, Ignition On, Vehicle In Park To Perform This Function."

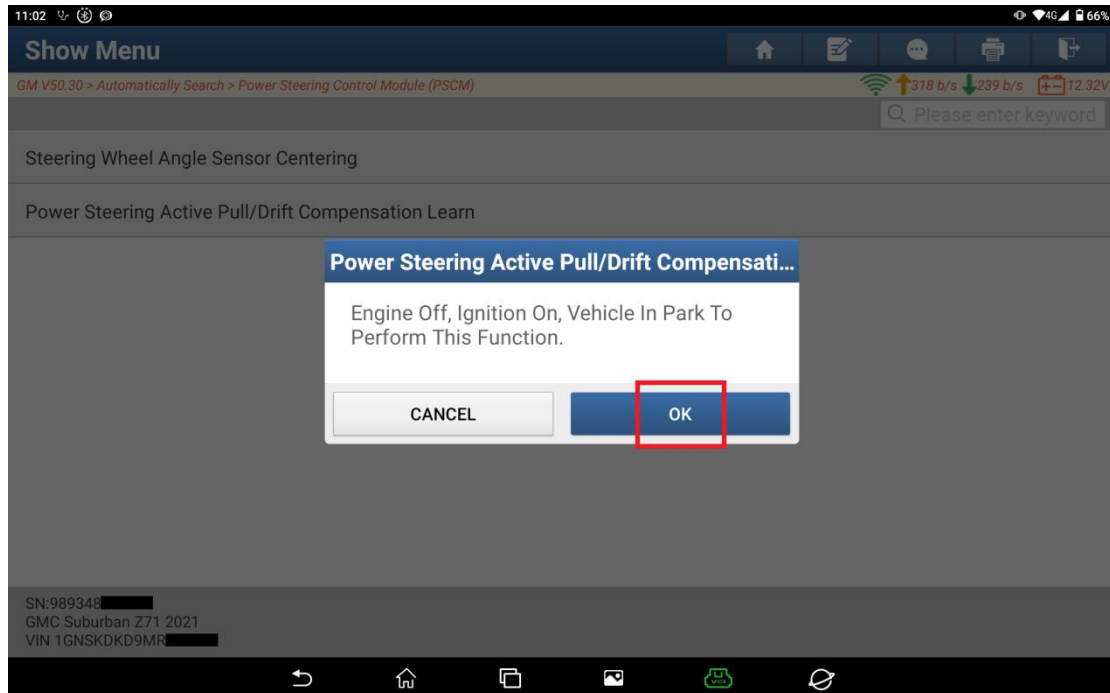

- Fulfill the following conditions as prompted: "Align The Front Wheels Straight And Center The Steering Wheel."

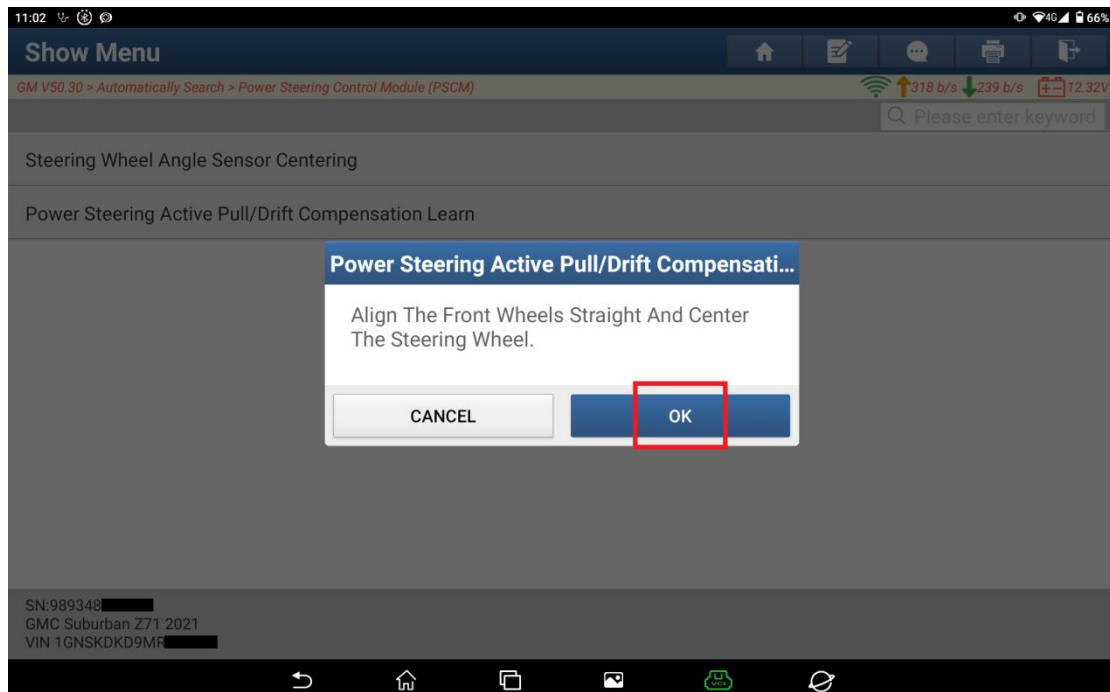

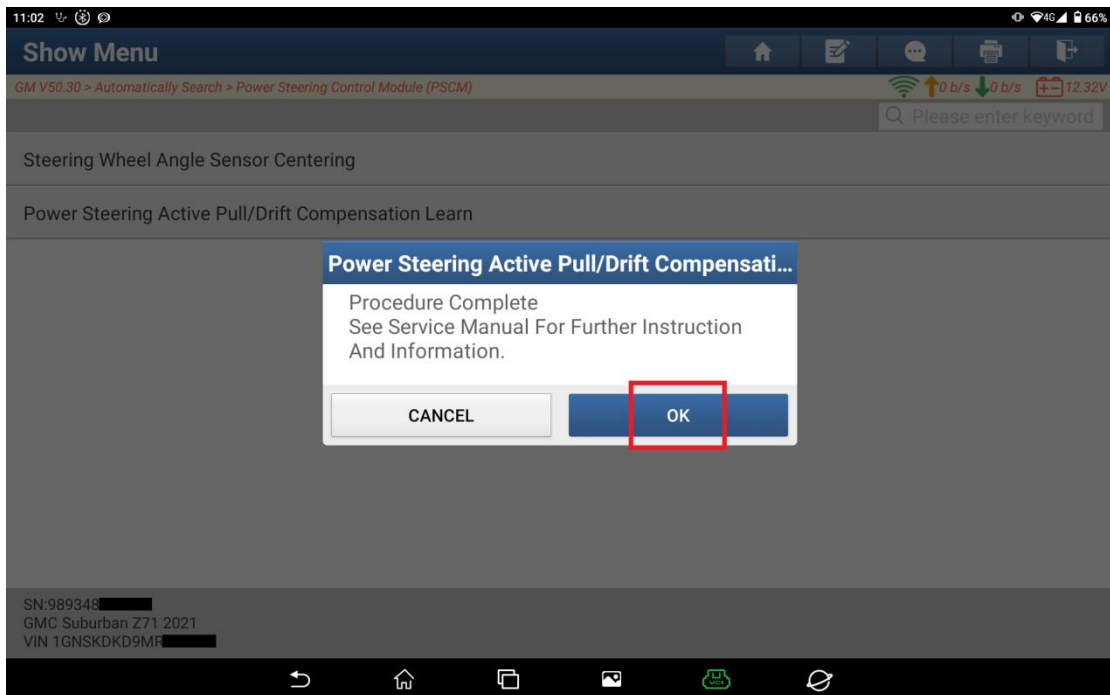
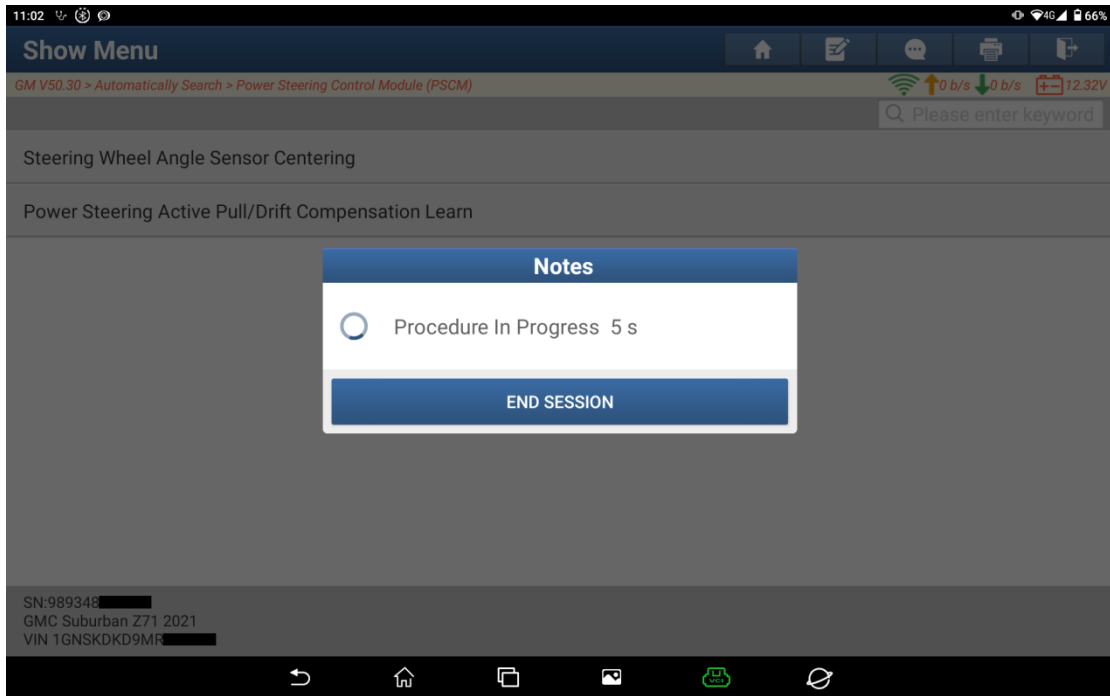

Statement:

The content of this document is copyrighted by LAUNCH TECH CO., LTD., and no individual or organization may quote or reprint it without consent.