

NISSAN KICKS 2021 Intelligent Key Registration

Supported Products: Launch's full range of comprehensive diagnostic equipment

Tested Model: NISSAN KICKS 2021

Note: Prepare all keys before matching. Keys not included in the matching process will not be usable.

Procedure:

1. Take X-431 PAD 5 as an example. Click [Local Diagnose], as shown in Figure 1.

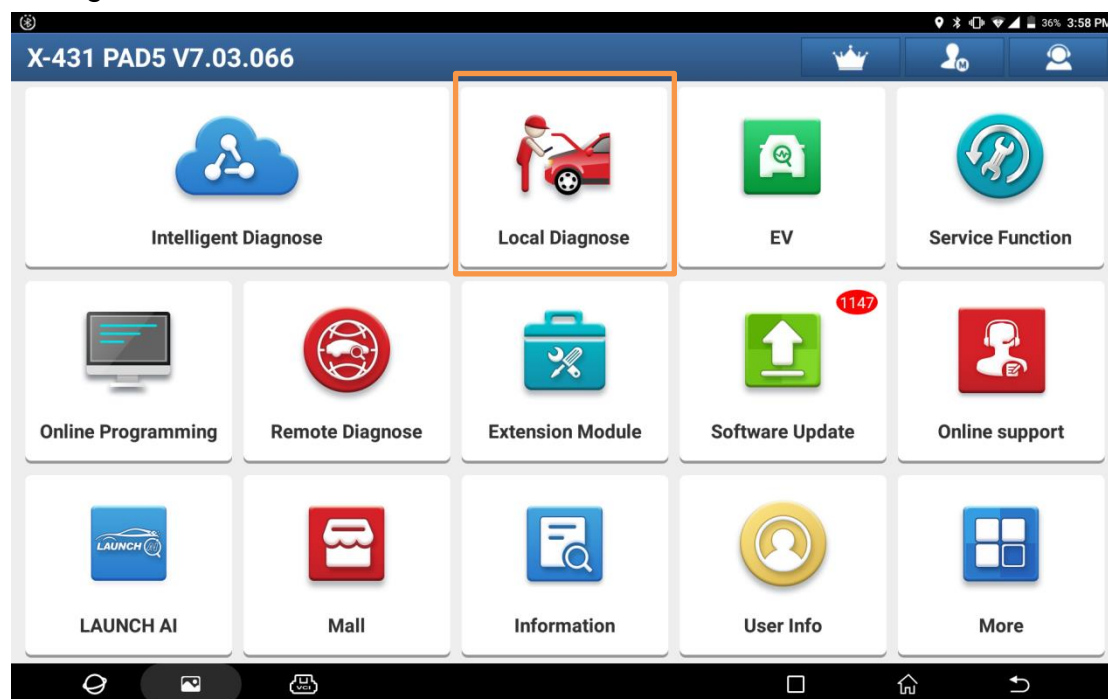

Figure 1

2. Click [NISSAN], as shown in Figure 2.

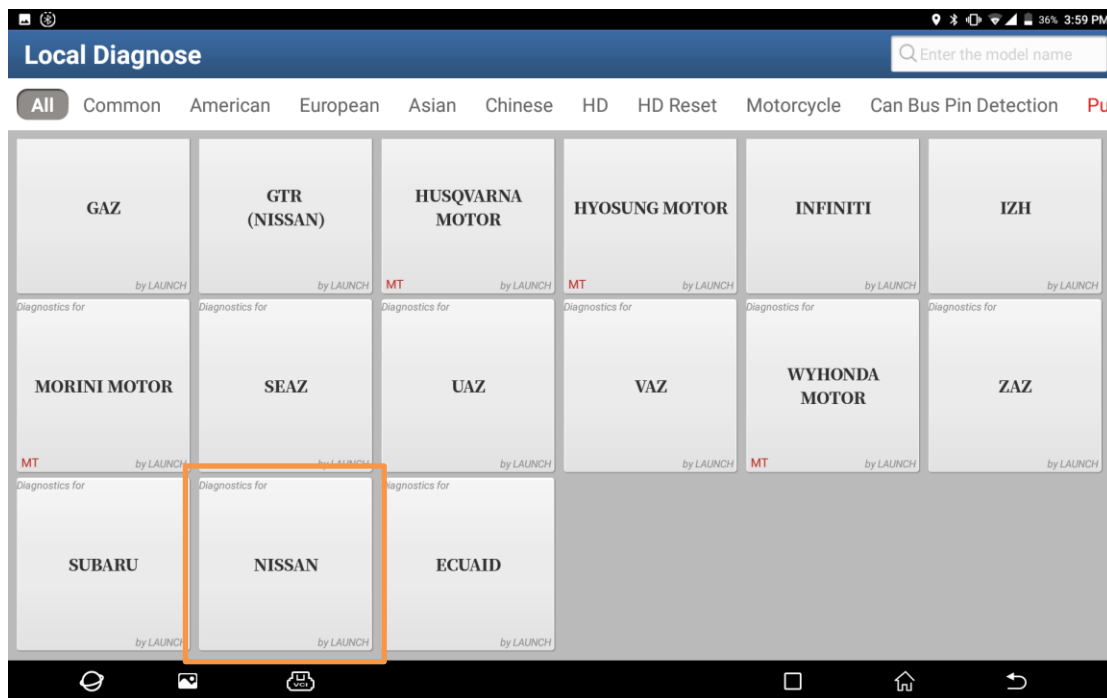

Figure 2

3. Click [OK], as shown in Figure 3.

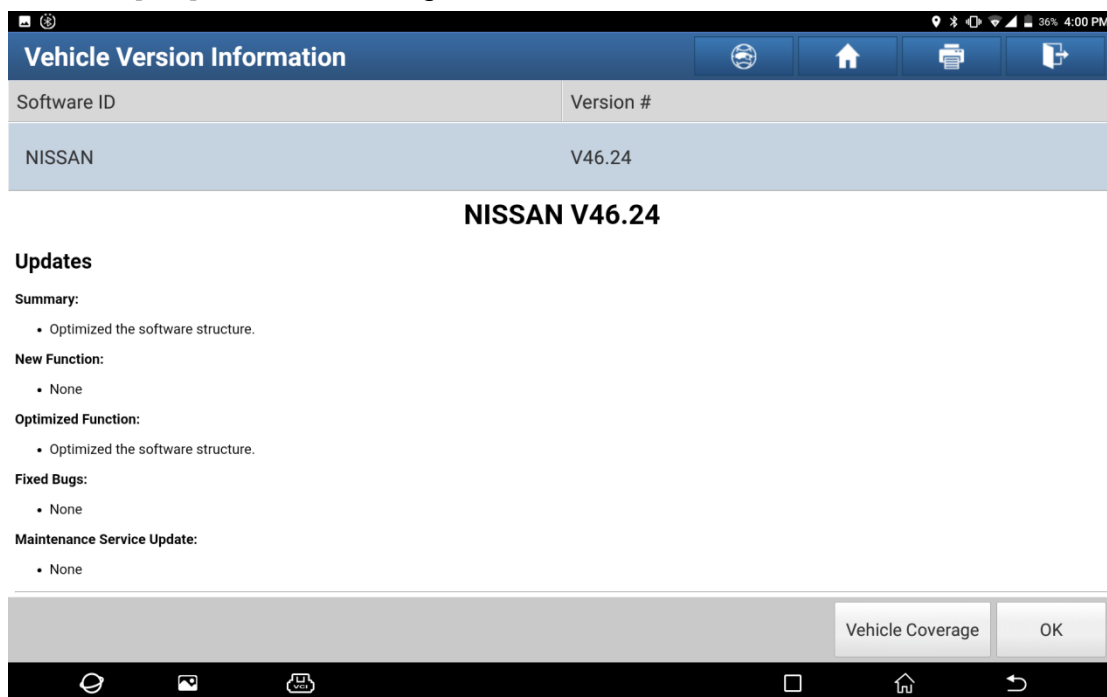

Figure 3

4. Choose [Manually Select], as shown in Figure 4.

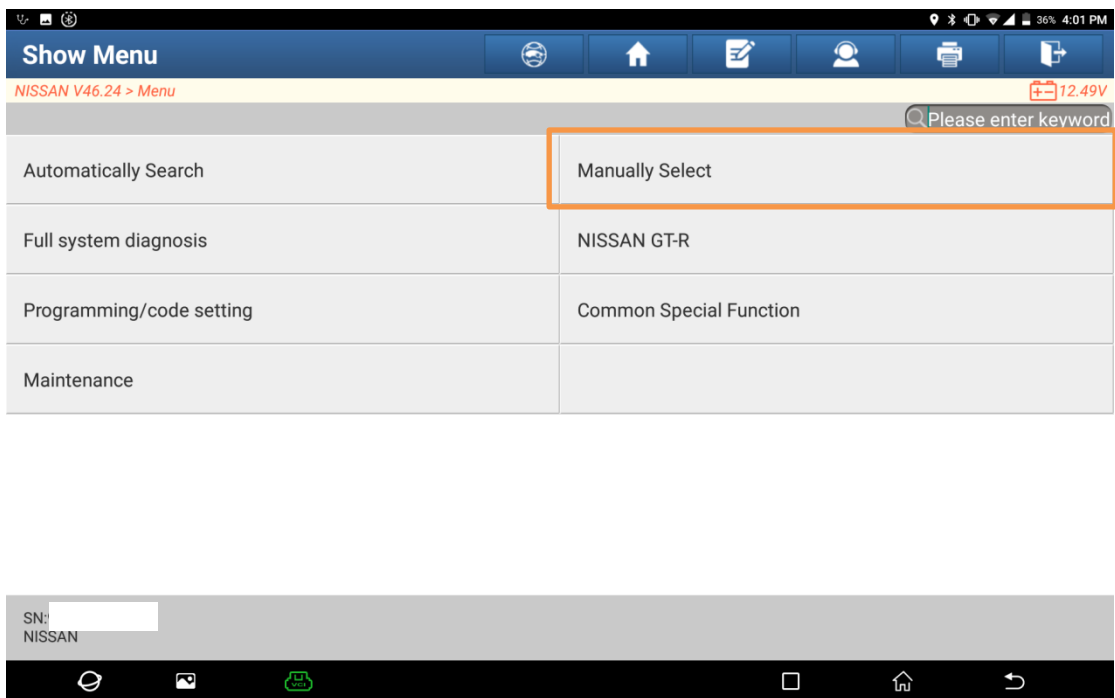

Figure 4

5. Choose [Far East], as shown in Figure 5.

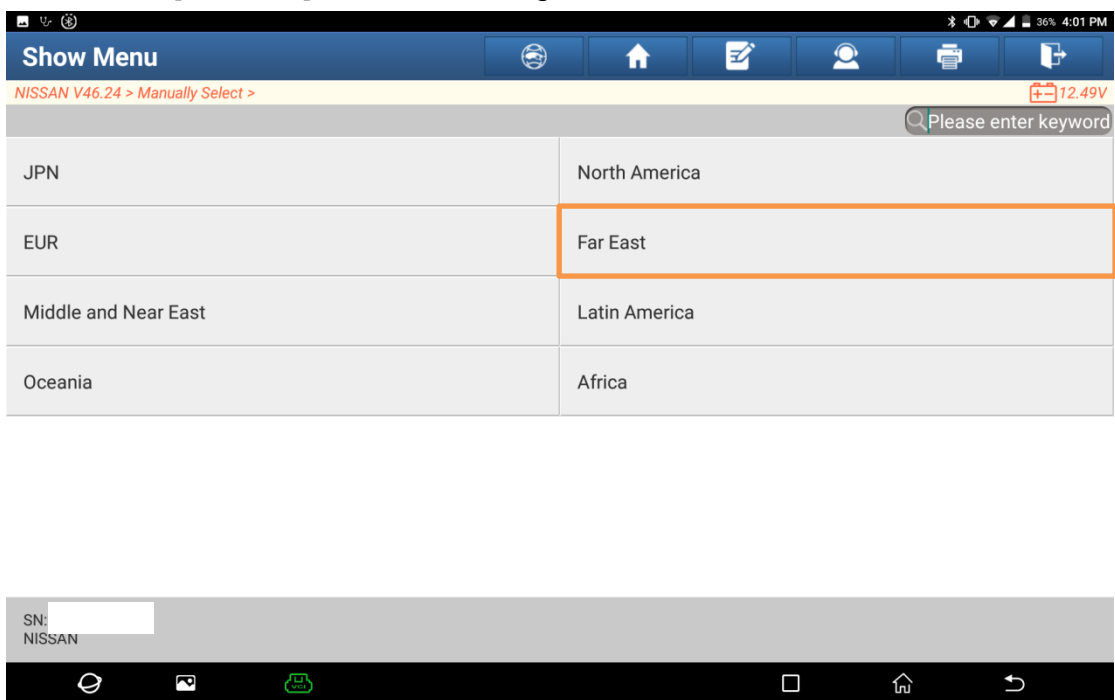

Figure 5

6. Choose [People's Republic of China], as shown in Figure 6.

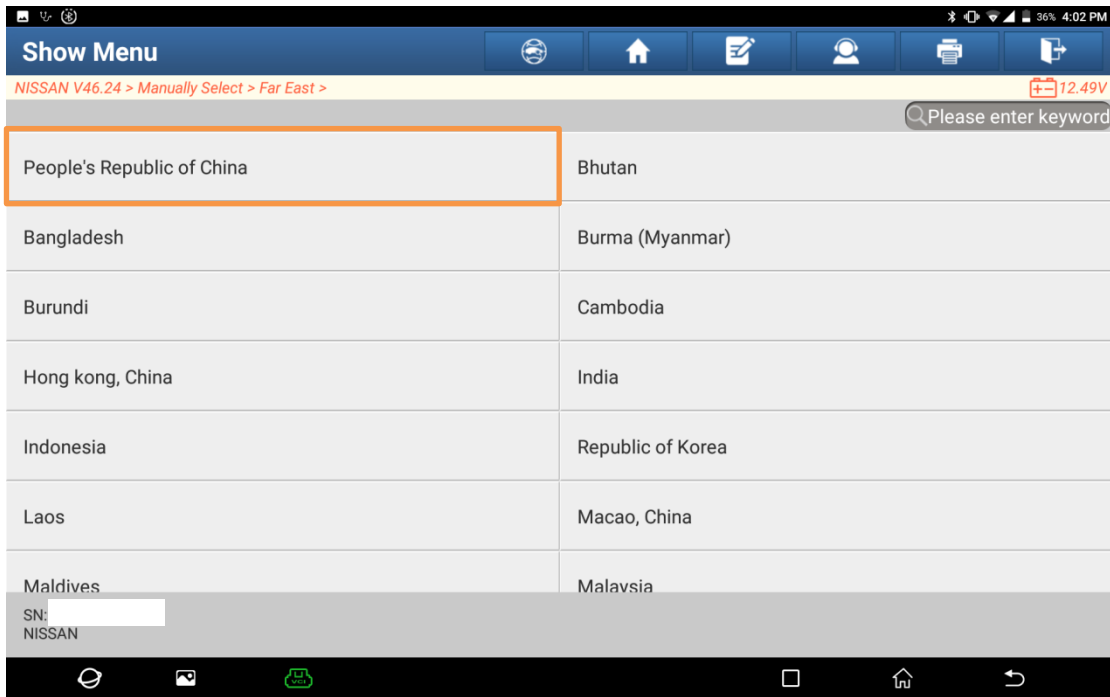

Figure 6

7. Choose [KICKS], as shown in Figure 7.

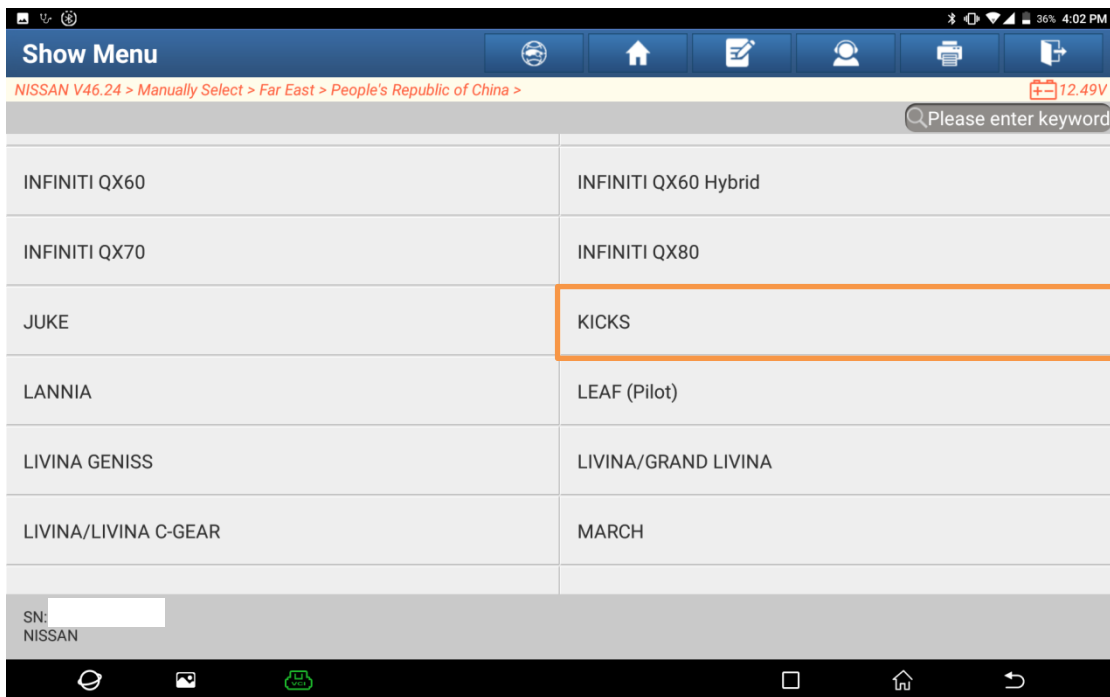

Figure 7

8. Choose [P15], as shown in Figure 8.

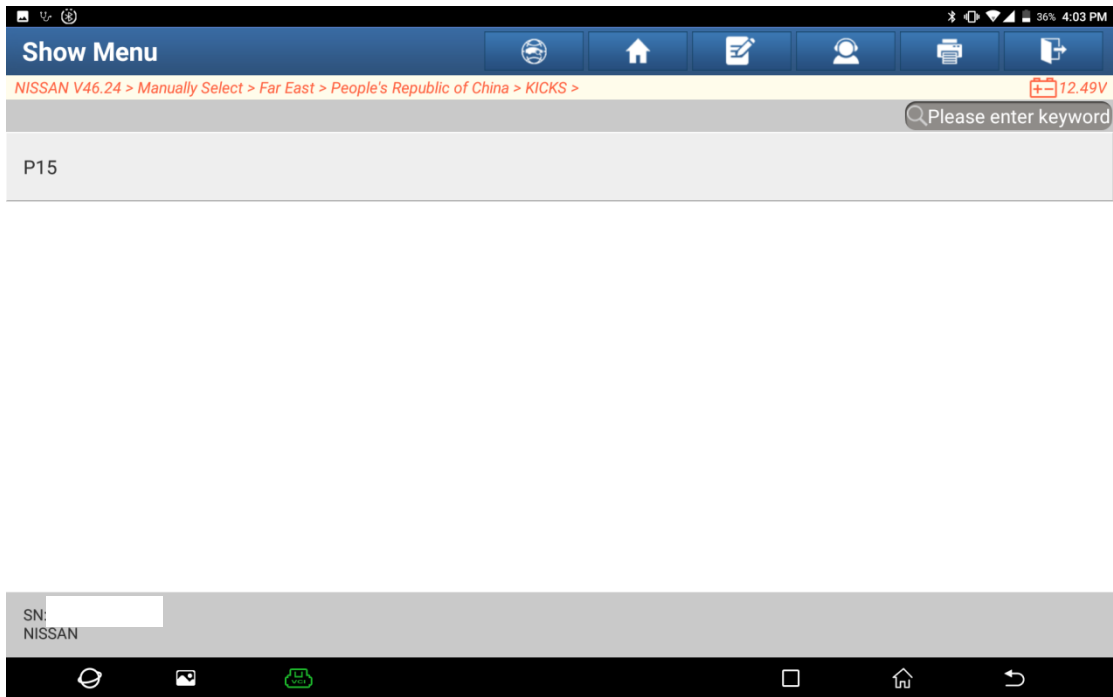

Figure 8

9. Choose [08/2021], as shown in Figure 9.

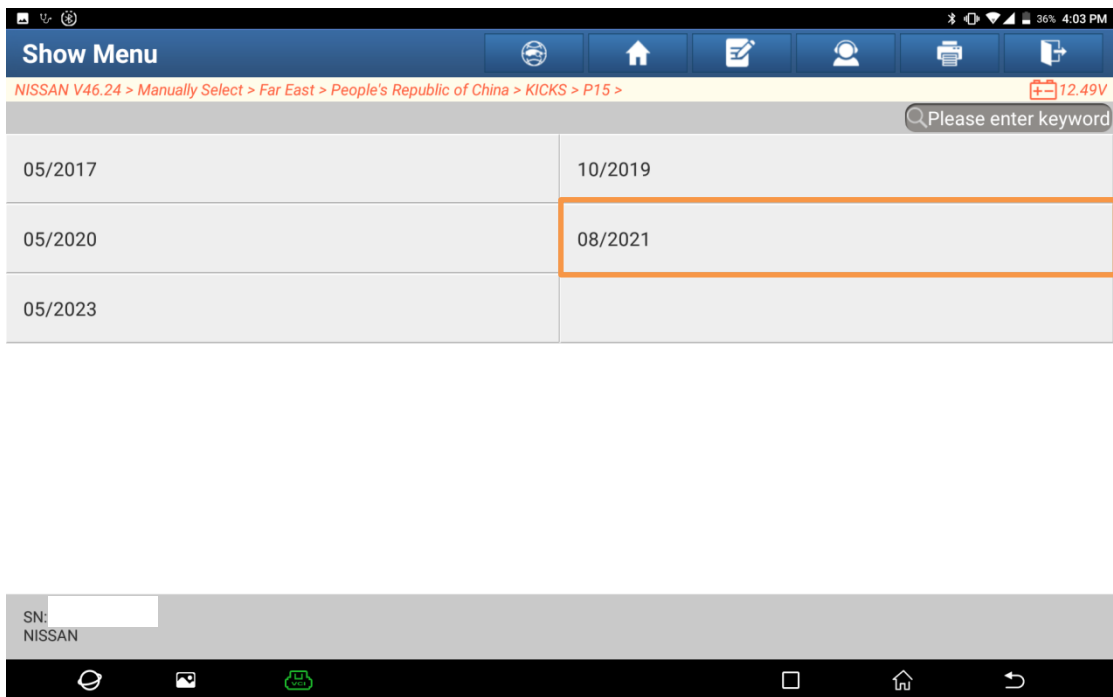

Figure 9

10. Click [NATS (Nissan Anti-theft System)], as shown in Figure 10.

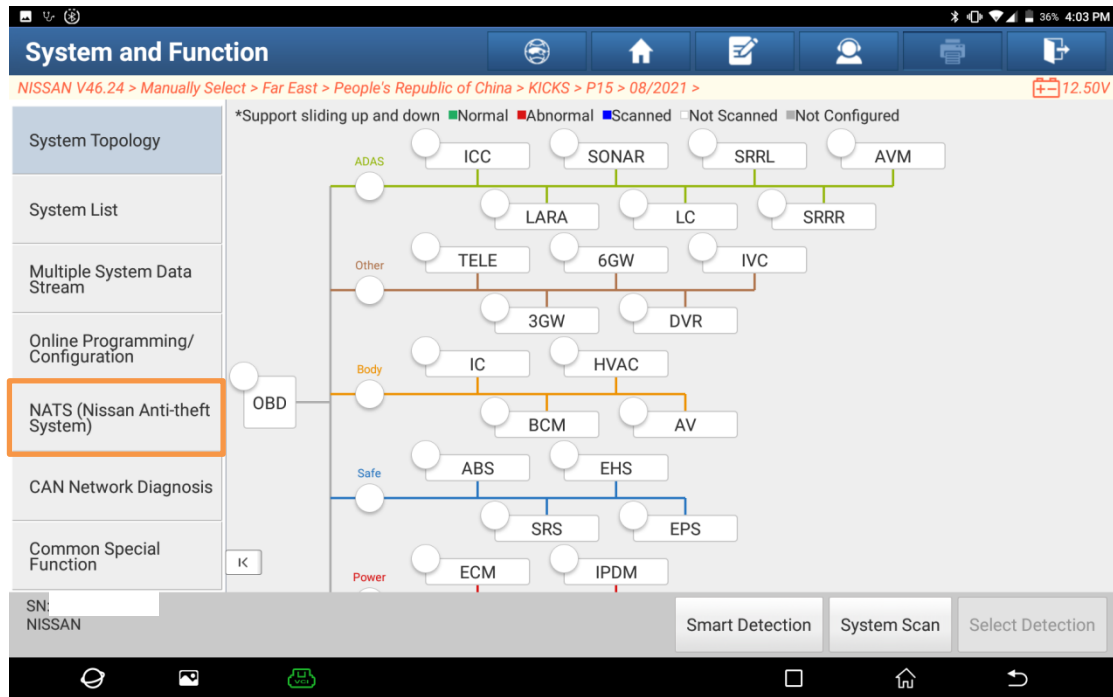

Figure 10

11. Click [OK], as shown in Figure 11.

The screenshot shows a 'Vehicle Confirmation' dialog box. The title bar reads 'Vehicle Confirmation'. Below it, the same breadcrumb trail as in Figure 10 is visible. The main area contains a table with the following data:

Item	Value
Area	Far East
Country	People's Republic of China
Vehicle	KICKS
Type	P15

Below the table, there is a large blue button labeled 'OK'. At the bottom, the status bar shows 'SN: NISSAN'.

Figure 11

12. After the scan is completed, choose [Key Registration Operation], as shown in Figure 12.

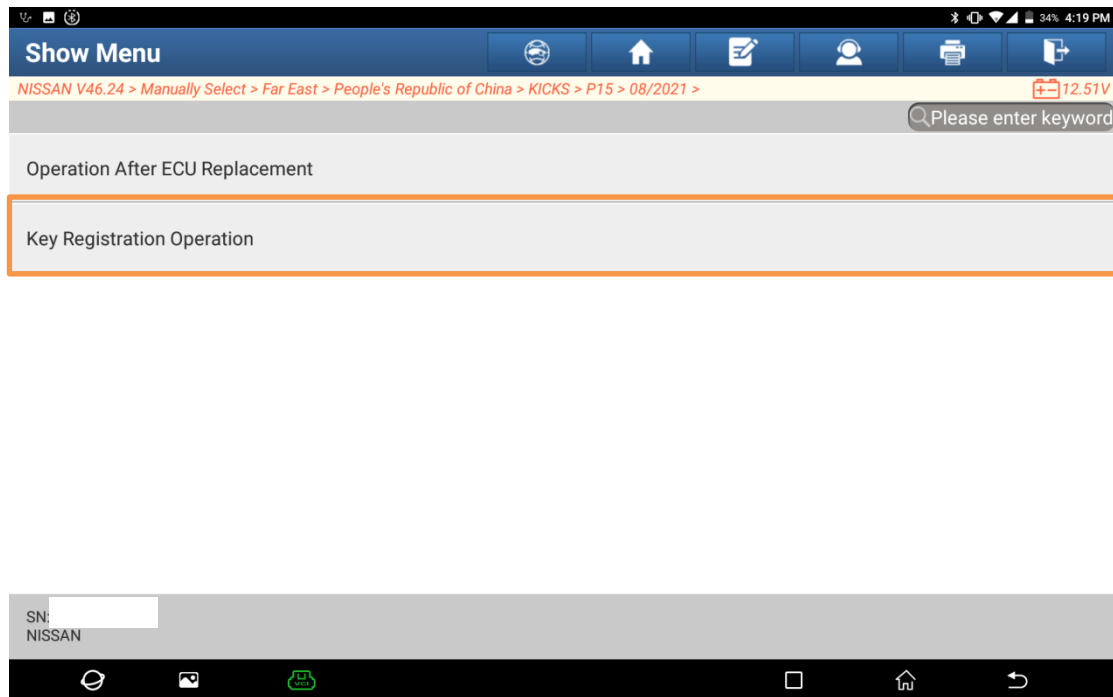

Figure 12

13. Choose [Register Key], as shown in Figure 13.

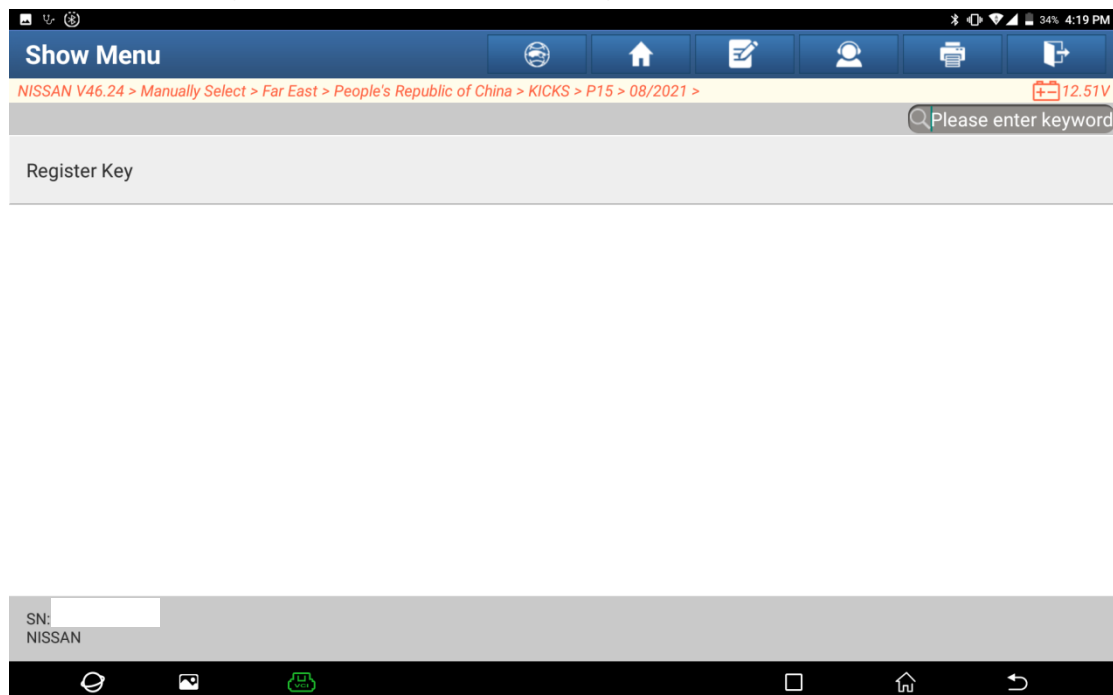

Figure 13

14. Prepare all keys and click [YES], as shown in Figure 14.

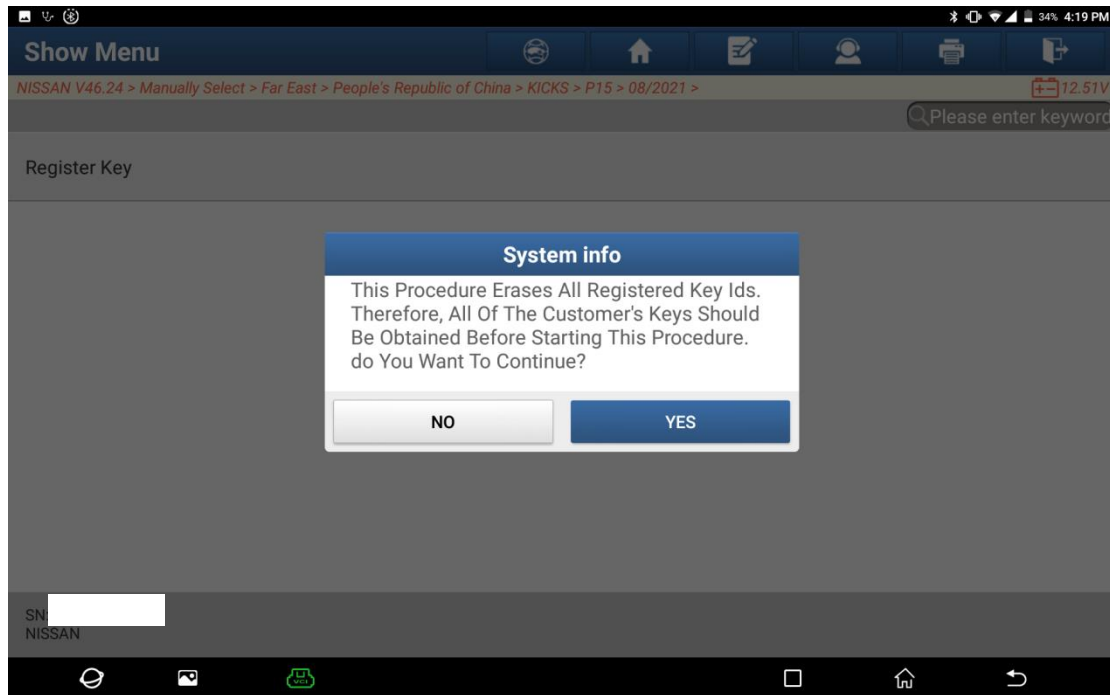

Figure 14

15. Turn on the emergency lamp, turn off the ignition switch, and click [OK], as shown in Figure 15.

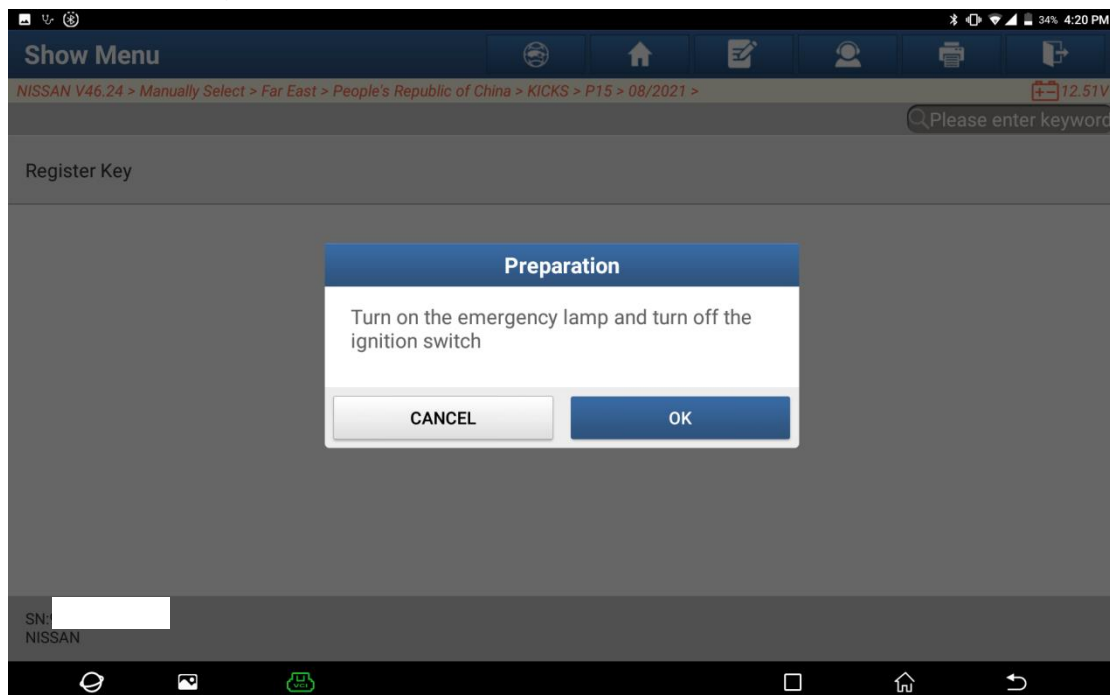

Figure 15

16. Insert the key into the ignition key cylinder and click [Next Step], as shown in Figure 16.

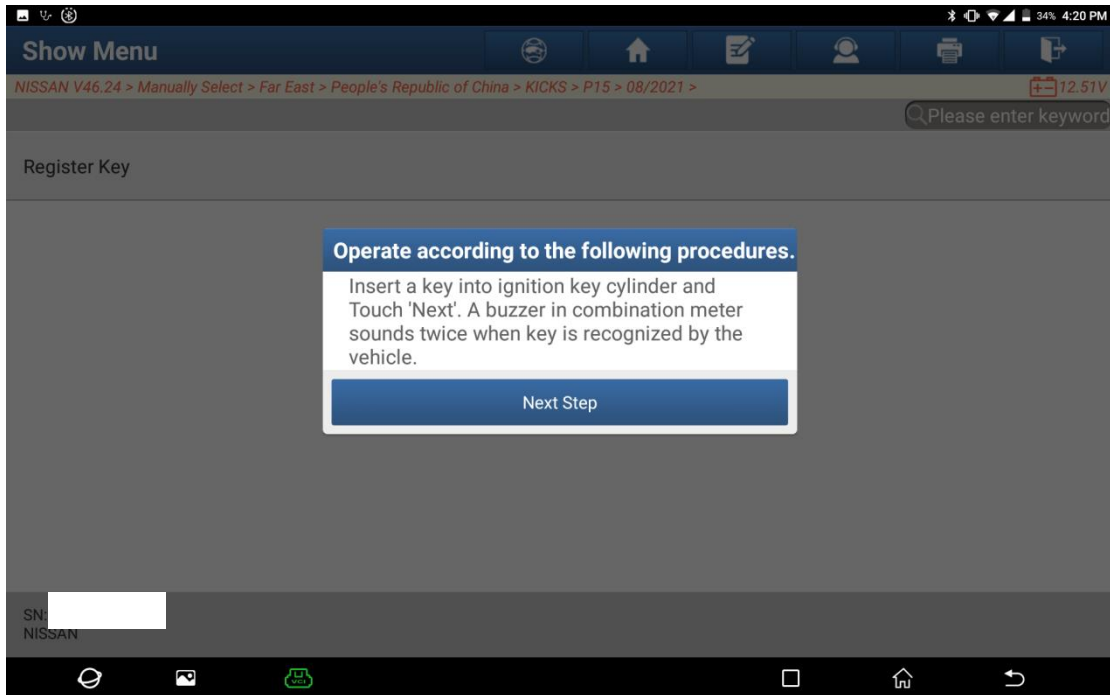

Figure 16

17. Choose [Networking access to 20 anti-theft passwords], as shown in Figure 17.

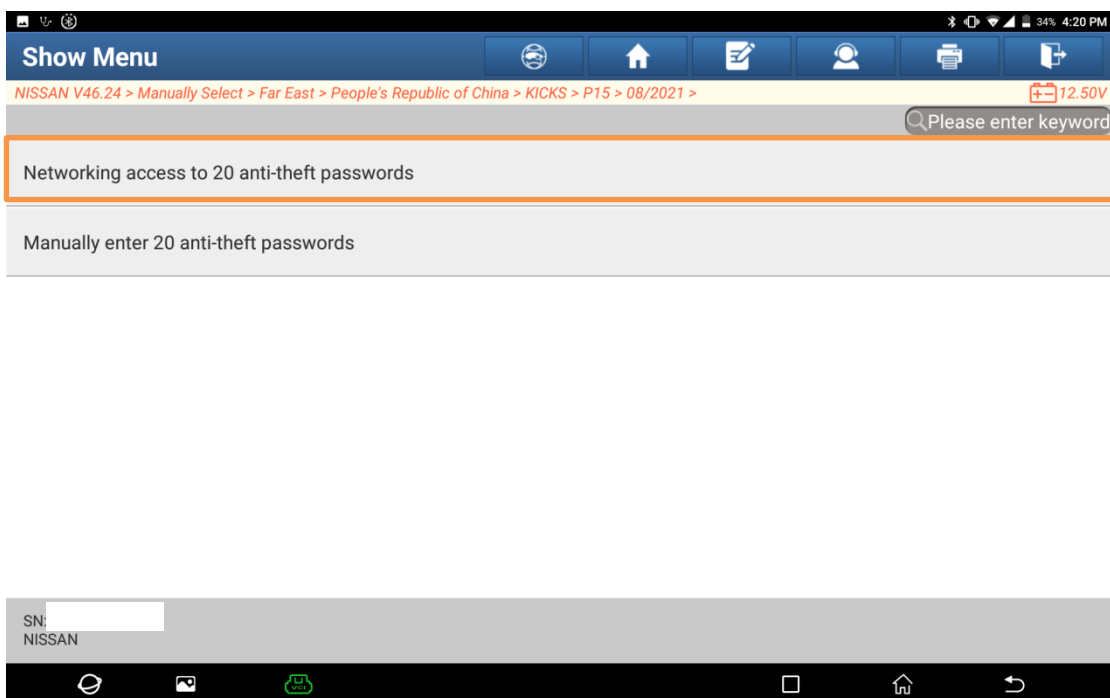

Figure 17

18. Click [OK]. The passwords are automatically obtained and the related module is unlocked, as shown in Figure 18.

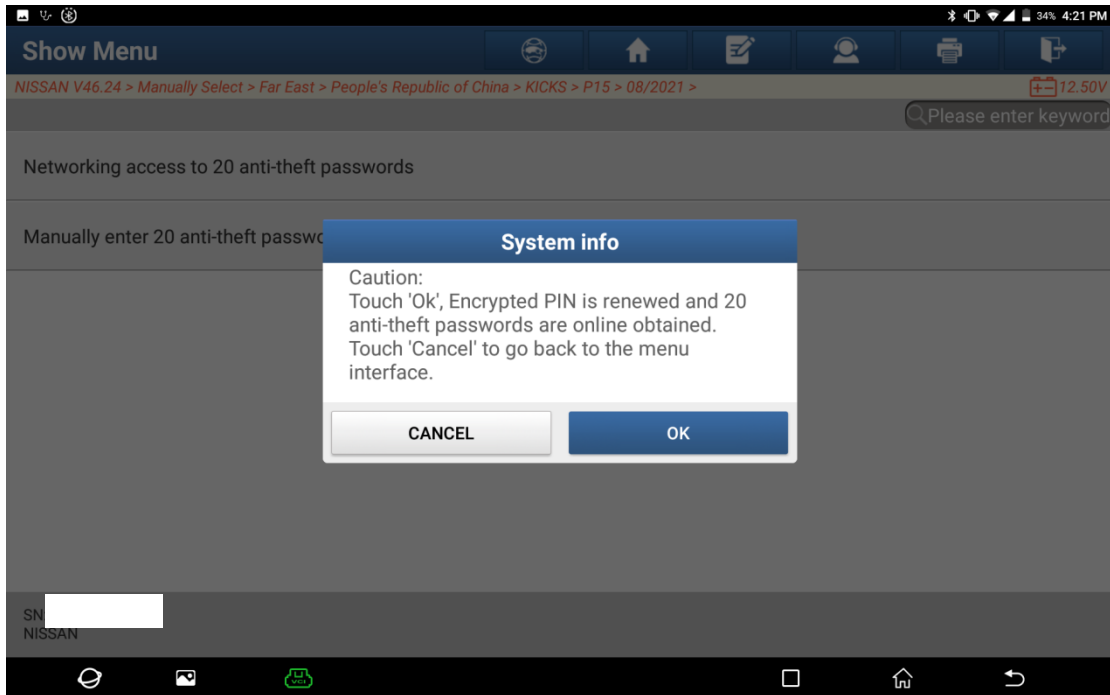

Figure 18

19. After the module is unlocked, register the keys that need to be matched. Press the power supply switch once, and then click [Confirmed], as shown in Figure 19.

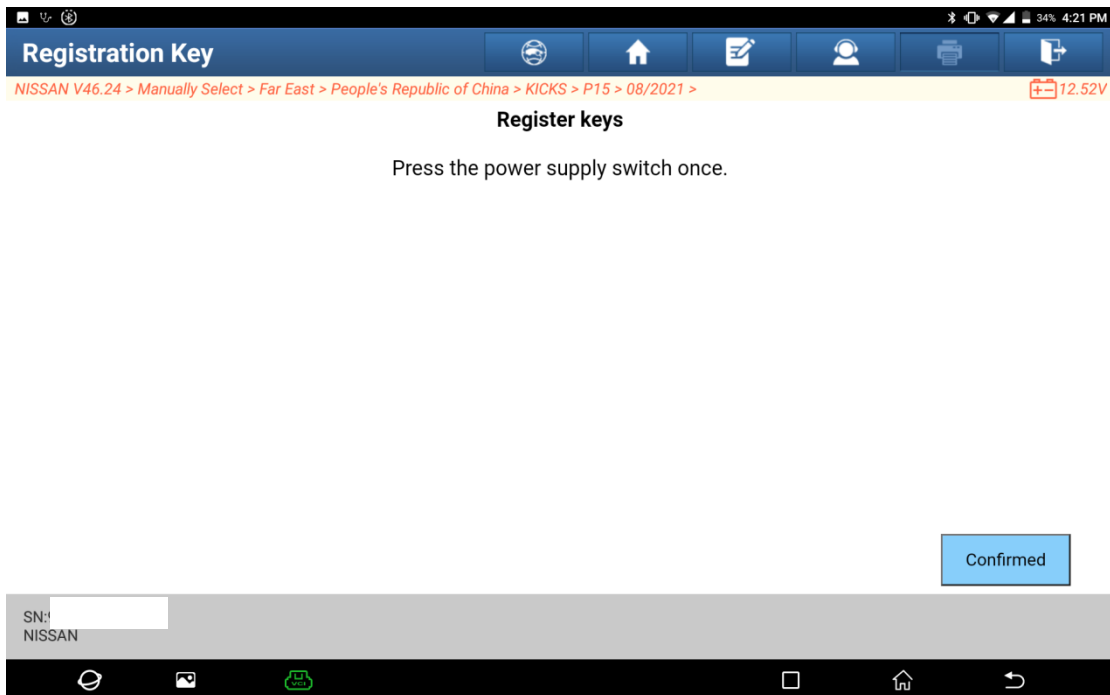

Figure 19

20. Touch the power supply switch with the symbol of an unregistered key. A sound similar to crackling should be heard. Check and confirm that the anti-theft lamp is flashing and the power supply is automatically turned on. Then, click [Confirmed], as shown in Figure 20.

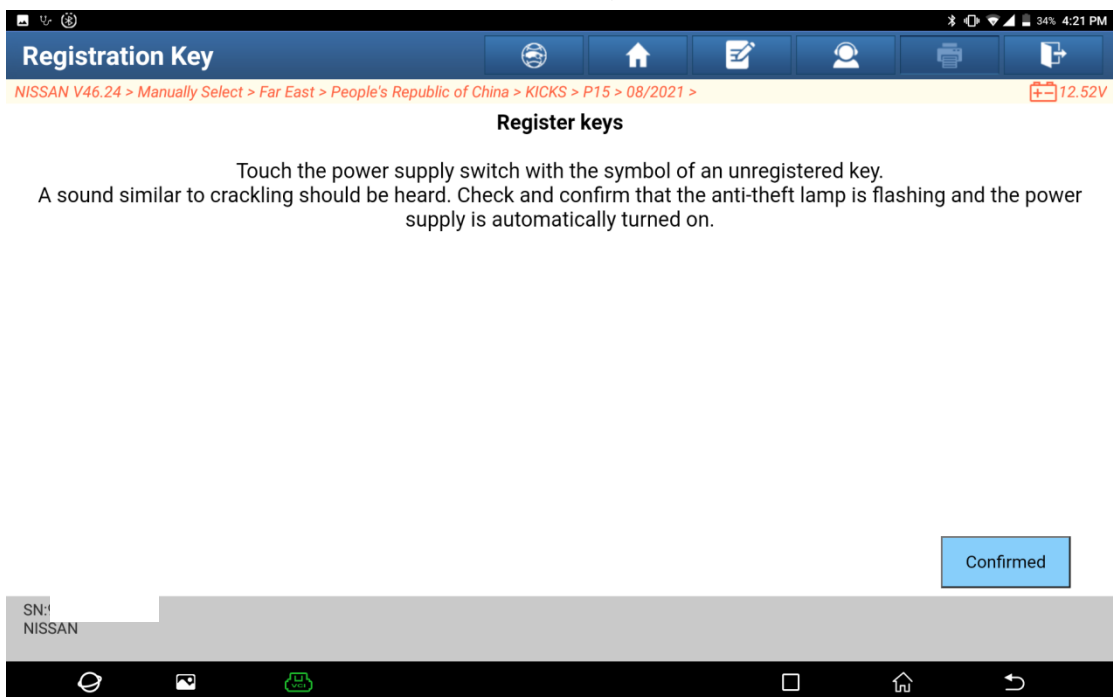

Figure 20

21. Press the power supply switch and turn the power supply switch OFF. Then, click [Confirmed], as shown in Figure 21.

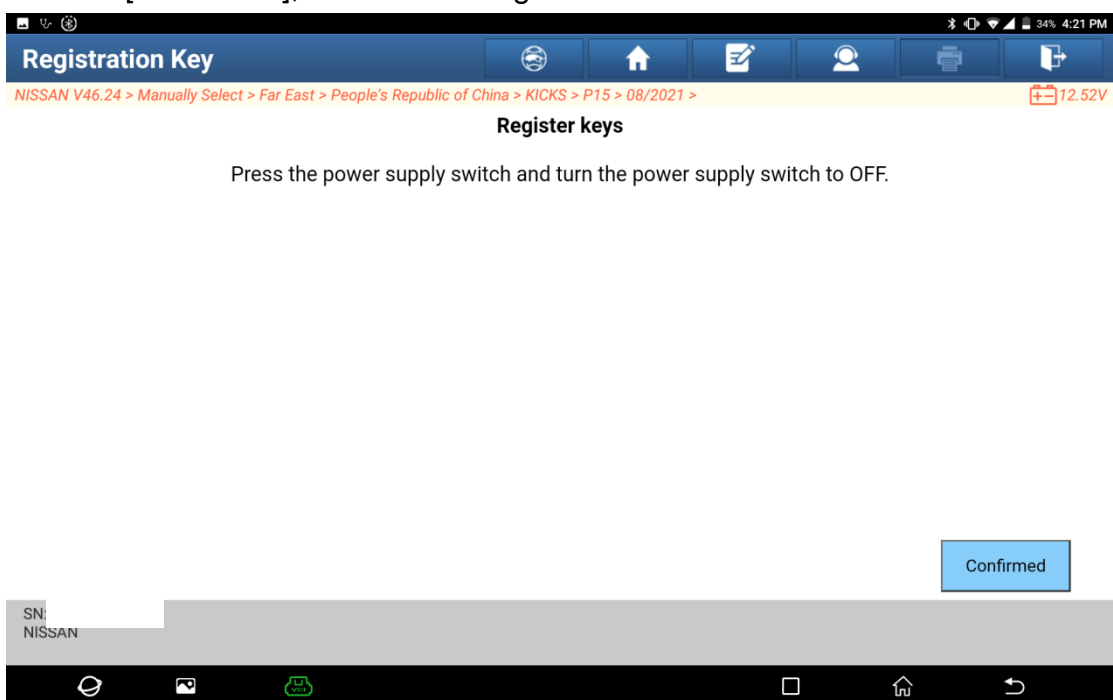

Figure 21

22. If there are more keys to register and match, click [Match the next key] to continue. Repeat steps 19-21 until all keys are registered, and then proceed to step 23, as shown in Figure 22.

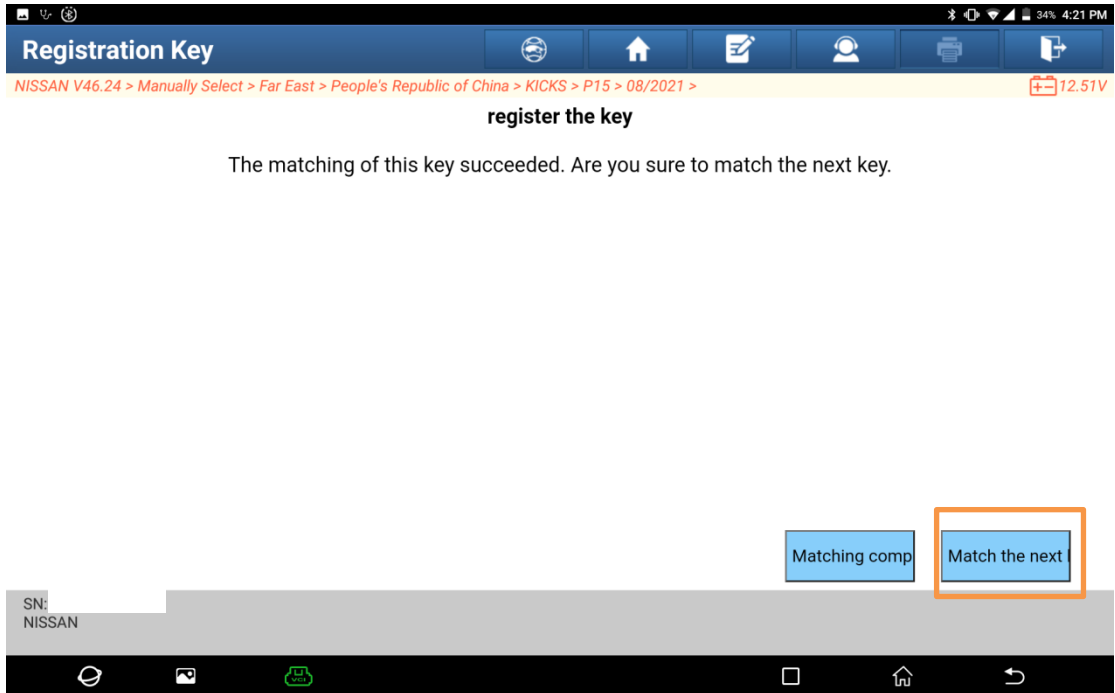

Figure 22

23. If all keys have been registered, click [Matching completed], as shown in Figure 23.

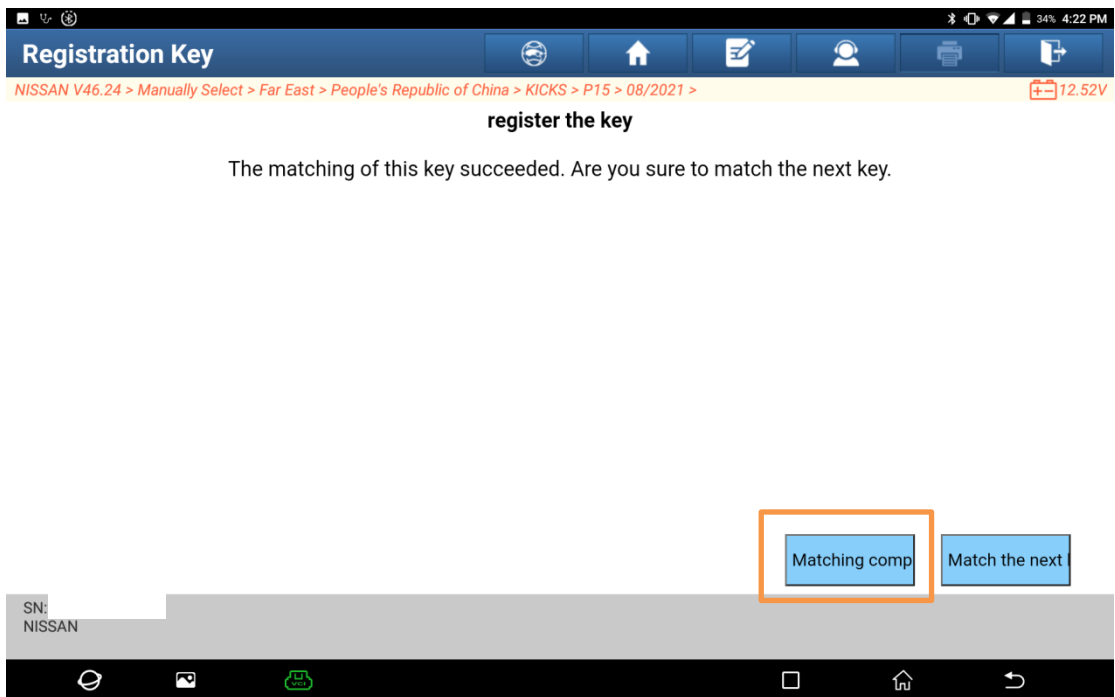

Figure 23

24. Use the registered keys to check the door locking and unlocking status. Confirm that the key registration mode is completed, and then click [Confirmed] to exit the registration mode, as shown in Figure 24. The key registration process is now finished.



To confirm that the key registration mode is completed, operate the registered keys and check the locking and unlocking status of car doors.



Figure 24

Statement:

The content of this document is copyrighted by LAUNCH TECH CO., LTD., and no individual or organization may quote or reprint it without consent.