

GM Chevrolet Suburban 2021 Steering Wheel Angle Sensor Centering

Supported equipment: Launch's full range of comprehensive diagnostic equipment

Current equipment: PAD 5

Function description: This function needs to be performed when the steering gear, steering column, or steering angle sensor has been disassembled and reassembled, four-wheel alignment has been executed, suspension components have been replaced, or issues such as an off-center steering wheel, vehicle pulling, or uneven power steering occur.

Tested model: 2021 GM Chevrolet Suburban,
VIN: 1GNSKDKD9MR*****

1. It is necessary to stop the vehicle before performing this function. On a PAD 5, choose [Local Diagnose].

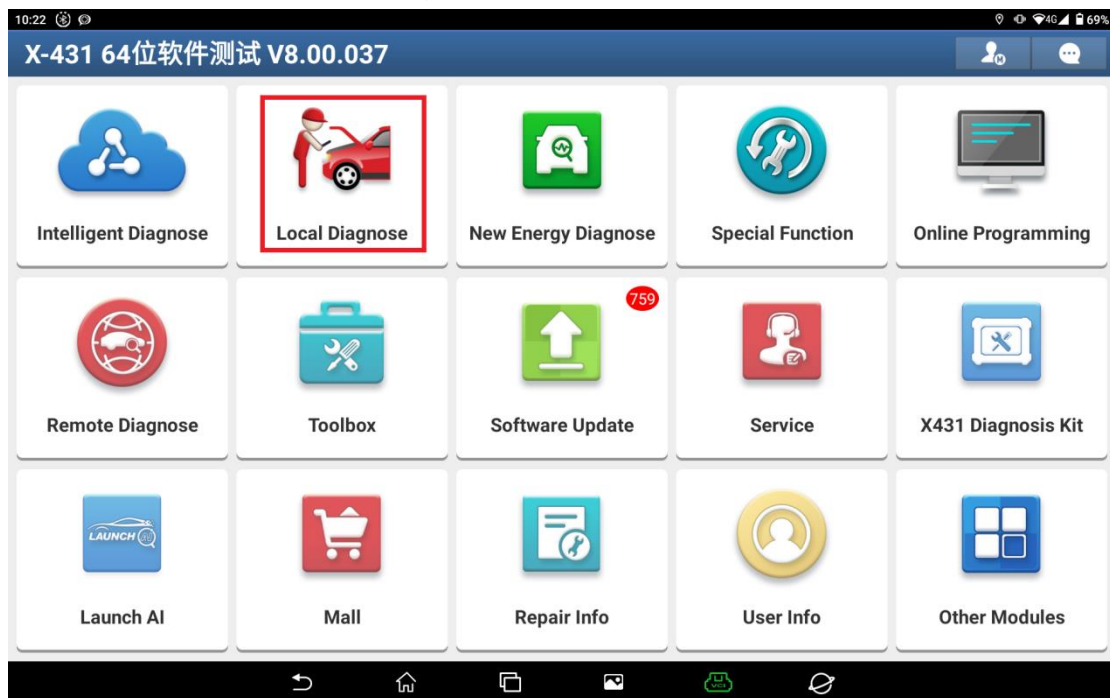

2. Choose [GM] to test.

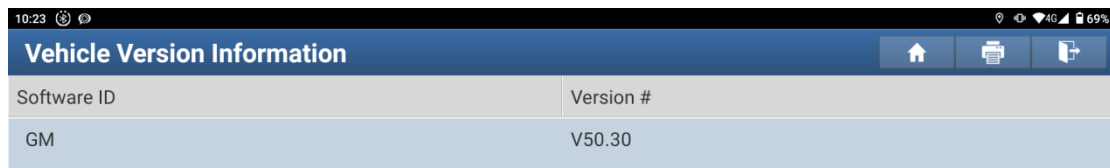
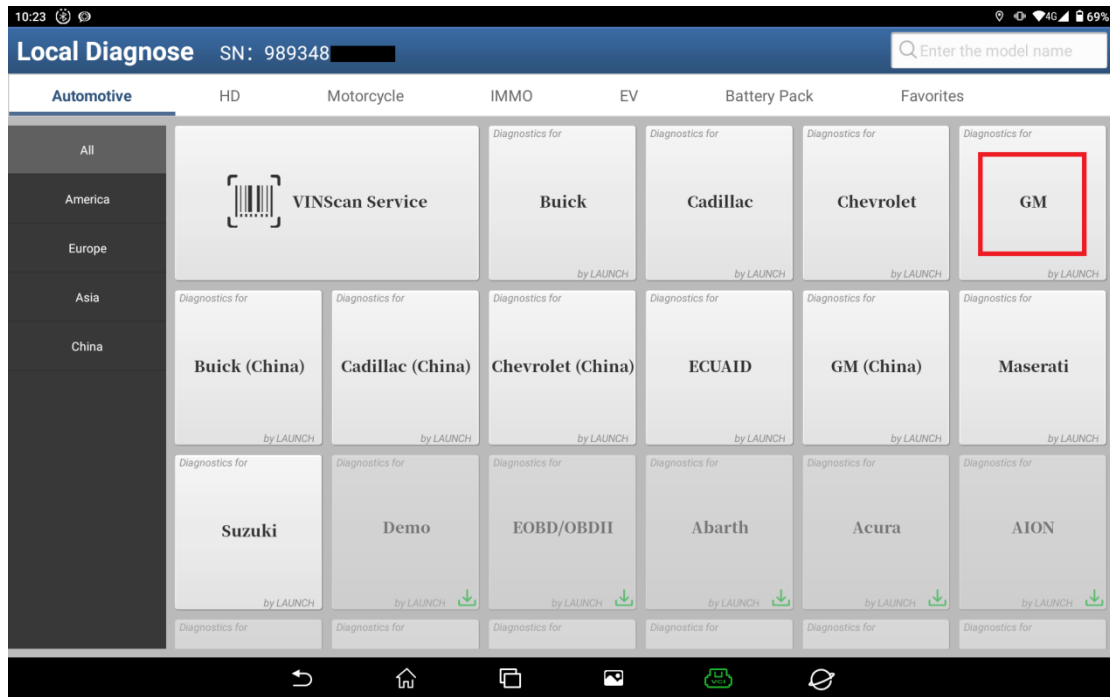

GM Diagnose V50.30

INTRODUCTION

This diagnostic software can test the ECUs of GM Models,including:

Engine Control Module, Transmission Control Module,Antilock Braking System, Supplemental Inflatable Restraint,Body Control Module, Instrument Panel Cluster, Heating and Air Conditioning, Tire Pressure Monitor, Electronic Suspension Control, Radio, Driver Door Module, Driver Position Module, Passenger Door Module, Remote Control Door Lock Receiver, Vehicle Comm. Interface Module, Immobilizer, Amplifier and so on.

Basic Functions:

- Reading ECU information
- Reading DTCs
- Clearing DTCs
- Reading vehicle running data
- Vehicle component operation test

Special Functions:

- **Engine Control Module:**
 - Oil Life Reset
 - Accelerator Pedal Position (APP) Learn
 - Crankshaft Position Variation Learn
 - EVAP Service Req Test



3. Choose [Automatically Search] to identify car models automatically.

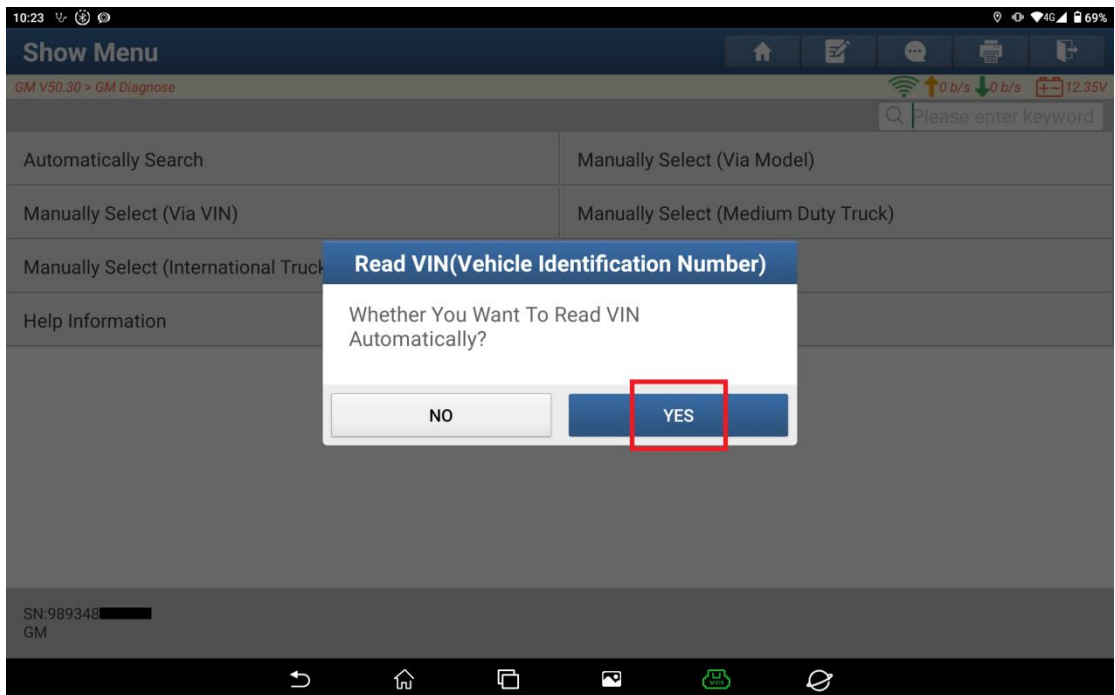
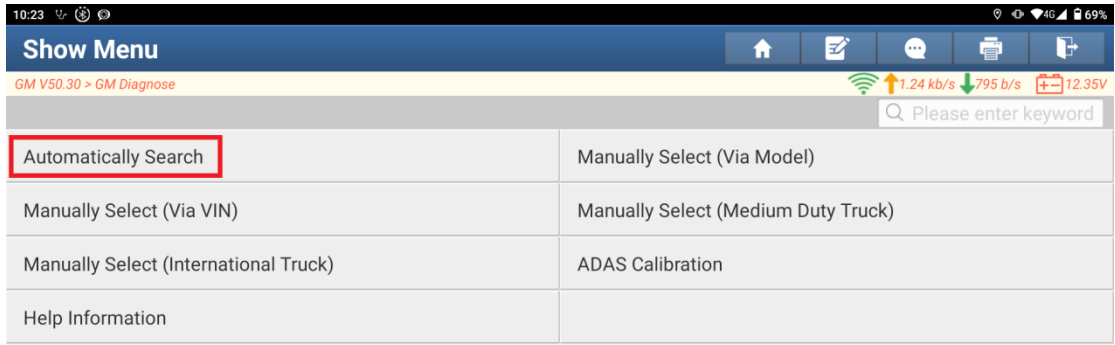

- 4. Operate according to the prompt “Turn Ignition ON (Turn The Key To On Position. For Push-Start Vehicle, Please Long Press The Start Button For 5-10s To Turn Ignition On)”.

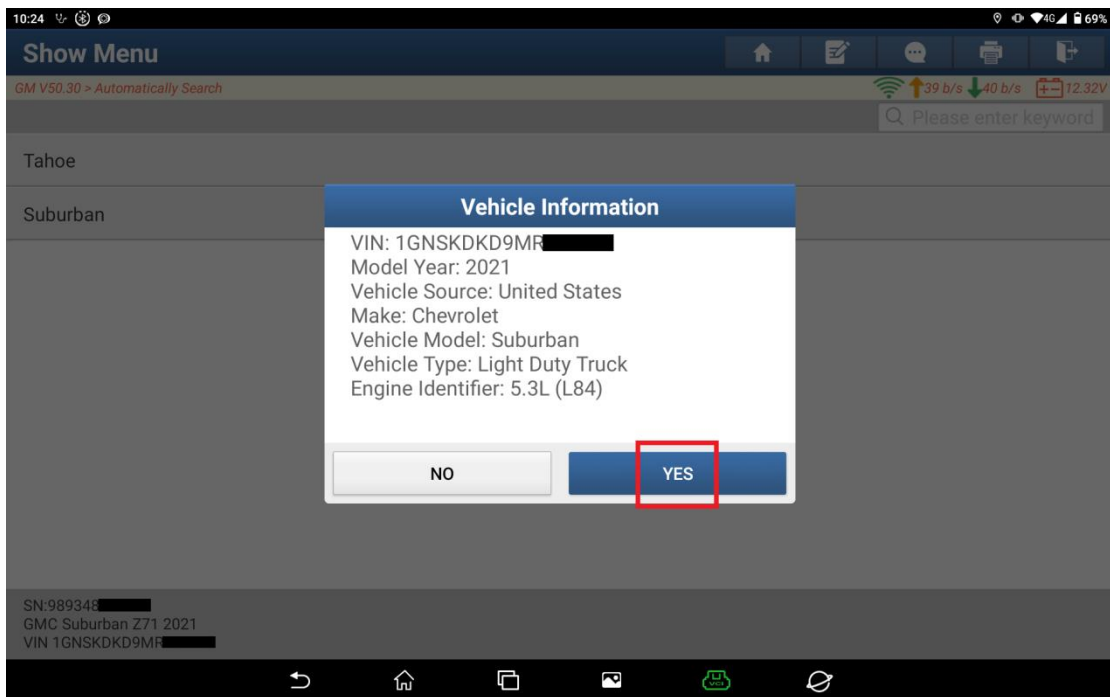
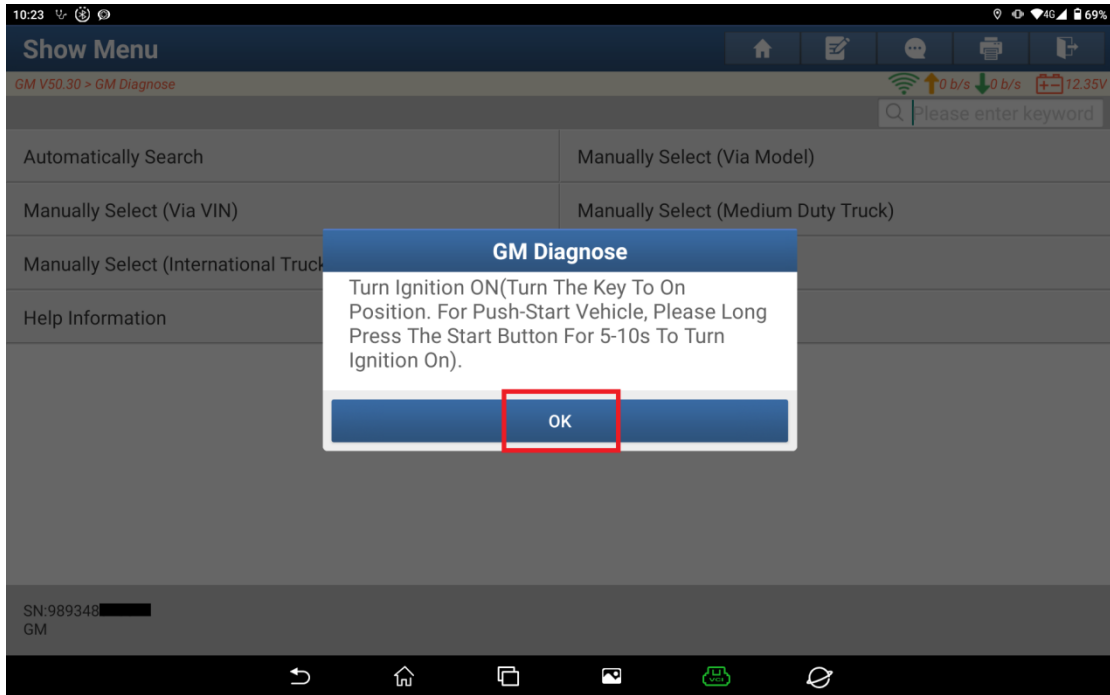

5. Click [PSCM] to access the system.

The screenshot shows the 'System and Function' interface for a GM V50.30 vehicle. The top status bar displays the time as 10:24 and battery level at 69%. The interface includes a navigation menu on the left with options like 'Topology', 'System List', 'Mutil-System DataStream', 'ADAS Calibration', 'Common Special Function', and 'Vehicle Configuration'. The main area features a network topology diagram with various modules connected by CAN bus lines. A red box highlights the 'PSCM' (Power Steering Control Module) node. Below the diagram, there are buttons for 'Smart Detection', 'System Scan', and 'Select Detection'. The bottom status bar shows the vehicle's SN (989348), VIN (1GNSKDK9M...), and model (GMC Suburban Z71 2021).

This screenshot shows the same 'System and Function' interface, but with the 'Power Steering Control Module (PSCM)' selected. The right side of the screen is now a greyed-out view of the PSCM's internal components. The 'ENTER' button at the bottom of the PSCM view is highlighted with a red box. The rest of the interface, including the navigation menu and status bar, remains the same as in the previous screenshot.

6. Click [Special Functions].

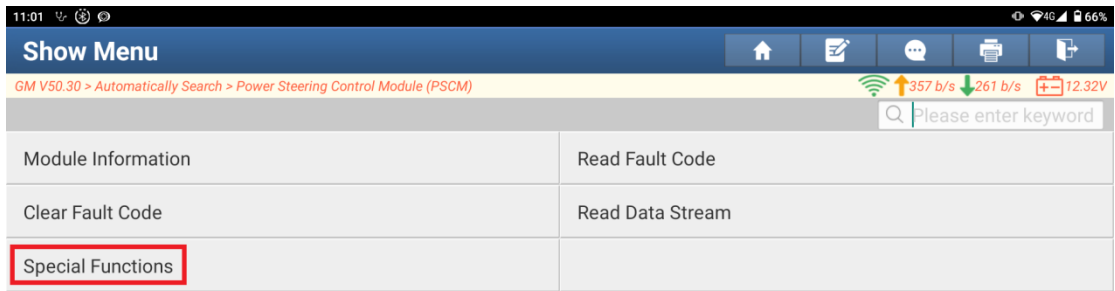

7. Click [Steering Wheel Angle Sensor Centering].

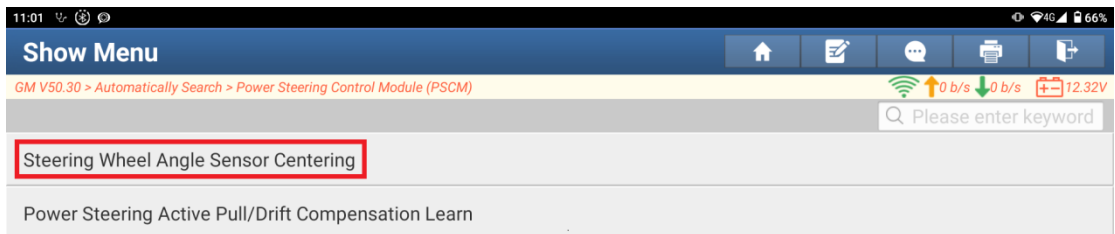

- 8. Confirm the following conditions before execution: "Engine Off, Ignition On, Vehicle In Park To Perform This Function."

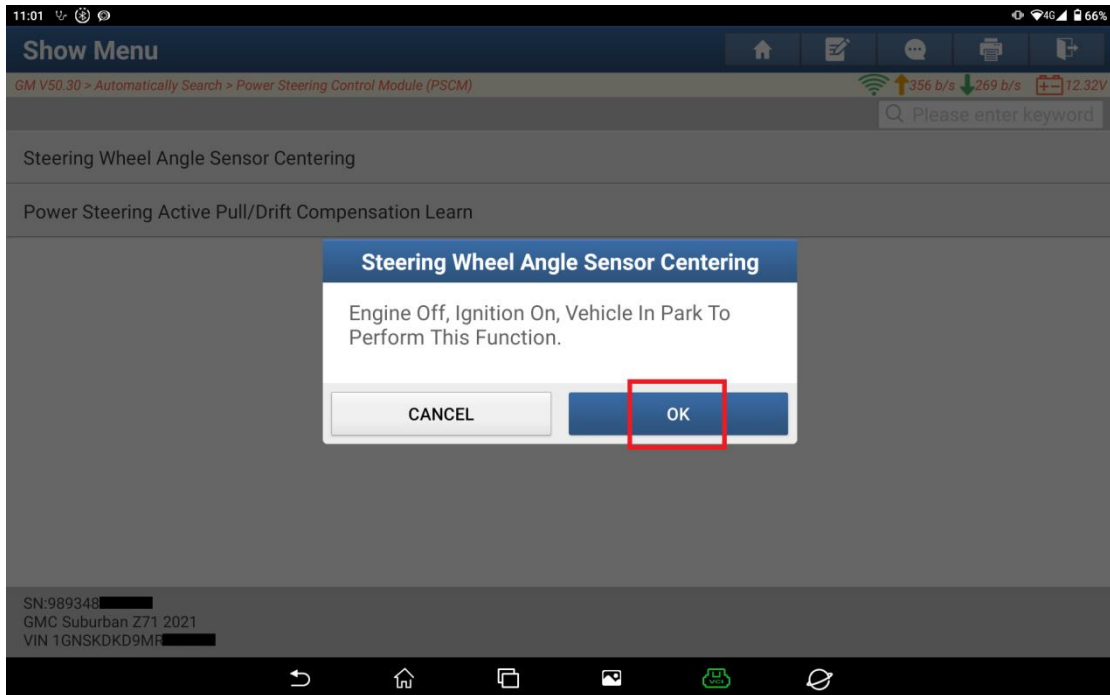

- 9. Fulfill the following conditions as prompted: "Align The Front Wheels Straight And Center The Steering Wheel."

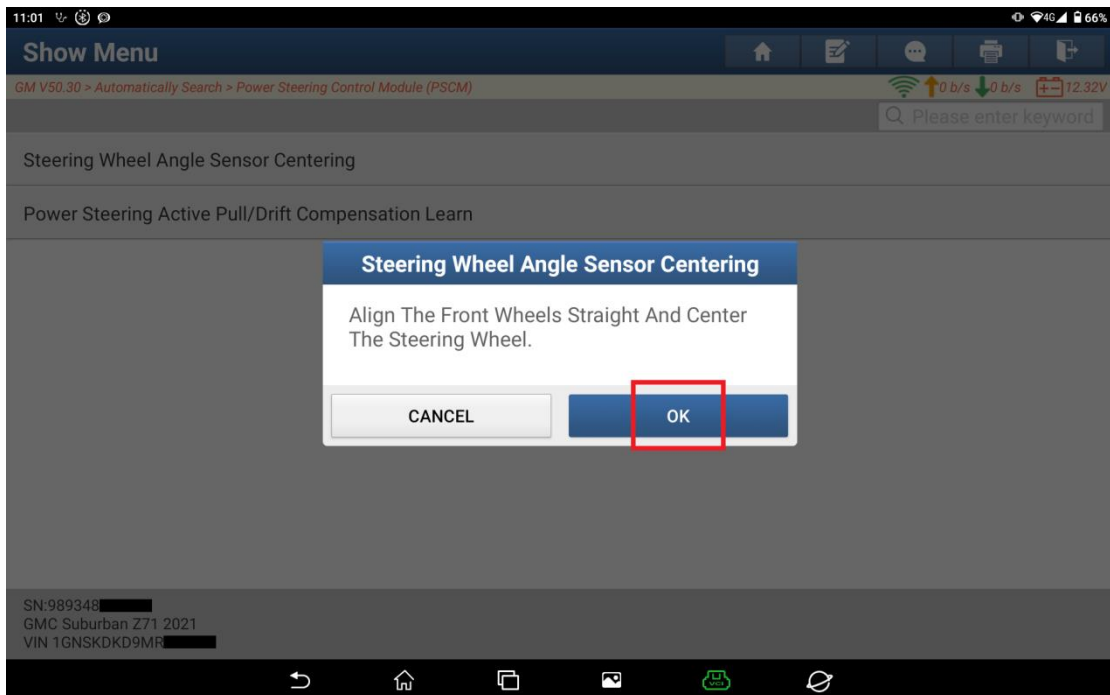

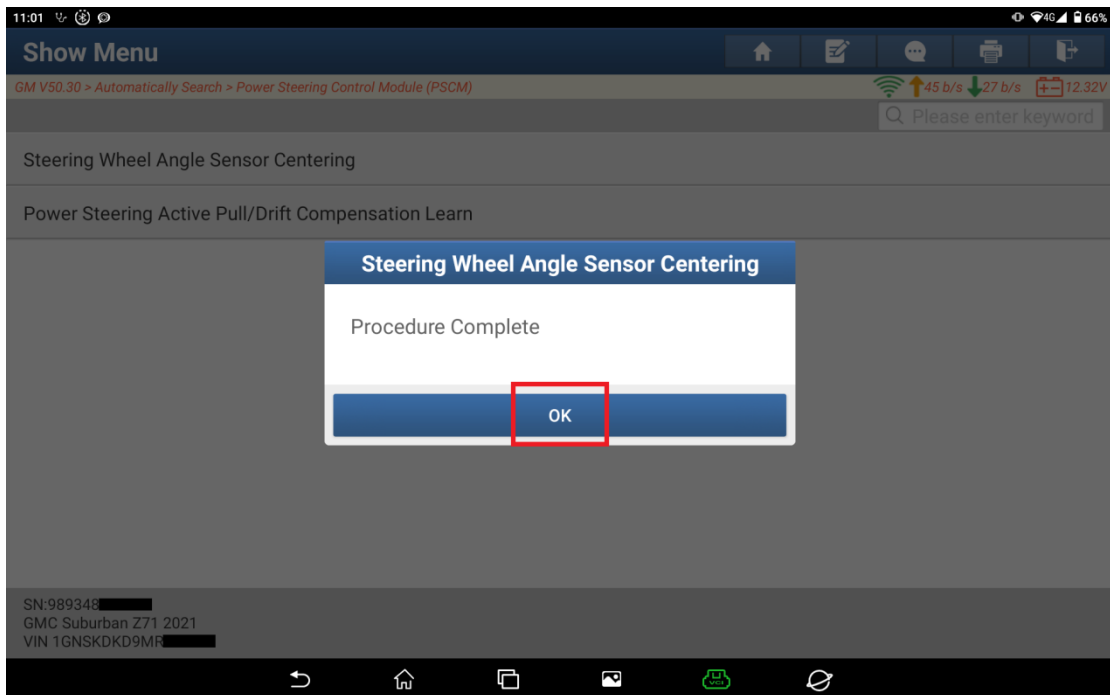
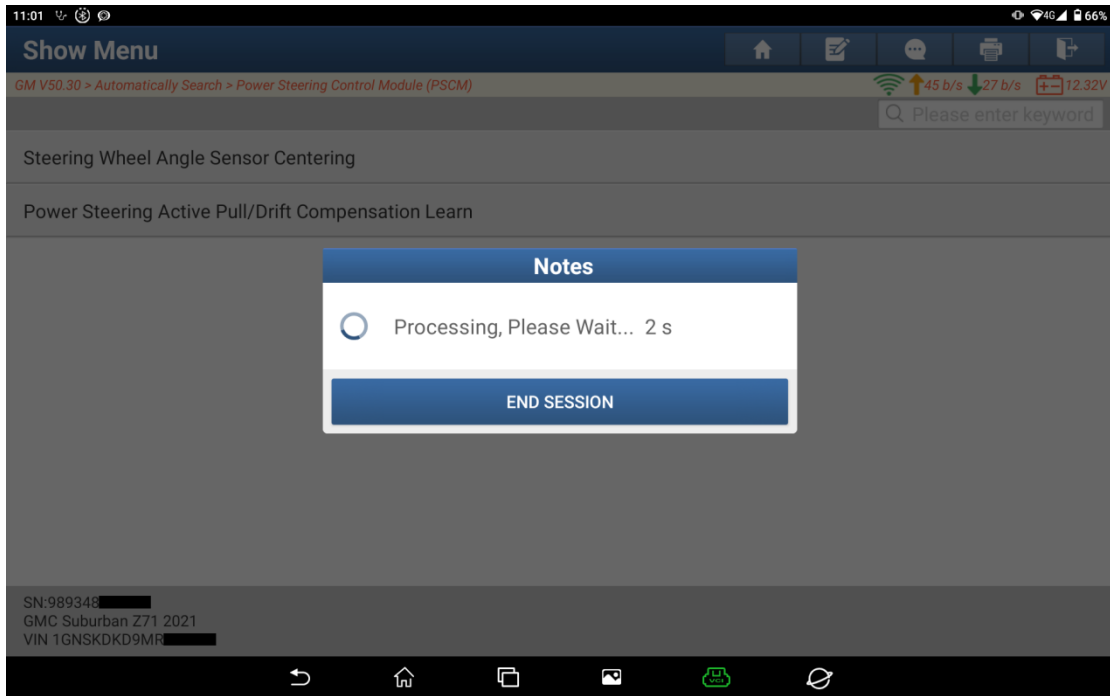

Statement:

The content of this document is copyrighted by LAUNCH TECH CO., LTD., and no individual or organization may quote or reprint it without consent.