

## CHRYSLER Renegade Oil Change Method

**Supported equipment:** Launch's full range of comprehensive diagnostic equipment

**Current equipment:** PAD V

**Function description:** After repair is completed for CHRYSLER Renegade, oil change is required.

**Tested models:** CHRYSLER/2021/Renegade, VIN: 1C4NJCDS0MPM\*\*\*\*\*

1. On a PAD V, choose [Local Diagnose] and then [CHRYSLER] to test;

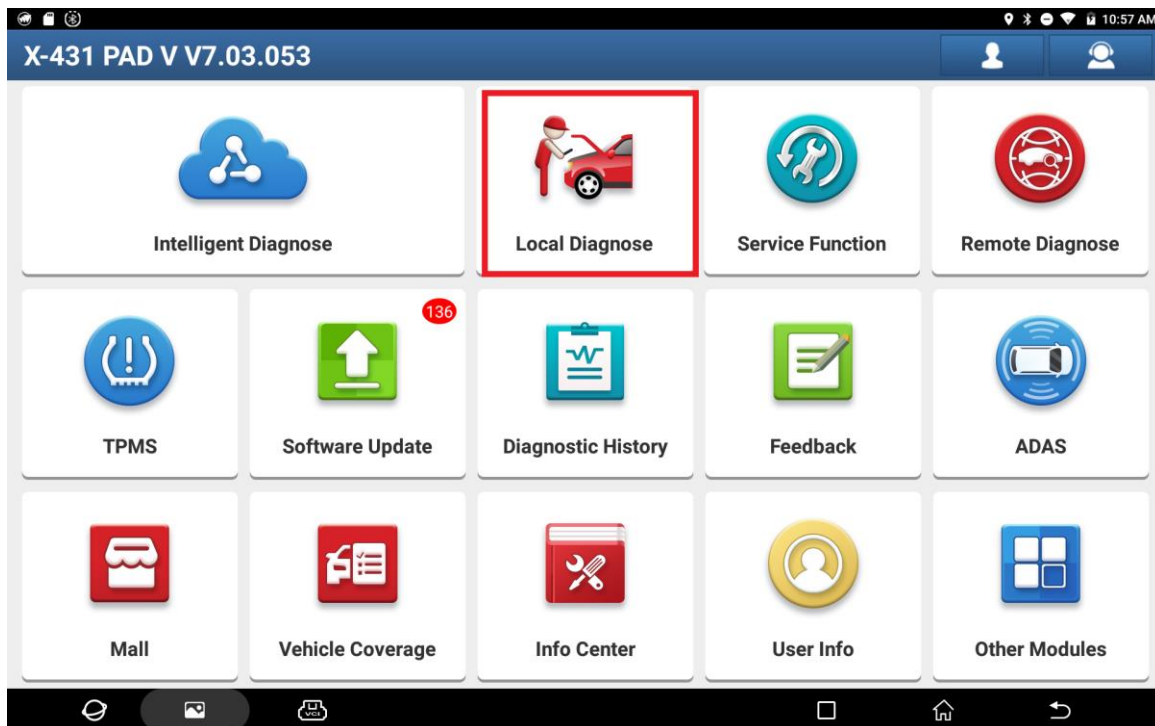

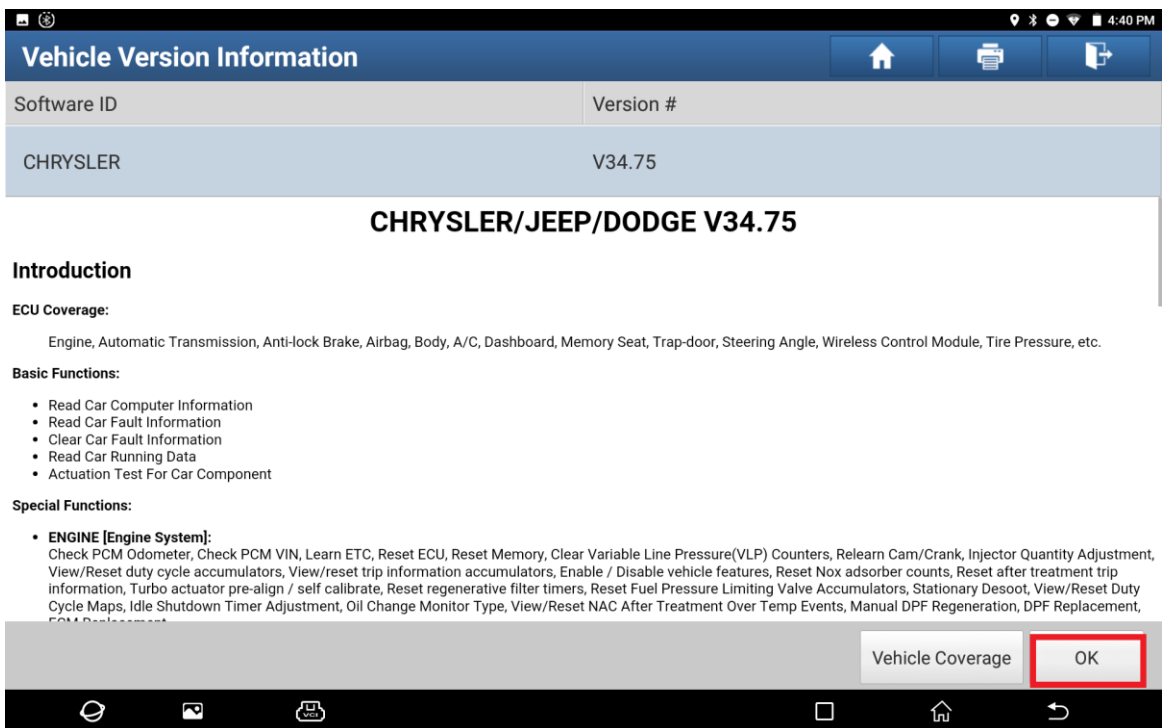
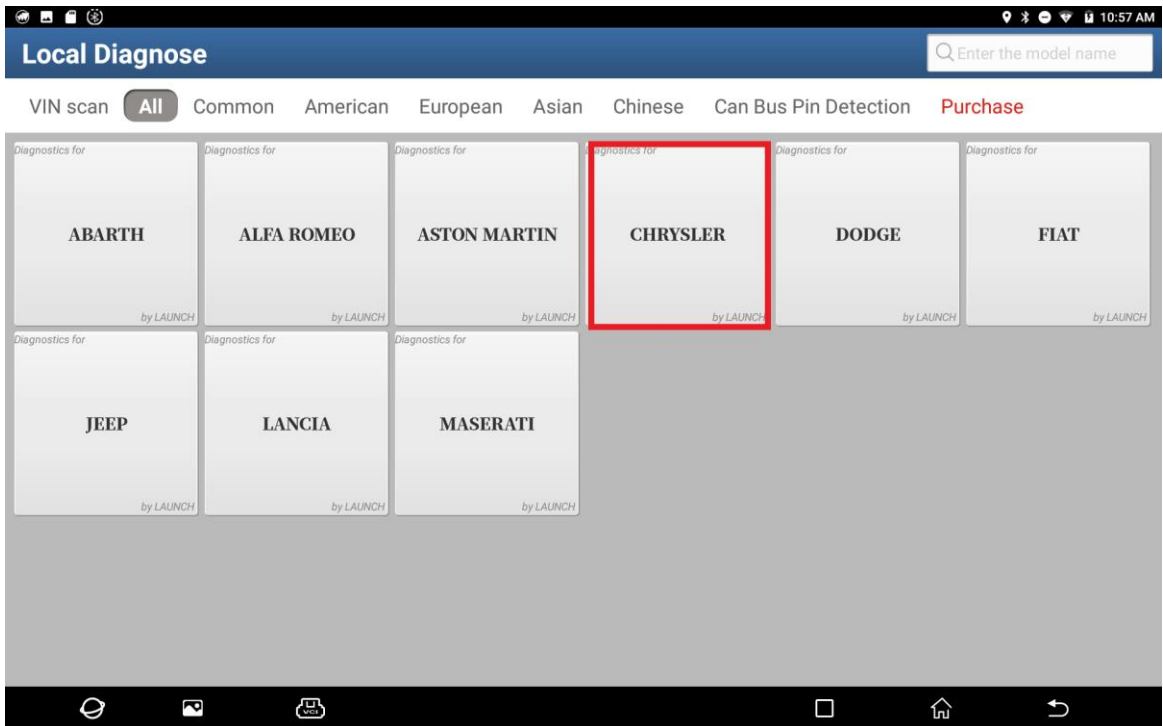

2. Click [16 PIN Connector] and choose [Automatically Search] to identify car models automatically;

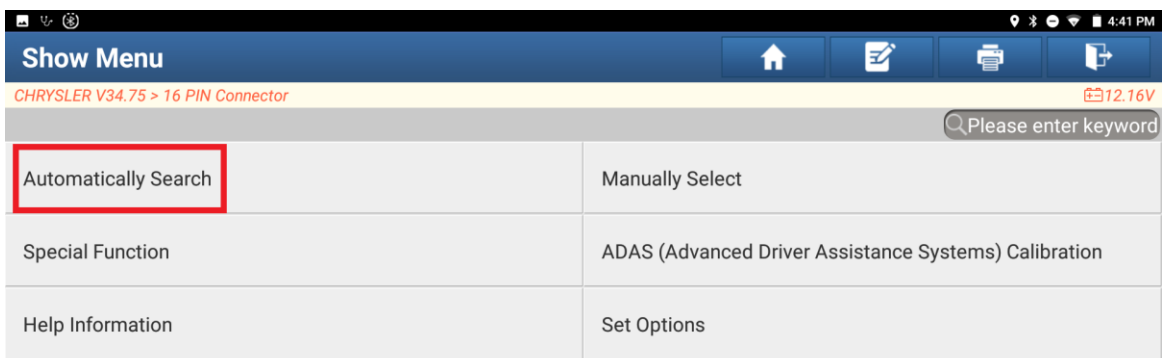
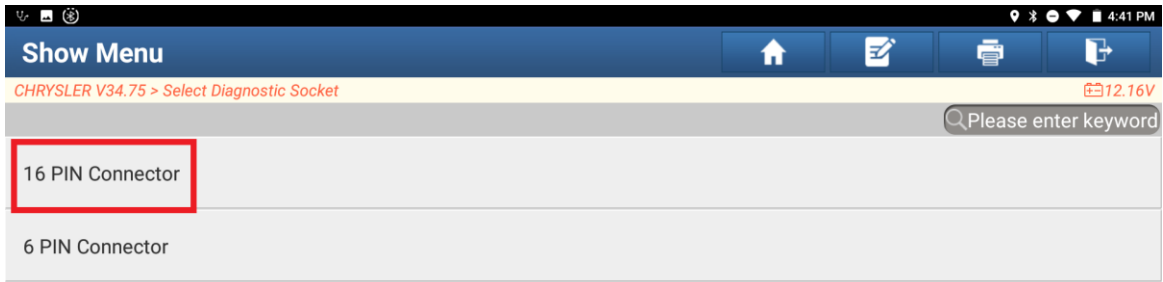

3. Click OK. It prompts that the SGW needs to be unlocked;

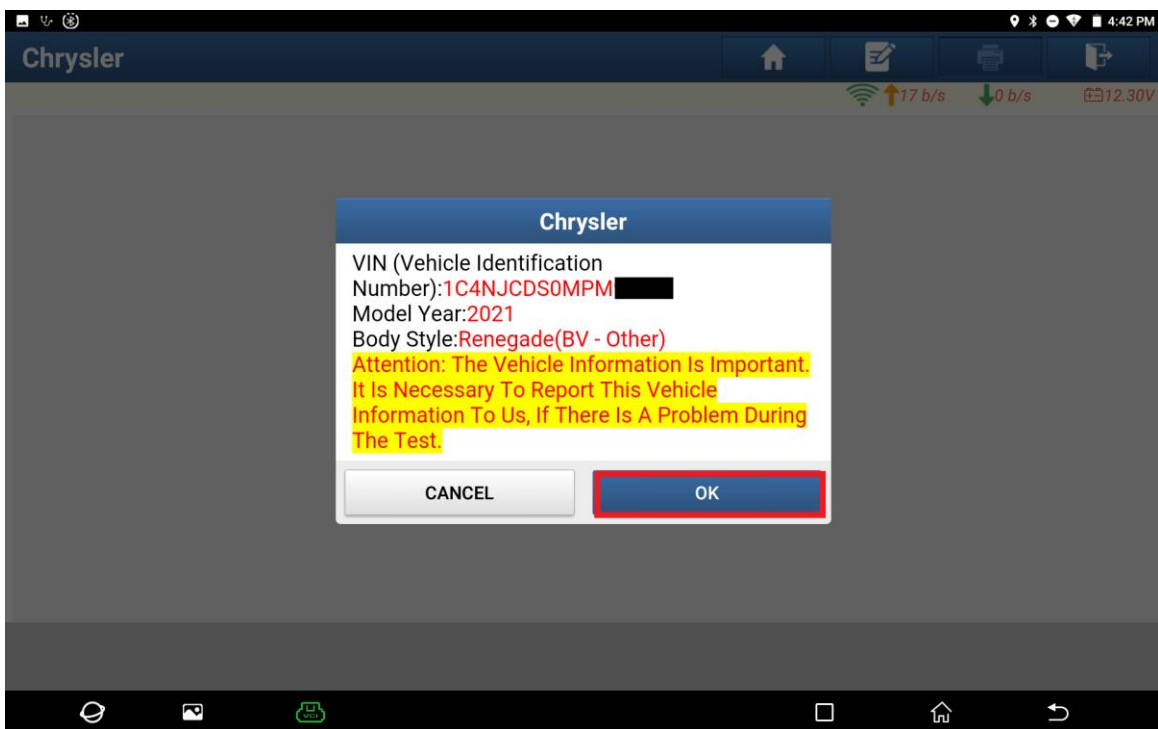
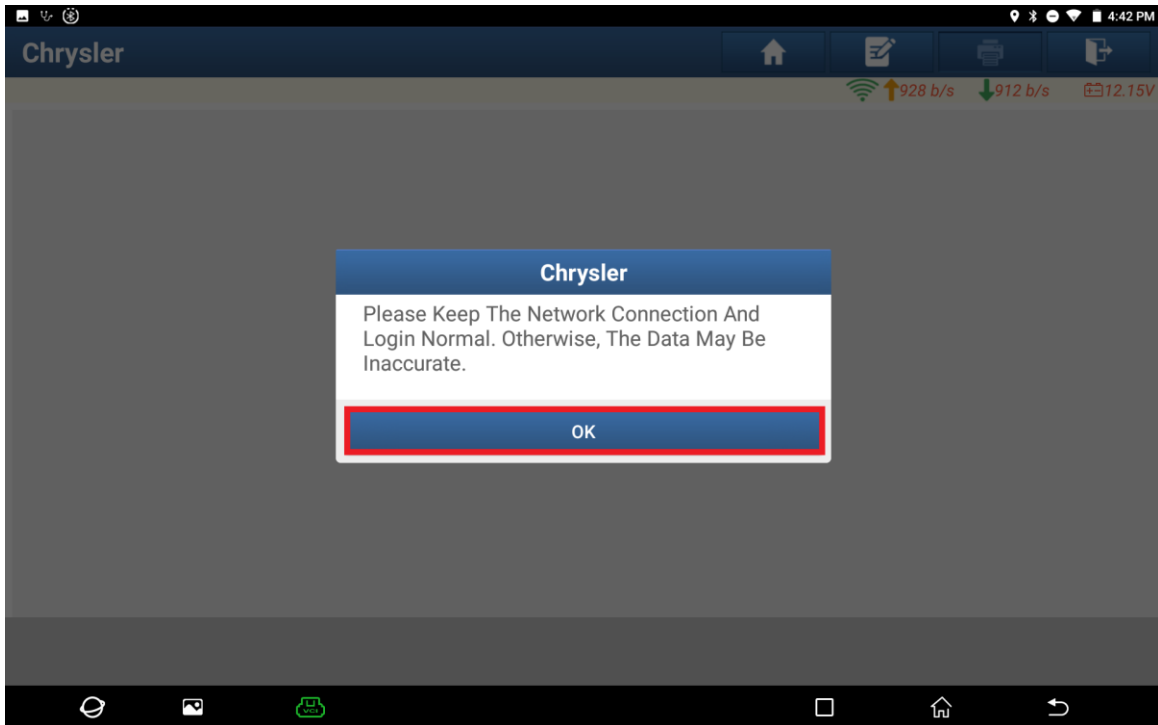

4. Click [Yes], choose [North America], and input the FCA account you purchased;



The Vehicle Is Equipped With SGW (Security Gateway) Module.  
Do You Want To Login with FCA Account To Unlock SGW (Security Gateway) Module?  
**Supports European Region Or North American Region(USA & Canada & Mexico). It Depends On The Business Area Of Your Dealer.**

\*YES\* - Login With FCA Account, Unlock The SGW (Supports'Version Information','Read DTC','Read Data Stream','Actuation Test'And'Special Function')  
\*No\* - Not Unlock SGW (Only Supports'Version Information','Read DTC'And'Read Data Stream')

**Without Unlocking SGW (Security Gateway).  
The Diagnostic Software Only Supports'Version Information','Read DTC'And'Read Data Stream'Functions.**

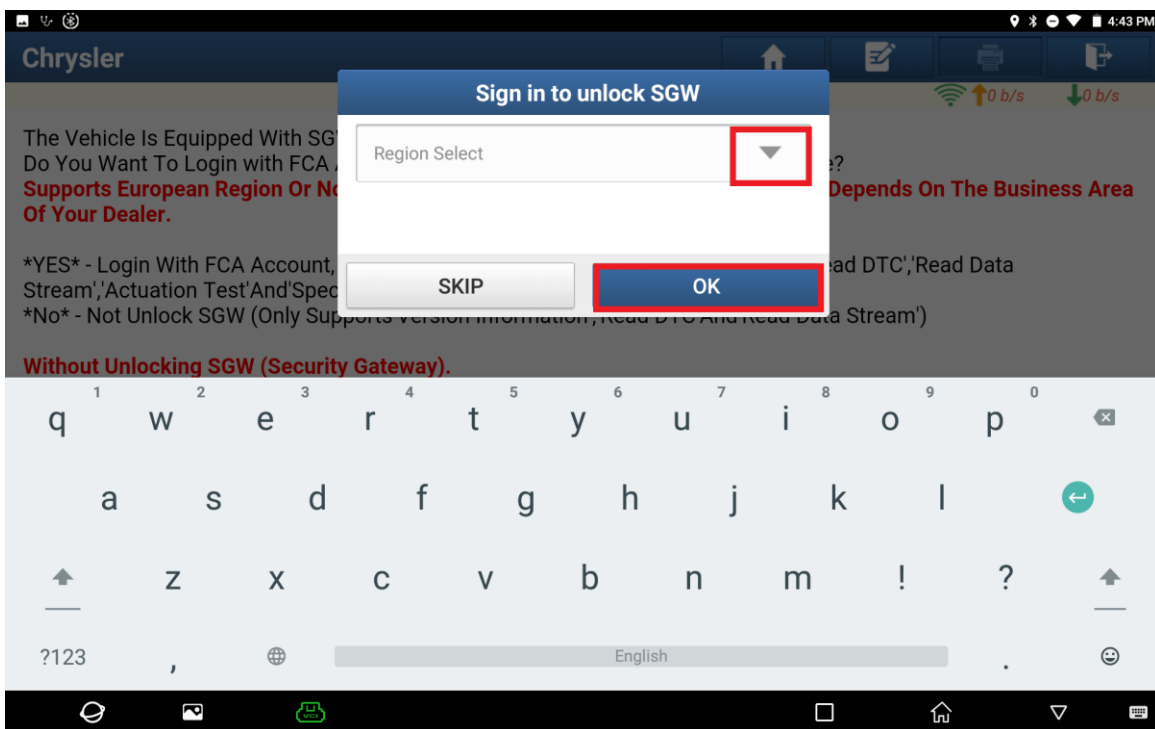

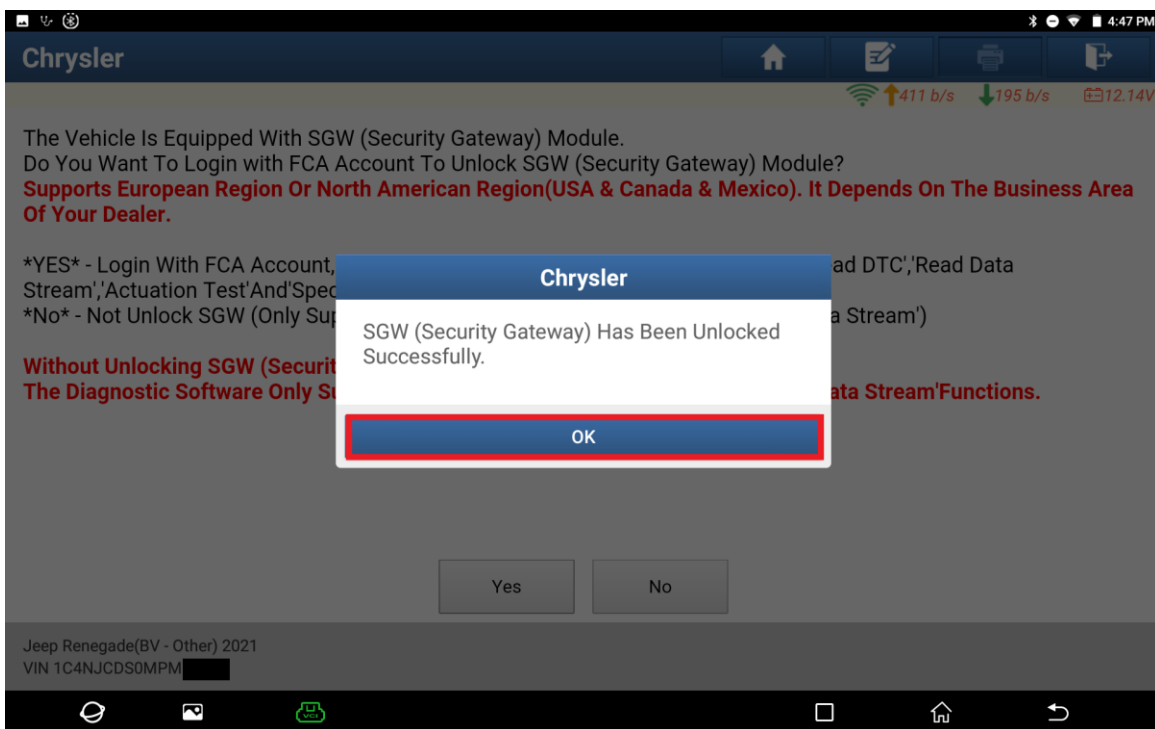
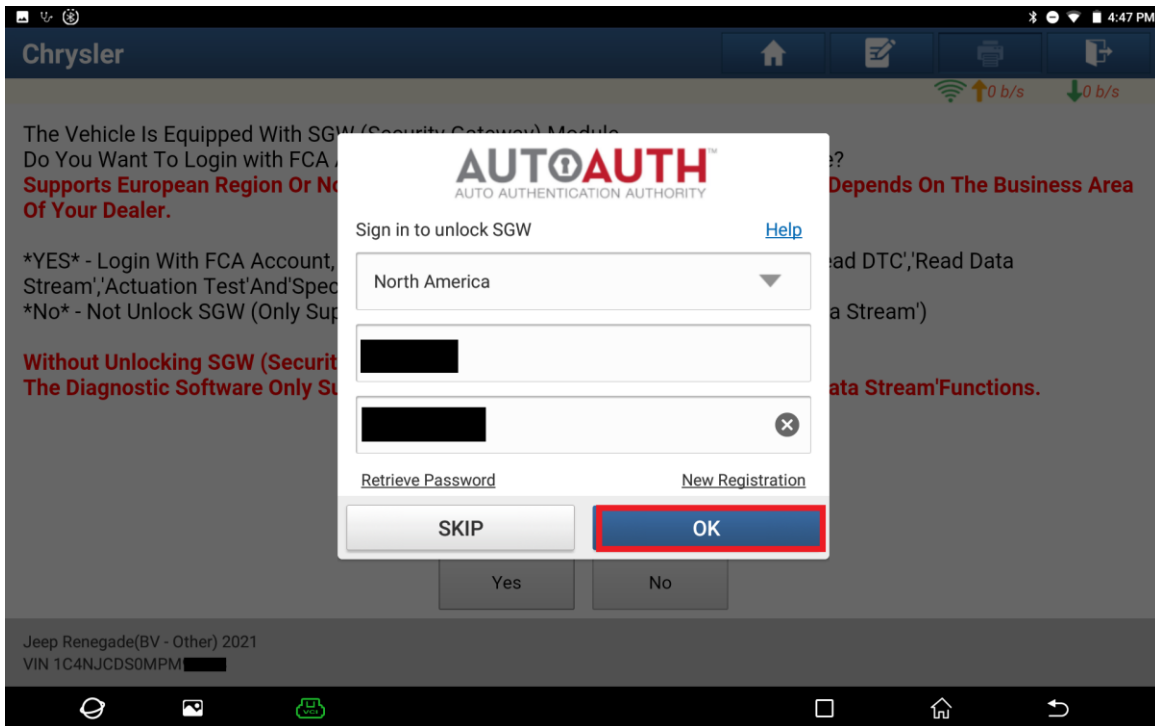

5. Click OK and click [Smart Detection] to scan the entire vehicle systems;

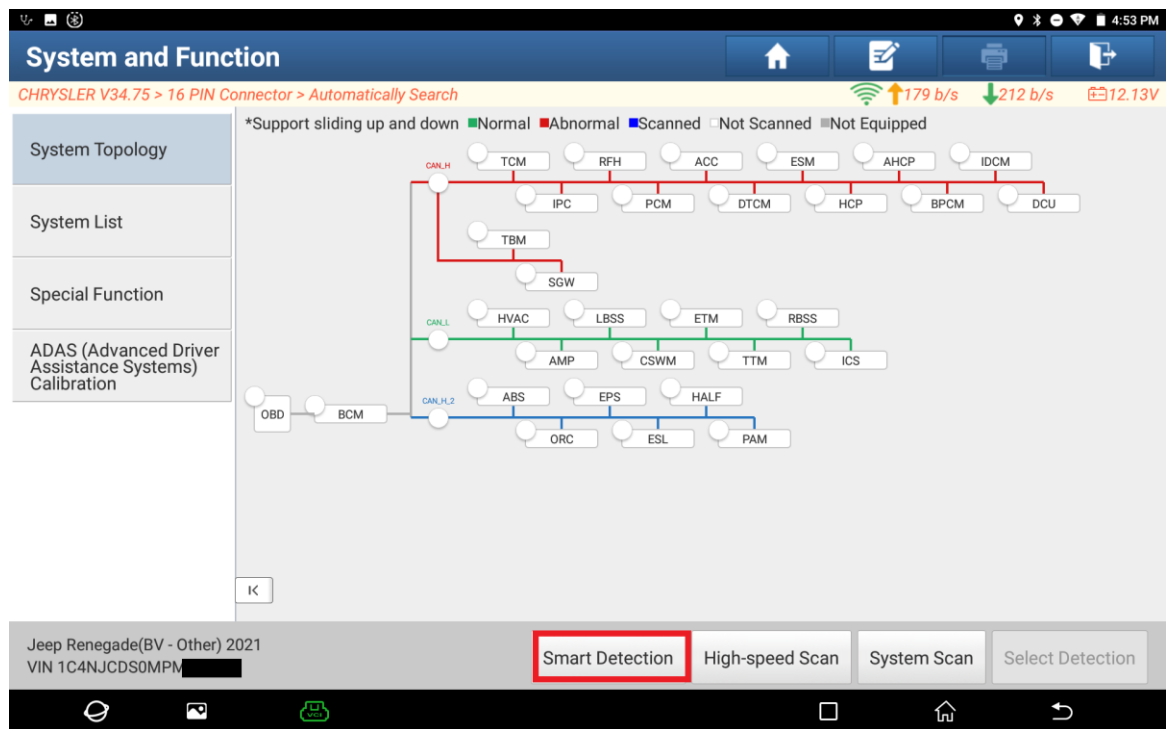

6. Click [PCM (Powertrain Control Module)] to access the system;

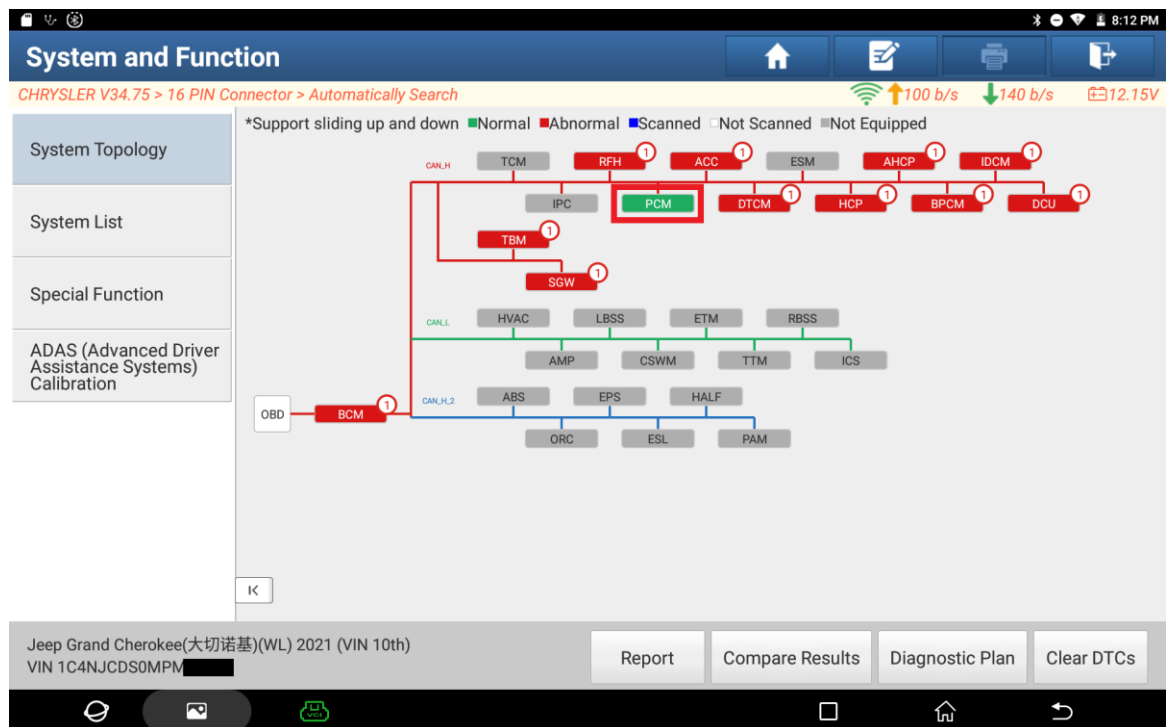

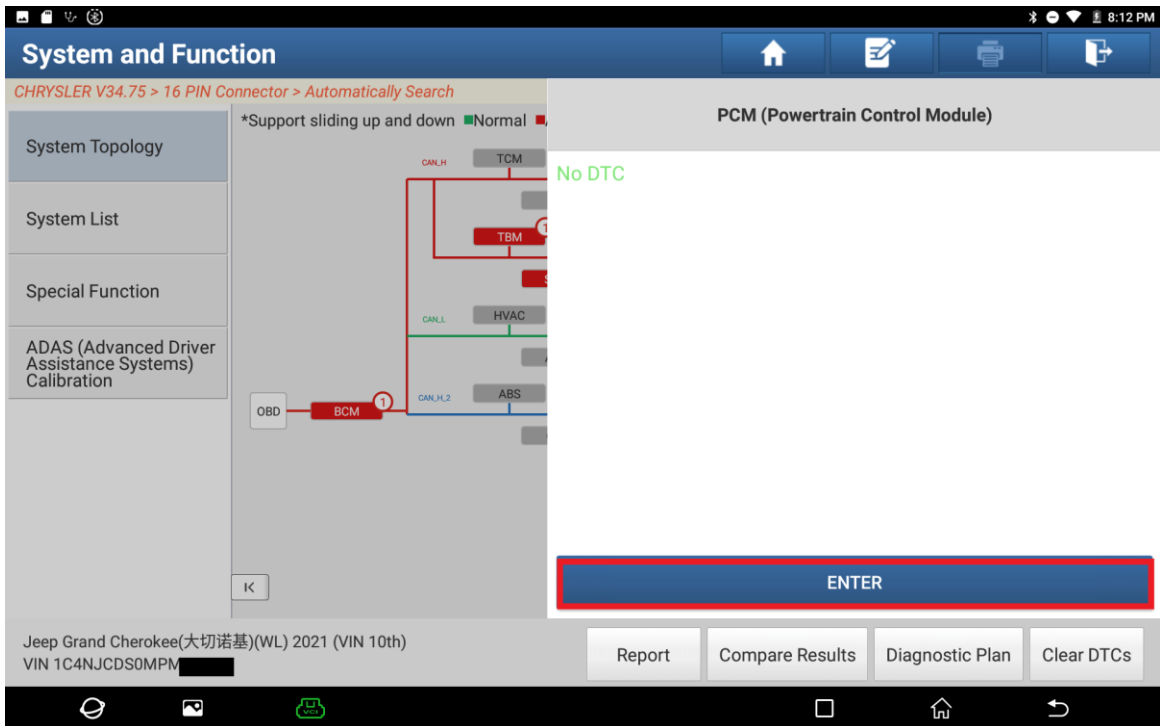

7. Click [Special Function];

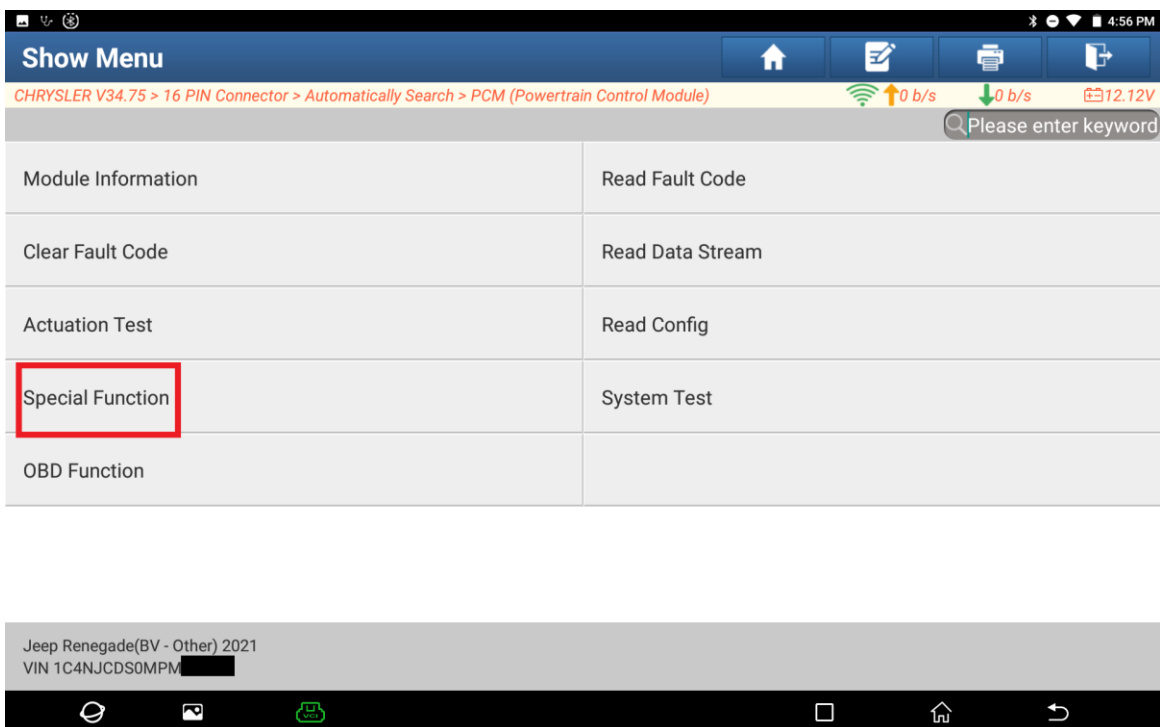

8. Click [Oil Change];



9. Click OK;

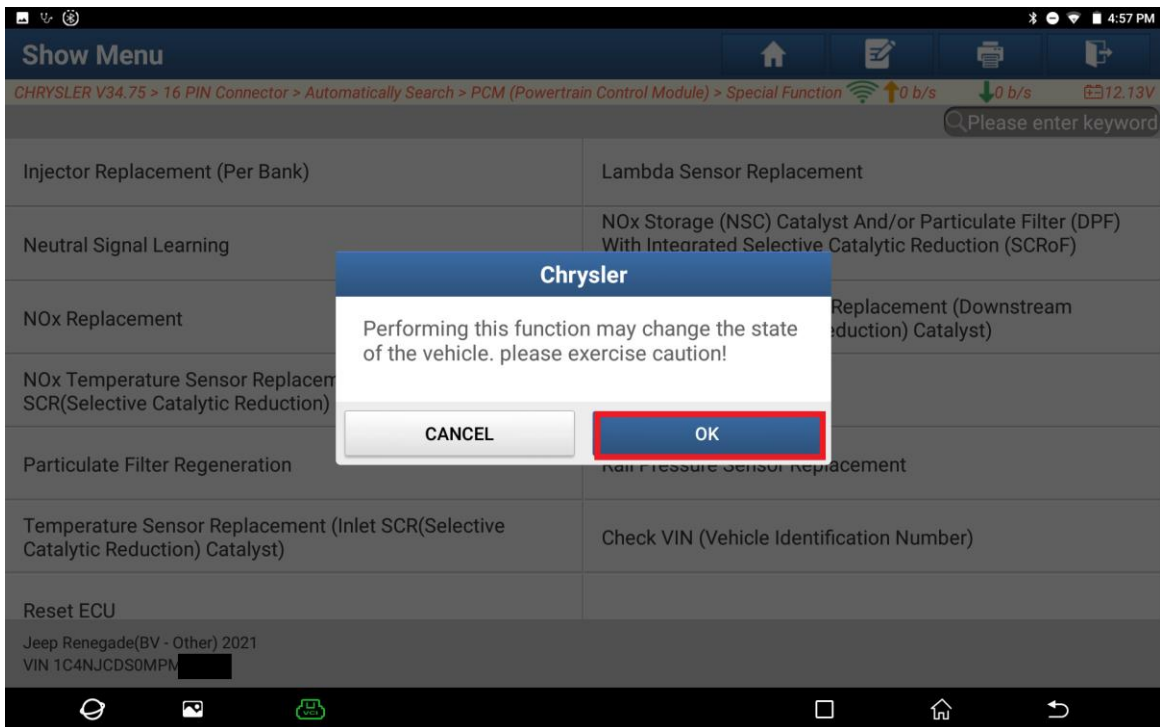

10. Click OK;

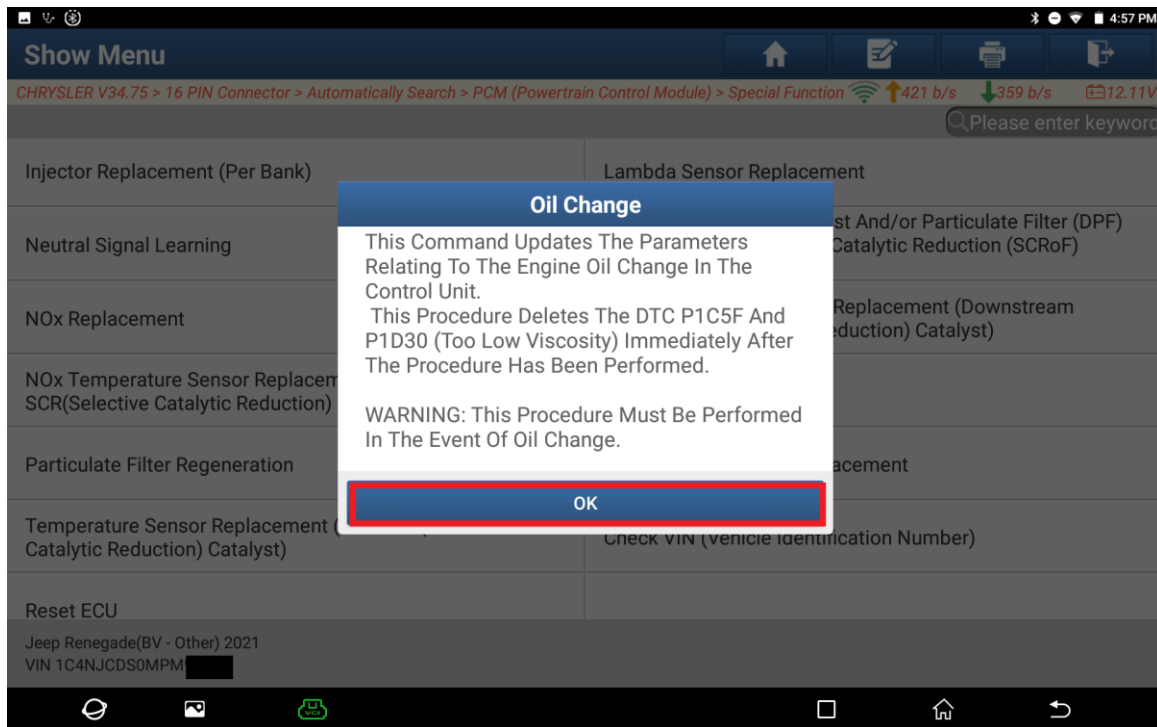

11. Click OK.

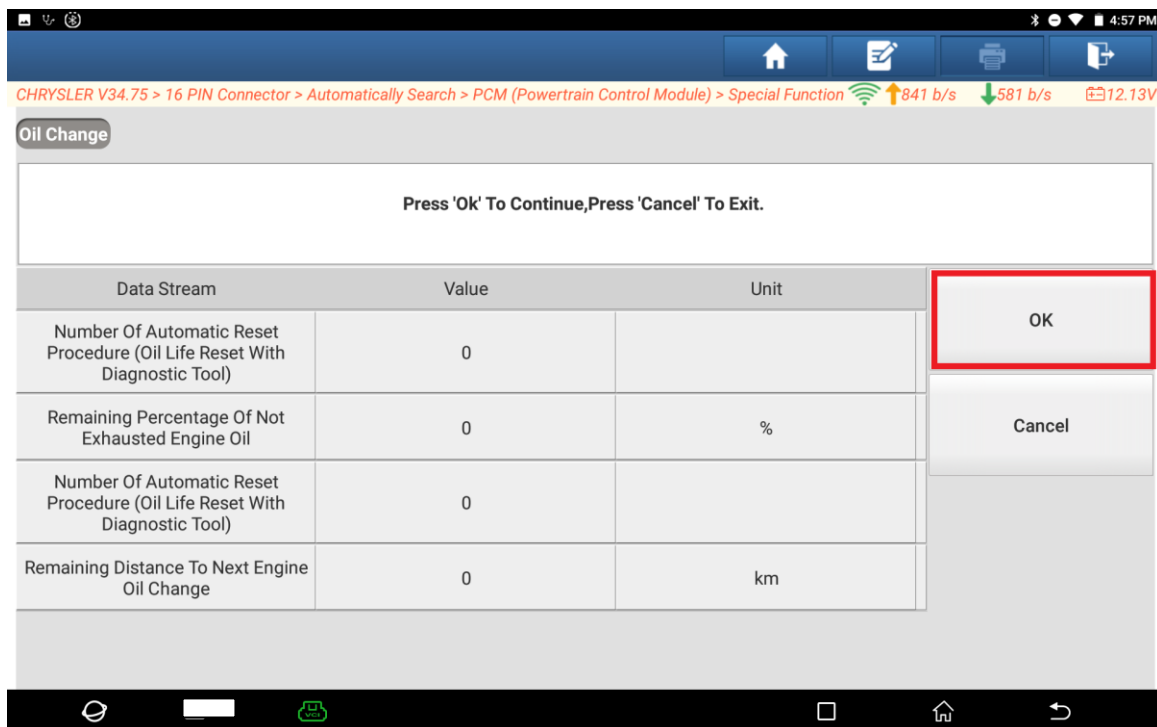

12. Click OK.

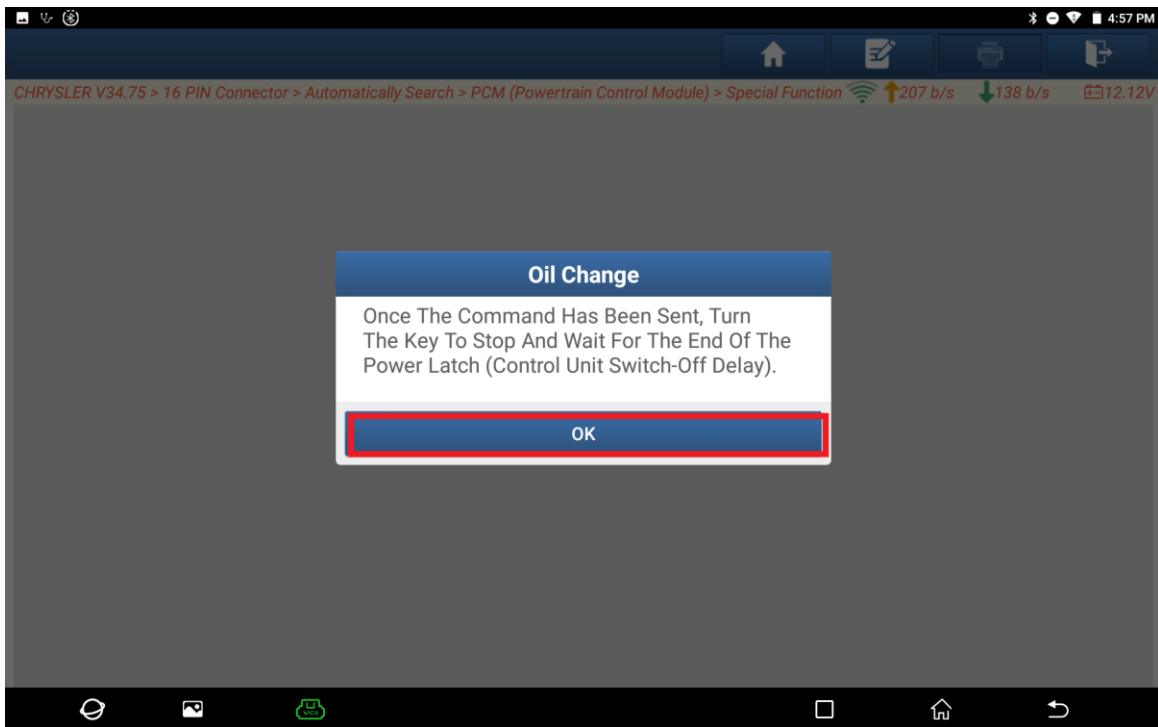

13. Click OK and wait.

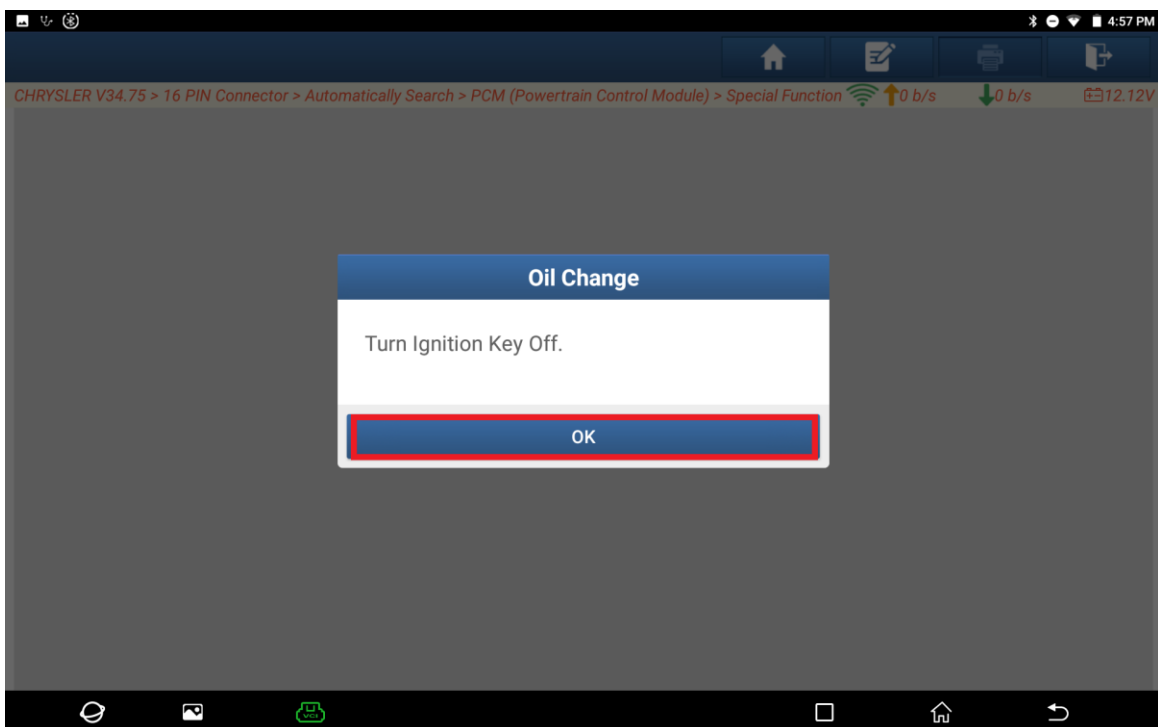

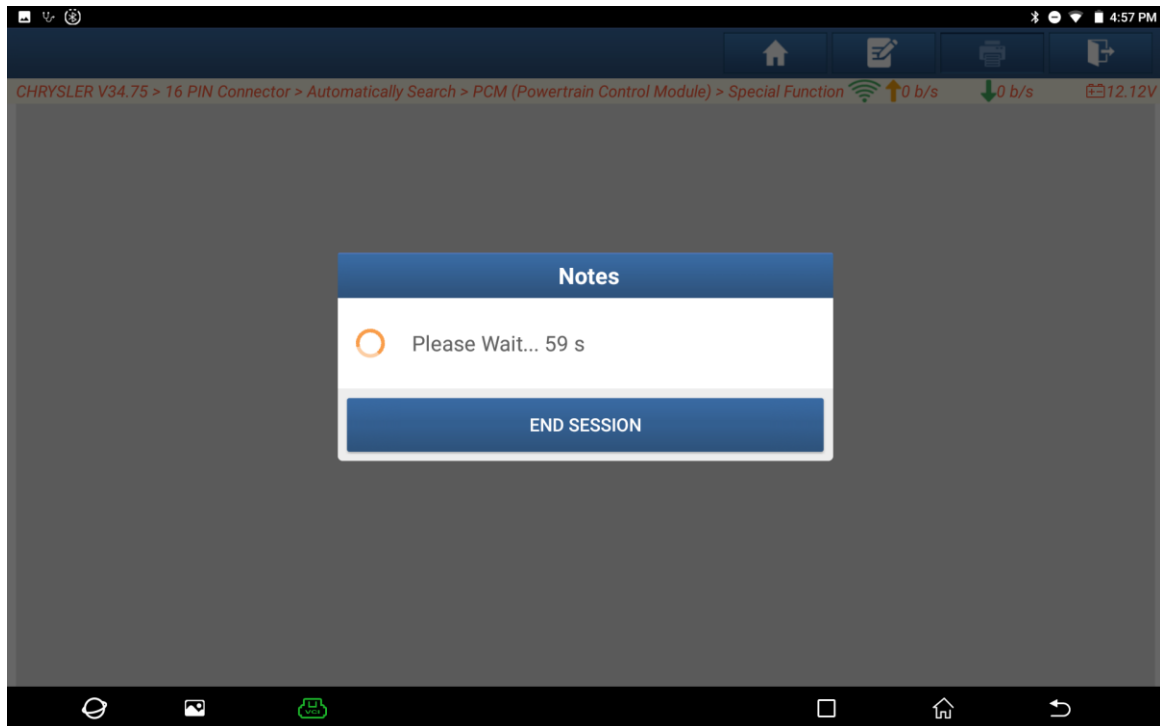

14. Click OK. The operations are completed.

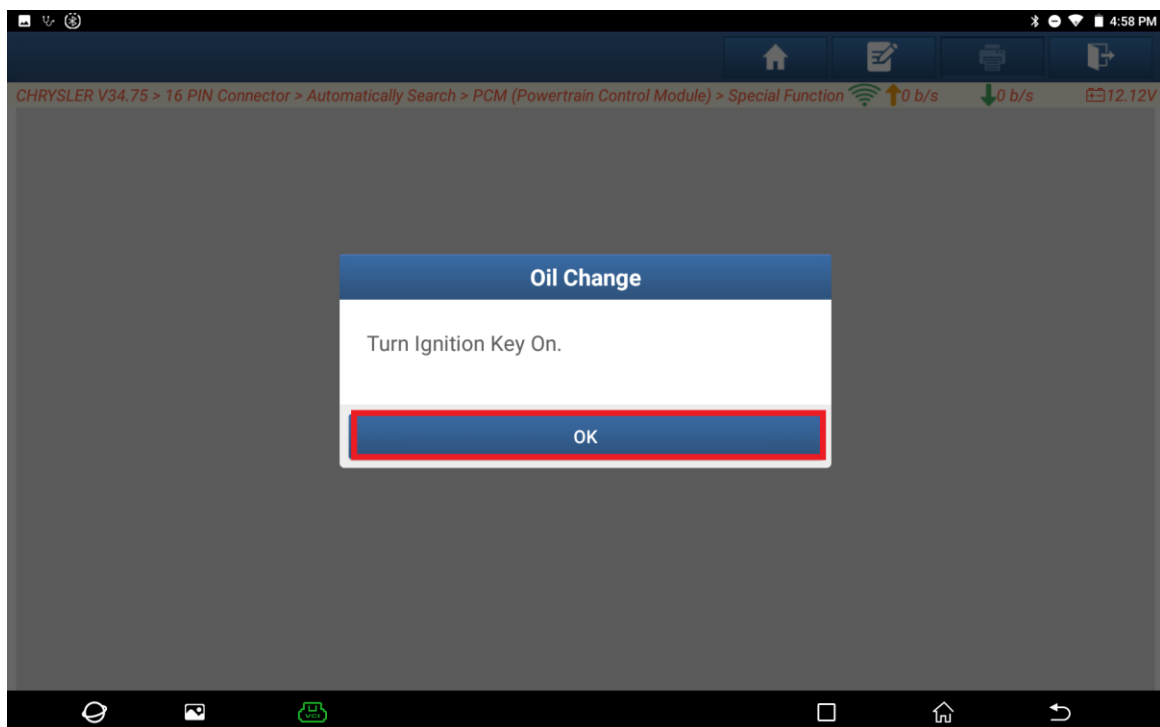

**Statement:**

The content of this document is copyrighted by Shenzhen Launch Tech Co., Ltd., and no individual or organization may quote or reprint it without consent.